



A24504



Hand Grip

•Attach Hand Grip to a wooden structural member greater than 1" thick using the lag screws provided.

•Pre-drill with 3/16" drill bit prior to fastening.

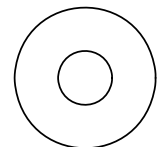
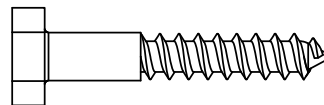
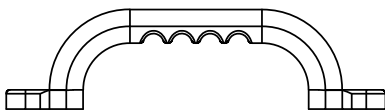
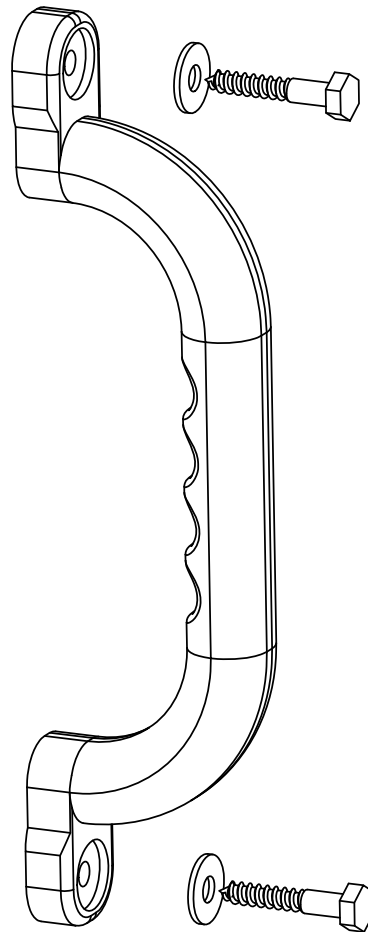

(1) 2 pack Yellow Hand Grips • 3320240

(2) 1/4 x 1-1/2" Lag Screw -9262212

(2) 1/4" Flat Washer -9251200