

## Installation

1. Remove the filter from the drainer, and then screw out the ferrule with a screwdriver to separate the filter flange from the drainer body.

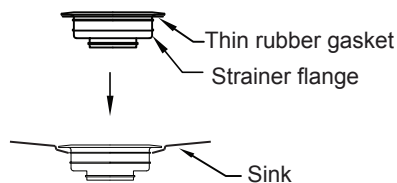

2. Place the filter flange into the sink, making sure the thin rubber gasket is in place.

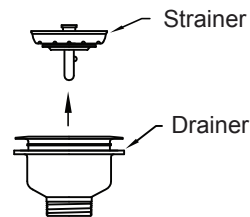

3. Lubricate flange gasket with water, place into lip of drain body and position drain body on the sink bottom.

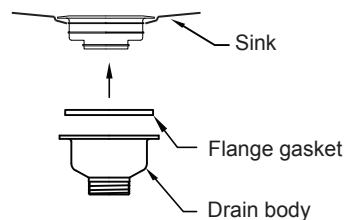

4. Align the ribs on the drain body and filter flange, then screw in ferrule and tighten with a screwdriver.

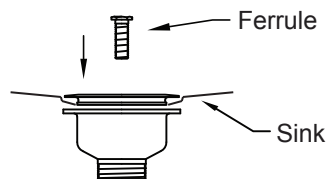

5. Push strainer into ferrule in drain body.

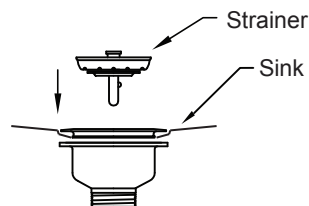

6. Make sure washer is in position, slide nut on 2" drain tubing and hand tighten the drain body nut. Test for leaks.

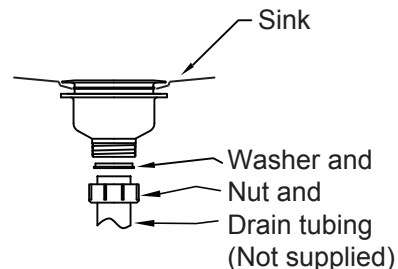

## Sink Drain With Removeable Strainer Installation Instructions

Model: 82101

- Maximum diameter of drain flange: 4-13/32"
- Specification for drain nut: 2" (minimum thread diameter about 2-1/4")

Questions, problems, missing parts?  
call Akicon Customer Service 8 a.m.-6p.m. EST, Monday-Friday  
Phone: +1(302)213 4406, Email: [service@akiconshop.com](mailto:service@akiconshop.com)  
[AKICONSHOP.COM](http://AKICONSHOP.COM)