

POULANPRO

MODEL
PP350



HEAVY DUTY STEAM CLEANER
OWNER'S GUIDE

IMPORTANT SAFETY INSTRUCTIONS

This owner's guide and any additional inserts are considered part of the product. They contain important information about safety, use, and disposal. Before using the product, please familiarize yourself with all operating and safety instructions. Please keep all documents for future reference and pass these documents on, together with the product, to any future owner. See our website for the most current version of this owner's guide.

INTENDED USE: This product is intended to be used indoors for household cleaning in the United States and/or Canada. This product is not intended for commercial or industrial uses. The manufacturer assumes no responsibility for damage or injury due to unauthorized use or product modification. Failure to follow these directions will void the product warranty.

WARNING: Risk to Children and Impaired Persons

Supervision is required during the installation, operation, cleaning and maintenance of this product by children under age 12 and anyone with reduced physical, sensory or mental capabilities. Children should be supervised to ensure that they do not play with the appliance, its parts and packaging material.

Directions to reduce risk of fire, electrical shock, and injury:

1. Read all instructions before use.
2. If an extension cord is necessary, use a properly rated cord (15 ampere, 14 gauge). Use care to position extension cord where it is least likely to be damaged or tripped over during use.
3. Before plugging power cord into electrical outlet, be sure that all electrical information on rating label agrees with your power supply.
4. To reduce likelihood of circuit overload, DO NOT operate another high wattage appliance on the same circuit as this unit.
5. To protect against risk of electrical shock, do not immerse unit in water or other liquids. Do not use power cord as handle, let it hang over edges of counters, or be crimped or closed in doors.
6. Never yank power cord to disconnect from outlet; instead, grasp plug and pull to disconnect.
7. Do not operate unit with a damaged power cord or if the unit has been dropped or damaged. To avoid risk of electrical shock, do not disassemble unit; contact Poulan Pro Consumer Service for examination and repair. Incorrect reassembly can cause a risk of electrical shock when unit is used.
8. A loose fit between wall outlet (receptacle) and plug may cause overheating and distortion of the plug. Discontinue use of the product in this outlet. Contact a qualified electrician to replace loose or worn outlets.
9. Do not leave unit unattended while plugged in.
10. Do not use unit where aerosol-based products are being used, or where oxygen is being administered.
11. Unit is only meant to be used with recommended model PP350 accessories. Using other types of attachments may cause damage to unit or injury.
12. If Lighted On/Off Switch does not illuminate when set to "ON" position while power cord is plugged in, unit is not operating normally. Immediately disconnect cord from power supply, then refer to troubleshooting guide of this manual for assistance.
13. Always turn unit off and unplug power cord before filling Boiler with water. Do not attempt to use unit without properly filling Boiler.
14. When filling Boiler, only water should be used in unit – other cleaning agents could damage unit or cause injury. Distilled or de-mineralized water is highly recommended, in order to minimize potential build-up of mineral deposits. Do not fill Boiler with more than 48 oz. (1,420 ml.) of water.
15. To avoid burns from escaping steam when removing Boiler cap to refill unit:
 - Always allow unit to cool for 5-10 minutes.
 - Press and hold Steam Button to release all remaining steam pressure.

-
16. To reduce risk of contact with hot water emitting from Main Nozzle, check appliance before each use by positioning it away from body and turning it on. Do not operate unit if Main Nozzle is blocked.
 17. Burns can occur from touching hot metal parts, hot water, or steam. Do not touch Main Nozzle or attempt to connect accessories while unit is in use. Do not touch bottom of Mop Head or attempt to attach a Microfiber Pad by hand while unit is in use. Use caution when you turn unit upside-down – there may be hot water in Boiler.
 18. Use caution when using unit on uneven surfaces, such as stairs.
 19. When steaming any surface for the first time, it is recommended that you consult the manufacturer's guidelines for material being steamed. For items in question, test on an inconspicuous area before proceeding.
 20. Steaming unsealed hardwood or unglazed ceramic surfaces is not recommended, and may result in warping or damage to the surface. Steam may remove the sheen from surfaces treated with wax.
 21. When steam mopping, never leave unit resting in one spot on any surface for any period of time – prolonged exposure to heat and moisture may damage floor surfaces.
 22. Do not allow power cord to touch hot surfaces during use. Bundle cord loosely when storing.
 23. Always allow Canister Steam Cleaner to cool (at least 30 minutes for complete cooling) and empty Boiler before storing. Do not store unit with a damp Microfiber Pad still attached.
 24. This product for use on 120 volt electrical outlets. The cord has a plug as shown at A in Figure 65.1. An adapter, as shown at C, can be used to connect three-blade grounding-type plugs to two-slot receptacles (it is not included with your product). The green grounding lug extending from the adapter must be connected to a permanent ground such as a properly grounded outlet box. An adapter should not be used if a three-slot grounded receptacle is available. *NOTE: A TWO-PRONG ADAPTOR IS NOT INCLUDED WITH THIS PRODUCT.

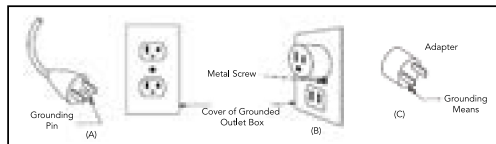

Figure 65.1

FCC CONSUMER ADVISEMENT: This equipment may generate, use and/or radiate radio frequency energy that may cause harmful interference to radio communications. Unauthorized use or modification of this product increases interference risk and may cause FCC revocation of permission to operate. To determine whether the equipment causes harmful interference, please turn the equipment on and off while simultaneously using a radio or television. If interference is suspected, the user is encouraged to contact Poulan Pro Consumer Service at 1-800-711-6617.

SAVE THESE INSTRUCTIONS

Questions or comments?

- poulanprosteam.com
- help@poulanprosteam.com
- 1-800-711-6617

Speak your mind! We invite you to review this product online:
poulanprosteam.com/reviews

The following features and accessories are included with your Heavy Duty Steam Cleaner. Carefully inspect the packing material for all parts listed below. To obtain possible missing parts, refer to **Product Support** on Page 15 of this manual for Consumer Service contact information.

UNIT FEATURES

- 1 10' Steam Hose
- 2 Pressure Gauge
- 3 Boiler Cap
- 4 Steam Handle Cradle
- 5 Illuminated On/Off Switch
- 6 Steam Nozzle
- 7 Steam Trigger Lock
- 8 Steam Trigger
- 9 Steam Adjustment Knob

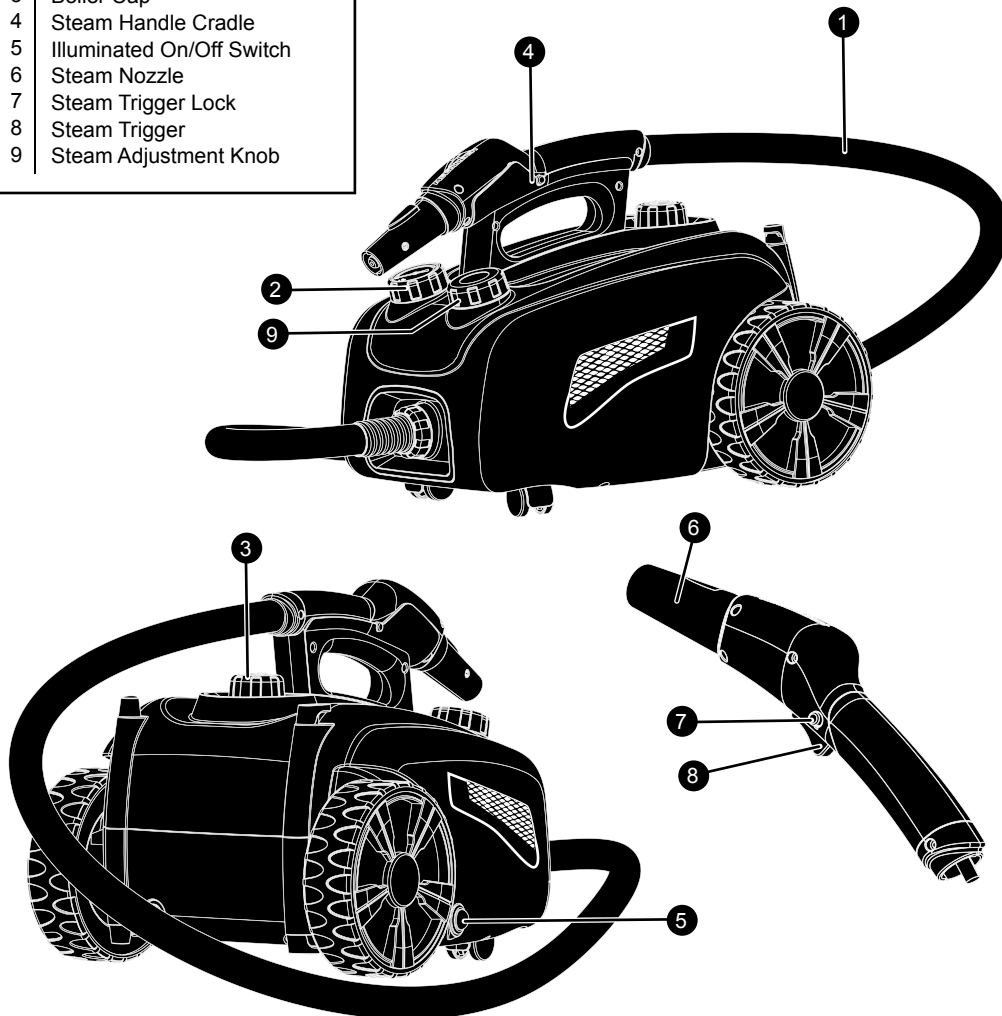

ACCESSORIES

- 1 2 - 16.5" Extension Wands
- 2 Microfiber Mop Pad
- 3 Scrubbing Mop Pad
- 4 5.5" Jet Nozzle
- 5 Triangle Brush
- 6 Squeegee
- 7 3 - 1.5" Nylon Utility Brushes
- 8 2 - 1.5" Brass Utility Brushes
- 9 Angled Nozzle
- 10 3" Scraper
- 11 13" x 8.5" Large Mop Head
- 12 Storage Bag
- 13 Fill Cup
- 14 Accessory Net
- 15 2 - 2.5" Round Brush

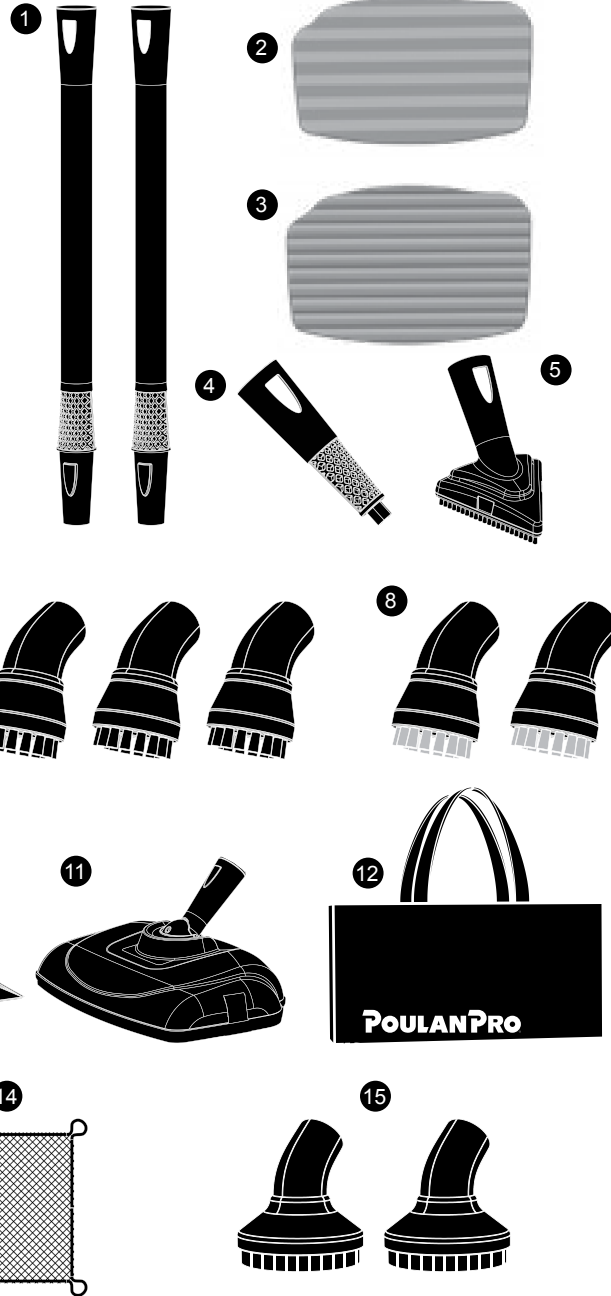

STEAM MOPPING ACCESSORIES

WARNING: Do not try to connect accessories while unit is emitting steam.

EXTENSION WANDS

1. Select one of the Extension Wands. Insert end (A) of Wand onto Steam Nozzle (B) with yellow lock/release button slightly off center with hole. Fully insert and rotate wand slightly to allow button to snap into hole.
2. Using the same instruction, attach remaining Extension Wand to the first Wand. Both Extension Wands should now be connected to the Steam Nozzle.

**MOP HEAD**

1. Align Mop Head with open end of Extension Wand, so that hole in Mop Head aligns with yellow lock/release button on Wand.
2. Press down on yellow lock/release button. While continuing to hold button down, slide Mop Head onto Extension Wand (See figure 1-A). Fully insert and rotate wand slightly until button snaps through hole (See figure 1-B).

NOTE: Do not use excessive force when mopping or using Extension Wands as this may cause the Wands to break.

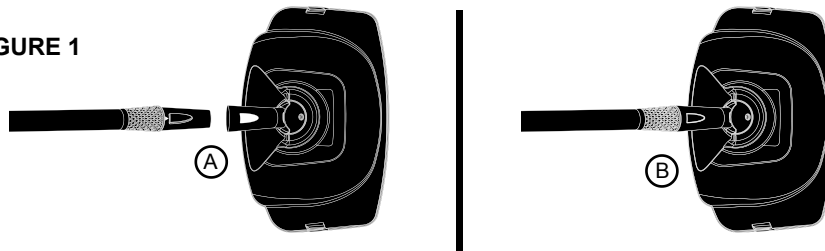
FIGURE 1

MICROFIBER PADS

1. Lay one Microfiber Pad on flat surface, with two fastener strips facing upward.
2. Align Mop Head with Microfiber Pad. Make sure Mop Head is oriented with Pad as shown, and centered as best as possible (See figure 2-A).
3. Press Mop Head firmly down onto Microfiber Pad. Fastener strips will adhere to Pad Grips on underside of Mop Head. Pad should now be attached and ready for use (See figure 2-B).

CAUTION: Use care when handling a recently used Microfiber Pad, as it may still be hot.

NOTE: Microfiber Pads are machine washable. To avoid picking up lint, washing separately from other fabrics is recommended. Only use liquid detergent. Avoid using any fabric softeners or bleach. Air drying is recommended; machine drying on a low heat or air dry setting is acceptable as well.

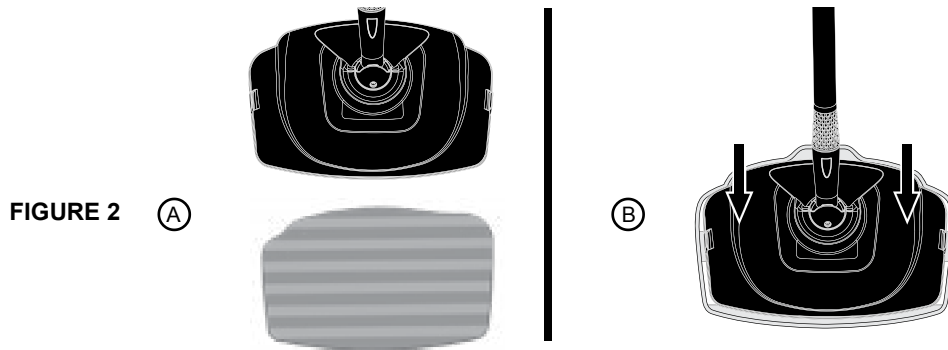

The Mop Head and Microfiber Pads are perfect for use on these hard floor surfaces:

- Sealed Hardwood
- Sealed Laminate
- Glazed Ceramic
- Marble
- Tile
- Stained Concrete
- Linoleum
- Granite
- Vinyl

IMPORTANT: Do not use on unsealed hardwood or unglazed ceramic surfaces. Surfaces that are not properly sealed may be warped or damaged by exposure to heat and moisture.

Care should also be taken when steaming sealed hardwood floors, as prolonged exposure to steam in a single spot may cause damage and discoloration. To avoid this, keep the Mop Head in constant motion on these surfaces.

Steam may remove the sheen from some floors that have been treated with wax.

Extremely rough textured floors may tear or damage Microfiber Pads.

Before steaming any flooring, it is recommended to consult the manufacturer's guidelines. For flooring in question, always test on a small inconspicuous area before proceeding.

STEAM CLEANING ACCESSORIES

WARNING: Do not connect accessories while unit is emitting steam.

JET NOZZLE / SCRAPER / TRIANGLE BRUSH

1. Select Jet Nozzle and push onto the Steam Nozzle (A).
2. Rotate accessory until the yellow lock/release button snaps into the accessory hole (B).

NOTE: The Jet Nozzle can be connected to the end of an Extension Wand for reaching high or difficult spots. Connect the Extension Wand (or Wands) as outlined on Page 8, then connect your Jet Nozzle to the Wand in the same way as you would normally connect to the Steam Nozzle.

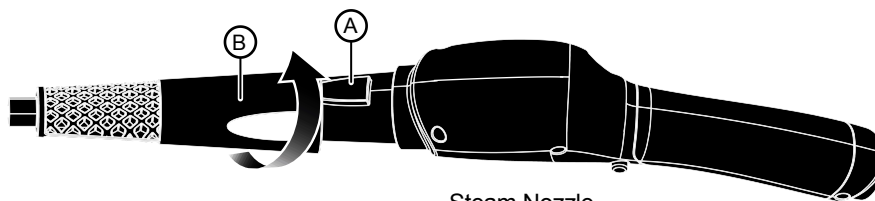

Steam Nozzle

UTILITY BRUSHES / ANGLED NOZZLE

NOTE: Accessories connect to the Jet Nozzle, not the Main Nozzle.

1. Firmly press accessories onto tip of Jet Nozzle. Press it on as far as possible to prevent steam leakage.
2. To remove accessories, simply grip it firmly and pull it off Jet Nozzle.

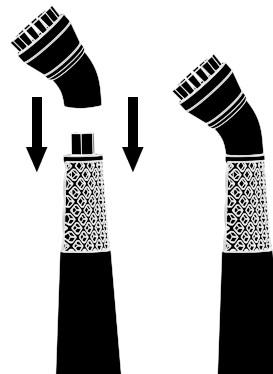

Jet Nozzle / Angled Nozzle	Dirt, Grease, Grime, Cracks and Crevices, Golf Clubs, Tread of Running Shoes
Triangle Brush	Corners on Countertops, Bathtubs, Floors
Scraper	Baked on Food, Grime, Grease, Stove Tops, Ovens
Nylon Utility Brush and Round Brush	Ovens, Stove Tops, Faucet Fixtures, Microwaves, Sports Equipment, Tile, Grout, Refrigerators, Toys, Door Knobs, Showers, Bathtubs, Changing Tables
Brass Utility Brush	BBQ Grills, Oven Wire Racks
Mop	Stone, Slate, Glazed Ceramic Tile, Sealed Hardwood

NOTE: Before cleaning electrical appliances, check and follow appliance manufacturer's cleaning guidelines. Never apply to electrical parts.

NOTE: Some delicate surfaces, such as painted wood or stainless steel may be scratched or damaged by the bristle of the brushes, especially the Brass Utility Brush. Use careful judgment when deciding what surface to clean with any of the brushes. If you are unsure if a surface will be damaged, it is recommended that you test a small inconspicuous spot before proceeding.

FILLING BOILER

1. Place unit on a flat, level surface.
2. Make sure illuminated On/Off Switch is turned to "Off" and grounded power cord is unplugged from electrical outlet.



If unit has been in use, always use the following safety precautions before removing the Boiler cap to add water:

- Allow unit to cool for 20 minutes or until pressure gauge is at zero.
- Press and hold Steam Trigger to release **ALL** remaining steam.

WARNING: Failure to follow these precautions may result in burns from escaping steam when the Boiler Cap is removed.

3. Cautiously unscrew and remove Boiler Cap.

WARNING: Water may be hot.

4. Drain any water remaining inside Boiler.

NOTE: The Boiler should be emptied after each use – this will help minimize mineral build-up and prevent over-filling.

5. Using the Fill Cup, fill the unit with 48 oz (1,420 ml) of water.

NOTE: In order to significantly reduce mineral build-up and prolong the life of your Heavy Duty Steam Cleaner, use of distilled or de-mineralized water in the unit is highly recommended. Refer to Page 13 for more information about mineral build-up.

WARNING: Caution should always be used when pouring water into the Boiler. Do not look directly down into fill hole when filling. Keep your free hand and any children or pets at a safe distance.

6. Replace Boiler Cap, ensuring that it is screwed on tightly to prevent hot steam from escaping and causing injury.

GENERAL OPERATION

NOTE: Be sure that Boiler has been filled and that all desired accessories are connected before following these steps.

1. For first time use, remove protective plastic cover from electrical plug. Plug power cord into a electrical outlet.
2. Switch Lighted On/Off Switch to “On” position.
3. The pressure gauge indicates the operating pressure of the steam cleaner. Once the needle is in the green section, the unit is ready to begin steaming.

During use and as steam is released, pressure will drop. This may cause the needle to move down in the green section. This is a normal condition. As long as the needle is in the green section, the product is operating normally. If the needle is continuously in the yellow or red section, please contact Consumer Service at 1-800-711-6617.

4. Direct Nozzle (and any connected accessory) towards surface you desire to steam, and press Steam Trigger. To sanitize surfaces, point Nozzle, press Trigger and hold approximately 1/2 inch from surface for at least 5 seconds. This will insure that you have killed germs and bacteria.

CAUTION: Always be sure that Nozzle and any accessory are pointed in a safe direction (away from yourself, other people, pets, and plants) before pressing Steam Trigger.

5. Keep Steam Trigger pressed for a continuous flow of steam. You may also hold the Steam Trigger, then push the Steam Trigger Lock to lock it down. This will allow a continuous flow of steam without need of holding the Steam Trigger down manually. Steam output can be adjusted by simply turning the Steam Adjustment Knob.
6. Using a back-and-forth motion over the area you are steaming will further enhance the cleaning process. Wipe steamed areas with a clean cloth to remove loosened dirt and grime. Wiping the area while it is still wet is recommended, but use caution when wiping surfaces such as metal that may still be hot.
7. Once steaming tasks are complete, turn the unit “Off” and unplug. Follow steps under Proper Storage procedure on Page 13 of this manual.

STEAM MOPPING

NOTE: Be sure that Boiler has been filled and that all steam mopping accessories are connected before following these steps.

It is recommended to sweep or vacuum hard floors before mopping.

1. Follow Steps 1-3 of General Operation section above.

Refer to Page 9 for a listing of hard floor surfaces that are recommended for cleaning with the Heavy Duty Steam Cleaner.

2. For best results, use a continuous back-and-forth motion over floor surface, pushing the Mop Head away and pulling it back towards you. Work your way backwards over the floor, in order to avoid walking over freshly mopped areas.

NOTE: To avoid warping or damage caused by heat and moisture, do not use on unsealed hardwood or unglazed ceramic surfaces. Steam may remove the sheen from some floors that have been treated with wax.

3. The Microfiber Pad will absorb dirt and moisture during mopping. However, when you are finished you may find some residual moisture has been left behind. In this case, it is recommended to allow floor time to air-dry. A fan may be directed towards mopped area to facilitate drying.

PROPER STORAGE

Preparing your Heavy Duty Steam Cleaner for storage is quick and simple. When you have finished your steaming tasks, follow the steps listed below.

1. Turn unit "Off" and unplug power cord.
2. Allow unit to completely cool (at least 30 minutes).
3. Press and hold Steam Trigger to release all remaining steam.
4. Remove all accessories from unit.
5. Carefully remove Boiler Cap.
6. Drain any remaining water from Boiler into a sink or tub – this will help to minimize mineral build-up and prevent over-filling during your next use. Replace Boiler Cap loosely.
7. Store accessories. Utility Brushes can be conveniently stored in the Accessory Net. Remaining accessories can be stored in the Storage Bag.
8. Store Canister Steam System in a cool, dry location.

MINERAL BUILD-UP

A common maintenance need for steam appliances is the removal of build-up caused by high mineral content in many municipal water supplies. This mineral build-up may limit the effectiveness and reduce the life of your Heavy Duty Steam Cleaner.

The best way to minimize mineral build-up is to use distilled or de-mineralized water when using your Heavy Duty Steam Cleaner. If you are unable to use distilled water, it is recommended that the following procedure be followed monthly to remove any mineral build-up:

1. Turn unit "Off" and unplug power cord.
2. Allow unit to completely cool (at least 30 minutes).
3. Press and hold Steam Trigger to release all remaining steam.
4. Remove all accessories from unit.
5. Carefully remove Boiler Cap.
6. Drain water from Boiler into a sink or tub.
7. Slowly pour 8 oz of vinegar into Boiler.
8. Allow to stand for 40 minutes.
9. Drain vinegar from Boiler.
10. Rinse Boiler with fresh water, drain and repeat until vinegar odor dissipates.

PROBLEM	POSSIBLE CAUSE	SOLUTION
Unit fails to heat up	Unit is not plugged in.	Plug power cord into electrical outlet.
	Household circuit breaker / ground fault interrupter has tripped or blown a fuse.	Reset circuit breaker / ground fault interrupter, or replace fuse. If you need assistance, contact a licensed electrician.
	Unit is damaged or otherwise in need of repair.	Immediately cease usage and unplug. Contact Consumer Service for further assistance (see Page 15 for details).
	Boiler is empty.	Refer to Filling Boiler procedure on Page 10.
	Mineral build-up in unit.	Refer to Mineral Build-up section on Page 13 for cleaning procedure.
Steam output is weak or intermittent.	Water level in Boiler is running low.	Refer to Filling Boiler procedure on Page 10.
	Mineral build-up in unit.	Refer to Mineral Build-up section on Page 13 for cleaning procedure.
Excessive amount of water in steam. NOTE: Unit produces wet steam – it is normal for steam to contain some amount of water.	Water condensation in Steam Hose.	Point nozzle towards sink, tub or ground and shake while pressing Steam Trigger. Continue until excess water is released.
	Boiler has been overfilled.	Filling the Boiler with more than 48 oz. (1,420 ml.) of water interferes with steam production, resulting in water condensation in steam. Always fill unit with correct amount of water. (see Page 10 for details)
Accessories do not stay firmly connected to Steam Nozzle.	Accessories not properly installed.	Check to make sure that accessories are properly connected, per procedures on Pages 8.
Floor surfaces appear cloudy or streaky after steaming.	Microfiber Pad is dirty.	Replace Microfiber Pad with a clean one.
	Hard water residue on floor.	Switch to distilled or de-mineralized water.



Product Support

CONSUMER SERVICE

For problems with your Heavy Duty Steam Cleaner, please refer to the troubleshooting guide located on Page 14 of this manual. Additional inquiries should be directed to our consumer support services through our Web site, poulanprosteam.com.

If you do not have internet access, you may also contact our Consumer Service Department by telephone, at **1-800-711-6617**.

NOTE: In order for our Consumer Service representatives to help you as quickly and efficiently as possible, please have the following information ready before calling:

- **Purchase information (where and when you purchased this product)**
- **Copy of purchase receipt / proof of purchase**
- **Product serial number (located on electrical specification label on bottom of unit)**

For information regarding your 2 year limited warranty, refer to Pages 15-16 of this manual.

ORDERING ACCESSORIES & PARTS

Replacement accessories and parts for your Heavy Duty Steam Cleaner (PP350) may be ordered through our Website:

poulanprosteam.com

You may also contact Consumer Service directly:
help@poulanprosteam.com or 1-800-711-6617



Warranty Information

2-YEAR LIMITED WARRANTY

What is covered

Poulan Pro® is a licensed brand of Steamfast, a division of Vornado Air, LLC ("Steamfast"). Subject to the terms and conditions of this 2-Year Limited Warranty ("Warranty") as set forth below, Steamfast warrants to the original consumer or purchaser ("Buyer") that this Poulan Pro®-branded steam product, excluding all accessories and attachments, (the "Product") is to be free from defects in material and workmanship for a period of two (2) year from the date of purchase when used and maintained in accordance with the Owner's Guide (the "Warranty Period").

In the event Buyer notifies Steamfast of a defect in the Product within the Warranty Period, Steamfast will replace the Product and/or defective component parts, as applicable and necessary. Any such replacement will be made at no charge to Buyer for parts or labor, provided that Buyer shall be responsible for all shipping and transportation costs associated with returning the Product to Steamfast for inspection and covered replacement.

What is not covered

This Warranty shall not be applicable to damage or loss caused in whole or in part by:

- Repairs, modifications or alterations to the Product by anyone other than Steamfast.
- Use or operation of the Product outside the permitted or intended uses described by Steamfast in the Owner's Guide, or other careless operation, handling, misuse, or abuse of the Product.
- Lack of proper maintenance or timely cleaning of the Product as specified in the Owner's Guide.

- Use of the Product other than for normal household purposes.
- Normal wear and tear.
- Used consumable parts, accessories and attachments, including, but not limited to, brushes, hangers, scrub pads and mop pads.
- Use of parts and accessories other than those produced or recommended by Steamfast.
- Cosmetic damage, such as scratches, nicks and dents.
- Damage caused by accident, water, flood, fire or other acts of nature or external causes.

Warranty limitations and exclusions

- NO OTHER EXPRESS WARRANTY IS GIVEN BY STEAMFAST TO BUYER AND NO REPRESENTATIVE HAS THE AUTHORITY TO MAKE REPRESENTATIONS OTHER THAN THOSE PROVIDED HEREIN.
- THERE ARE NO WARRANTIES WHICH EXTEND BEYOND THE DESCRIPTION ON THE FACE HEREOF AND ALL IMPLIED WARRANTIES, SPECIFICALLY THE IMPLIED WARRANTIES OF MERCHANTABILITY AND FITNESS FOR A PARTICULAR PURPOSE, ARE HEREBY EXPRESSLY LIMITED TO THE DURATION OF THE WARRANTY PERIOD, UNLESS A SHORTER PERIOD IS PERMITTED BY LAW.
- STEAMFAST'S REPLACEMENT OF THE PRODUCT IS THE EXCLUSIVE REMEDY. UNDER NO CIRCUMSTANCES SHALL STEAMFAST BE LIABLE TO BUYER OR ANY OTHER PERSON FOR ANY INCIDENTAL, SPECIAL, CONSEQUENTIAL, OR OTHER DAMAGES, EVEN IF STEAMFAST HAS BEEN ADVISED OF OR COULD REASONABLY FORESEE THE POSSIBILITY OF SUCH DAMAGES, INCLUDING, BUT NOT LIMITED TO, LOSS OF PROFITS OR DAMAGE, WHETHER ARISING OUT OF BREACH OF WARRANTY, BREACH OF CONTRACT OR UNDER ANY OTHER THEORY OF LAW.
- THIS WARRANTY GIVES BUYER SPECIFIC LEGAL RIGHTS. BUYER MAY ALSO HAVE OTHER RIGHTS WHICH VARY FROM STATE-TO-STATE. SOME STATES DO NOT ALLOW THE EXCLUSION OR LIMITATION OF INCIDENTAL OR CONSEQUENTIAL DAMAGES, AND SOME STATES DO NOT ALLOW LIMITATIONS ON HOW LONG AN IMPLIED WARRANTY LASTS, SO THE ABOVE LIMITATION OR EXCLUSION MAY NOT APPLY TO BUYER.

How do you register the Warranty

Buyer must complete an application to register this Warranty within sixty (60) days following date of purchase. Buyer may either visit Steamfast's website at www.Poulan Prosteam.com and complete an online application or mail a completed application to Steamfast. Failure to register this Warranty within sixty (60) days following date of purchase will render this Warranty null and void.

Warranty service

For warranty service, call 1-800-711-6617 or email consumerservice@steamfast.com to obtain a Return Authorization ("RA") form. Include the Product model number and serial number, as well as Buyer's name, address, city, state, zip code and phone number when contacting Steamfast for warranty service. Buyer may be required to provide the original sales receipt for purposes of verifying date of purchase. After receiving the RA form, the Product must be shipped, postage prepaid by Buyer, to:

Steamfast
Attn: Warranty & Repair
415 E. 13th Street
Andover, KS 67002

To assure proper handling, packages must be clearly marked with the RA number. Packages not clearly marked with the RA number may be refused at the receiving dock.

Important: After receiving return authorization, carefully pack the Product to avoid damage in shipping. Damage in shipping is not covered by the Warranty and shall be the sole responsibility of Buyer. Damage or loss not covered by this Warranty or occurring outside the Warranty Period will require a fee to cover the cost of handling and shipping. All such fees and costs shall be the sole responsibility of Buyer.

Please allow at least 1-2 weeks for return of the Product after it is received by Steamfast. For ease of recordkeeping, it is recommended that Buyer staple or attached the original sales receipt to this Owner's Guide and record the Product serial number (located on the Product specifications decal) here:

POULAN PRO[®]

Poulan Pro

415 East 13th, Andover, KS 67002

1-800-711-6617 | poulanprosteam.com | help@poulanprosteam.com

T350-005 R-, V00