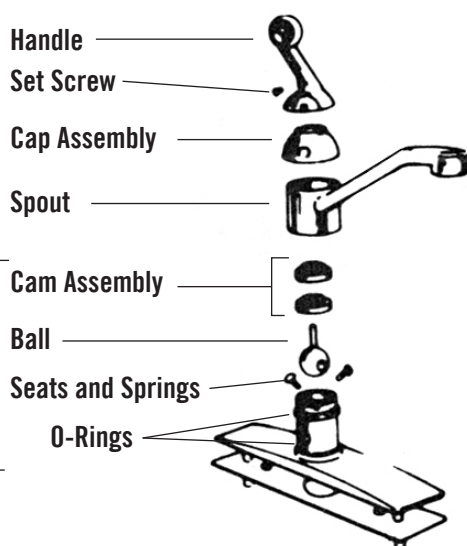

Tools Required:

Screwdriver
Pliers
Needle Nose Pliers
Allen Wrench
Plumbers Grease

REPLACES #RP77738, WITH #70 STAINLESS STEEL BALL**Installation Instructions:**

1. Turn off water supply to the faucet. Once the water supply is shut off, turn the faucet on to release water pressure, then turn the faucet off.
2. Remove the Handle. For Metal Handle: use an allen wrench to loosen Set Screw and lift Handle off valve.
(For Acrylic Handle: Pry off Index Button, remove Screw and pull Handle from the valve.)
3. Remove Cap Assembly (Cap and Cap Adjusting Ring) by using pliers and turning counter-clockwise to loosen.
4. Remove old Faucet components:
 - a. Remove old Cam Assembly and Ball.
 - b. Remove old Seats and Springs, using needle nose pliers. Remove any debris from the valve.
 - c. Remove old O-Rings. For Kitchen Faucets: Remove the Spout by pulling up to remove from valve. Cut off old O-Rings.
5. Install new Repair Kit components:
 - a. Replace O-Rings on valve. (Add Plumbers Grease to O-Rings.)
 - b. Install new Seats over Springs by inserting into both the hot and cold sides of the valve. (Narrow part of Spring faces up, with Seat on top of Spring. The flared end of the Seat faces down.)
 - c. Install new Ball by inserting into valve and lining up with notch inside valve.
 - d. Install new Cam Assembly (Cam and Washer) over Ball.
6. Reinstall the Faucet components: Cap Assembly and Handle.
 - a. Place Cap Assembly over Cam, threading onto the valve and tighten with pliers.
 - b. Metal Handle: Place Handle in position and secure with Set Screw.
Acrylic Handle: Place Handle in position, secure with Screw and press on Index Button.
7. Turn on water supply and check for leaks. Tighten Cap Adjusting Ring to stop any leakage.

**Single Lever Kitchen Faucet
(with Metal Handle)****Single Lever Lavatory Faucet
(with Acrylic Handle)**