

**WOODSTAKE WAGON
#F410 "BERLIN SPORT"
ASSEMBLY INSTRUCTIONS**

** For step-by-step instructions with color photos,
go online to www.berlin-flyer.com , click on
"Instructions" and then your wagon model.

- 1) Invert wagon body (17) on table or bench with rear section extending over the edge. Rear section has the four hole drilling. Place rear wheel assembly (14) in place and fasten with 1" truss head bolts (18), and lock nuts (4). Position rear braces (13) over axle and fasten with 1" truss head bolts (18) and lock nuts (4).
- 2) Reverse wagon position so that front section extends over table. Position front axle assembly (23) and fasten with 1" truss head bolts (18) and lock nuts (4). Fasten front center brace (12) in rear center hole of front section with 1" truss head bolts (18) and lock nut (4). **BE SURE TO USE END WITH 1/4" HOLE ON THE FRONT CENTER BRACE WHEN FASTENING TO THE WAGON BODY. 5/16" HOLE GETS FASTENED TO NOSE PIECE.**
- 3) Turn body right side up. Fasten nose assembly (3) to front axle assembly (23) with 5/16" x 1" Hex head machine bolt (21) and lock nut (5). Putting bolt through front center brace (12), then through front axle assembly (23), then through nose (3). ****SEE BELOW**
- 4) Position axle steering arms (22) and (10) in front axle assembly (23), axle pointing toward the side of the wagon, arms pointing toward the rear of the wagon. Fasten rear steering cross bar (6) to nose piece (3) and steering arms (22) and (10) with 1/4" x 5/8" Hex head machine bolts (11) and lock nuts (4). ****SEE BELOW**
- 5) Place 1/2" SAE washers (9) over front axles, then wheels (8), then push nuts (7). **** NO WASHERS ON REAR AXLE ****
- 6) Fasten steering tube (1) to nose assembly (3) with 1/4" x 2 3/4" machine bolt (2) and lock nut (4).
- 7) Assemble racks (19) as shown.

****LOCK NUTS USED IN ITEMS 3, 4, AND 6 SHOULD NOT BE OVERTIGHTENED. STEERING MECHANISM MUST TURN FREELY! LOCK NUTS USED ON WAGON BOTTOM CAN BE TIGHTENED UNTIL SNUG. DO NOT PULL BOLTS THROUGH WAGON BOTTOM.**

****KEEP TIRES PROPERLY INFLATED AT ALL TIMES**

****PUT SEVERAL DROPS OF OIL ON AXLES AND ON ALL MOVING PARTS AS YOU ASSEMBLE.**

ILLUS. NO.	PART NO.	NO. REQ. FOR ASSEMBLY	DESCRIPTION
1.	F-329	1	Steering Tube
2.	F-328	1	Machine Bolt 1/4 x 2 3/4"
3.	F-332	1	Front Nose Assembly
4.	F-325	11	Lock Nuts 1/4"-20
5.	F-326	2	Lock Nuts 5/16"-18
6.	F-334	1	Rear Steering Cross Bar
7.	F-320	4	Hub Caps (Push Nuts)
8.	F-430	4	Wheels
9.	F-341	2	Flat Washer 1/2" SAE
10.	F-431	1	Right Axle Steering Arm
11.	F-324	3	Hex Head Machine Bolts 1/4 x 5/8"
12.	F-335	1	Front Center Brace
13.	F-337	2	Rear Braces (FITS EITHER SIDE)
14.	F-336	1	Rear Wheel Assembly
15.			
16.			
17.	F-438	1	Body
18.	F-321	7	Truss Head Bolts 1/4 x 1"
19.	F-339	6	Racks
20.			
21.	F-327	1	Hex Head Machine Bolt 5/16 x 1"
22.	F-442	1	Left Axle Steering Arm
23.	F-333	1	Front Axle Assembly
24.	F-344	12	Stake Pockets (attached to body)

!!!WARNING!!!
SMALL PARTS USED FOR
ASSEMBLY POSE A CHOKING
HAZARD AND SHOULD BE
KEPT OUT OF REACH OF
CHILDREN.
ADULT ASSEMBLY REQUIRED

Tools required for assembly:
- Flat end screwdriver
- Two 7/16" wrenches
- Two 1/2" wrenches
- Hammer
- Pliers

Manufactured by:
Berlin Wood Products, Inc.
5039 CR 120
P.O. Box 184
Berlin, OH 44610
(330) 893-3281

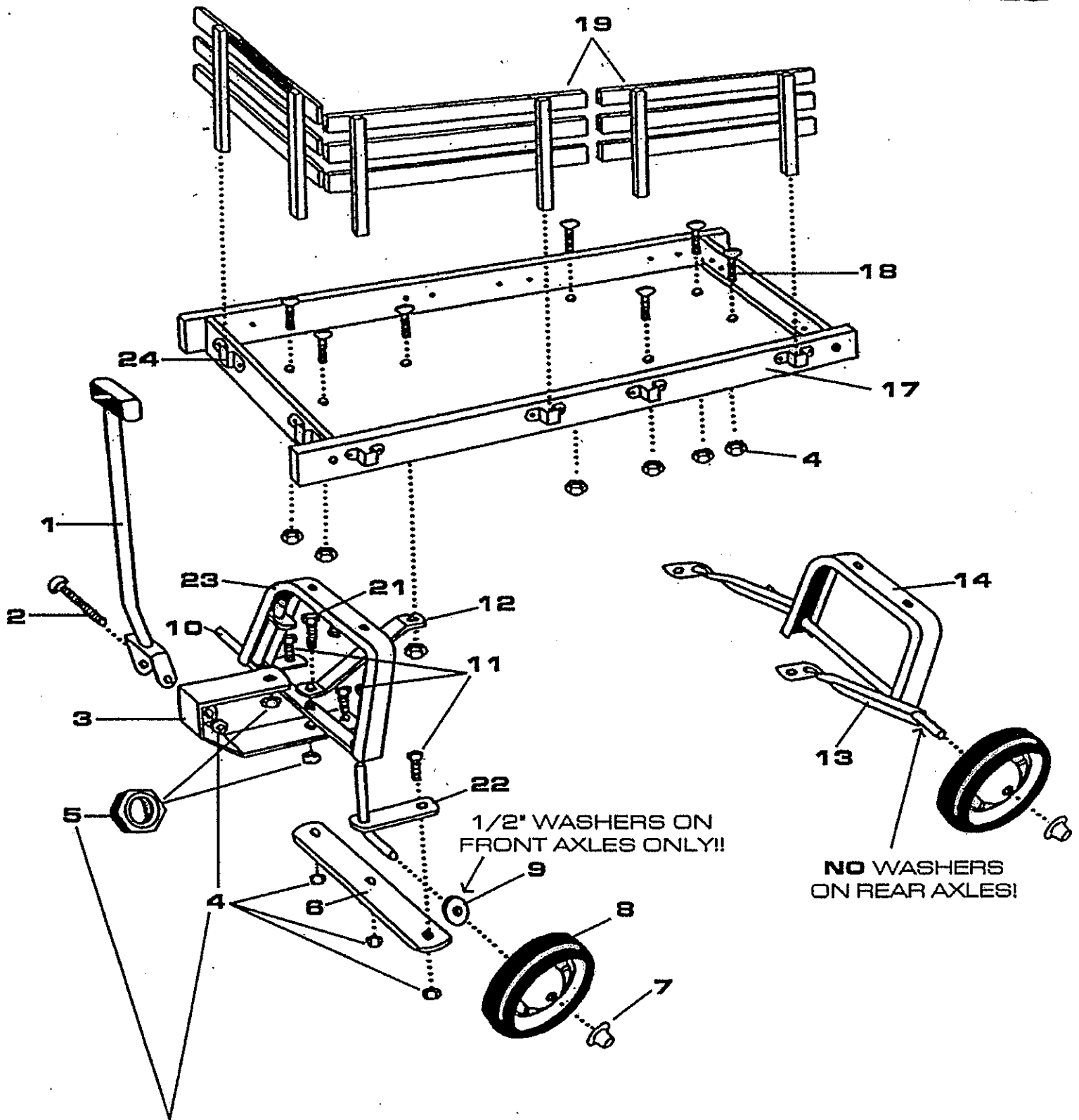

NOTE: USE THE STOVER LOCK NUT.

WARNING

NO-TIP® Steering is a registered trademark for a design intended to reduce the incidence of tipping, compared with that experienced with traditional steering mechanisms in most children's toy wagons. Tipping of this wagon can result even with NO-TIP® Steering if the wagon is operated at an excessive rate of speed, turned suddenly, or operated on sloping ground. Care should be exercised in the use of any toy wagon, and children should be properly instructed in the safe operation of this wagon. Younger children should be supervised at all times while using this wagon.