



Instruction Manual

Item# FT973615/FT973615BE/FT973615GR



Having Trouble?

Chat with us on your phone

Simply point your phone camera towards the QR code or see our website



xbrand.us

or email at

customerservice@ecintel.com

Monday - Friday 7:00AM - 3:30PM PST

BIRDBATH FOUNTAIN



Have Questions or Issues? Need help with assembly?

Contact us and we will resolve immediately.

Simply point your phone camera towards the QR code or see our website

Support Hours M-F 7:00AM - 3:30PM (U.S Pacific Time)



Chat with us:
xbrand.us



Email:
customerservice@ecintel.com



Call:
951-319-4433

Purchased your product online?

We would really appreciate it if you can share your experience with others by reviewing our product on the website from which you purchased.



Limited 1-Year Manufacturer Warranty on xbrand.us

Manufacturer warranty covers:

- Parts that are deemed defective within 30 days will be shipped free of charge, within the 48 contiguous states.
- Any warranty claim after 30 days, will require shipping to be paid by the customer.

Any visible damage due to the neglect, misuse, or abuse will void the limited warranty of the product.

For further information, please contact us:

Chat with us: xbrand.us



Simply point your phone camera towards the QR code or see our website

Email: customerservice@ecintel.com

Purchased your product online?

We would really appreciate it if you can share your experience with others by reviewing our product on the website from which you purchased.



Please use your smart phone camera to scan the QR code.
Simply point your camera and let the camera scan the
code below, and click on the link that opens up.

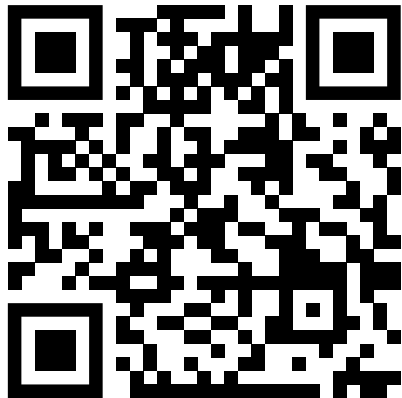

<https://xbrand.us/product/FT973615/>

Contents 2

What is included 3

Assembly instructions 4

YouTube video instruction 5

Warranty 6

What is included



A. Lower Base



F. Medium Base



G. Small Base



x2 Splash Guard

H. Small Bowl



I. Hose



B. Large Bowl



E. Medium Bowl



D. Door to the Pump



C. Auto Shut Off Pump



https://www.youtube.com/watch?v=3_Eyl6X-Qoc

Assembly instructions

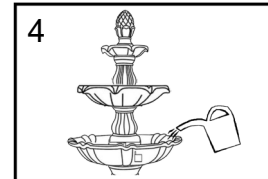
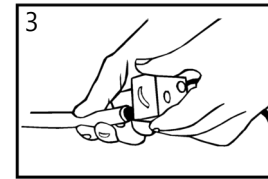
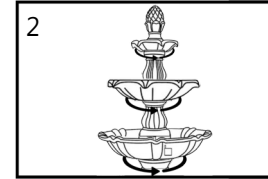
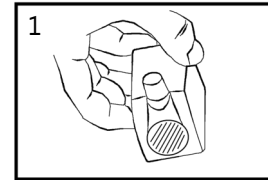

1. Easily adjustable water flow with Auto Shut-off Pump.
2. Using twisted motions connect each part of the fountain body.
3. Connect the Hose with the water pump.
4. Submerge the water pump with water and enjoy the waterflow.

Note: Make sure the pump is submerged in water at all times. If the water level drops, the pump will overheat and burn out. To avoid pump burn out, refill the water every 48 hours.

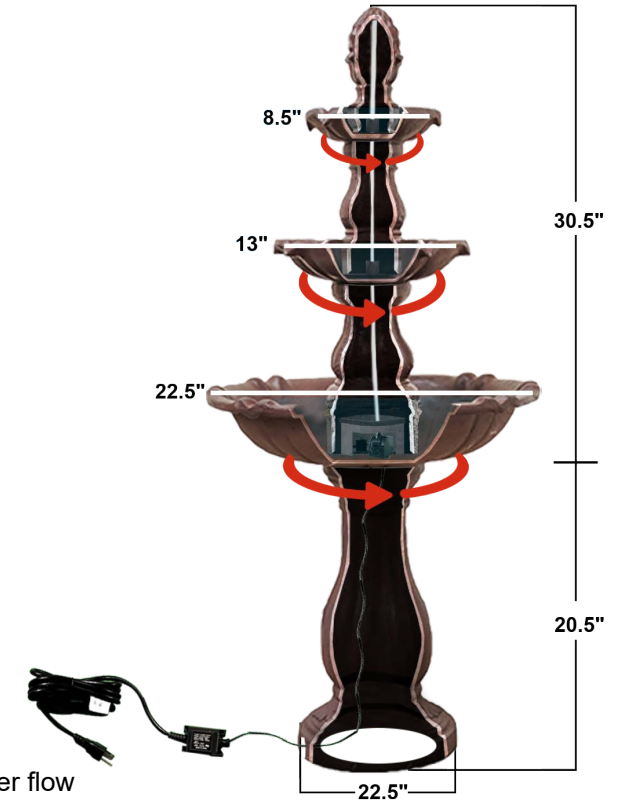

Scan the QR code for detailed instructions

<https://xbrand.us/product/FT973615/>