

MAGIC MESH®

Hands-Free Screen Door Installation Instructions

IMPORTANT: Before hanging, ensure that the surface is clean of dirt and debris.

SINGLE DOORS:

Determine the proper direction to install the screen:

- If your door opens IN, install on the OUTSIDE of the door frame.
- If your door opens OUT, install on the INSIDE of the door frame.

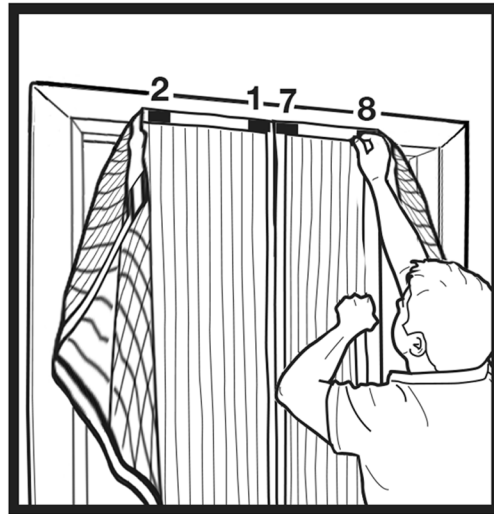

5. Repeat for hook and loop strips #2 and #8. Hold for 30 seconds.
Note: Be sure to hang the screen high enough so that it does not drag on the ground.

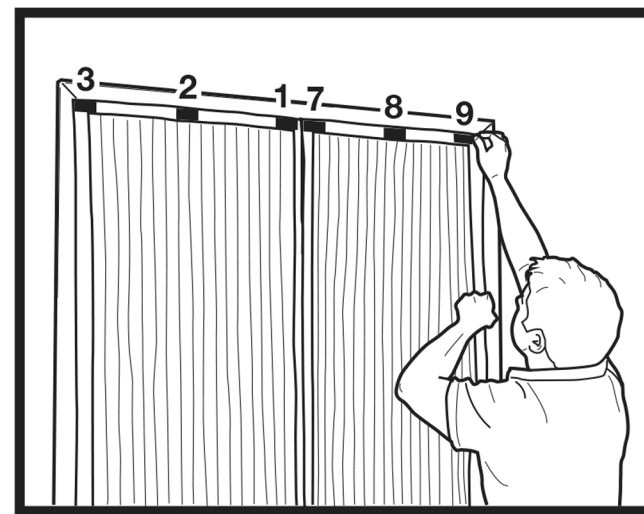

6. Repeat for hook and loop strips #3 and #9.
Note: Do not apply the hook and loop strips to the screen on the sliding screen door. Always attach and secure to the solid door frame surface.

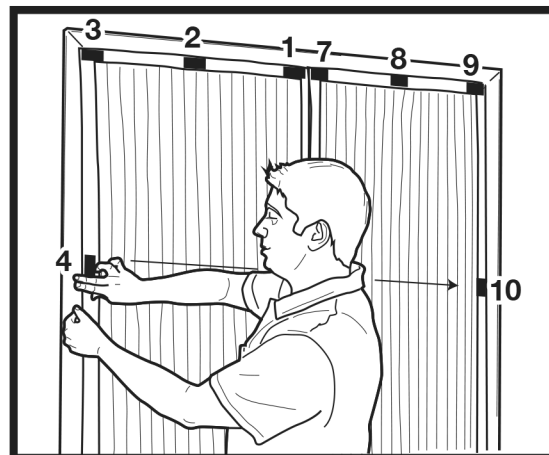

7. Attach the rest of the hook and loop strips row by row: #4 & #10, #5 & #11 and #6 & #12.

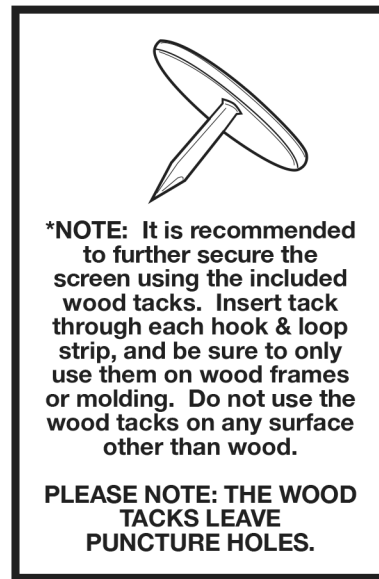
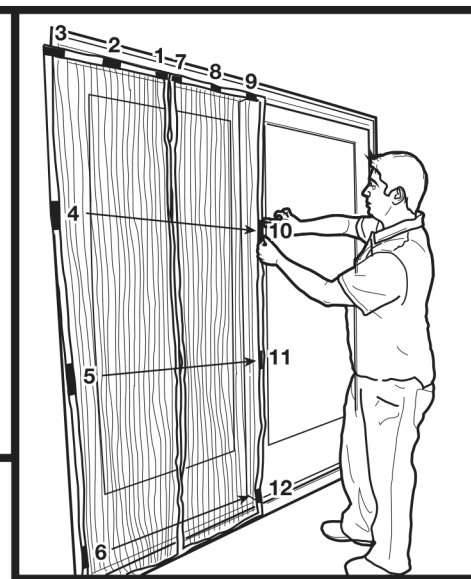

Helpful Tips & Troubleshooting:

Do not attempt to attach the wood tacks to glass, vinyl, or aluminum siding or to the door/door frame. They should only be used for wooden frames or walls.

Cleaning and Storage:

- Do not use any harsh abrasive cleaners on this product.
- Wipe off the mesh with a damp, lukewarm cloth. For stubborn dirt, you can spot clean with a small amount of soap and a cloth. Allow the mesh to air-dry.
- Do not put in a dryer. Do not dry clean.

Important Safety Instructions

- Keep children away from the packaging material and the storage bag. There is danger of suffocation.
- Maintain an adequate distance from heat sources such as stove tops, ovens, or BBQ grills.
- Because of possible electromagnetic interference, people with implanted medical devices (e.g. pace makers) should consult their doctor before using.
- Take extra caution when using wood tacks. Keep away from children.
- Product may not function properly if not installed correctly.

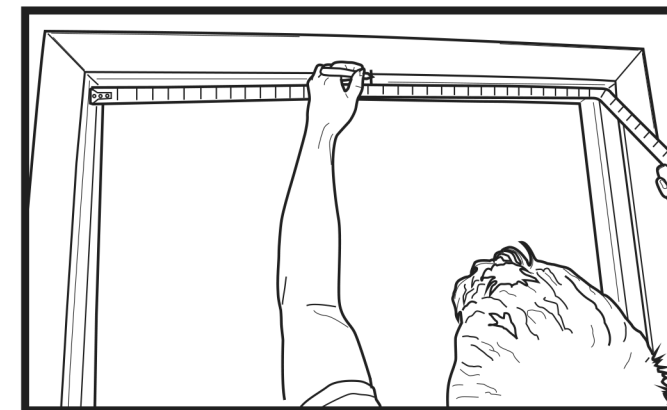

1. Find and mark the center of the top of your door frame.

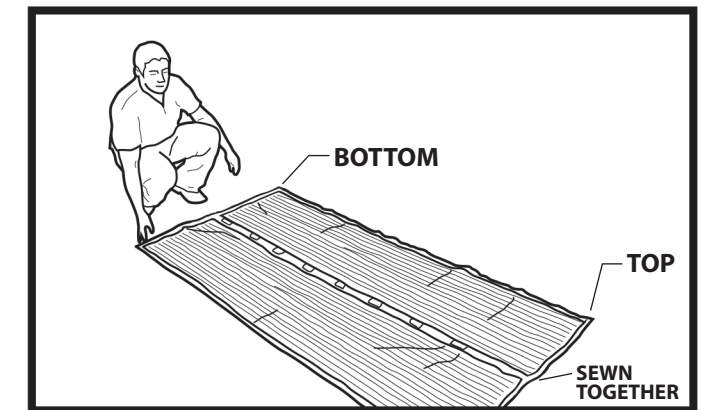

2. Lay your Magic Mesh® Screen flat on the floor with the magnets aligned in the center. **Note:** The top of the panel will have a larger gap between the magnets and the trim versus the bottom of the panel. The top strip of the panel is where side A and B are sewn together.

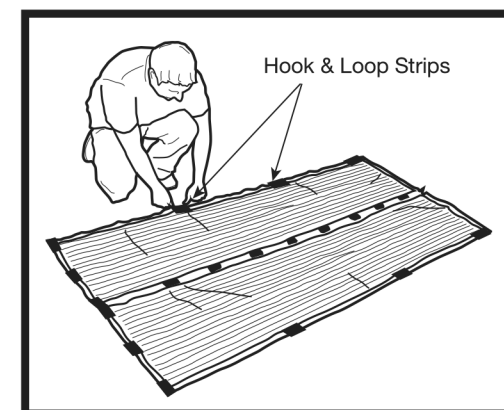

3. Peel the adhesive backing off of the hook and loop strips and apply to the Magic Mesh® Screen according to FIGURE 1.

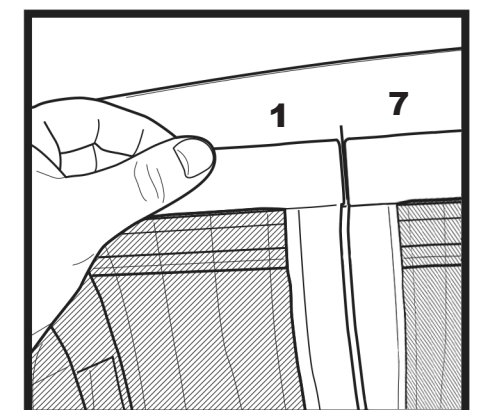
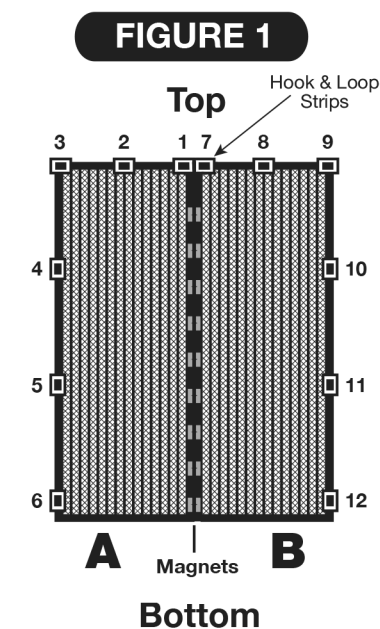

4. Take Panel A and peel off the adhesive backing of hook and loop strips #1 and #7 then apply them to the center of the door frame with pressure. Hold for 30 seconds. **Note:** Be sure to hang the screen high enough so that it does not drag on the ground.

©2016 APG
All Rights Reserved.
Magic Mesh is a registered trademark of APG.

Distributed By:
Allstar Products Group
Hawthorne, NY 10532