

# **WARNING**

**Read This Manual  
BEFORE Operating This Tool**



## **OPERATOR'S MANUAL For Quik Stik™ Rafter and Truss Fastening System**



# TABLE OF CONTENTS

Introduction .....	3
Safety .....	4
Limited Warranty .....	5–7
Quik Stik™ Diagram .....	8
Installation and Replacement of the Driver Bit .....	9
Drill/Driver Attachment .....	9
Bubble Level Attachment .....	10
Loading the Quik Stik System.....	10
Screw Driving Tips.....	11–12
Removing a Screw .....	12
Choosing Installations.....	13–17
a. Installation 1: Rafter/Truss Offset from Stud: Fasten Straight Up Through Double Top Plate .....	13
b. Installation 2: Rafter/Truss Offset from Stud: Fasten from Front- Bottom Corner of Double Top Plate .....	14
c. Installation 3: Rafter/Truss Aligned with Stud or Slightly Offset: Fasten from Wide Face (Side) of Stud .....	15
d. Installation 4: Rafter/Truss Aligned with Stud or Over a Window/Door Header: Fasten from Narrow Face of Stud .....	16
e. Installation 5: Rafter/Truss Aligned with Stud: Fasten from Corner of Stud .....	17
Care and Maintenance .....	18

## INTRODUCTION



Introducing the new standard for overhead fastener installations of rafter and truss assemblies. The Simpson Strong-Tie® Quik Stik™ rafter and truss fastening system provides a versatile solution that makes fastening rafter and truss connections faster, safer and easier. No ladders, nail guns or compressors needed. The Quik Stik installation system is lightweight and easy to use without formal training or certification. Quik Stik system is compatible with most drills — even cordless models. This adaptability to your existing tools enhances the efficiency and cost-effectiveness of the Quik Stik solution.

The Quik Stik fastening system is designed to drive the 6" Simpson Strong-Tie Strong-Drive® SDWC Truss screw (SDWC15600) to fasten wood rafters and trusses to the top plates of wood frame walls. It is not designed to drive collated fasteners or any other type of screw.

This manual provides instruction for the operation of the Quik Stik tool when installing a Strong-Drive SDWC Truss Screw. For more details about the SDWC Truss screw, installation details and installations with multiple SDWC Truss screws, see the F-F-SDWC18 product flier at **[strongtie.com](http://strongtie.com)**.

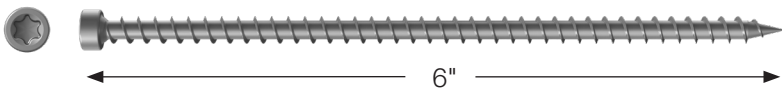

The SDWC Truss screw is a structural screw with a fully threaded shank for a secure connection. The SDWC Truss screw has been tested in accordance with ICC-ES AC233 (screw) and ICC-ES AC13 (wall assembly and roof-to-wall assembly) for uplift and lateral loads between wall plates and vertical wall framing, and between the top plate and the roof rafters or trusses.

## SAFETY

**CAUTION:** Safety and operation of the drill motor are not considered in this manual. See the operating and safety instructions for the drill motor used with the tool for drill motor capabilities and operation.

Study this manual before operating the tool and understand the safety warnings and cautions. Keep the manual with the tool for reference.



**CAUTION:** Eye protection that conforms to ANSI Z87.1 and provides protection against flying particles both from the front and the side should be worn by the operator and others in the work area when loading, operating and servicing the tool. Eyewear without side shielding does not provide adequate protection.



**CAUTION:** Additional safety protection will be required in some environments. Stay alert.

- The work area may include exposure to falling objects that could cause head injury.
- Noise levels could lead to hearing damage.
- Sharp objects could cause hand injury.
- A tripping hazard may be present if electric extension cords are being used.
- Dress appropriately when using the tool.



### ADDITIONAL SAFETY WARNINGS

- Keep work area clean and well lit.
- Do not operate Quik Stik™ system in dangerous environments.
- Do not use Quik Stik system in wet or damp locations.
- The use of Quik Stik system can cause sparks; do not use in the presence of flammable liquids, dust or gases.
- Guard against electrical shock.
- Never modify a power tool plug, and always use a plug with a matching outlet.
- Keep cords away from physical hazards and replace damaged cords immediately.
- When operating electrical tools outside, use extension cords suitable to exterior use.

## LIMITED WARRANTY

This Limited Warranty applies to all Simpson Strong-Tie Quik Stik™ products other than bits (a “Quik Stik Product”). All future purchases of Quik Stik Products are subject to the terms of the Limited Warranty in effect as of the purchase date. All other Simpson Strong-Tie products have a separate Limited Warranty applicable to such products. Please consult **[strongtie.com/limited-warranties](http://strongtie.com/limited-warranties)** for the applicable Limited Warranty.

This Limited Warranty must be read in conjunction with all applicable General Notes, General Instructions for the Installer, General Instructions for the Designer, Building Codes, Corrosion Information, and Terms & Conditions of Sale, along with any other information or specifications published by Simpson Strong-Tie Company Inc. (“Simpson Strong-Tie”) or available on the **[strongtie.com](http://strongtie.com)** website (“Website”) or on the product package, label or product manual. All of this information is referred to collectively as the “Simpson Strong-Tie Documentation.” All applicable Simpson Strong-Tie Documentation must be carefully reviewed each time any Quik Stik Product is used.

Simpson Strong-Tie warrants, to the original purchaser only, that each Quik Stik Product will be free from substantial defects in materials, manufacturing and design for the lifetime of the Quik Stik product, if properly stored, maintained and used in accordance with the Simpson Strong-Tie Documentation. This Limited Warranty is void and does not apply to any (a) Quik Stik Product purchased from an unauthorized dealer, retailer or distributor, (b) Quik Stik Product deterioration or damage due to environmental conditions or inadequate or improper handling, transportation, storage, servicing or maintenance, (c) cosmetic defects, including discoloration, (d) use of a Quik Stik Product in temperatures or environmental conditions outside the ranges specified for such Quik Stik Product in the Simpson Strong-Tie Documentation, (e) normal wear and tear, (f) failure or damage caused by the use of a Quik Stik Product with any fasteners, screws, products or accessories other than authentic Simpson Strong-Tie products, (g) Quik Stik Product that was subjected to negligence or excessive or improper use, including any use not in accordance with the Simpson Strong-Tie Documentation, (h) failure or damage caused by any third-party products, building materials or components, (i) modified Quik Stik Product, or any nonstandard use or application of a Quik Stik Product, (j) failure or damage caused by corrosion, termites or other wood destroying organisms, animal or insect activity, wood fungal decay, rot, mold, mildew, exposure to chemicals or other hazardous substances, a corrosive environment or materials, inadequate moisture protection, or premature deterioration of building materials, (k) failure or damage caused by an act of God, including any hurricane, earthquake, tornado, lightning, ice, snow, high wind, flood or other severe weather or natural phenomena, (l) installation services or workmanship, or (m) failure or damage caused by the gross negligence, willful misconduct, or other acts or omissions of the builder, general contractor, installer or any third party, including the building owner.

Although Quik Stik Products are designed for a wide variety of uses, Simpson Strong-Tie assumes no liability for confirming that any Quik Stik Product is appropriate for an

## LIMITED WARRANTY (CONT.)

intended use, and each intended use of a Quik Stik Product must be reviewed and approved by qualified professionals. Each Quik Stik Product is designed for the load capacities and uses listed in the Simpson Strong-Tie Documentation, subject to the limitations and other information set forth in the Simpson Strong-Tie Documentation.

Quik Stik Product demonstrations, training, operator examinations, technical and customer support and other services provided by Simpson Strong-Tie are based on Simpson Strong-Tie's present knowledge and experience, are conducted for illustrative or instructive purposes only, do not constitute a warranty of Quik Stik Product capabilities, specifications or installation and do not modify the applicable Limited Warranty for Quik Stik Products set forth herein. Any services provided by Simpson Strong-Tie are provided without any representation or warranty of any kind, and Simpson Strong-Tie assumes no liability for any representations or statements made as part of such Quik Stik Product demonstrations, training, operator examinations or other services. In the event of any inconsistency between any information provided during any such demonstration or service, and the information in any applicable Simpson Strong-Tie Documentation, the information in the Simpson Strong-Tie Documentation shall govern. In the event of any inconsistency between any information provided on the Website, and the information in any other Simpson Strong-Tie Documentation, the information on the Website shall govern.

**ALL WARRANTY OBLIGATIONS OF SIMPSON STRONG-TIE SHALL BE LIMITED, AT SIMPSON STRONG-TIE'S ABSOLUTE DISCRETION, TO EITHER REPAIRING THE DEFECTIVE QUIK STIK PRODUCT OR PROVIDING A REPLACEMENT FOR THE DEFECTIVE QUIK STIK PRODUCT. THIS REMEDY CONSTITUTES SIMPSON STRONG-TIE'S SOLE OBLIGATION AND LIABILITY AND THE SOLE AND EXCLUSIVE REMEDY OF PURCHASER AND, WITHOUT LIMITING THE GENERALITY OF THE FOREGOING, EXCLUDES ANY LABOR OR OTHER COSTS INCURRED IN CONNECTION WITH A WARRANTY CLAIM. PURCHASER ASSUMES ALL RISK AND LIABILITY ASSOCIATED WITH ANY USE OF THE QUIK STIK PRODUCT, INCLUDING BUT NOT LIMITED TO SUITABILITY FOR ITS INTENDED USE.**

**THE LIMITED WARRANTY HEREIN IS EXPRESSLY IN LIEU OF ALL OTHER WARRANTIES, AND, WHERE LAWFUL, SIMPSON STRONG-TIE DISCLAIMS ALL OTHER WARRANTIES, INCLUDING BUT NOT LIMITED TO IMPLIED WARRANTIES OF MERCHANTABILITY AND FITNESS FOR A PARTICULAR PURPOSE AND WARRANTIES ARISING FROM COURSE OF PERFORMANCE, COURSE OF DEALING OR TRADE USAGE. IN NO EVENT WILL SIMPSON STRONG-TIE BE LIABLE FOR INCIDENTAL, CONSEQUENTIAL, PUNITIVE OR SPECIAL DAMAGES OR DIRECT OR INDIRECT LOSS OF ANY KIND, INCLUDING BUT NOT LIMITED TO PROPERTY DAMAGE, DEATH AND PERSONAL INJURY. SIMPSON STRONG-TIE'S ENTIRE LIABILITY IS LIMITED TO THE PURCHASE PRICE OF THE DEFECTIVE QUIK STIK PRODUCT. SOME STATES DO NOT ALLOW LIMITATIONS ON HOW LONG AN IMPLIED WARRANTY LASTS, OR THE EXCLUSION OR LIMITATION OF INCIDENTAL OR**

## LIMITED WARRANTY (CONT.)

**CONSEQUENTIAL DAMAGES, SO THE ABOVE LIMITATION OR EXCLUSION MAY NOT APPLY TO YOU. THIS WARRANTY GIVES YOU SPECIFIC LEGAL RIGHTS, AND YOU MAY ALSO HAVE OTHER RIGHTS WHICH VARY FROM STATE TO STATE.**

To obtain warranty service, you must contact Simpson Strong-Tie promptly at **(800) 999-5099** or at Simpson Strong-Tie Company Inc., 5956 West Las Positas Boulevard, Pleasanton, CA 94588, regarding any potential claim, no later than sixty (60) days after you discover the potential claim. Upon request by Simpson Strong-Tie, you must provide Simpson Strong-Tie with proof of purchase and written records evidencing, in reasonable detail, the date and manner of any service or maintenance of the Quik Stik Products, as applicable. Simpson Strong-Tie may, in its absolute discretion, request that you return the allegedly defective Quik Stik Products to Simpson Strong-Tie, in which case Simpson Strong-Tie will issue a Return Materials Authorization (RMA), which must be completed and returned to Simpson Strong-Tie with the Quik Stik Product. Simpson Strong-Tie is not responsible for any costs or expenses incurred in connection with the return of Quik Stik Products to Simpson Strong-Tie, but Simpson Strong-Tie shall bear all costs and expenses incurred in connection with the shipment of replacement Quik Stik Products in the event that Simpson Strong-Tie determines that the Quik Stik Product should be replaced in accordance with this Limited Warranty. If Simpson Strong-Tie elects to repair or replace the Quik Stik Product, Simpson Strong-Tie shall have a reasonable time to do so.

No one is authorized to change or add to this Limited Warranty. If at any time Simpson Strong-Tie does not enforce any of the terms, conditions or limitations stated in this Limited Warranty, Simpson Strong-Tie shall not have waived the benefit of said term, condition or limitation and can enforce it at any time. This Limited Warranty is extended only to the original purchaser and is not transferrable. It is not intended nor shall it be construed to create rights in any third party.

# QUIK STIK™ DIAGRAM

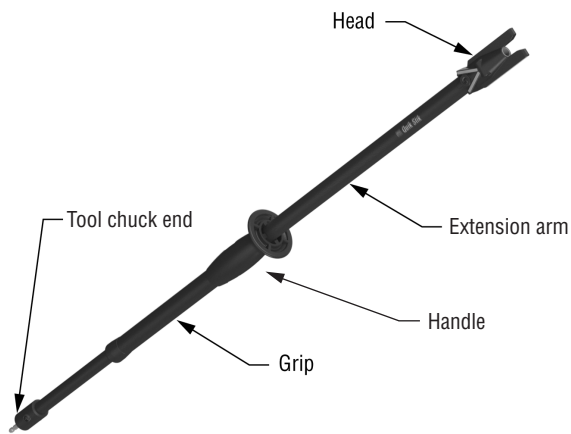

Quik Stik Components

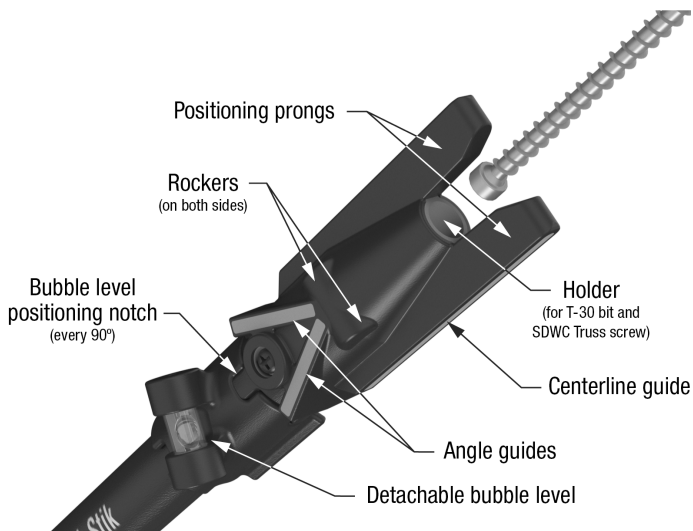

Quik Stik Head Features

## INSTALLATION AND REPLACEMENT OF THE DRIVER BIT

A T-30 driver bit is included with the tool and in packages of Strong-Drive® SDWC Truss screws (sold separately). To insert the bit, simply push down on the head of the Quik Stik™ tool to expose the magnetic bit holder. Slide the bit into the holder, press firmly until it clicks, and release the tool head back to its original position. To remove, push down on the Quik Stik tool head, and pull the bit out of the holder using pliers.

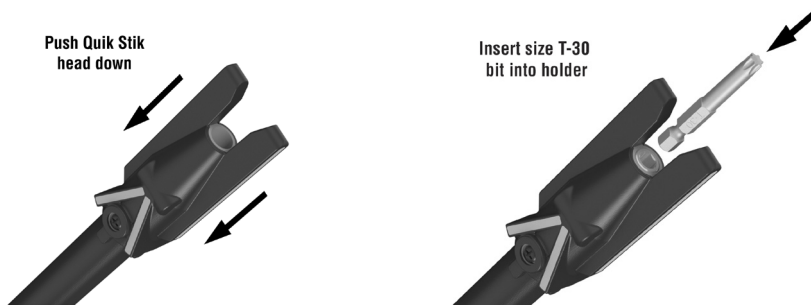

**Quik Stik bit insertion — draw the head back to expose the bit or bit holder; insert T-30 bit into bit holder.**

## DRILL/DRIVER ATTACHMENT

The Quik Stik tool is compatible with the drill motor of your choice as long as it is capable of a minimum of 1,200 rpm, which is very common. It is permissible to use an impact driver, although tool reliability may be compromised when used with an impact driver due to additional wear on the tool caused by the concussive action of the driver motor.

To attach the drill/screwdriver motor to the tool, insert the hex drive shaft of the Quik Stik tool into the drill/screwdriver motor's chuck and tighten until snug.



**Quik Stik drill attachment.**

To verify that the Quik Stik tool is properly installed, cycle the tool through an installation motion, sliding the handle and grip over the extension arm, while the drill/screwdriver motor is running. The action should be smooth and when the spring-loaded guide tube is released, it should return to its original position.

## BUBBLE LEVEL ATTACHMENT

The Quik Stik™ system includes a snap-on, adjustable bubble level that assists in determining the proper screw installation angle for certain installations. The bubble level easily snaps onto the Quik Stik extension arm and can be slid up and down the length of the arm and locked into place with the positioning notches in either the head or the handle of the tool. However, it is recommended that the bubble level be positioned adjacent to the Quik Stik head and locked into place using one of the four positioning notches molded into the head (see below).

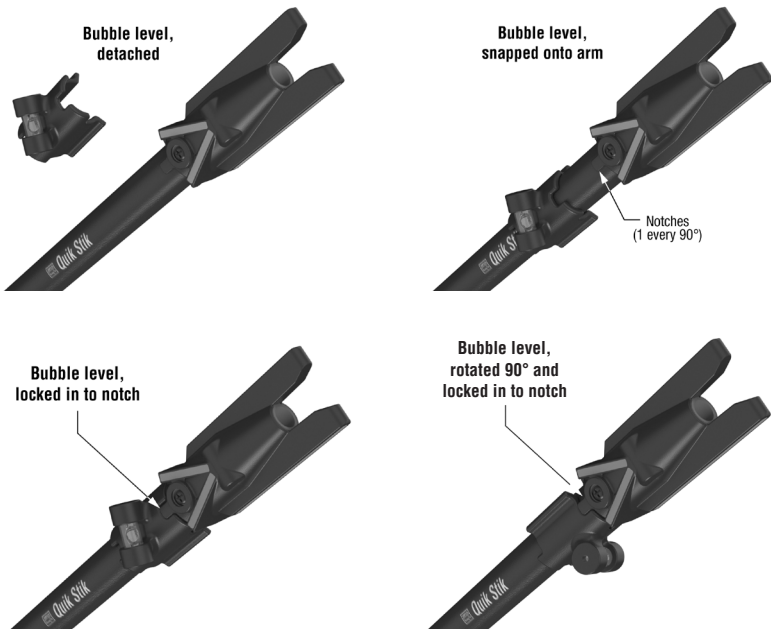

Quik Stik Bubble Level Attachment

## LOADING THE QUIK STIK SYSTEM

To load an SDWC screw into the Quik Stik system, simply insert the head of the screw into the holder located between the positioning prongs of the Quik Stik head.



## SCREW DRIVING TIPS

The Quik Stik™ system has been designed to assist the installation of the Strong-Drive® SDWC Truss screw into rafter or truss assemblies. The use of the Quik Stik centerline guide, angle guides and bubble level as described in this Operator's Manual will ensure correct connection geometries which are required for the SDWC Truss screw to achieve the published design values. If the point of the SDWC Truss screw protrudes from the side of the rafter or truss chord, the installation is incorrect and the screw will not achieve its design values. The fastener should be completely removed and reinstalled using the correct angle as prescribed by the corresponding installation instructions.



**Incorrect installation with SDWC protruding out the side of rafter/truss.**

Holding the grip on the extension arm in one hand and the screwdriver motor in the other, position the head of the tool at the intended point of fastener installation.

For precise fastener placement, check the location of the screw point by pulling back on the extension sleeve.



**Retracting the Quik Stik head allows screw point and threads to be visible.**

## SCREW DRIVING TIPS (CONT.)

Drive the SDWC screw with minimal pressure, allowing the drill and the screw to do the work. Excessive pressure is not necessary and can lead to damage of the fastener head or the tool.

For precise countersinking, pull back the handle to provide a view of the screw as the head is countersunk into the wood member.



Quik Stik head assists in controlling screw depth.

## REMOVING A SCREW

Pull back on the Quik Stik™ handle to reveal the driver bit for easy engagement with the screw head. Once the head is engaged, ensure that the drill motor is in **reverse** and back out the screw while letting the Quik Stik grip release so that the screw settles back into the head; switch the driver motor back to forward and the screw is now ready to be driven again.



Retracting the Quik Stik head also assists in backing out screws.

## CHOOSING INSTALLATIONS

The Quik Stik™ rafter and truss fastening system can be used in a variety of ways to install the Simpson Strong-Tie® Strong-Drive® SDWC Truss screw for securing a rafter or truss to the top plate of the wall frame. The SDWC screw has been tested in five different installation configurations in order to account for a variety of field conditions. Despite differences in how the screw is installed, each installation resists the same uplift and lateral loads when it's properly executed.

### Installation 1 — Rafter/Truss Offset from Stud: Fasten Straight Up Through Double Top Plate

The bubble level is not needed for this installation.

*For rafter/truss configurations that are offset from the stud* — when the installer encounters a rafter or truss that allows the screw to be installed without a stud obstructing the installation:

1. Position the head of the Quik Stik tool underneath the center of the top plates so it aligns with the centerline of the rafter or truss resting on top of the plates.
2. Ensure that the orange centerline guide on the head is 90° to the top plate (i.e., the tool is oriented perpendicular to the plates).
3. Ensure that the driver motor is switched to the **forward** position.
4. Drive the SDWC Truss screw straight up through the top plates and into the rafter or truss until the top of the head is flush with the bottom surface of the plate.



**Installation 1: Rafter/Truss Offset from Stud: Fasten Straight Up Through Double Top Plate.**

## CHOOSING INSTALLATIONS (CONT.)

### Installation 2 — Rafter/Truss Offset from Stud: Fasten from Front-Bottom Corner of Double Top Plate

1. Position the head of the Quik Stik™ tool so that the positioning prongs straddle the bottom edge of the double top plate, aligning the SDWC screw to enter the bottom member along its edge.
2. Use the orange centerline on the head of the tool to align the screw so the SDWC Truss screw points to the center of the rafter or truss. Align the orange angle guide line so it is perpendicular to the top plate, or with the bubble level positioned on the same side as the angle guide, position Quik Stik until the bubble appears in the level's window. This is a 22° angle, which is the proper angle for installing the SDWC Truss screw.
3. Ensure that the driver motor is switched to the **forward** position.
4. Drive the SDWC Truss screw through the top plates and into the rafter or truss.
5. If the point of the SDWC Truss screw protrudes from the side of the rafter or truss chord, the installation is incorrect. The fastener should be completely removed and reinstalled using the correct angle.



Installation 2: Rafter/Truss Offset from Stud: Fasten from Front-Bottom Corner of Double Top Plate.

## CHOOSING INSTALLATIONS (CONT.)

### Installation 3 — Rafter/Truss Aligned with Stud or Slightly Offset: Fasten from Wide Face (Side) of Stud

The bubble level is not needed for this installation.

1. Position the head of the Quik Stik™ tool so the positioning prongs are in the corner where the stud and bottom top plate meet.
2. Sight along the centerline guide on the head to align the tool with the centerline of the rafter or truss. If the rafter or truss is offset from the stud, be sure to install the screw on the overhanging side. Use the rocker to help adjust the installation angle of the head to align with the rafter or truss centerline.
3. Ensure that the driver motor is switched to the **forward** position.
4. Drive the SDWC Truss screw through the top plates and into the rafter or truss until the screw head is seated in the bottom surface of the top plate.
5. If the point of the SDWC Truss screw protrudes from the side of the rafter or truss chord, the installation is incorrect. The fastener should be completely removed and reinstalled using the correct angle.



Installation 3: Rafter/Truss Aligned with Stud or Slightly Offset: Fasten from Wide Face (Side) of Stud.

## CHOOSING INSTALLATIONS (CONT.)

### Installation 4 — Rafter/Truss Aligned with Stud or Over a Window/Door Header: Fasten from Narrow Face of Stud

1. Adjust the bubble level so it is positioned adjacent to the centerline guide.
2. Pull back slightly on the grip so the point of the screw is extended slightly beyond the ends of the positioning prongs.
3. This method involves embedding just the screw point into the wood, then adjusting the screw angle before driving it into the framing members. Put the point of the screw in the seam between the top plate and the stud — or on the desired spot for installation — and pivot the whole tool up past 45°.
4. Ensure that the driver motor is switched to the **forward** position.
5. Drive the SDWC Truss screw point into the wood surface so the first two screw threads embed into the wood.
6. Pivot the tool downward until the bubble appears in the level's window. This will be the proper 22° angle for installing the SDWC Truss screw.
7. Continue to drive the SDWC Truss screw through the top plates and into the rafter or truss.



Installation 4: Rafter/Truss Aligned with Stud or Over a Window/Door Header: Fasten from Narrow Face of Stud.

## CHOOSING INSTALLATIONS (CONT.)

### Installation 5 — Rafter/Truss Aligned with Stud: Fasten from Corner of Stud

Position the head at the front corner of the stud and use the guidelines to get the correct installation angle.

1. Position the head of the Quik Stik™ tool so the positioning prongs straddle the front corner of where the stud meets the top plate.
2. Sight along the centerline guide so the tool is pointed at the center of the rafter or truss. Then align the angle guide with the vertical edge of the stud. Use the head rocker surface to help position and stabilize the tool. (If using the level, the bubble should also appear in the level's window.) This should be the proper compound angle for installing the SDWC Truss screw.
3. Ensure that the driver motor is switched to the **forward** position.
4. Drive the SDWC Truss screw through the top plates and into the rafter or truss until the head of the screw is flush with the bottom surface of the top plate.
5. If the point of the SDWC Truss screw protrudes from the side of the rafter or truss chord, the installation is incorrect. The fastener should be completely removed and reinstalled using the correct angle.



Installation 5: Rafter/Truss Aligned with Stud: Fasten from Corner of Stud.

## CARE AND MAINTENANCE

General maintenance and care for the Quik Stik™ rafter and truss fastening system.

- When not in use, the Quik Stik tool should be stored in a dry place and out of the reach of children and untrained persons.
- Disconnect the tool from the drill/driver motor before making adjustments, changing accessories, or storing.
- Regularly check for misalignment or binding of moving parts and other conditions that may affect operation.
- Use only accessories recommended by Simpson Strong-Tie.
- Do not treat the Quik Stik tool with liquid or spray lubricants that may attract wood dust.

Periodically wipe the exterior surface of the Quik Stik tool with a dry cloth. Check the drive shaft for wear. Check the driver bit for wear. Replace the driver bit as needed. To replace the driver bit, draw the main tube all the way back to expose the bit; pull the bit out of the bit holder; insert a new bit. The 6-lobe replacement bit is part no. BIT30T-2-RC3.

## NOTES

## NOTES