

VISSANI™

Item #1006 634 064

Model #HVBC430ST

USE AND CARE GUIDE

4.3 CU FT BEVERAGE AND WINE CENTER

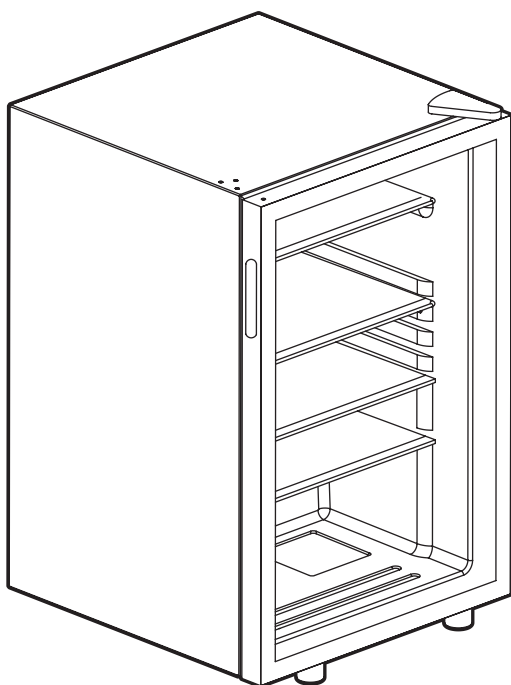

Questions, problems, missing parts? Before returning to the store,
call Vissani Customer Service
8 a.m. - 7 p.m., EST, Monday - Friday, 9 a.m. - 6 p.m., EST, Saturday

1-855-847-7264

HOMEDEPOT.COM

THANK YOU

We appreciate the trust and confidence you have placed in Vissani through the purchase of this beverage and wine center. We strive to continually create quality products designed to enhance your home. Visit us online to see our full line of products available for your home improvement needs. Thank you for choosing Vissani!

Table of Contents

Safety Information	2	Door Reversal Instructions.....	7
Warranty.....	4	Operating Instructions.....	10
Pre-Operation	4	Startup	10
Before You Begin.....	5	Setting Temperature – Adjustable Thermostat	10
Transport.....	5	Control	10
Ventilation	5	Loading Beverages and Wine Bottles.....	10
Stabilization	5	LED Light.....	11
Protect From Heat.....	5	Shutdown.....	11
Clean Before Use.....	5	Defrosting	11
Tools Required	6	Care and Cleaning	11
Product Description	6	Protect from Moisture	11
		Troubleshooting	12

Safety Information

IMPORTANT SAFETY INSTRUCTIONS

Before you use your beverage cooler, please read this owner's manual carefully. Use this appliance only for its intended purpose as described in this owner's manual.



DANGER: Risk of child entrapment. Before you throw away your old refrigerator or freezer:

- Take off the doors.
- Leave the shelves in place so that children may not easily climb inside.

- This beverage cooler must be positioned so that the plug is accessible. Never unplug the unit by pulling on the power cord. Always grasp the plug firmly and pull straight out from the outlet.
- When transporting the beverage cooler, keep the unit in the upright position. Do not tilt the appliance beyond 45° or place the unit in upside-down position. Do not tip over.
- Do not touch the cooled surfaces while the appliance operates, especially not with wet hands, because the skin may stick to the cold surfaces.
- If the unit fails to cool properly, dispose of spoiled food as needed.
- Unplug your unit before cleaning.



NOTE: If for any reason this product requires service, we strongly recommend that a certified technician perform the service. Repairs made by non-qualified personnel will void the warranty.



WARNING: Do not damage the refrigerant circuit.

- The rating plate is inside the appliance or outside on the rear or side wall.
- This appliance is not intended for use by persons (including children) with reduced physical, sensory, or mental capabilities, or lack of experience and knowledge, unless they have been given supervision or instruction concerning use of the appliance by a person responsible for their safety. Children should be supervised to ensure that they do not play with the appliance.
- Do not operate your beverage cooler in the presence of explosive fumes.



WARNING: Do not use flammable materials on or near the unit. This can result in fire and cause irreparable harm or damage to the unit.



DANGER: Risk of fire or explosion. Flammable refrigerant used. To be repaired only by trained service personnel. Do not puncture refrigerant tubing.



CAUTION: Risk of fire or explosion. Dispose of property in accordance with federal or local regulations. Flammable refrigerant used.

POWER SUPPLY



IMPORTANT: Do not cut or remove the third ground prong from the power cord.

- The appliance must be correctly installed and connected to the power supply in accordance with the installation instructions before it is used.
- The main power supply must be properly grounded.
- This beverage cooler is equipped with a 115V/60 Hz single phase motor. Do not use a ground-fault circuit interrupter (GFCI) outlet to connect the unit.

POWER CORD

- Do not run cord over carpeting or other heat insulators. Do not cover the cord. Keep cord away from traffic areas, and do not submerge in water. If the supply cord is damaged, it must be replaced by the manufacturer or its service agent or a similarly qualified person in order to avoid a hazard. Repair or replace immediately all electric cords that have become frayed or otherwise damaged. Do not use a cord that shows cracks or abrasion along its length, the plug, or the connector end.
- The power cord length is 5 feet long (1,524 mm). Never shorten or lengthen the power cord. Do not fold or coil the power cord.



DANGER: Never place excess length of the power cord into the compressor enclosure in the back of the beverage cooler. This action creates a dangerous heat buildup which can melt the cord, cause an electrical hazard, and may potentially cause a fire.



IMPORTANT: Touching the power cord to the compressor at the back of the unit during operation can create an electrical hazard and damage the compressor.



CAUTION: Young children should be supervised to ensure that they do not play with the appliance.



IMPORTANT: This beverage cooler should not be positioned within a recessed or enclosed cabinet. It is designed for freestanding installation only.



IMPORTANT: This unit is not designed to be installed in a RV, garage, or any outside installation.



CAUTION: The surface of the compressor may become hot during normal operation. Do not touch as this may cause injury.



WARNING: Keep the beverage cooler away from any combustible or volatile liquids or gases, including gasoline, oil, alcohol, paint, paint thinners, and solvents. Such chemicals should never be stored in the unit.



IMPORTANT: Never use with an extension cord. The grounded three-power plug must be connected to the outlet directly.

SAVE THESE INSTRUCTIONS

Warranty

MC Appliance Corporation warrants this beverage cooler to be free from defects in material and workmanship, and agrees to remedy any such defect or to furnish a new part(s), at the company's option, for any part(s) of the unit that have failed during the warranty period. Parts and labor expenses are covered on this unit for a period of one year from the date of purchase. A copy of the dated sales receipt or invoice is required to receive warranty service by an authorized service agent.

- ☐ Damages due to shipping or improper installation.
- ☐ Damages due to misuse or abuse.
- ☐ Content losses due to failure of the unit.
- ☐ Repairs performed by unauthorized service agents.
- ☐ Service calls that do not involve defects in material and workmanship such as instructions on proper use of the product or improper installation.
- ☐ Replacement or resetting of house fuses or circuit breakers.
- ☐ Failure of this product if used for other purposes than its intended purpose.
- ☐ Disposal costs for any failed unit not returned to our factory.
- ☐ Any delivery/installation costs incurred as the result of a unit that fails to perform as specified.
- ☐ Expenses for travel and transportation for product service if your appliance is located in a remote area where service by an authorized service technician is not available.
- ☐ The removal and reinstallation of your appliance if it is installed in an inaccessible location or is not installed in accordance with published installation instructions.
- ☐ Refunds for non repairable products are limited to the price paid for the unit per the sales receipt.

LIMITATIONS OF REMEDIES AND EXCLUSIONS

Product repair in accordance with the terms herein, is your sole and exclusive remedy under this limited warranty. Any and all implied warranties including merchantability and fitness for a particular purpose are hereby limited to one year or the shortest period allowed by law. MC Appliance Corporation is not liable for incidental or consequential damages and no representative or person is authorized to assume for us any other liability in connection with the sale of this product. Under no circumstances is the consumer permitted to return this unit to the factory without the prior written consent of MC Appliance Corporation. Some states prohibit the exclusion or limitation of incidental or consequential damages, or limitations on implied warranties. This warranty gives you specific legal rights, and you may also have other rights which vary from state to state.

Pre-Operation

BEFORE YOU BEGIN



IMPORTANT: Before you begin, do not plug the beverage cooler into a power outlet until it has been resting in its upright position for at least six (6) hours.



IMPORTANT: If the beverage cooler has been laid on its side, placed upside down, or tilted more than 45° during moving or transport, it is extremely important to allow the refrigerant and compressor oil to separate and settle so the compressor operates properly. Failure to do so will cause severe mechanical problems with the unit's motor/compressor, and will void the warranty.

- The beverage cooler is shipped with the door hinge brackets attached on the right side.
- The door may be reversed to allow opening from the left side.



IMPORTANT: If you plan to reverse the door hinges, do not plug the beverage cooler into the power outlet.

TRANSPORT

Use two or more people to move the beverage cooler.

VENTILATION

- In order for the beverage cooler to function efficiently, it must be placed in an adequately ventilated space to allow for heat dissipation. It is important to allow at least 2 inches (50 mm) of space on each side and above the unit, and 4 inches (100 mm) of space behind the unit.
- To fully utilize the beverage cooler, approximately 22 inches (558 mm) of space should be allowed in front of the unit for the door to open fully to 160°.

STABILIZATION

- The beverage cooler must be placed on a flat, stable surface. Adjust the unit's front leveling legs to assure quiet operation and prevent rattling when the compressor activates.
- Never place the unit on soft materials such as foam, plastic, or thick textured carpeting.
- Make sure the unit and door are aligned. Use the adjustable legs (front only) to align the unit and/or the screws under the triangular bracket cover to align the door. See page 7 for more detailed instructions on accessing the metal bracket.

PROTECT FROM HEAT

- Place the beverage cooler away from heat source or direct sun.
- Do not operate your beverage cooler outdoors or in an environment with high temperatures and/or high humidity, such as garages, attics, or outdoor patios. The temperature variances will create condensation on the glass door.
- Do not cover the beverage cooler with tarps or other items while operating, as this may cause overheating.

CLEAN BEFORE USE

To remove any manufacturing dust and residual odors, wipe the beverage cooler inside and out with a damp cloth and a solution of baking soda and warm water (2 tbsp baking soda to 1 qt water). Wipe away any residual baking soda with a clean, moist cloth. Allow to dry before operating.

Pre-Operation (continued)

TOOLS REQUIRED

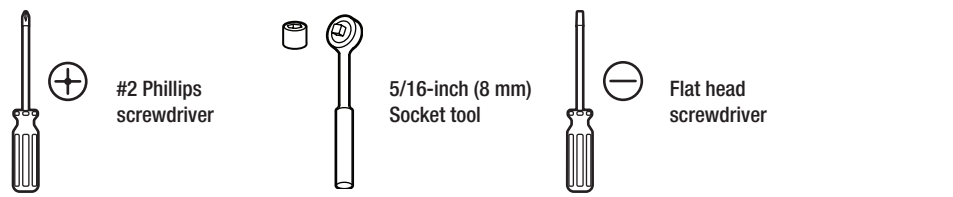

PRODUCT DESCRIPTION

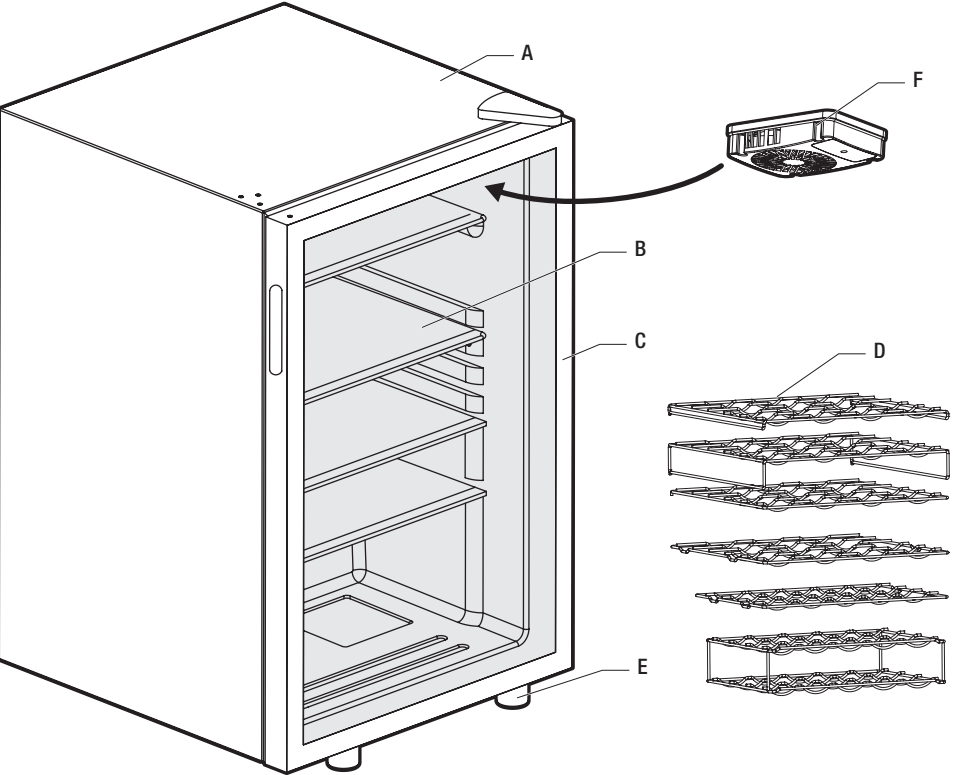

Part	Description
A	4.3 cu ft beverage and wine center
B	Adjustable glass shelves
C	Reversible double-pane glass door with stainless-steel frame

Part	Description
D	Adjustable wine bottle racks
E	Adjustable front leveling legs
F	Fan and LED light

Door Reversal Instructions



IMPORTANT: Remove glass shelves before reversing the door.



IMPORTANT: Never lay the beverage cooler on its back. The compressor and motor components are installed at the back of the beverage cooler and may easily be damaged if the unit is placed on its back.

1 Removing Plastic Hole Insert Plugs

- Gently remove plastic hole insert plugs (1) from the left side of the beverage cooler (A) with a thin flathead screwdriver. Save the plugs for step 5.

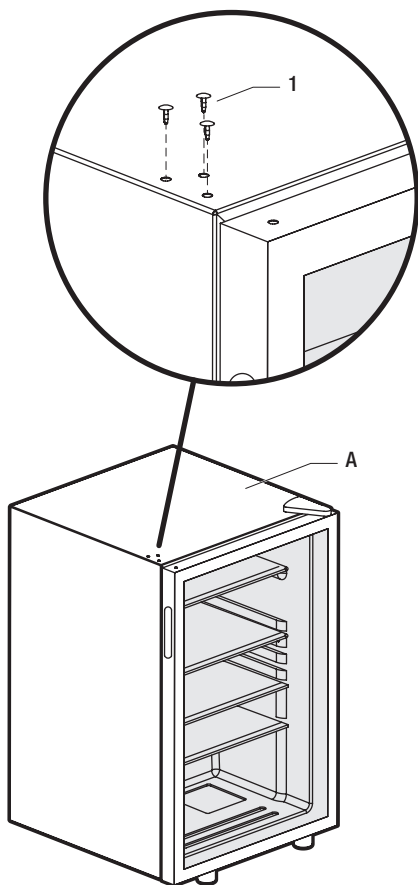

2 Removing the Triangular Bracket and Door from Right Side

- Loosen the triangular bracket cover (2) by simultaneously pushing it towards the back of the unit and pulling up.
- Slide the bracket cover (2) toward the front of the beverage cooler and lift off.
- Remove the metal bracket (3) by unscrewing the three screws (4).

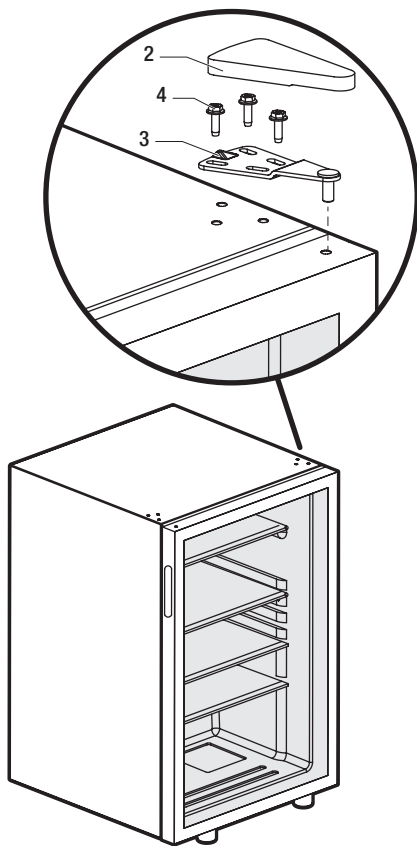

Door Reversal Instructions (continued)

3 Removing the Bottom Base Bracket from Right Side

- Carefully place the unit on its side.
- Remove the bottom metal base bracket with nylon washer (5).
- Unscrew the axle insert (6) with a flathead screwdriver. Screw into the opposite hole of the metal base bracket.

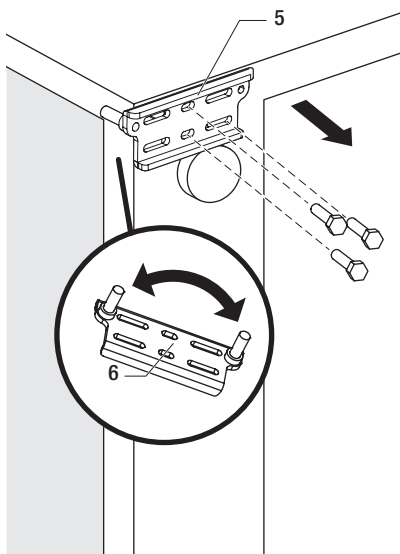

4 Reattaching the Bottom Base Bracket to Left Side

- Gently place the beverage cooler on its opposite side.
- Remove screw (7) and re-insert it into the opposite side of the unit.
- Reattach the metal base bracket with nylon washer (5) on the new hinge side.
- Lift the unit to an upright position.

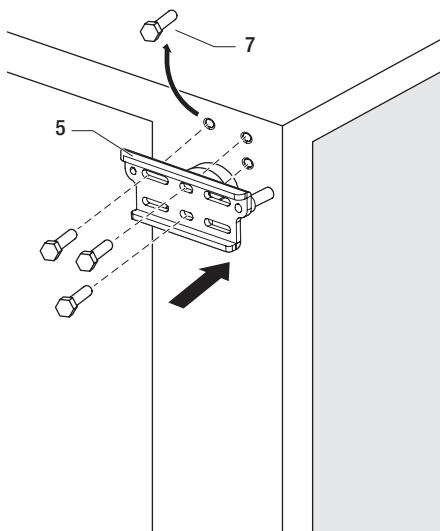

Door Reversal Instructions (continued)

5 Reattaching the Triangular Bracket and Door to Right Side

- Place the top bracket into the door, and align the metal bracket holes over the holes in the top of the unit cabinet.
- Tighten the three screws (4) to hold it in place.



IMPORTANT: The rubber gasket should be compressed on all sides of the door. If the gasket is more compressed on one side, the metal bracket position should be adjusted.



IMPORTANT: Make sure the door is level.

- Once the door position is finalized, securely tighten the screws (4).
- Reinstall the triangular bracket cover (2) by carefully threading it onto the metal bracket (3) and pressing down.
- Reinstall all plastic hole insert plugs (1).



IMPORTANT: The plastic hole insert plugs maintain the seal and integrity of the insulation. Extra inserts are included in case the plugs are damaged during removal.



IMPORTANT: It is extremely important to wait at least six hours before plugging the beverage cooler into a power outlet. During the door reversal process, the refrigerant and compressor oil fluids mixed. It is important to allow the refrigerant and compressor oil to separate and settle so the compressor operates properly. Failure to do so will cause severe mechanical problems, perhaps even the destruction of the unit's motor/compressor, and will void the warranty.

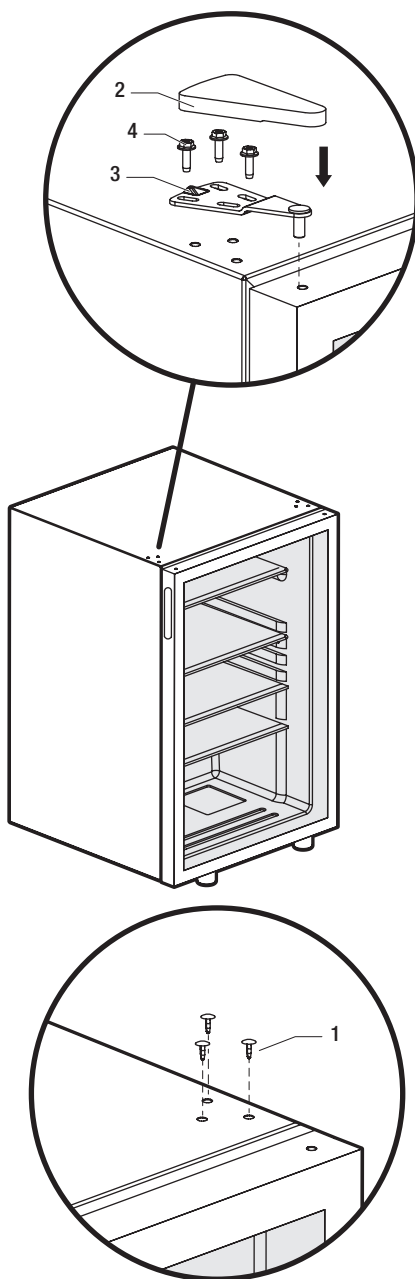

Operating Instructions

STARTUP

Connect the power cord to a standard wall outlet. Do not use a GFCI outlet to connect the unit (see Safety Information). After connection, you will immediately hear a short beep.

SETTING TEMPERATURE – ADJUSTABLE THERMOSTAT CONTROL

The default temperature is 43 °F (6 °C). Use the ▲ and ▼ buttons to set the desired temperature between the range of 37 °F to 61 °F (3 °C to 16 °C).

The display will flash while the temperature is being set. After a few seconds, it will revert to its current internal temperature reading. The digital display reading will adjust as the unit cools. While the unit is adjusting to the new setting, press the ▲ and ▼ buttons to view the selected temperature setting.

If there is a power outage, the unit will revert to the last temperature setting once power is restored.

LOADING BEVERAGES AND WINE BOTTLES

When loading the beverage cooler to full capacity, we recommend the following steps to effectively cool a large number of beverages and wine bottles.

1. Use the Adjustable Thermostat Control to set the temperature to 43 °F (6 °C) (also the default temperature).
2. Allow the beverage cooler to cool for a minimum of two hours.
3. Load the wine bottles. To achieve maximum capacity, refer to the loading diagrams.
4. After initially filling with wine bottles, the internal temperature will rise as indicated on the display.
5. Once the beverage cooler has cooled the wine bottles to 43 °F (6 °C), use the Adjustable Thermostat Control to select a desired cooler internal temperature (the lowest temperature setting is 37 °F (3 °C)).
6. Allow several hours for the beverage cooler to cool to the desired lower temperature.

ROW 1
7 wine bottles

ROW 2
7 wine bottles

ROW 3
7 wine bottles

ROW 4
7 wine bottles

ROW 5
5 wine bottles

ROW 6
5 wine bottles

ROW 7
5 wine bottles

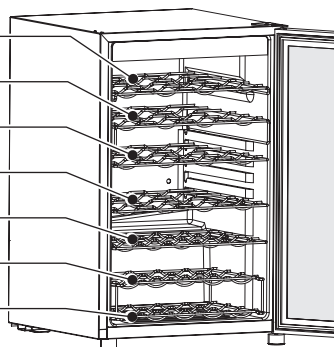

NOTE: It is normal for temperature variances to occur inside the unit, and areas near the door will have slightly warmer temperatures.

Standard 12-Ounce Cans

The beverage cooler accommodates 126 standard 12-ounce cans. To accommodate all 126 cans, position the glass shelves and load the beverages.

Wine Bottles

The beverage cooler accommodates a range of wine bottles, and the capacity varies depending on the position of the shelves and width of the wine bottles. Nest the wine bottles to gain greater capacity.

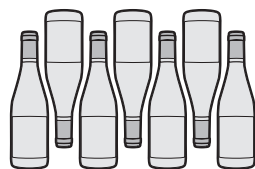

Other Beverages

The glass and wire shelves can be adjusted to accommodate varying sizes of beverage cans and bottles depending upon storage needs.

Operating Instructions (continued)

LED LIGHT

Press the  button to turn the LED light on and off.

To enhance the lifespan of the LED light and conserve energy, it is recommended to predominantly utilize the light for loading and selecting beverages.

SHUTDOWN

If the beverage cooler will not be in use for a long period of time, disconnect it from the power outlet, clean inside thoroughly, and leave the door open to prevent mildew.

DEFROSTING

Frost may develop on the interior back panel of the unit when the temperature setting is very low and the unit is not fully stocked with beverages. The presence of frost may force the unit to run continuously and thus increase internal temperature.

To defrost the beverage cooler:

1. Use the ▲ and ▼ buttons to increase the temperature until the compressor turns off.
2. Allow the internal ice/frost buildup to melt. Ensure the internal drain (located at the middle back of the lower shelf) is not clogged.
3. During this time, the melted frost flows through an internal drain into a holding pan on top of the compressor. The heat of the compressor evaporates the liquid.
4. Reset the temperature to 43 °F (6 °C) and allow to cool for at least one hour.
5. Adjust the unit to the desired temperature setting.

Care and Cleaning

PROTECT FROM MOISTURE

Heavy moisture in the environment can cause degradation to the insulation, as well as rust to the cabinet, compressor, and/or power supply.

It is important to periodically clean and maintain the beverage cooler. When performing maintenance, make certain the unit is unplugged from the power outlet.

Wipe the inner and outer surfaces of the beverage cooler clean with a damp cloth. If needed, use a gentle detergent or a solution of baking soda and water. Remove any residue with clean water and a soft cloth, then dry with another cloth.

Once clean, you may use a common kitchen appliance wax on outer surfaces.

Inspect, clean, and maintain the rubber gasket around the door. A small amount of petroleum jelly applied to the bracket side of gaskets will keep the gasket pliable and ensure a good seal.



IMPORTANT:

- Do not use hot water, harsh detergents, gasoline, kerosene, solvents, acids, or anything flammable to clean the beverage cooler. These can damage the paint and degrade the plastic components.
- Do not spray the beverage cooler with water as this may cause rust and degrade the insulation.
- Do not clean glass shelves with hot water when they are cold. Shelves may break if exposed to sudden temperature changes or impact. For your protection, tempered glass is designed to shatter into many small pebble-size pieces.
- For replacement components, they must be obtained from Vissani Customer Service. This ensures the correct replacement components are provided, and minimizes risk of possible ignition due to incorrect parts or improper service.

Troubleshooting

Problem	Solution
Beverage cooler doesn't work.	<ul style="list-style-type: none"> □ Check for power failure. □ Verify unit is plugged into a standard power outlet and not a GFCI outlet. □ Check if control panel is on.
Beverage cooler is too cold.	<ul style="list-style-type: none"> □ Adjust thermostat to higher number.
Beverage cooler is not cooling sufficiently.	<ul style="list-style-type: none"> □ Adjust thermostat to lower number. □ Ensure door is closed properly. □ Ensure the door gasket provides a proper seal. If you can slide a piece of paper between the gasket and unit body, the gasket is not sealing properly. □ Unit may not have enough ventilation space around it. □ Check if the sides of the unit are warm. If not, please contact Vissani Customer Service. □ Do not put hot beverages in the beverage cooler.
Beverage cooler compressor runs for long periods.	<ul style="list-style-type: none"> □ Hot weather and/or frequent door opening will force the unit to work harder to keep cool. □ Do not overload the beverage cooler.
Beverage cooler door does not close properly.	<ul style="list-style-type: none"> □ Unit may be tilted. Adjust front legs to level the unit. □ Align the door using a 5/16-inch (8 mm) socket, adjusting the screws under the triangular bracket cover. For assistance, please contact Vissani's Customer Service Department.
Side panel of beverage cooler is hot.	<ul style="list-style-type: none"> □ The unit exchange heats through the side walls; therefore, does not indicate malfunction. □ Usually happens when door is opened and closed frequently or when operated in high temperature weather. Results from dissipation of heat from within the unit. Do not touch the panel. Does not indicate a malfunction.
Condensation forms on the glass door.	<ul style="list-style-type: none"> □ Condensation forms under conditions of high humidity; does not indicate a failure. Wipe condensation with dry towel. □ Relocate unit to a cooler area or adjust thermostat to a higher setting to balance out the exterior and interior temperatures. Condensation will dissipate as time goes on.
Sound of trickling water.	<ul style="list-style-type: none"> □ This is the refrigerant flowing. Does not indicate a malfunction.
Buzzing sound.	<ul style="list-style-type: none"> □ A buzzing noise is typically generated by the compressor when starting up or shutting down.
Odor.	<ul style="list-style-type: none"> □ Unit may require cleaning.

VISSANITM

Questions, problems, missing parts? Before returning to the store,
call Vissani Customer Service
8 a.m. - 7 p.m., EST, Monday - Friday, 9 a.m. - 6 p.m., EST, Saturday

1-855-847-7264

HOMEDEPOT.COM

Retain this manual for future use.