



## WRINGING INSTRUCTIONS



1 Add any desired cleaning solution. Fill bucket with water to MAX WATER FILL line. DO NOT OVERFILL.



2 Dip mop head in water and soak thoroughly.



3 Place mop in the wringer basket, making sure to get all yarn strands inside.



4 Gently release locking lever. DO NOT lower past 45° as that will damage the lever. Push handle up and down to wring.

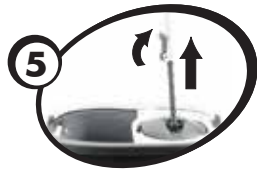

5 Extend handle and snap locking lever back into place. You are ready to mop!

## MOPPING INSTRUCTIONS



1 Before mopping, place mop handle grip in between open palm hands and spin mop to flare out mop strands.



2 Mop in "S" shape, making sure no strands get caught under green mop head.



3 If any strands do get caught under green mop head, repeat Steps 1 and 2.



SCAN CODE TO  
SEE ASSEMBLY  
INSTRUCTIONS,  
MOPPING TIPS,  
AND MORE!

**USE & CARE:** Machine or hand wash mop head in warm, sudsy water and air dry. Do not use bleach or fabric softener.

**Questions or concerns? Call Libman at 877.818.3380.**