

Check that you have all your parts and accessories.

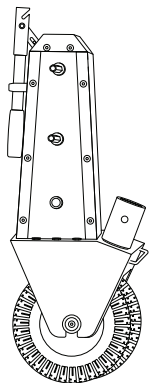

XL UNIT



SPANNER WRENCH



DRILL ATTACHMENT

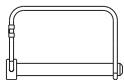

ROTATION PIN



COUPLING PLATE



HITCH BALL

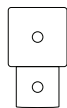

BALL BASE

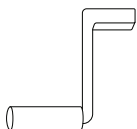

HAND CRANK



MANUAL



# TRAILER VALET XL W/ BALL MOUNT

## Quick Start Guide

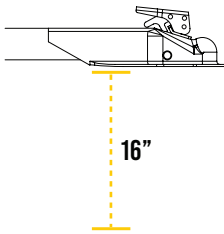

1.

Check trailer height and raise the trailer tongue to where the frame is about 16 inches off the ground to give adequate space to attach the dolly.

2.

Attach hitch ball w/ ball base to coupler.

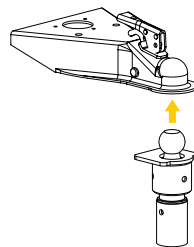

3.

Use spanner wrench and tighten that base!

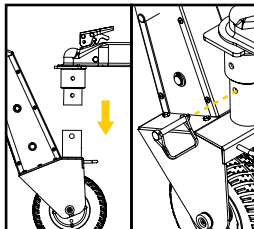
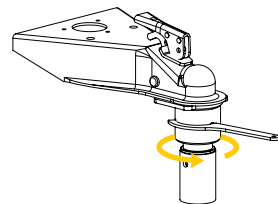

4.

Using your trailer jack, lower the hitch towards the unit's rotating coupler and attach rotation pin to secure.

5.

Make sure the XL is securely tightened and not rocking.

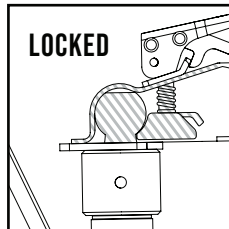

6.

Attach the crank handle, lift the steering handle to disengage brakes, and start moving!

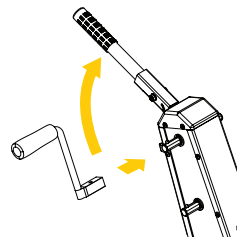

To use the XL with a drill, read the manual for step-by-step instructions. For supporting documents, visit us at [support.trailervalet.com](https://support.trailervalet.com).

Scan the QR code to access some helpful videos to help you get started and **#MoveForward**.



Check that you have all your parts and accessories.

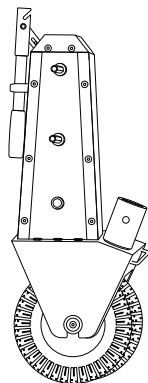

XL UNIT



SECURITY BOLT

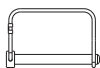

ROTATION PIN



CRANK HANDLE



DRILL ATTACHMENT



MANUAL

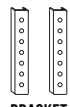

BRACKET CLAMPS (2X)



FOAM STRAP

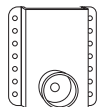

MOUNT BRACKET

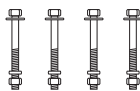

BRACKET BOLTS (4X)



MOUNTING JOINT



STOP PIN



# TRAILER VALET XL W/ MOUNT BRACKET

## Quick Start Guide

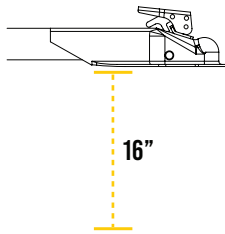

1. Check trailer height and raise the trailer tongue to where the frame is about 16 inches off the ground to give adequate space to attach the dolly.

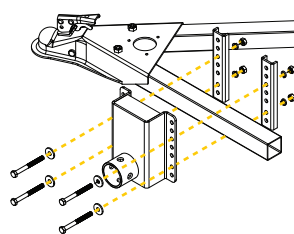

2. Install the XL Mount bracket to your trailer frame.

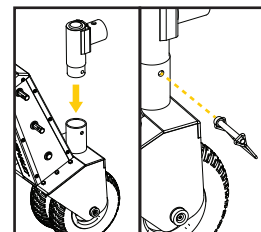

3. Attach mounting joint to the rotating coupler on the XL unit using the rotation pin.

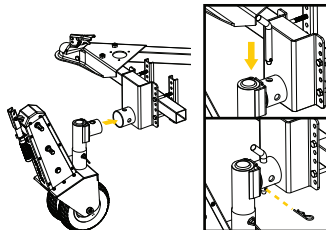

4. Connect XL unit to Mount Bracket and secure with stop pin.

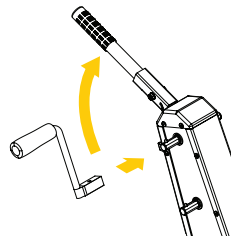

5. Attach the crank handle, lift the steering handle to disengage brakes, and start moving!

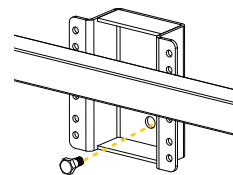

6. **OPTIONAL:** Lock with security bolt located in the back of the bracket to prevent removal.

To use the XL with a drill, read the manual for step-by-step instructions. For supporting documents, visit us at [support.trailervalet.com](https://support.trailervalet.com).

Scan the QR code to access some helpful videos to help you get started and **#MoveForward**.

