

PARTS & FEATURES

1. **Start Lever** Lever on handle which allows the engine to run. When lever is released, engine will stop.
2. **Choke Control** Restricts the air intake. This allows for an enriched fuel-air mixture which helps to start the engine.
3. **Muffler** Location of engine exhaust.
4. **Recoil Starter Handle** The engine is equipped with an easy pull recoil starter.
5. **Blade** Rotating cutting element.
6. **Blade Guard** Prevents stones and debris from being thrown at the operator.
7. **Spark Plug/Spark Plug Wire** Provides spark to ignite air/ fuel mixture. The Spark Plug Wire must be disconnected and moved away from the Spark Plug when servicing the unit.
8. **Air Filter** Removes debris and contaminants from intake air, allowing engine to run smoothly with low exhaust.
9. **Depth Selector Plate**
10. **Depth Control Lever**
11. **Control Rod** Used to control the edging depth of cut.
12. **Flameout Wire Terminals** Must be connected for the Start Lever to function.

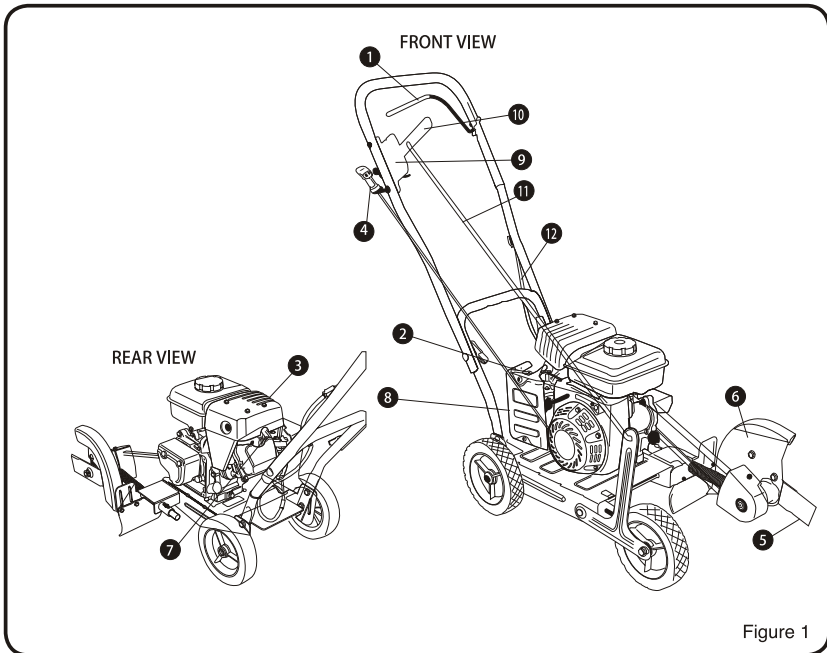

Figure 1

ASSEMBLY

Read and follow the assembly instructions. Do not discard any parts or materials until the unit is assembled. References to the right or left side of the edger are from the viewpoint of the operator's position behind the edger.



WARNING!

Do not operate edger if it is damaged or not completely and correctly assembled.



WARNING!

Before doing any assembly or maintenance to the unit, remove the wire from the spark plug.



WARNING!

Always wear ANSI compliant safety glasses with side shields while assembling the edger.

Intended use

- When used for its intended purpose, this device corresponds to the state of the art, as well as to the current safety requirements at the time of its introduction.
- The unit is designed to cut lawn areas in private house and hobby gardens.
- The device is not suitable for commercial or industrial use.
- Any other type of use is inappropriate.
- Improper use or modifications to the device or the use of components that are not tested and approved by the manufacturer may result in unforeseen damage!
- Any use that deviates from its intended use and is not included in these instructions is considered unauthorised use and relieves the manufacturer from his or her legal liability.

The following components will be found in the carton.
Quantities shown in ().

1. (1) Edger
2. (1) Edger Operator's Manual
3. (1) Upper Handle
4. (1) Control Rod
5. (1) Container of SAE 30 Engine Oil
6. (1) Parts bag containing the following:
 - (2) Hair Pins
 - (2) Plastic Wing Nuts (M8)
 - (2) M8x35mm Pipe Bolts
 - (1) Wire Tie
 - (1) Spark plug socket wrench w/ rod



WARNING!

Flameout wires **MUST** be connected for correct engine operation. Failure to connect can result in serious injury.

How to Remove Edger from Carton

1. Remove all parts and packaging components.
2. Use a utility knife to cut all 4 vertical edges and lay the side panels flat around the edger.
3. Remove any remaining packaging.
4. Roll the unit out from the carton, and place on a hard level surface.

How to Assemble the Handle

NOTE: Refer to Figure 2 when following steps below:

1. Assemble the upper handle to the lower handle with the (2) pipe bolts and the (2) plastic wing nuts. Firmly handtighten the wing nuts.
2. Slide one end of the control rod into the hole of the Depth Control Lever. Secure with hairpin.
3. Slide the other end of the control rod through the hole of the wheel bracket arm. Secure with second hairpin.
4. Attach the recoil starter handle through the rope guide, by twisting it into position.
5. Remove the temporary insert from the engine flameout wire terminal.
6. Connect the flameout wires from the engine and handle. Use cable tie to secure loose wire to handle.

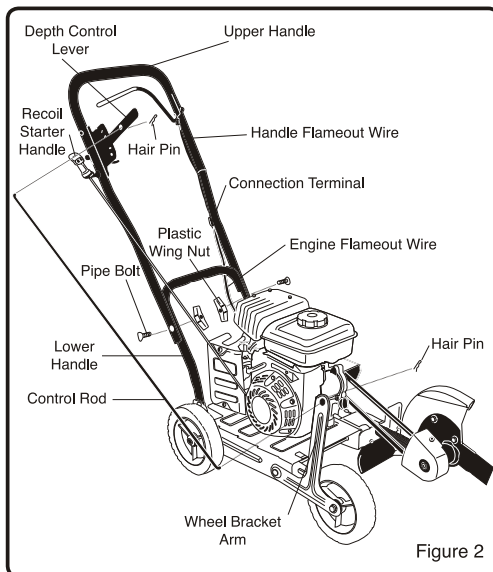

ENGINE PREPARATION

Engine Oil



CAUTION!

Engine shipped without oil. Failure to add oil will result in serious engine damage. A bottle of SAE 30 engine oil is included with your edger. Refer to the chart on the right for alternative oil types to use at different temperatures. Always use a high quality detergent oil classified "For Service, SG, SH, SJ" or higher. Do not use special additives.

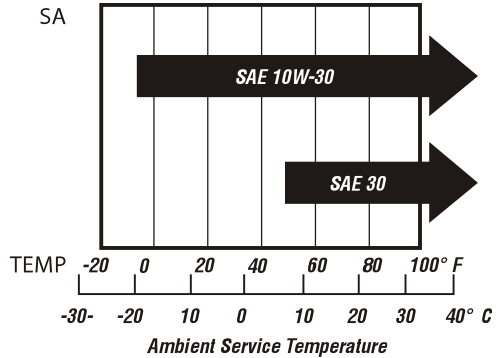

CAUTION!

Always use recommended oil type. Using dirty oil or incorrect oil type such as 2-stroke engine oil will shorten engine life.

NOTE: Engine Oil Capacity is 12 ounces. For the first time fill, simply add the entire contents of the provided oil bottle to the crankcase.

HOW TO CHECK OIL LEVEL AND FILL TO PROPER LEVEL



WARNING!

Before checking oil, make sure engine is off, and spark plug wire has been disconnected from spark plug.



CAUTION!

Frequently check oil level while filling. **DO NOT OVERFILL. DO NOT UNDERFILL.** Running engine at improper oil level will seriously damage engine.

1. Place the edger on a level surface.
Put the depth control lever in the first

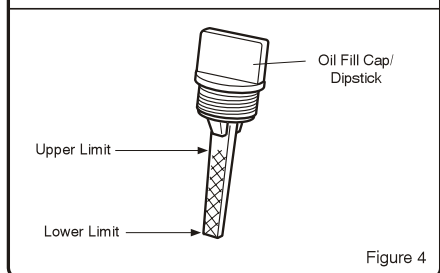
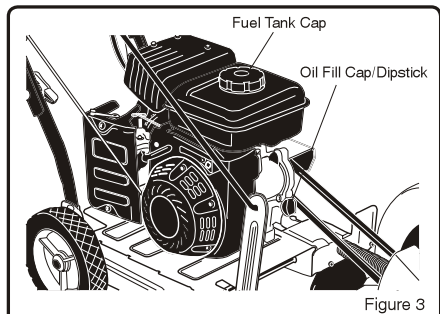

- cutting depth (See Figure 7), and check that the frame of the edger is level.
2. Remove the oil fill cap/dipstick and wipe clean with cloth. (See Figure 3)
 3. Insert dipstick into fill spout but do NOT screw in. Remove dipstick and check oil level.
 4. When oil level is full, the oil will be at upper limit on dip stick. If oil level is near or below the lower limit, oil must be added. (See Figure 4)
 5. Add oil slowly until the oil level reaches the upper limit of the dipstick. Use a funnel or nozzle to reduce spillage.
 6. Replace and tighten dipstick.
 7. Clean up any spilled oil.

Fuel



WARNING!

- Gasoline is extremely flammable and vapors can explode if ignited. Handle with care. Use fresh, clean, regular-unleaded gasoline with a minimum of 88 Octane. Do NOT use leaded gasoline, gasohol, methanol, or diesel fuel. Do NOT mix oil with gasoline. Do NOT allow gasoline to become contaminated with dust, water, or debris.



CAUTION!

- Using incorrect fuel type or contaminated fuel will cause serious engine damage.

NOTE: Fuel tank capacity is approximately 1.7 qt (1.6L)

HOW TO FILL ENGINE WITH FUEL



WARNING!

- Turn engine off and let engine cool for several minutes before removing the fuel cap or adding fuel.
- Never fill fuel tank indoors.
- Do not smoke while adding fuel.

1. Clean surface around fuel tank cap to prevent contamination. (See Figure 3)
2. Loosen fuel cap slowly. After removing cap, place on a clean surface.
3. Pour fuel into the tank. Use care to avoid spillage.



WARNING!

- Do NOT OVERFILL fuel. Allow space for the fuel to expand due to heat from engine and/or sun.

4. Before replacing the fuel cap, inspect and clean the fuel cap seal.
5. Replace the fuel cap and securely hand-tighten.
6. Clean up any spilled fuel.