

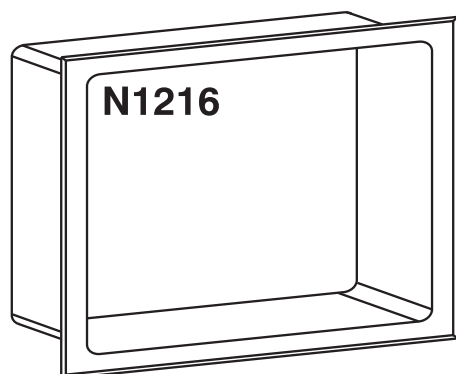

Stainless steel wall niche

User Manual

**SN001-1/SN001-2/SN001-3/SN001-4/SN002-1/SN002-2/SN002-3
SN002-4/SN003-1/SN003-2/SN003-3/SN003-4/SN004-1/SN004-2
SN004-3/SN004-4/SN005-1/SN005-2/SN006-1/SN006-2/SN006-3/SN006-4**

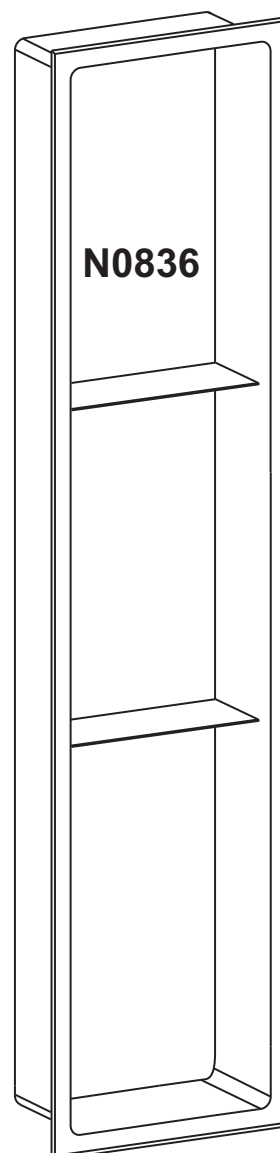
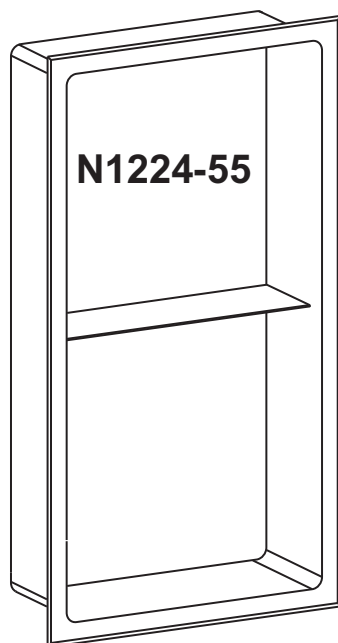
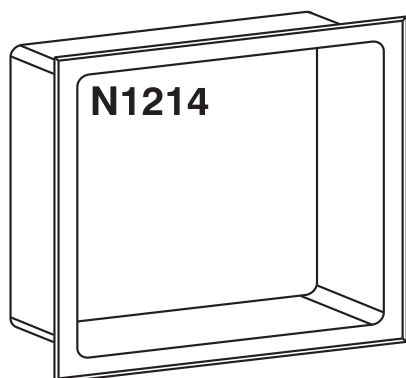
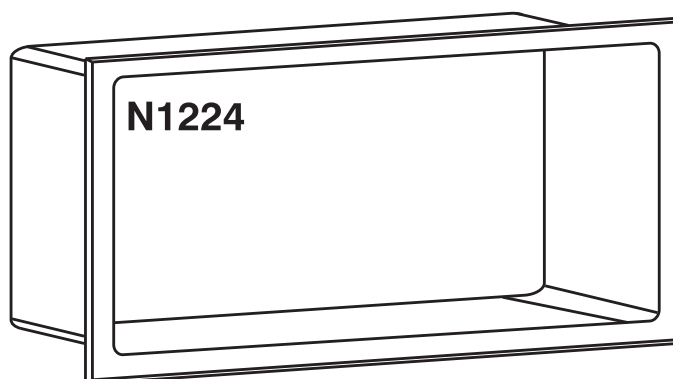
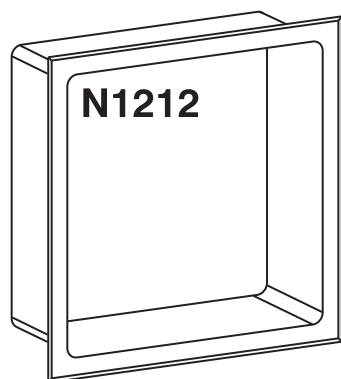



We recommend that you hire a professional worker to install and repair this product.

Tools and accessories required (not included)

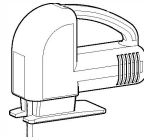

If necessary

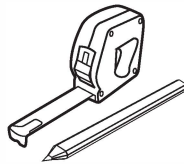

Before You Begin

- Please carefully read these instructions.
- Unpack and inspect the niche carefully.
- Do not install the niche if it is damaged. Save all original packaging and receipts.
- Check and follow all local plumbing codes.

General Recommendations

- Read installation and maintenance instructions thoroughly before installation.
- Be sure to use proper tools and always wear personal safety accessories for your protection.

Care & Maintenance

- Akdy Stainless Steel Niche are easily kept new, and long lasting with minimal care.
- For best results, always rinse with small amount of soap, and wipe them after each use.
- To avoid scratches and discoloration to the niche's surface, refrain using steel wool or scouring pad.

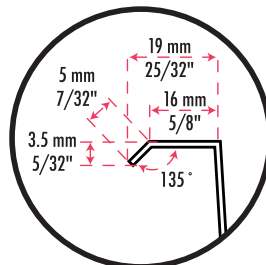
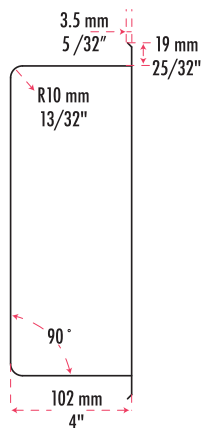
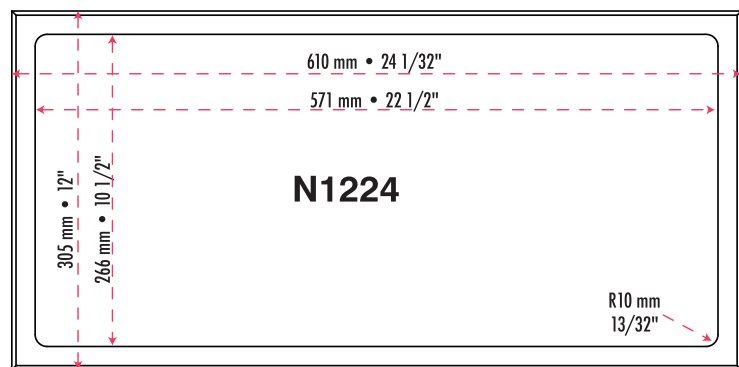
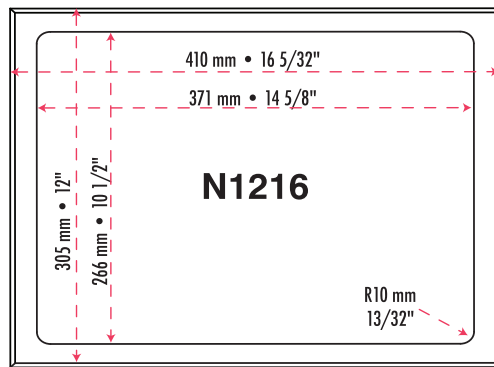
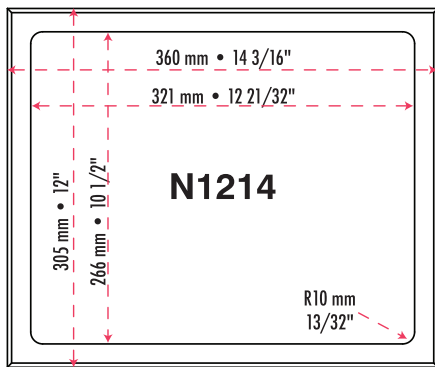
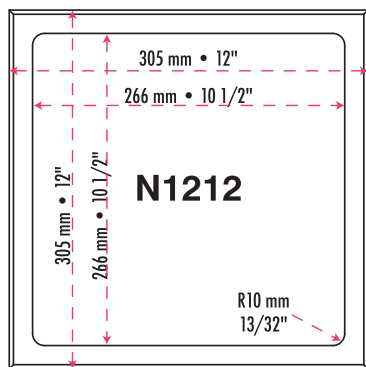

Features

304 Stainless steel, 18 gauge
 Installs over or under your wallcovering
 Long-lasting, easy-to-clean, satin finish
 10 mm radius corners

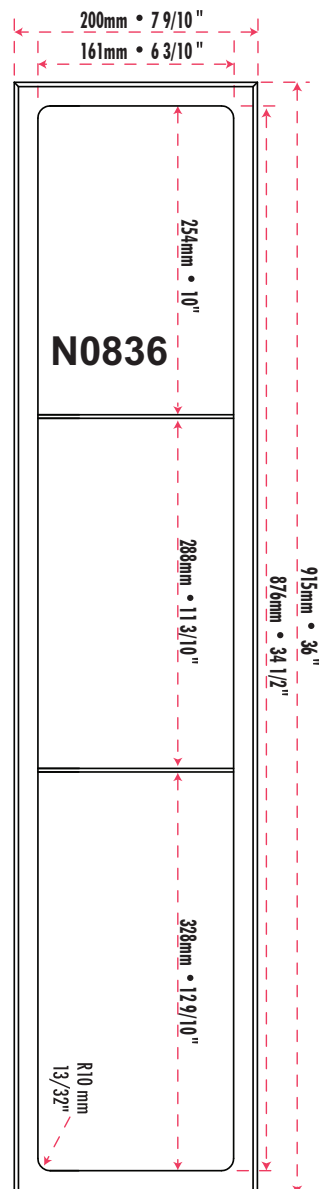
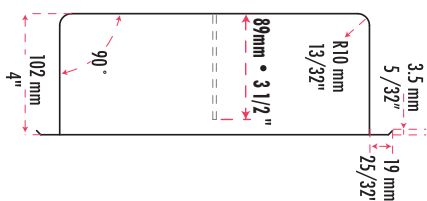
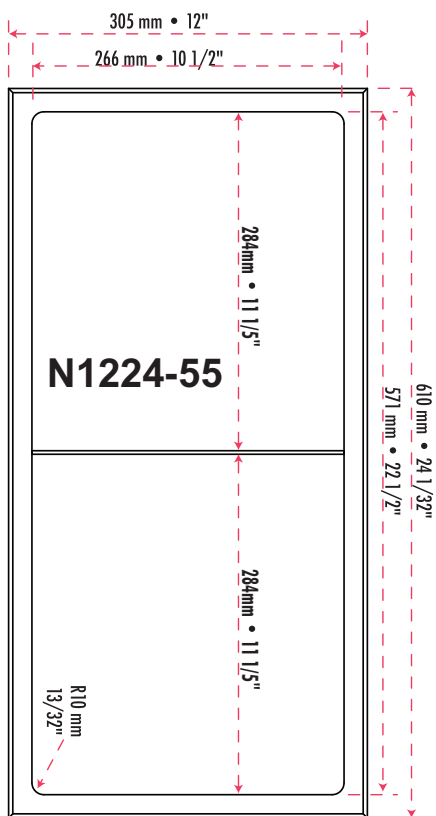

The dimensions provided above are approximate and given for guidance only.
 THE CUTTING OF COUNTERTOP MUST BE DONE BY A PROFESSIONAL INSTALLER.

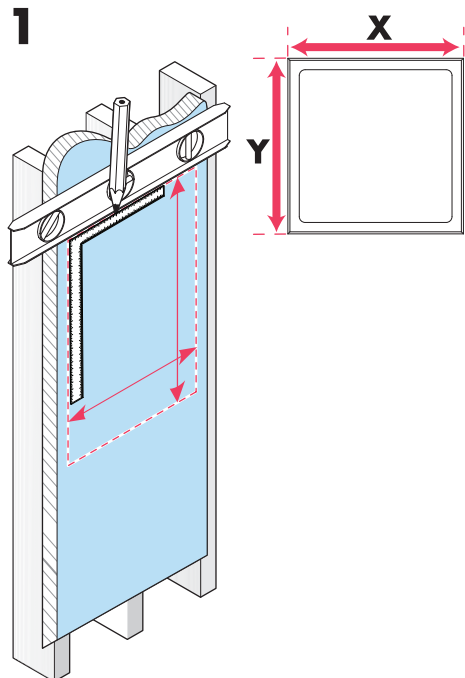
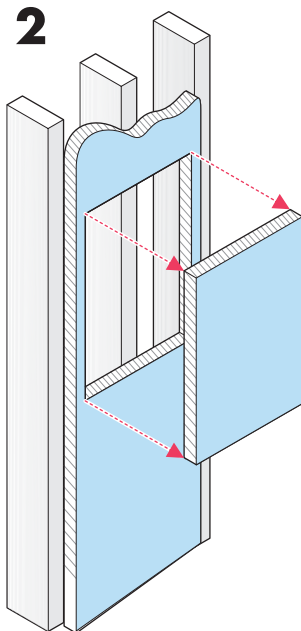
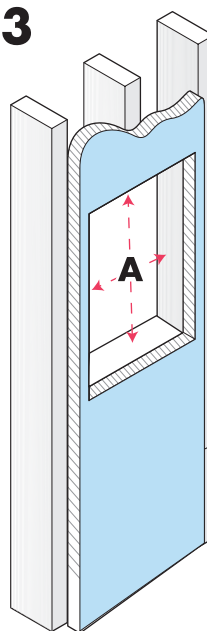
1**2****3**

- Prepare an opening between the uprights according to the dimensions X and Y of your niche minus 6 mm (1/4 inch). Ideally, when you insert the niche, it should offer a little resistance in the gypsum to prevent it from moving until the silicone dries completely. If you have added another ceramic style finish, make it finish slightly shorter than the gypsum.

- You will need to install wall supports all around the niche (A) in order to support it adequately.

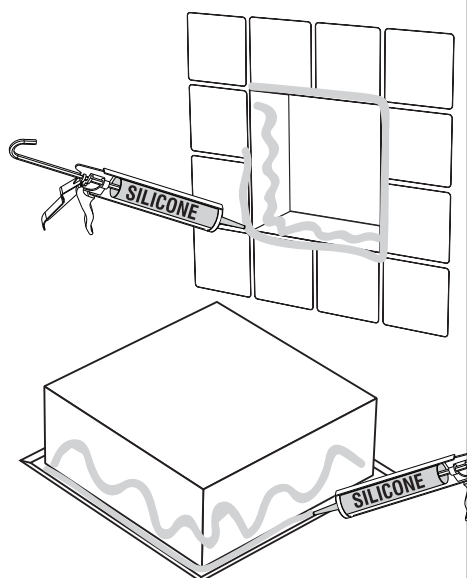
4

- Generously apply silicone on all sides, on the inner surface of the edge of the niche, on the wall and on the uprights (as illustrated) for optimal sealing and support.

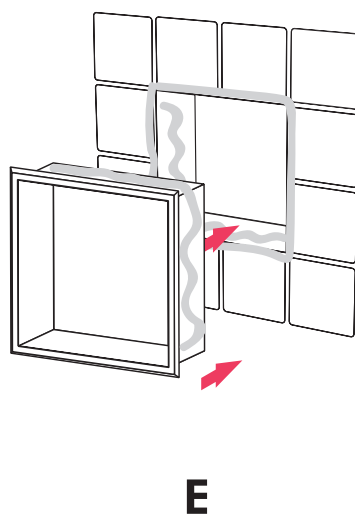
5

- Place the niche against the wall and press firmly. Remove the niche and add silicone if it does not protrude slightly.

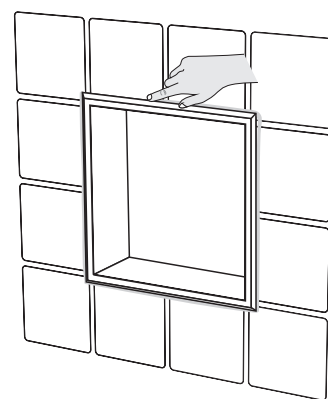
6

- With a wet finger, wipe off any excess silicone.