

04. Operation

1 Sit On The Toilet Seat

- ▶ Make skin contact with the seat sensor.

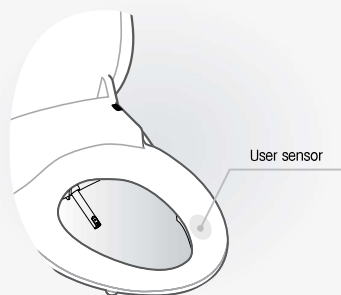

2 Wash, Bidet, Turbo

- ▶ Select one of the functions listed above.
- ▶ When pressing the selected function again, nozzle will oscillate back and forth to wash a wider range.
- ▶ Press the button once again to stop oscillate function.
- ▶ The specialized water spray in Turbo function helps relieve constipation.

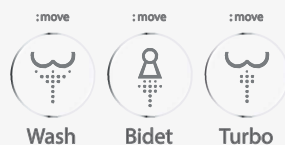

3 Dry Temperature Control

- ▶ Dryer operates for 3 minutes.
- ▶ Dryer temperature is adjustable by pressing "+" or "-" buttons. (5 levels)
- ▶ Dryer effect will be improved if you wipe the moisture lightly before operating the drying function.



4 Pulse

- ▶ When pressing the Pulse button during the operation of Wash, Bidet, and Turbo, water pressure will repeat high and low for smooth pulsating wash.
- ▶ Pulse function will not operate during the operation of Sitz bath*.

*See how to use on page 15, step 14.



5 Child Function

- ▶ When selecting Child function, settings adjust to low pressure.
- ▶ 1 min Bidet - 30 sec Bidet Oscillating - 30 sec Bidet Pulse.

*** What it does :**
Extra extended nozzle position
Lower water pressure
Lower seat temperature
Lower water temperature

6 Nozzle Position Control

- ▶ Nozzle position is adjustable. (5 positions)

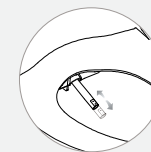

7 Water Pressure Control

- ▶ Water pressure is adjustable. (5 levels)
- ▶ If the water or screen filters become blocked, it may cause low water pressure. Regularly check the water and screen filters. See section 5 for instructions.



8 Stop

- ▶ All operations will stop.
- ▶ When pressing the Stop button for 3 seconds, unit will turn off.
- ▶ Press Stop, Wash, Bidet or Turbo to turn on.

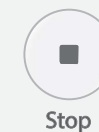

04. Operation

9 Seat/Water Temperature Control

- ▶ Seat/Water temperature is adjustable. (4 levels) (Off - Low - Middle - High)
- ▶ To reduce the chance of low temperature burns, the seat has a safety feature that turns to low temperature (35°C, 95°F) when seat is occupied for more than 15 minutes consecutively.

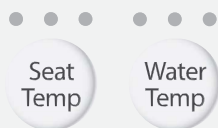

10 Energy Saving Function

- ▶ ECO 1
- This mode is activated by pressing the Energy Saving button until the yellow LED lamp lights up. (Seat and water temperature will be kept at 32°C)
- ▶ ECO 2
- This mode is activated by pressing the Energy Saving button until the green LED lamp lights up. (Seat and water heater will be kept off until seated)
- ▶ ECO OFF
- Press the Energy Saving button until LED lamp turns off.
- ▶ When the unit is occupied, it adjusts to the preset temperature and it returns to the saving mode when seat is unoccupied.
- ▶ If the seat and water temperature are off, they will remain off.

11 Nozzle Cleaning

- ▶ When selecting Nozzle Cleaning while not seated, the nozzle cleans itself 3 times. Then nozzle extends and stops for manual cleaning process.
- ▶ Clean the nozzle with a brush and press the STOP button after completion of manual cleaning.
- ▶ NOZZLE CLEANING will not operate if the seat sensor is activated.



12 Night Light

- ▶ Blue LED night light provides enough brightness to see the toilet without turning on the bathroom light.
- ▶ Night light can be turned on and off by pressing '+' for 3 seconds while not seated.
- ▶ Night light setting cannot be adjusted if seat sensor bypass feature is activated.

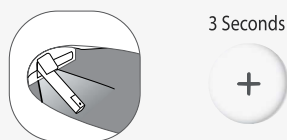

13 Automatic tank draining

- ▶ To protect from water contamination, the water tank will be drained(replaced) for 2 minutes if the seat is not used for 48 consecutive hours.
- ▶ This feature is deactivated from the factory. To activate this feature, press Stop and Water Temp. buttons for 3 seconds.

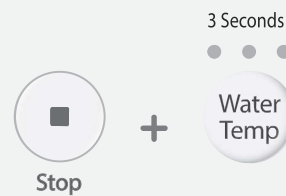

14 Sitz Bath

- ▶ Wash or Bidet is switched to Wash Sitz Bath or Bidet Sitz Bath if Nozzle Cleaning button is pressed during use.
- ▶ Water pressure is switched to 1st level regardless of preset water pressure settings and Sitz Bath operates for 5 minutes.
- ▶ LED of Nozzle Cleaning turns on during the operation of Sitz Bath.
- ▶ Select the Nozzle Cleaning again to switch to normal Wash or Bidet.

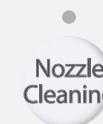

15 Seat Sensor Bypass

- ▶ The seat sensor can be activated and deactivated by pressing Pulse button for 3 seconds.
- ▶ If the seat sensor is deactivated, the unit works without occupying the seat and select features* cannot be controlled.

* Features
Night light, Silent mode, Nozzle cleaning.



16 Reset

- ▶ Press and hold the Stop button for 5 seconds.
- ▶ After 3 seconds, the seat will power off. Keep holding another 2 seconds and the seat will power back on. This completes the factory reset process.



05. Maintenance & Cleaning

Screen Filter Cleaning

- 1 Close the water valve.
- 2 Disconnect the water supply hose. Take the screen filter out and clean it with a soft brush.
- 3 Return the filter after cleaning and reconnect the water supply hose.
- 4 Open the water valve.

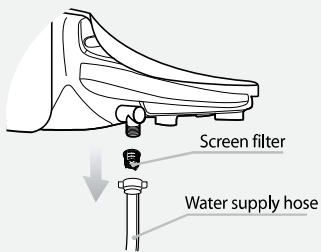

Seat Cleaning

- 1 Exterior surface of unit is made of plastic material, which may be damaged by scrubber, chemicals, etc.
- 2 Wipe the surface with a soft damp cloth. Do not spray water directly onto the surface.
- 3 Clean the body after removing the power plug from the outlet. Be sure no water splashes into the power plug or outlet.
- 4 Be careful of not dropping any chemical detergents or toilet cleaner the main body or supply hose to avoid damage.

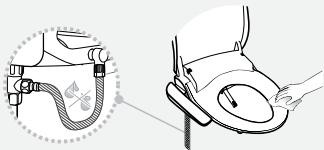

Extended Non-Use

When bidet seat is not used for an extended period of time, unplug and drain the unit.



Draining of Tank Water

- 1 Remove the power plug from the outlet.
- 2 Close the water feed valve.
- 3 Press the release button and gently pull to remove the unit from the catch plate.
- 4 Use a screwdriver or coin to open the drain plug.

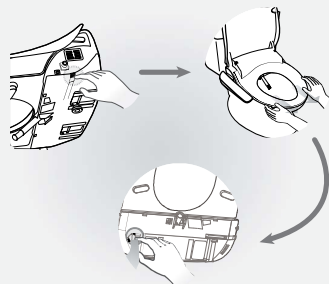

06. Settings

● : Seat sensor 'off' ○ : Seat sensor 'on' ● : Regardless of on/off

No	Function	Seat status	Switch operation	Description	Initial status
1	Silent mode	●	" - " for longer than 3 seconds.	To turn on/off the operating chime sound.	ON
2	Power off	●	" Stop " for longer than 3 seconds.	Press one of Stop, Wash, Bidet, Intensive or Dry to power on.	
3	Seat sensor bypass	●	" Pulse " for longer than 3 seconds.	Seat sensor feature will be deactivated.	OFF
4	Night light	●	" + " for longer than 3 seconds.	To turn on/off the night light.	ON
5	Factory reset	●	Press and hold the Stop button for 5 seconds.	After 3 seconds, the seat will power off. Keep holding another 2 seconds and the seat will power back on. This completes the factory reset process.	ON
6	Automatic tank draining	●	" Stop " + " Wash Temp. " for longer than 3 seconds	Automatic tank draining feature will be activated	OFF

* The unit will work without sitting on the seat if the occupied seat sensor is deactivated. (turned off)

* If the seat sensor is deactivated, some features cannot be controlled. (Night light on/off, silent mode on/off, and nozzle cleaning)

07. Troubleshooting

※ Please check the following points before requesting repair service.

Problem	Check list
Completely out of order	<ul style="list-style-type: none"> • Check if the power plug is not connected. • Check if the power supply or outlet has failed.
Water does not spray out	<ul style="list-style-type: none"> • Check if the water supply is turned on. • Check if water valve is open. • Check if nozzle is blocked by foreign material. • Check if connection hose is bent.
Water pressure is low	<ul style="list-style-type: none"> • Check if screen filter is blocked by foreign material. • Check if the water pressure is set at too low level.
Water is not warm enough	<ul style="list-style-type: none"> • Check if its temperature is set at off or low level, or economy mode.
Seat is not warm enough	<ul style="list-style-type: none"> • Check if its temperature is set at off or low level, or economy mode.
Water tank is drained intermittently	<ul style="list-style-type: none"> • Check if the automatic water draining feature activates.

Self-Diagnosis Table

※ Please refer to the following table and inform the exact status when requesting repair service.

No	Self Diagnosis	Indication
1	Water temp sensor is disconnected or not inserted	LEDs of water low + middle level blinking
2	Water temp sensor is short-circuited or overheated	LEDs of water high + middle level blinking
3	Seat temp sensor is disconnected or not inserted	LED of water low level blinking
4	Seat temp sensor is short-circuited or overheated	LED of water high level blinking

08. Dimensions

■ Dimension diagrams

inch (mm)

