

MUD MIXER

***MIXING MUD HAS NEVER BEEN THIS EASY...
OR THIS CLEAN!***



OWNERS MANUAL & ASSEMBLY INSTRUCTIONS

MudMixer • Model MMXR-3221

MUD MIXER®

This machine is designed primarily for mixing and distributing bagged concrete and/or mortar products, and is intended for use by contractors, landscapers, fence builders, and residential homeowners in completing professional and DIY projects.

Read this information carefully to learn **how to operate** and **maintain your product properly** and to avoid injury and product damage.

You are responsible for operating the product properly and safely.

You may contact MudMixer directly at www.MudMixer.com for product safety and operation training materials, accessory information, help finding a dealer, or to register your product.

Whenever you need service, genuine MudMixer parts, or additional information, contact an Authorized Service Dealer or MudMixer Customer Service and have the model and serial numbers of your machine ready.

IMPORTANT: With your mobile device, you can scan the QR code on the rear electrical box to access warranty, parts, and other product information.

Safety & Specs	1
Parts & Hardware List.....	1
Assembly Instructions	2
Assembly Video (via QR code)	4
Operating Instructions.....	5
Maintenance Schedule.....	5
Maintenance Warranty	6



Figure 2
Safety-alert symbol

This manual identifies potential hazards and has safety messages identified by the safety-alert symbol (Figure 2), which signals a hazard that may cause serious injury or death if you do not follow the recommended precautions.

MudMixer MMXR-3221

Machine Overview



View 1



View 2



1. Open the QR Code reader on your smartphone.
2. Hold your device over the QR Code so it's clearly visible within your smartphone's screen. Your phone will automatically scan the code and prompt you to open a browser window. (It may take a few seconds on some devices. Some QR Code readers may require you to press the button to take a picture of the code.) After your smartphone reads the code, it will navigate to the online video.
3. PRESS PLAY on the video.

Hopper

Safety Auger Guard
(inside Hopper)
see View 3 below

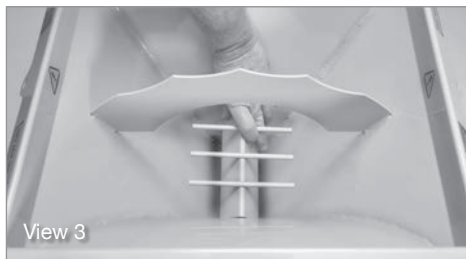

View 3

T-Valve

Secondary Hose

Chute

Concrete Bag Cutter

Water Control Dial

Power Switch

Grounded Power Cable

Flat Free Tire

Safety Auger Guard on Chute

Auger (inside chute)

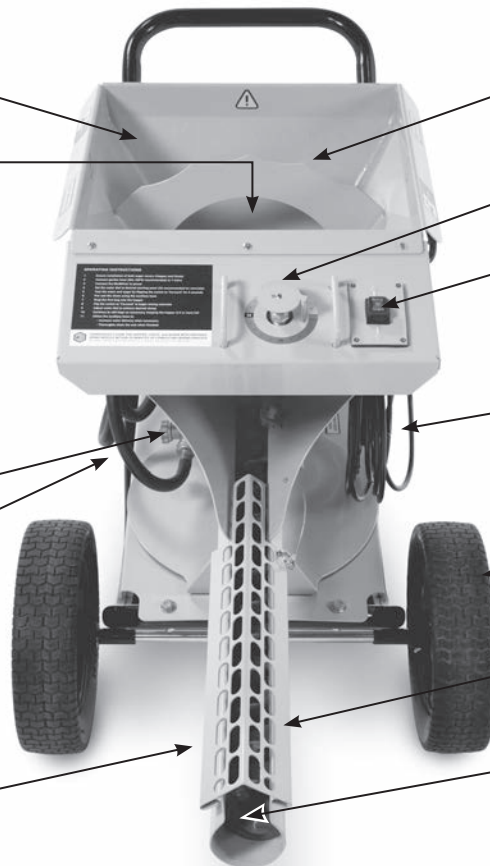

MudMixer MMXR-3221

Manual Part Number: MMXR-P316

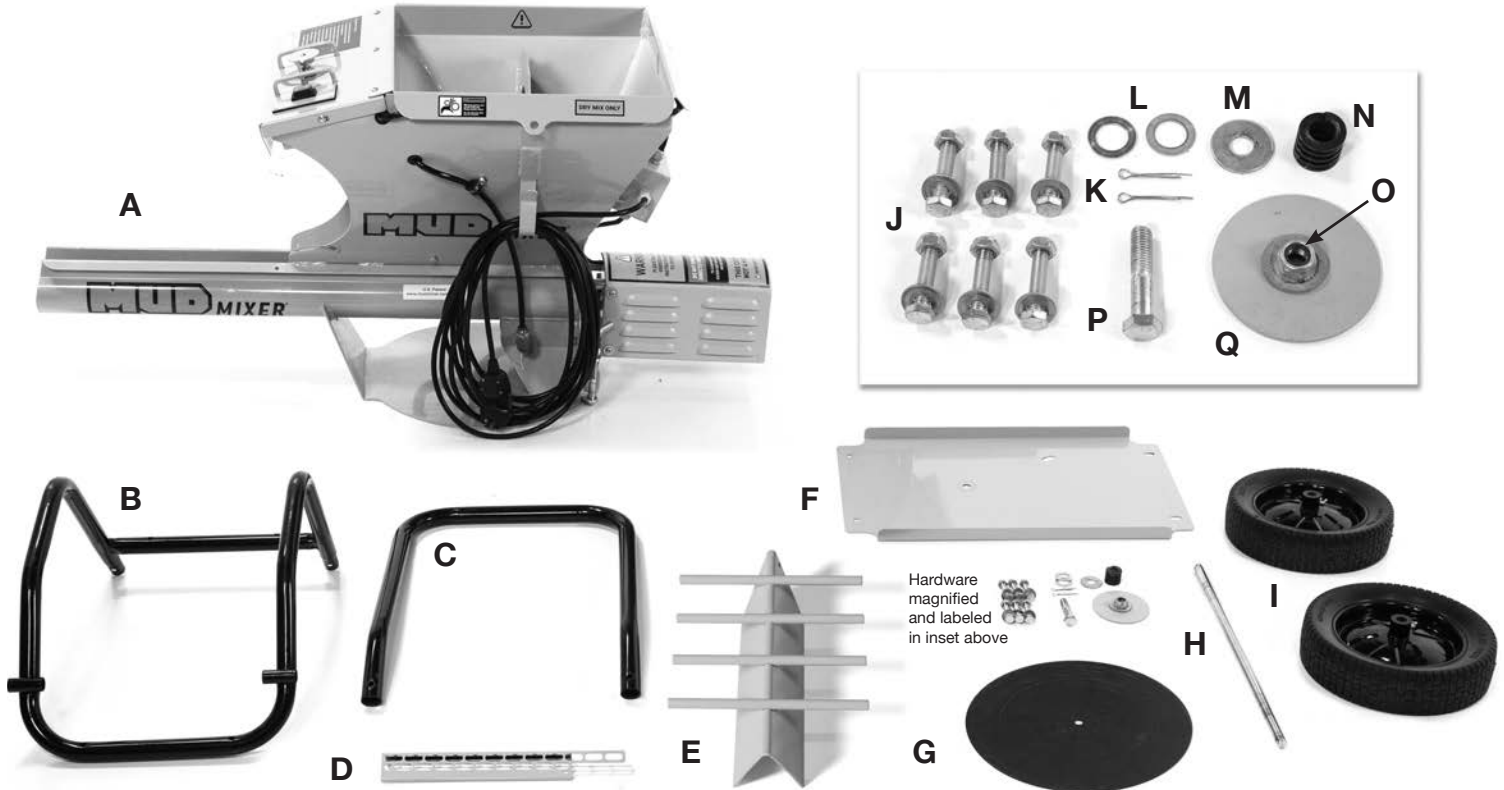

DETAILS	
Overall Length	66.5 in.
Overall Width	22.5 in.
Overall Height	35 in.
Chute Height	16 in.
Weight	145 lbs.
Hopper Capacity	120 lbs.
Body Construction	14 Gauge High-Strength Steel
Frame Construction	1 in. Steel Pipe
Tires	Marathon Flat-Free
ELECTRICAL	
Electrical Requirements	120-volt
Cord Length	25 ft.
Running Amps	1.6
MOTOR	
Motor HP	½ HP
Motor Protection Rating	IP55
SAFETY FEATURES	
Safety Auger Guard in Hopper	
Safety Auger Guard over Chute	
Grounded Power Cable	
Water-tight electrical boxes and connections	

PARTS LIST - MUDMIXER MODEL MMXR-3221	
A	MudMixer - Body
B	MudMixer - Frame
C	MudMixer - Frame Handle
D	Safety Auger Guard - Chute
E	Safety Auger Guard - Hopper
F	Base Plate
G	Plastic Bushing (black)
H	Wheel Axle
I	Flat-Free Wheels
HARDWARE PACKAGE LIST	
J	M10 x 50 Bolts, Washers & Nuts (6)
K	Axle Washer Pin (2)
L	Axle Washer (2)
M	Base Plate Small Washers (2)
N	Base Plate Spring (1)
O	Base Plate Nut (1)
P	Base Plate M14 x 65 Bolt (1)
Q	Base Plate Big Washer (1)

MudMixer MMXR-3221

Assembly Instructions • Steps 1 - 3a

Tools Needed: 1.) Pliers 2.) 5/8" Wrench 3.) 7/8" Wrench

STEP 1

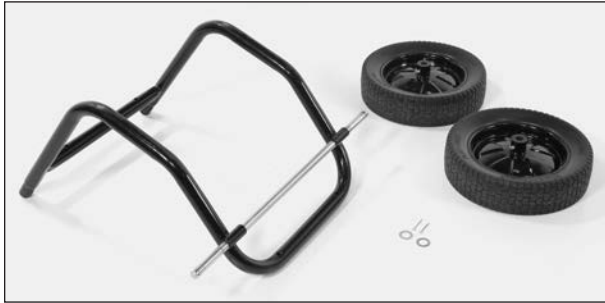

Insert **Part H** Wheel Axle through provided slots in **Part B** MudMixer Frame.



Place one **Part I** Flat-Free Wheel on **Part H** Wheel Axle (grease port facing in) on either side of axle.



Secure **Part I** Flat Free Wheels to **Part H** Wheel Axle using one **Part K** Axle Washer Pin and **Part L** Axle Washer on each wheel. Place Axle Washer on the outside of Wheel then push the Axle Washer Pin through hole of axle, then split/divide to secure.

Visit: mudmixer.com/videos to learn more about your MudMixer!

STEP 2



Secure **Part C** MudMixer Frame Handle to **Part B** MudMixer Frame with **Part J**, M10 x 50 Bolts, Washers, Nuts (2 of 6)

STEP 3a



Place **Part F** Base Plate on **Part B** MudMixer Frame oriented as shown in the photograph (PIVOT LATCH LOCK RELEASE positioned on handle side). Secure Base Plate to Frame with **Part J**, M10 x 50 Bolts, Washers, Nuts (4 of 6).

MudMixer MMXR-3221

Assembly Instructions • Steps 3b - 4

STEP 3b



Lay **Part G** Plastic Bushing (black), webbing down, on **Part F** Base Plate, aligning center holes

STEP 3c



Secure MudMixer to Base Plate with **Parts M-Q** Base Plate Hardware noted below.

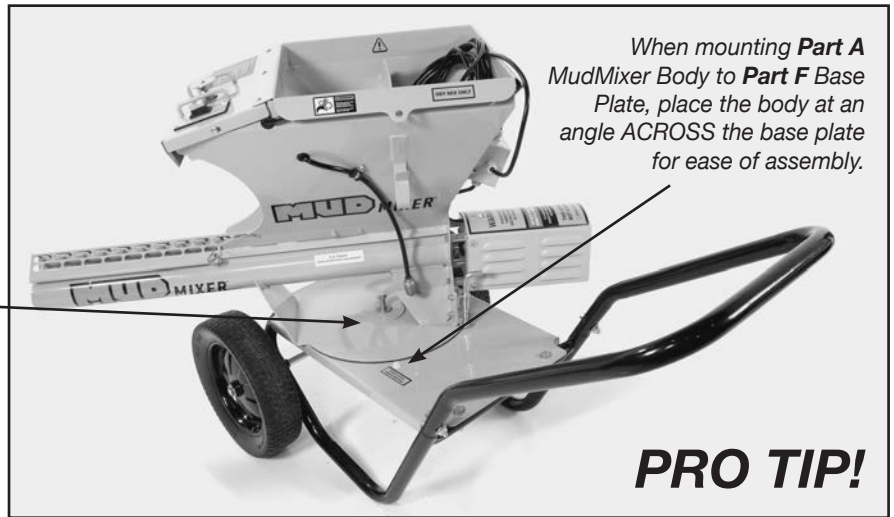

When mounting **Part A** MudMixer Body to **Part F** Base Plate, place the body at an angle **ACROSS** the base plate for ease of assembly.

PRO TIP!

PAGE 2 HARDWARE (BASE PLATE PARTS M-Q)

J	M10 x 50 Bolts, Washers & Nuts (6)	M	Small Washers (2)
K	Axle Washer Pin (2)	N	Spring (1)
L	Axle Washer (2)	O	Nut (1)
		P	M14 x 65 Bolt (1)
		Q	Big Washer (1)

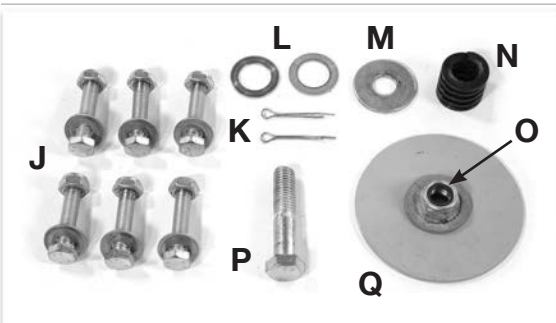

STEP 4



Tighten **Part O** Base Plate Nut until **Part N** Base Plate Spring is almost compressed, but not completely

MudMixer MMXR-3221

Operating Instructions

1. Ensure installation of both Safety Auger Guards (Hopper and Chute).
2. Connect garden hose (Min 40PSI recommended) to T-Valve.
3. Connect the Grounded Power Cable to power.
4. Set the Water Control Dial to desired starting point (35 - 50 recommended for concrete).
5. Flip the Power Switch to "Forward" for 5 seconds to test the water and Auger.
6. Pre-wet the Chute using the Secondary Hose.
7. Using the Concrete Bag Cutter, place the first bag of powder into the Hopper.
8. Flip the Power Switch to "Forward" to begin mixing concrete.
9. Adjust Water Control Dial to achieve desired slump.
10. Continue to add bags as necessary, keeping the Hopper 3/4 or more full.
11. Utilize the Secondary Hose to:
 - Increase water delivery when necessary
 - Thoroughly clean the unit when finished
12. THOROUGHLY CLEAN THE HOPPER, CHUTE, and AUGER WITH PROVIDED SPRAY NOZZLE WITHIN 20 MINUTES OF COMPLETING MIXING PROCESS



****DO NOT SPRAY WATER DIRECTLY ONTO OR INTO THE MOTOR****

MUDMIXER MMXR-3221 MAINTENANCE SCHEDULE



*** WARNING - DO NOT CLEAN THE MIXER WHILE IT IS HOOKED TO ELECTRICITY ***

General Cleaning

- After using the **MudMixer**, it is *absolutely necessary to clean the unit thoroughly*.
- We recommend using the **MudMixer Secondary Hose** and a rag to ensure the unit is free of concrete residue of any kind after the end of each project.

Motor Cleaning

- Use a rag to wipe the motor clean if necessary.



*** DO NOT SPRAY WATER DIRECTLY ONTO OR INTO THE MOTOR ***

Wheel Maintenance

- Use the grease ports on the wheels to grease the wheels when necessary.

MudMixer MMXR-3221

Warranty Information

The **MudMixer Company** promises to repair the **MudMixer** product if it is defective in materials or workmanship for the period listed below.

- Ninety (90) days for any unit used for any purpose including personal, family, or household use, rental, or commercial.

This warranty extends to the original retail purchaser only and commences on the date of the original retail purchase.

Any part of this product manufactured or supplied by MudMixer and found in the reasonable judgment of the **MudMixer Company** to be defective in material or workmanship will be repaired or replaced without charge for parts and labor by the **MudMixer Company** or an authorized dealer.

The product, including any defective part, must be returned to the **MudMixer Company** or an authorized MudMixer dealer within the warranty period. The expense of delivering the product to the dealer for warranty work and the expense of returning it back to the owner after repair or replacement will be paid by the owner. **MudMixer Company's** responsibility with respect to claims is limited to making the required repairs or replacements and no claim of breach of warranty should be cause for cancellation or rescission of the contract of any **MudMixer** brand product. Proof of purchase will be required by the dealer to substantiate any warranty claim before warranty work must be performed by the **MudMixer Company**.

This warranty is limited to 90 days from the date of original retail purchase for any **MudMixer** brand product that is used for rental or commercial purposes, or any other income producing purpose.

This warranty does not cover any **MudMixer** brand product that has been subject to misuse, neglect, negligence, or accident, or that has been operated in any way contrary to the operating instructions as specified in the operator's manual. This warranty does not apply to any damage to the product that is the result of improper maintenance or to any product that has been altered or modified. The warranty does not extend to repairs made necessary by normal wear or by the use of parts or accessories which are either incompatible with the **MudMixer** product or adversely affect its operation, performance, or durability.

The MudMixer company reserves the right to change or improve the design of any **MudMixer** brand product without assuming any obligation to modify any product previously manufactured.

The warranty applies only if you perform the routine maintenance specified in the Operator's Manual. **MudMixer** makes no other express warranty.

ALL IMPLIED WARRANTIES ARE LIMITED IN DURATION TO THE STATED WARRANTY PERIOD. ACCORDINGLY, ANY SUCH IMPLIED WARRANTIES INCLUDING MERCHANTABILITY, FITNESS FOR A PARTICULAR PURPOSE, OR OTHERWISE, ARE DISCLAIMED IN THEIR ENTIRETY AFTER THE EXPIRATION OF THE APPROPRIATE ONE YEAR OR NINETY DAY WARRANTY PERIOD. MUDMIXER'S OBLIGATION UNDER THIS WARRANTY IS STRICTLY AND EXCLUSIVELY LIMITED TO THE REPAIR OR REPLACEMENT OF DEFECTIVE PARTS AND MUDMIXER DOES NOT ASSUME OR AUTHORIZE ANYONE TO ASSUME FOR THEM ANY OTHER OBLIGATION. SOME STATES DO NOT ALLOW LIMITATIONS ON HOW LONG AN IMPLIED WARRANTY LASTS, SO THE ABOVE LIMITATION MAY NOT APPLY TO YOU. MUDMIXER ASSUMES NO RESPONSIBILITY FOR INCIDENTAL, CONSEQUENTIAL, OR OTHER DAMAGES INCLUDING BUT NOT LIMITED TO, EXPENSE OF RETURNING THE PRODUCT TO THE MUDMIXER COMPANY OR AN AUTHORIZED MUDMIXER SERVICE CENTER OR EXPENSE OF DELIVERING IT BACK TO THE OWNER, MECHANICS TRAVEL TIME, TELEPHONE CHARGES, RENTAL OF A PRODUCT DURING THE TIME WARRANTY SERVICE HAS BEEN PERFORMED, TRAVEL, LOSS OR DAMAGE TO PERSONAL PROPERTY LOSS OF REVENUE, LOSS OF USE OF THE PRODUCT, LOSS OF TIME, OR INCONVENIENCE. SOME STATES DO NOT ALLOW THE EXCLUSION OR LIMITATION OF INCIDENTAL OR CONSEQUENTIAL DAMAGES, SO THE ABOVE LIMITATION OR EXCLUSION MAY NOT APPLY TO YOU.

For additional questions regarding warranty terms and conditions, you may contact the **MudMixer Company** via the website at www.mudmixer.com or by phone at (806) 515-4MUD (2987).