

Vertical Mailboxes

Indoor, top-loading mailboxes for
replacement applications

AF FLORENCE
manufacturing company

A GIBALTAR INDUSTRIES COMPANY 



*Image: Florence 1250 vertical with surface-mount collar
Location: Chicago, IL
Application: Townhome Entry Breezeway*

1250 Vertical Mailboxes

for Postal Delivery



Vertical mailboxes can be used for Postal Delivery when they replace older vertical mailboxes. Over the years, postal regulations have changed and these mailboxes are no longer approved for new construction. As these units are top-loading, they should be protected from the weather.

Standard Features

- Top Load
- Recessed- or surface-mounted
- Prepared for USPS installed Master Lock
- Anodized aluminum finish
- 5-pin cylinder cam locks with two keys (1,000 key changes)
- Name and number ID card holders

 florencemailboxes.com/vertical

Door Size

The 1250 vertical series mailbox is pre-configured with one door size.

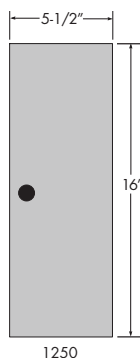

Lock Option

The 1250 vertical series comes standard with a K30809 lock.



Optional Features

- Private master lock
- Eight architectural powder coat finishes

Color Options

Anodized Aluminum is standard for all vertical mailboxes. Upgrade your installation to one of eight different architectural color options, all in a durable, powder coat finish.

Antique Bronze (AB) PMS 8622C	Black (BK) PMS Black 6C	Dark Bronze (DB) PMS Black 7C	Gold Speck (GS) PMS 7-5C
Postal Grey (PG) PMS 413C	Sandstone (SD) PMS 7501C	Silver Speck (SS) PMS 877C	White (WH) PMS White



VERTICAL MAILBOX ALL CABINETS: 19-1/8" H 6-1/8" D

Single Row	Double Row	Layout Per Row	Wall Cut Width	Overall Width
3	6	3	17-1/2"	19"
4	8	4	23"	24-1/2"
5	10	5	28-5/8"	30-1/8"
6	12	6	34-1/8"	35-5/8"
7	14	7	39-5/8"	41-1/8"
8	16	4-4	47-1/2"	49"
9	18	5-4	53-1/8"	54-5/8"
10	20	5-5	58-3/4"	60-1/4"
11	22	6-5	64-1/4"	65-3/4"
12	24	6-6	69-3/4"	71-1/4"
13	26	7-6	75-1/4"	76-3/4"
14	28	7-7	80-3/4"	82-1/4"
15	30	5-5-5	88-7/8"	90-3/8"
16	32	5-6-5	94-3/8"	95-7/8"
17	34	6-6-5	99-7/8"	101-3/8"
18	36	6-6-6	105-3/8"	106-7/8"
19	38	6-6-7	110-7/8"	112-3/8"
20	40	7-7-6	116-3/8"	117-7/8"
21	42	7-7-7	121-7/8"	123-3/8"
22	44	6-6-6-4	129-7/8"	131-3/8"
23	46	6-6-6-5	135-1/2"	137"
24	48	6-6-6-6	141"	142-1/2"
25	50	7-6-6-6	146-1/2"	148"
26	52	7-7-7-5	152"	153-1/2"
27	54	7-7-7-6	157-1/2"	159"
28	56	7-7-7-7	163"	164-1/2"
29	58	6-6-6-6-5	171-1/8"	172-5/8"
30	60	6-6-6-6-6	176-5/8"	178-1/8"

VERTICAL MAILBOX MODEL NUMBERS			
Number of Compartments	Standard Model Number	Surface Mount Model Number	Surface Mounted Collar
3	12503H	12503SM SH	SMS1253
4	12504H	12504SM SH	SMS1254
5	12505H	12505SM SH	SMS1255
6	12506H	12506SM SH	SMS1256
7	12507H	12507SM SH	SMS1257

Did you know?

The USPS allows vertical mailboxes for replacement purposes only, and so they should not be considered for any new construction installations as they do not meet the STD-4C (see page 36 for details).

Single Row

Wall Cut Depth = 6-3/4"
Wall Cut Height = 17-3/4"
Overall Height = 19-1/8"

Double Row

Wall Cut Depth = 6-3/4"
Wall Cut Height = 37"
Overall Height = 39-1/4"

Note: Vertical mailbox installations should always be protected from direct exposure to the weather. Florence Manufacturing is not responsible for damage caused by weather conditions.

SURFACE MOUNTED

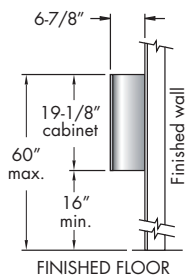

FULLY-RECESSED

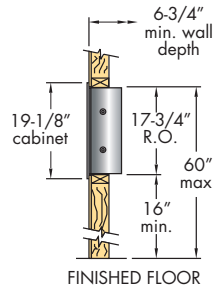

DOUBLE ROW FULLY-RECESSED

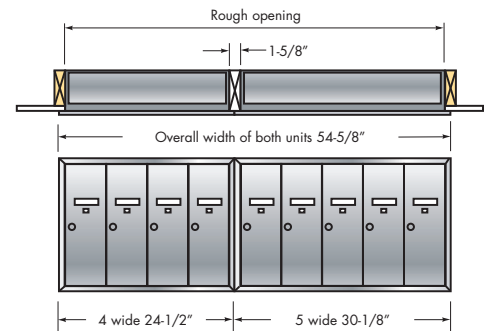
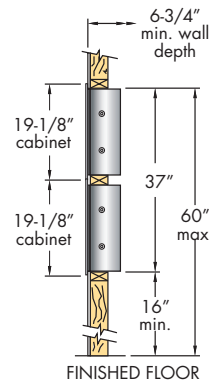

Surface-Mount Collar

When your mailbox installation location has limited wall depth or walls that are covered in material which makes it difficult to cut a rough opening, the 1250 vertical series has a surface-mount collar option. This also provides a sleek, finished look.



Vertical Mailboxes



*Image: Florence 1250 Vertical Mailboxes
Location: New York, NY
Application: Apartment Community*

AF FLORENCE
manufacturing company

A GIBRALTAR INDUSTRIES COMPANY

florencemailboxes.com

800.275.1747