

# INSTRUCTION FOR INSTALLATION OF LOCKSETS

## 1. MARK DOOR

Mark center of door edge and center hole on door face through guide on template. (Backset 60mm fitting all doors from 35mm to 50mm thickness).

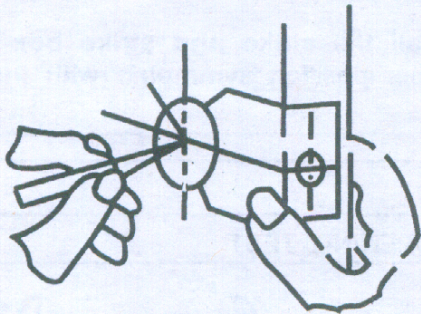

## 3. INSTALL STRIKE

Install strike as illustrated and make sure it is set to the same height as the latch.

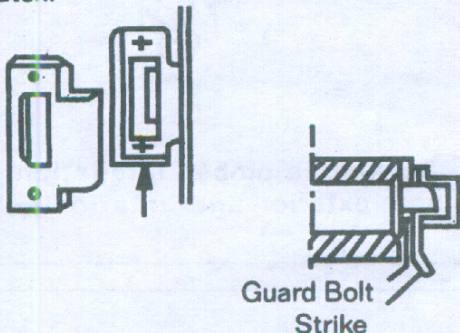

## 5. INSTALL INTERIOR LEVER

Turn interior lever so that assembly and rose can be placed on spindle (The knob must be placed in same level with Connect bar Tighten screws).

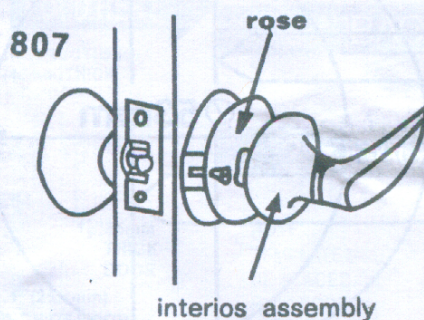

## 2. DRILL TWO HOLES AND INSTALL LATCH

Drill 53mm hole through door face as marked for lockset and 23mm hole in center of door edge for latch. Make sure the hole for latch can be inserted right into the door edge. Then chisel a small place until latch face is flush with door edge.

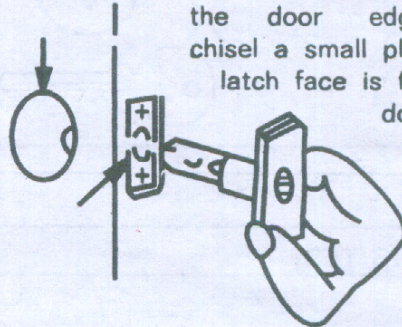

## 4. INSTALL EXTERIOR KNOB

Install knob with spindle into latch making certain that stems are positioned correctly through latch hole. press flush against door.

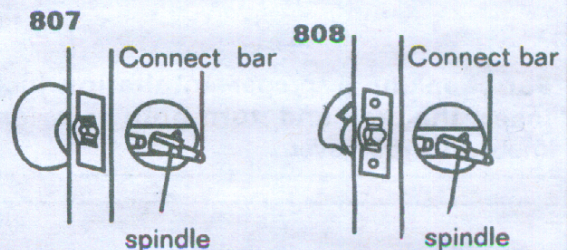

## 5. INSTALL INTERIOR LEVER

Turn interior lever so that assembly and rose can be placed on spindle (The lever must be placed in same level with Connect bar Tighten screws).

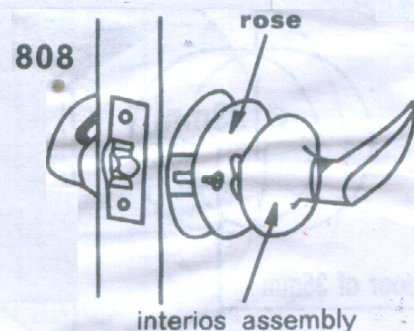



## 6. CHANGE LOCK HAND

If key hole is placed in erroneous position depress retainer and slide knob off. Turn exterior knob 180° and replace knob back.

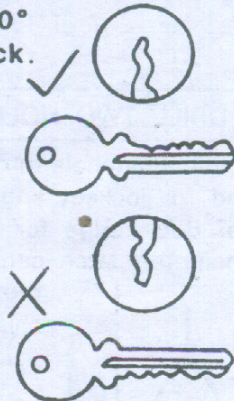

## 7. ACCESSORIES

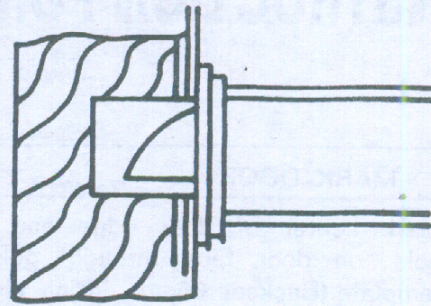

Install the strike and strike box in the proper position symmetric with the latch

## 8. OPENING TEST

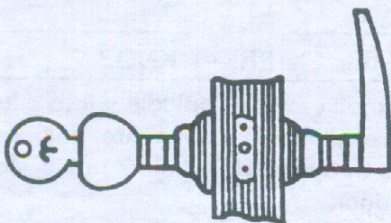

807

For checking a proper intallation just insert the key and turn both exterior knob interior lever.

## 8. OPENING TEST

808

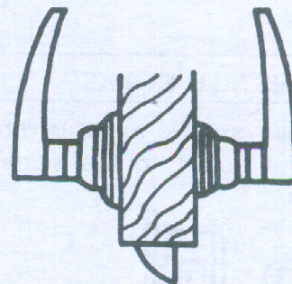

For checking a proper intallation just turn both exterior and interior levers.

# PAPER MARKER

## TUBULAR LOCKSETS TEMPALTE

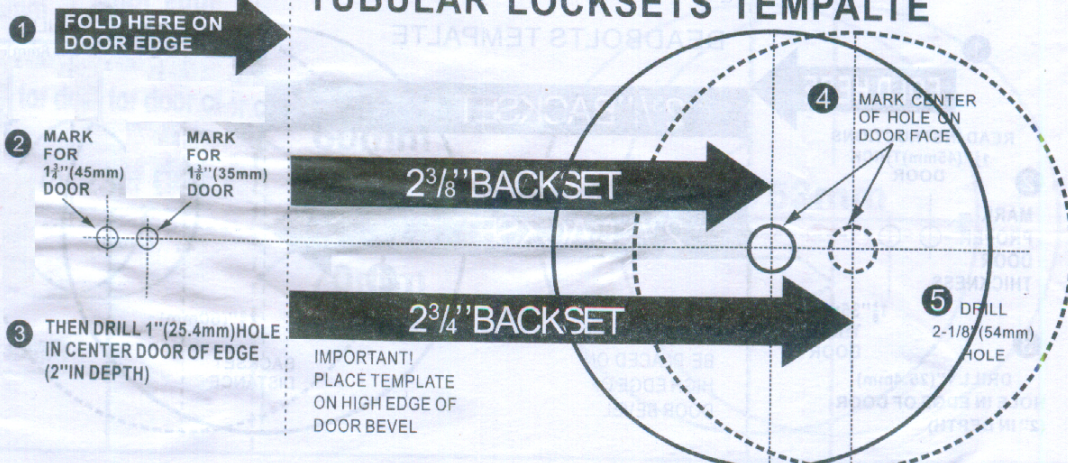



# INSTRUCTIONS FOR INSTALLATION OF SINGLE AND DOUBLE CYLINDER DEADLOCKS

FOR USE ON DOORS 1-3/8" TO 1-3/4" (35mm-45mm)

<b>1. MARK DOOR</b> <b>A.</b> Fold and apply template to high edge of door bevel and mark center of door edge as indicated on template at the desired height from the floor.	<b>B.</b> Mark center hole on door face through guide on template for either 2-3/8" (60mm) or 2-3/4" (70mm) backset.	<b>5. INSTALL EXTERIOR MECHANISM</b> <b>A.</b> Press cylinder side flush against door making certain the torque blade is properly positioned in latch cam. <b>B.</b> Tapped holes in exterior cylinder should be lined up with latch holes. Key hole should be in down position. <b>TORQUE BLADE SHOULD BE HORIZONTALLY INSERTED INTO LATCH CAM.</b>
<b>2. DRILL HOLES</b> <b>A.</b> Drill thru door face as marked for lockset. It is recommended that holes be drilled from both sides to prevent splitting. Hole size is 2" (50.8mm) for standard installations.	<b>B.</b> Drill 1" (25mm) hole in center of door edge thru to 2" (50.8mm) hole for latch.	<b>6. INSTALL INTERIOR MECHANISM</b> <b>A.</b> Slide turn piece onto torque blade. <b>B.</b> Insert machine screws through holes engaging holes in cylinder and tighten.
<b>3. INSTALL LATCH</b> <b>A.</b> Insert latch in hole keeping it parallel to face of door. Mark outline and remove latch!	<b>B.</b> Chisel 1/8" deep or until latch face is flush with door edge.	<b>INSTRUCTIONS FOR INSTALLING DOUBLE CYLINDER DEADLOCKS</b> Exterior half is fully assembled with exterior torque blade. <b>EXTERIOR TORQUE BLADE</b> <b>NOTE:</b> This assembly is placed through latch first
<b>C.</b> Install deadbolt latch in up position into hole as shown on latch. Insert and tighten screws.	<b>D.</b> For drive-in deadbolt, press flush to door edge. Bolt must be vertically aligned with door edge as indicated by arrow.	<b>A. Install interior cylinder</b> <b>INTERIOR TORQUE BLADE</b> <b>NOTE:</b> The interior torque blade is inserted into the exterior blade.
<b>4. INSTALL STRIKE</b> <b>A.</b> Bore 1" hole 1" minimum deep for deadbolt.	<b>B.</b> Mortise 1/16" deep for strike locating from 1" hole in door. Insert and tighten screws	<b>B.</b> Press interior assembly flush against door making certain the torque blade is properly positioned in latch cam. Key hole should be in down position. <b>C.</b> Insert (2) two screws through countersunk holes engaging holes in exterior cylinder and tighten.

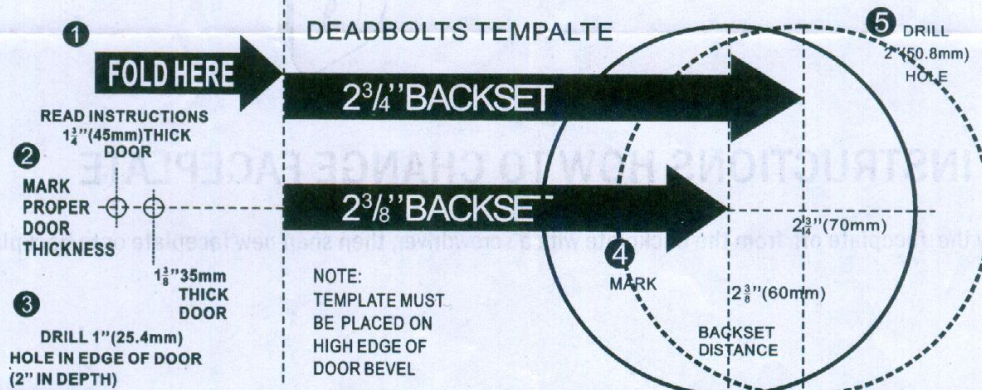



## INSTRUCTIONS FOR HOW TO USE THE ADJUSTABLE LATCH

1. The latch is factory preset at 2-3/8" (60mm) backset, which is standard for most doors.
2. To use the 2-3/8" (60mm) backset, no adjustment is required, simply insert the screw stems on the outside knobs thru holes (A) and (C) of the latch and proceed with installation of lockset
3. To adjust latch to 2-3/4" position, hold rear of latch and rotate latch case 1/2 turn pulling front of latch forward until pin snaps into the 2-3/4" (70mm) position.
4. To return the latch to the 2-3/8" (60mm) position, repeat above BUT push back with thumb on the latch bolt and push latch bolt and latch case simultaneously.

NOTE: The latch must be in the retracted position before attempting adjustment.

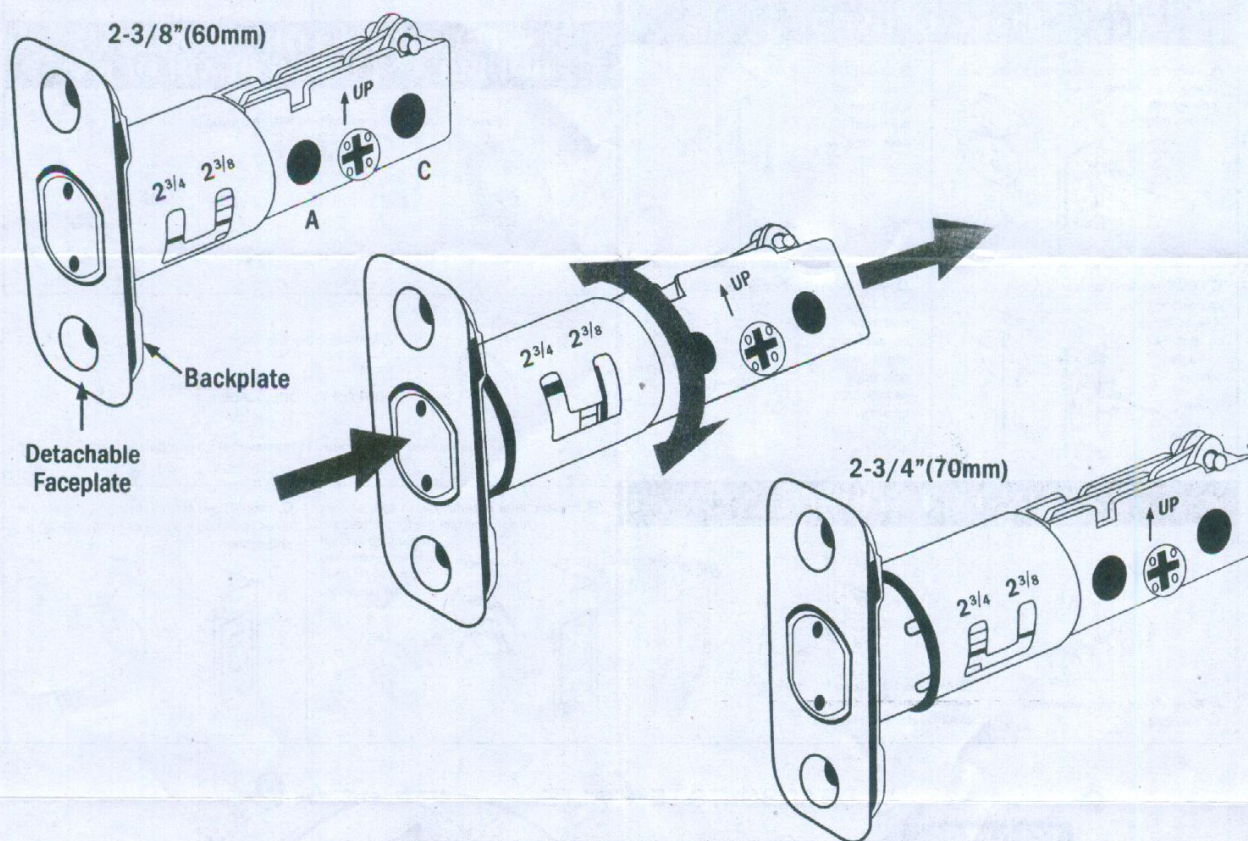

## INSTRUCTIONS HOW TO CHANGE FACEPLATE

1. Gently pry the faceplate off from the backplate with a screwdriver, then snap new faceplate onto backplate.