

Installation Guideline

It should be installed over the substrates where are firmly fixed, flat, clean, dry, and free of contaminants such as dust, oil, paint, sealers, etc. to ensure proper adhesion. Wet areas need special attention and require appropriate substrates, e.g., concrete, cement boards (compressed sheet), and/or treated plywood. The use of reinforced waterproof membranes is suggested.



1. Tools needed



2.Measure the area, determine the quantity needed, have a few as extra. Layout the tiles to your plan first, and using the glass tile nipper and scissors to pre-cut the tiles fitting around any outlets, corners, and window frames.

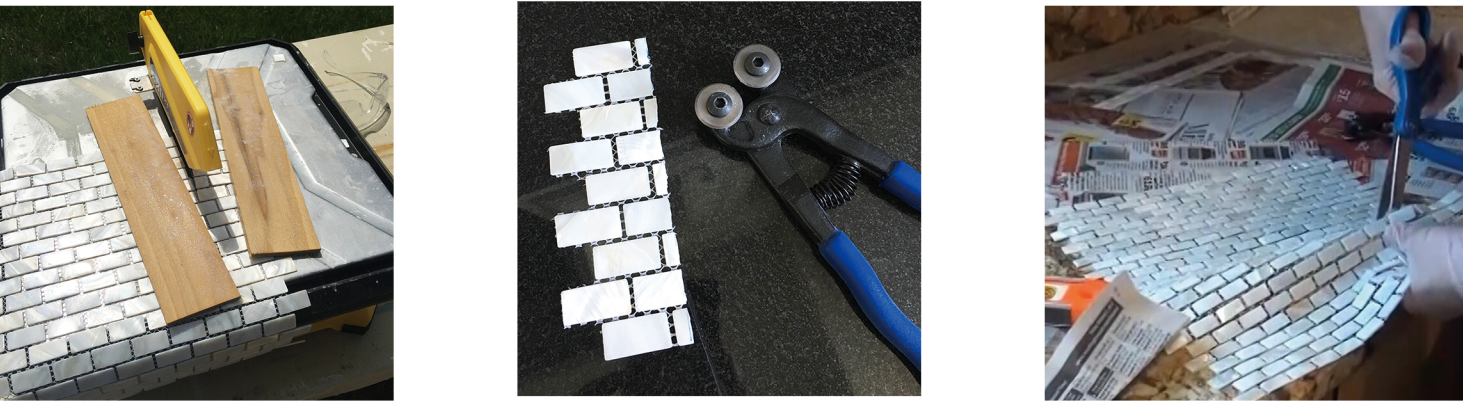

3. It can be set by a thin-set mortar or tile setting mat, opt the one that suitable for you.

1)If to use thin-set mortar, apply the adhesive with a 3/16" trowel. Due to the thickness of this product(3/16" thick), we do not recommend using a square notched trowel greater than 1/8". Set the tile in place,gently tapping it in with a grout float to ensure 100% adhesive coverage.Clean excess adhesive before it completely dries on the tiles with a damp cloth or sponge.



2) If to use the tile setting mat. Peel off the backing paper, place the mat in position and mark cuts if needed. Cut the mat with scissors or utility knife. Flatten air bubbles and creases. Cover all surfaces to be tiled. Cut a corner from the end of the mat to facilitate folding or corner. Set the tiles onto the mat evenly.



4. Grouting. (For the seamless version skip this step) After the tiles are firmly set (For thin-set mortar,approximately 24 hours after installation. For tile setting mat, within 24 hours usually) clean the surface with a clean, damp sponge. We recommend using a non-sanded grout. Excess grout should be cleaned from the surface as the work progresses, while grout is fresh and before it hardens. Prior to grouting, testing a small area to make sure the surface does not scratch during grouting.



5. Caulking. Using a tile caulk and a set of caulking tools to caulk any seams, like where the tile meets the walls and where the tile meets the counters.



6. Seal the tiles and grout lines after grouting. We recommend using the DuPont™ StoneTech® Professional Sealer or 511 Impregnator to seal shell mosaic tile.

