

USE AND CARE GUIDE

SMALL HALL TREE WITH 4 DOORS

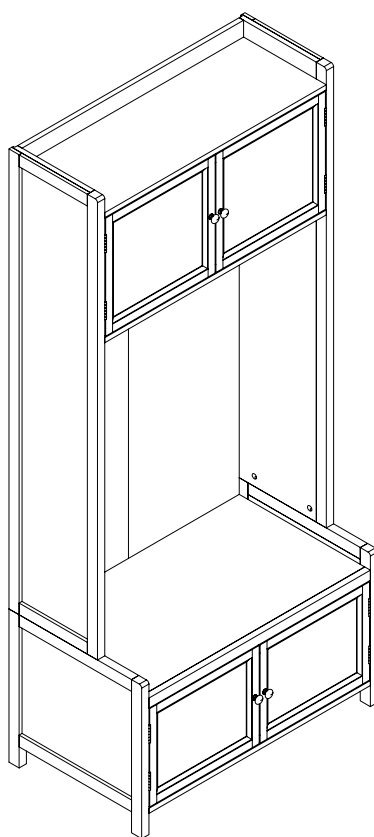

Questions, problems, missing parts? Before returning to the store,
call Home Decorators Collection Customer Service.
8 a.m. – 7 p.m., EST, Monday – Friday, 9 a.m. – 6 p.m., EST, Saturday

1-800-998-7021

[HOMEDEPOT.COM/HOMEDECORATORS](https://www.homedepot.com/homedecorators)

THANK YOU

We appreciate the trust and confidence you have placed in Home Decorators Collection through the purchase of this small hall tree with 4 doors. We strive to continually create quality products designed to enhance your home. Visit us online to see our full line of products available for your home improvement needs. Thank you for choosing Home Decorators Collection!

Table of Contents

Table of Contents.....	2	Hardware Included.....	3
Safety Information.....	2	Pre-assembly (continued).....	4
Warranty.....	2	Package Contents.....	4
3 Year Warranty.....	2	Assembly.....	5
What is Covered.....	2		
What is Not Covered.....	2		
Pre-assembly.....	3		
Planning Assembly.....	3		
Tools Required.....	3		

Safety Information



DANGER

- Keep small parts away from children during assembly.
- Read and follow instructions carefully.



WARNING

- Read these instructions carefully and keep in a safe place.
- TO GUARANTEE THE SAFE USE OF THIS PRODUCT, FOLLOW THE WARNINGS, GUIDELINES AND RECOMMENDATIONS IN THIS MANUAL.
- Adult assembly required.
- Small parts may present choking hazard prior to assembly.
- Do not place heavy objects on the glass top.
- Some assembly may involve attaching glass or mirrors.
- Be very careful handling the glass or mirrors, as severe injury may result if the glass or mirror breaks.
- Never handle large pieces of glass or mirrors by yourself.



CAUTION

- Do not use power tools to assemble your furniture. Power tools may strip or damage parts/product.
- Do not overtighten connectors (screws, bolts, etc.). Overtightening can lead to product damage.
- Be sure to check all packing materials carefully for small parts that may have come loose inside the carton during shipment. If parts are missing, contact THE HOME DEPOT to obtain any missing parts.
- DO NOT USE SUBSTITUTE PARTS.
- This product should only be used on a flat, level surface.

Warranty

3 YEAR WARRANTY

WHAT IS COVERED

We guarantee this product to be free of manufacturing defects to the original purchaser for three years.

WHAT IS NOT COVERED

This warranty does not cover commercial use, acts of nature, and abusive use.

Pre-assembly

PLANNING ASSEMBLY

Keep children and pets away from build area. Make sure your area is large enough to unpack, sort and assemble the unit.

TOOLS REQUIRED

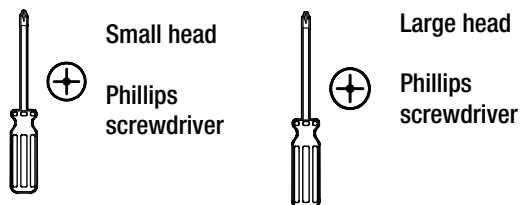

HARDWARE INCLUDED



NOTE: Hardware not shown to actual size.

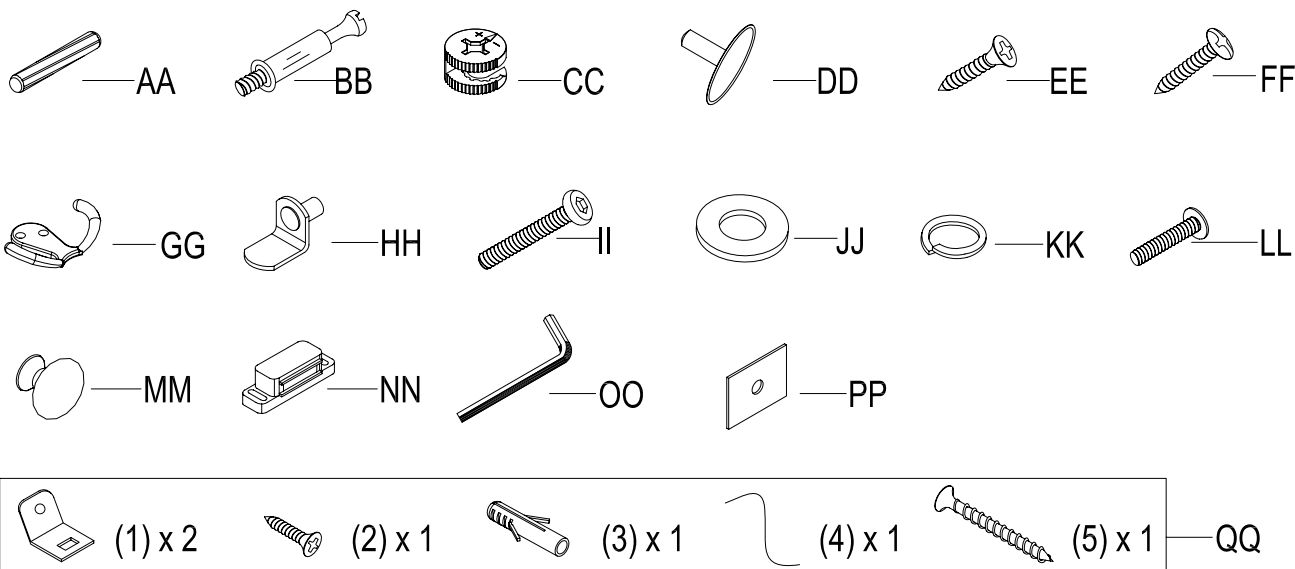

Part	Description	Quantity
AA	Wood dowel	34
BB	Cam lock bolt	28
CC	Cam lock	28
DD	Plastic cover	12
EE	1/2 in. Flat head screw	22
FF	5/8 in. Round head screw	45
GG	Pothook	3
HH	Shelf support	8

Part	Description	Quantity
II	Bolt	4
JJ	Washer	4
KK	Spring washer	4
LL	Knob bolt	4
MM	Knob	4
NN	Magnet	4
OO	Wrench	1
PP	Metal plate	4
QQ	Anti-tipping hardware package	1

Pre-assembly (continued)

PACKAGE CONTENTS

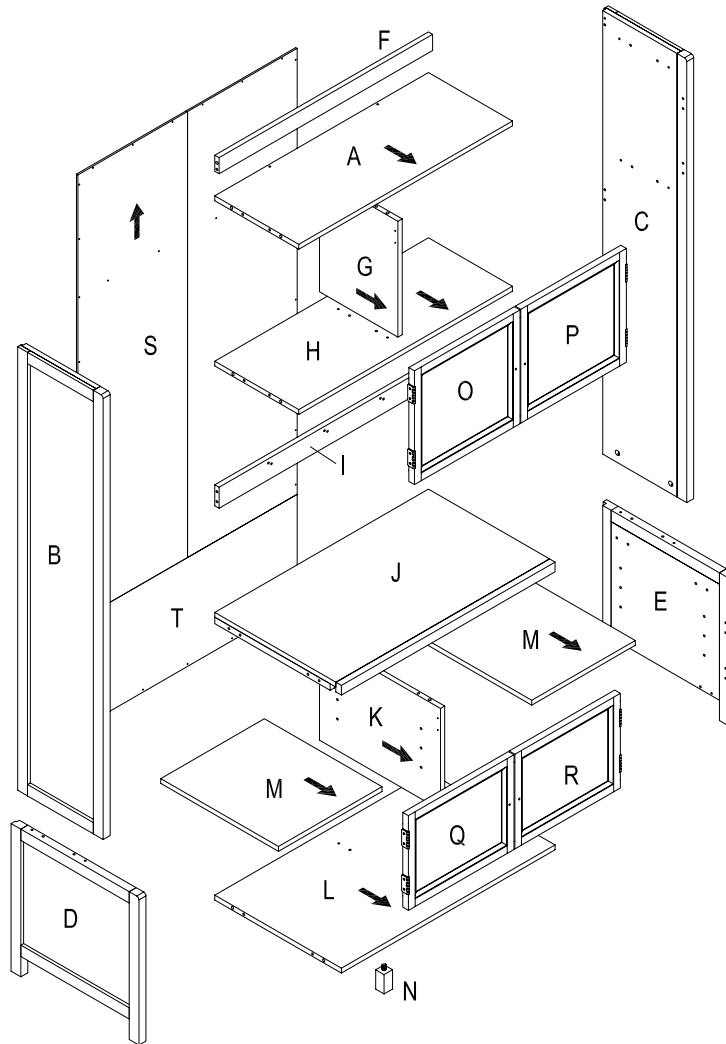

Part	Description	Quantity
A	Top panel	1
B	Top left side panel	1
C	Top right side panel	1
D	Bottom left side panel	1
E	Bottom right side panel	1
F	Top crossbar	1
G	Top partition	1
H	Top fixed panel	1
I	Bottom crossbar	1
J	Bottom fixed panel	1
K	Bottom partition	1
L	Bottom panel	1
M	Adjustable shelf	2
N	Foot	1
O	Top left door	1
P	Top right door	1
Q	Bottom left door	1
R	Bottom right door	1
S	Top back panel	1
T	Bottom back panel	1

Assembly

1 Attaching the top partition to the top panel

- a) Install dowel (AA) and bolt (BB) into panel (A).

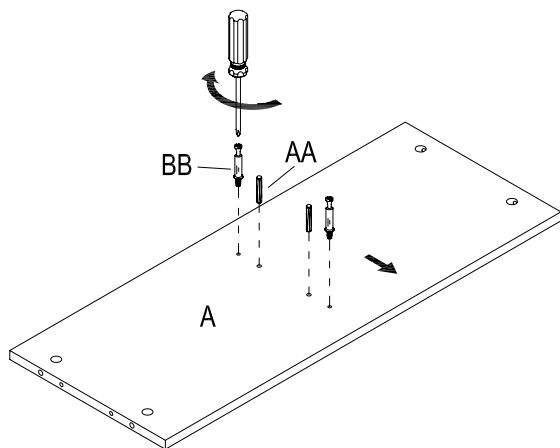

- b) Attach magnet (NN) to partition (G) with screw (FF). Insert lock (CC) into partition (G).

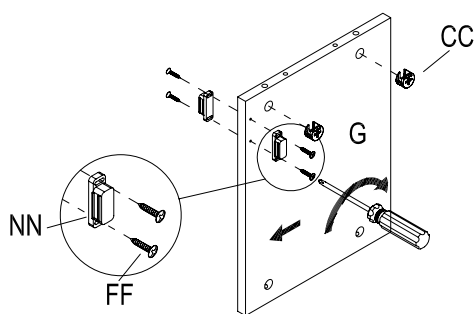

- c) Join panel (A) to the partition (G) with dowel (AA).

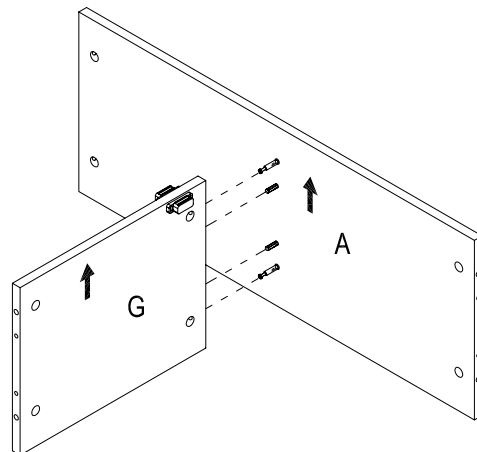

- d) Tighten bolt (BB) with lock (CC) in the pre-drilled holes.

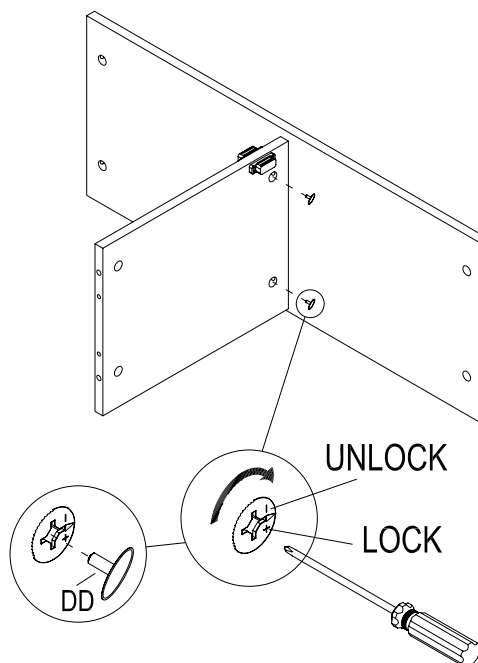

- e) Cover the cam holes with the cover (DD).

Wood dowel	Cam lock bolt	Cam lock	Plastic cover	5/8 in. Round head screw	Magnet	Small head	Large head
(AA) x 2	(BB) x 2	(CC) x 2	(DD) x 2	(FF) x 4	(NN) x 2		

Assembly (continued)

2 Attaching the top fixed panel

- a) Install dowel (AA) and bolt (BB) into panel (H).

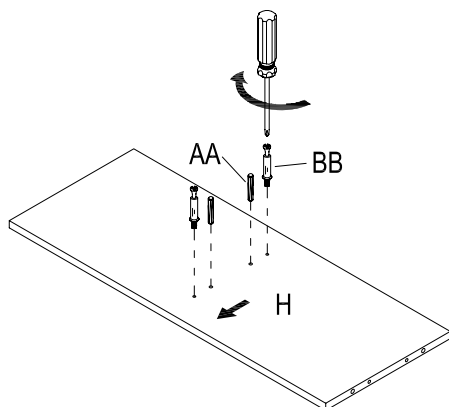

- b) Insert lock (CC) into partition (G).

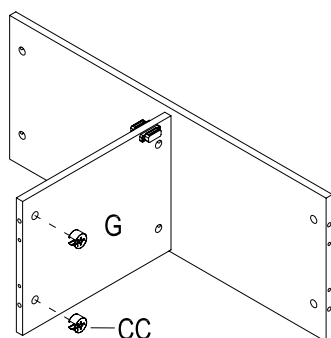

- c) Join panel (H) to the partition (G) with dowel (AA).

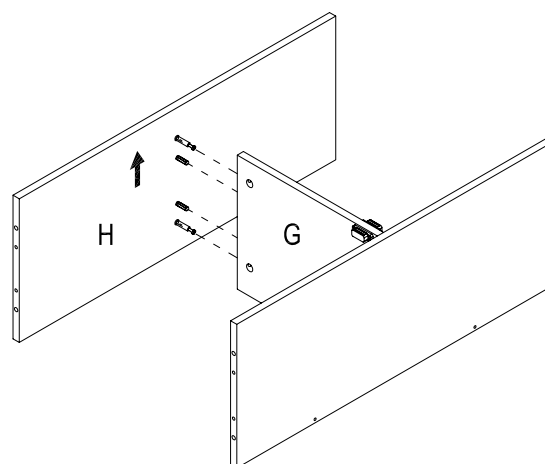

- d) Tighten bolt (BB) with lock (CC) in the pre-drilled holes.

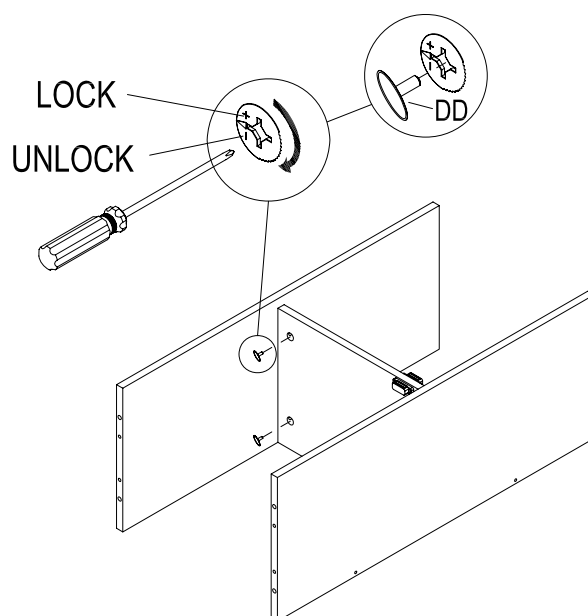

- e) Cover the cam holes with the cover (DD).

Wood dowel Cam lock bolt Cam lock Plastic cover

(AA) x 2

(BB) x 2

(CC) x 2

(DD) x 2

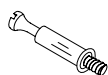

Small head

Large head

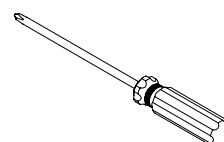
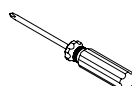

Assembly (continued)

3 Attaching the top crossbar

- a) Install bolt (BB) into panel (A).

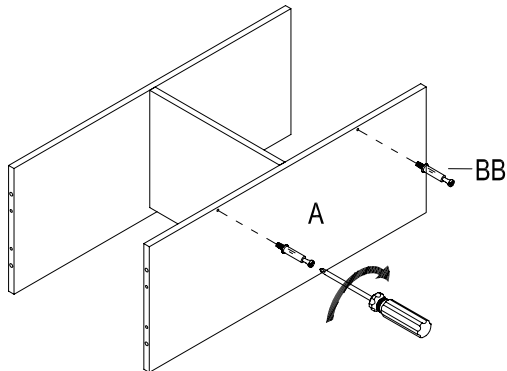

- b) Insert lock (CC) into bar (F).

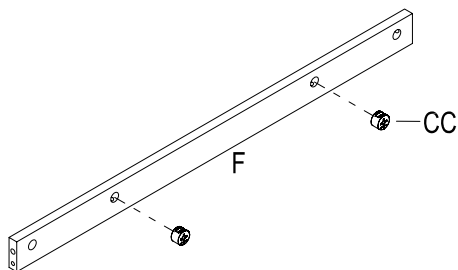

- c) Join bar (F) to the panel (A) with bolt (BB).

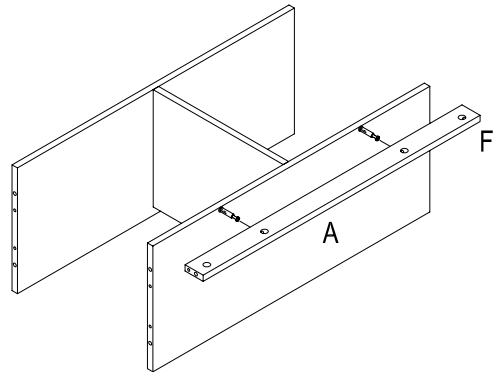

- d) Tighten bolt (BB) with lock (CC) in the pre-drilled holes.

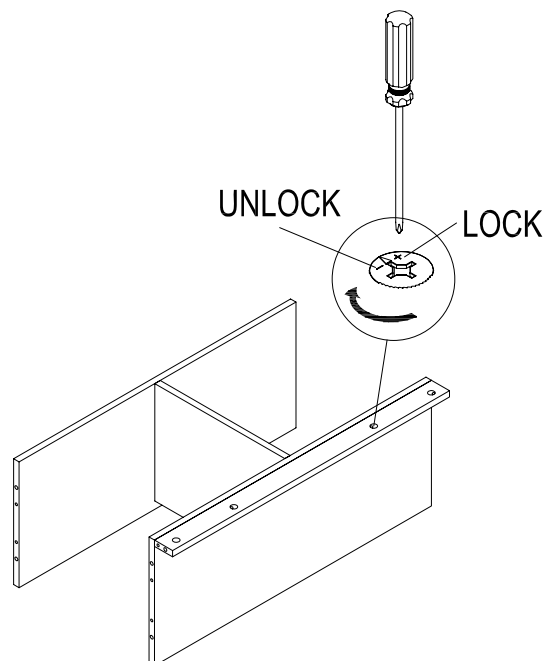

Cam lock bolt Cam lock Small head Large head

(BB) x 2

(CC) x 2

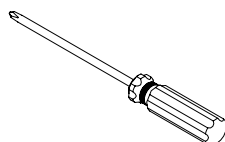
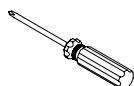

Assembly (continued)

4 Attaching the top right side panel

- a) Install dowel (AA) and bolt (BB) into panel (C).

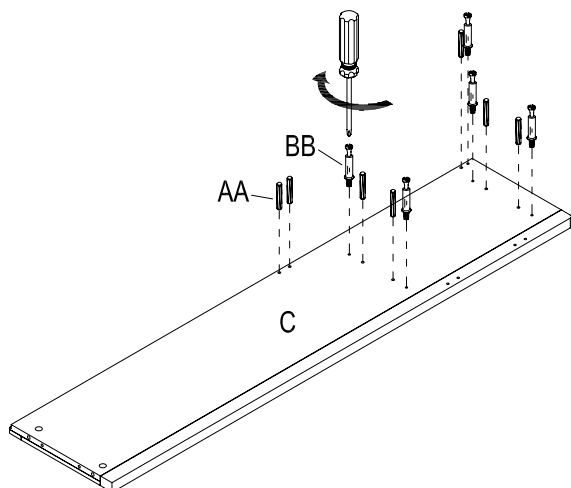

- b) Insert lock (CC) into panels (A) and (H).

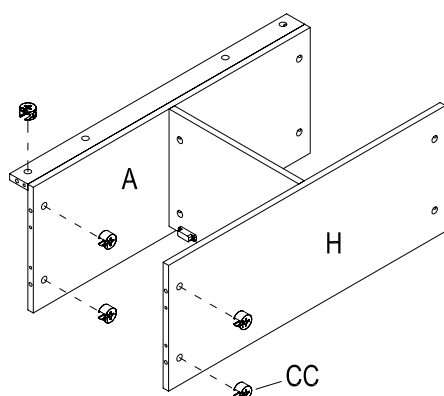

- c) Join panel (C) to the assembled body with dowel (AA).

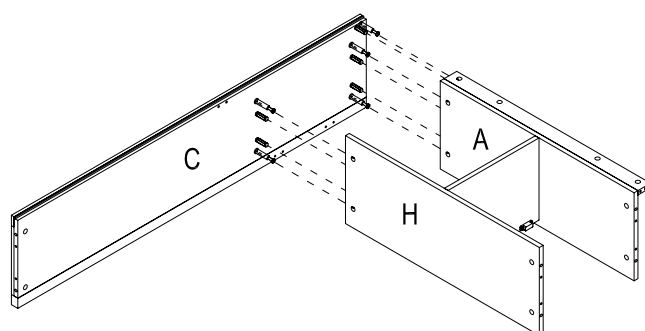

- d) Tighten bolt (BB) with lock (CC) in the pre-drilled holes.

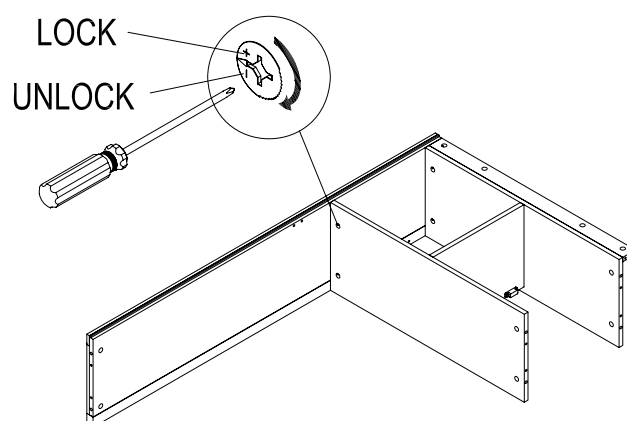

Wood dowel

Cam lock bolt

Cam lock

Small head

Large head

(AA) x 5

(BB) x 5

(CC) x 5

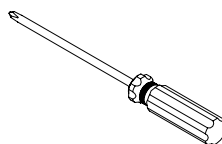
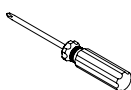
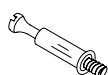

Assembly (continued)

5 Attaching the top left side panel and bottom crossbar

- a) Install dowel (AA) bolt (BB) into panel (B).

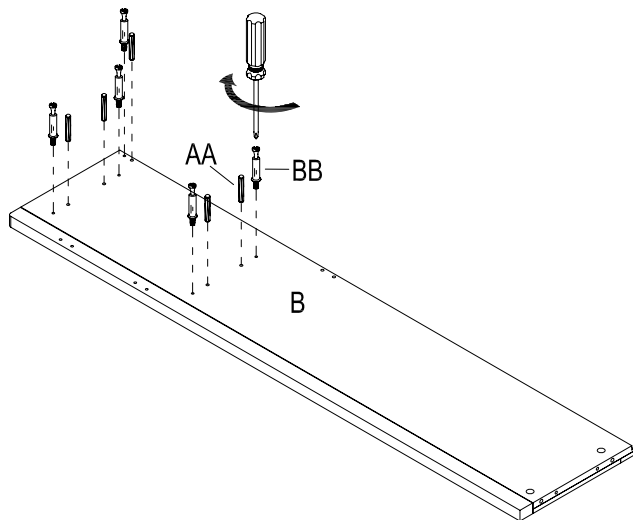

- b) Attach pothook (GG) to bar (I) with screw (EE) as shown.

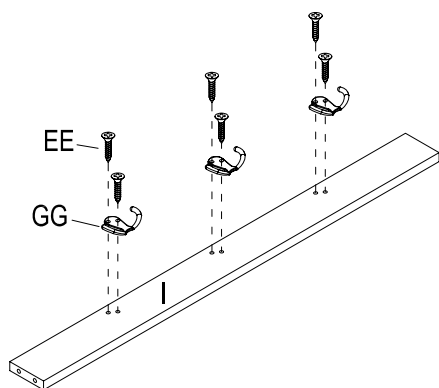

- c) Insert lock (CC) into panels (A) and (H), and bar (F).

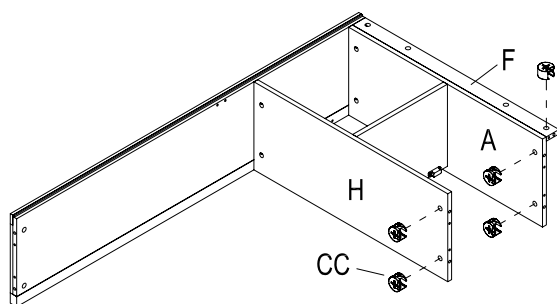

- d) Join panel (B) and bar (I) to the assembled body with dowel (AA).

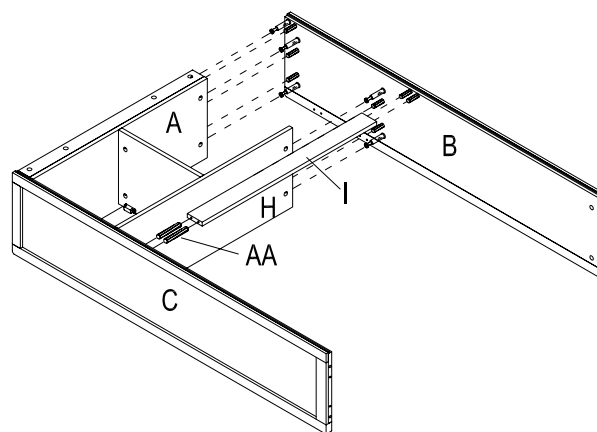

- e) Tighten bolt (BB) with lock (CC) in the pre-drilled holes.

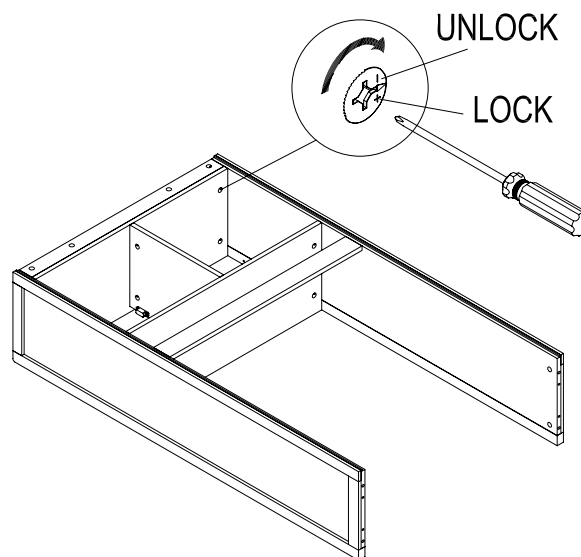

Wood dowel

Cam lock bolt

Cam lock

Pothook

1/2 in. Flat head screw

Small head

Large head

(AA) x 9

(BB) x 5

(CC) x 5

(GG) x 3

(EE) x 6

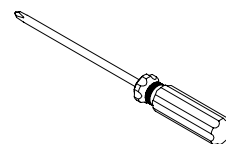
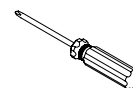
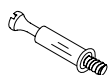

Assembly (continued)

6 Attaching the bottom partition to the bottom fixed panel

- a) Install dowel (AA) bolt (BB) into panel (J).

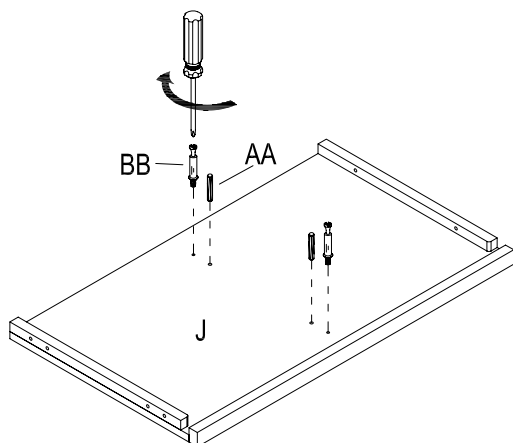

- b) Attach magnet (NN) to partition (K) with screw (FF). Insert lock (CC) into partition (K).

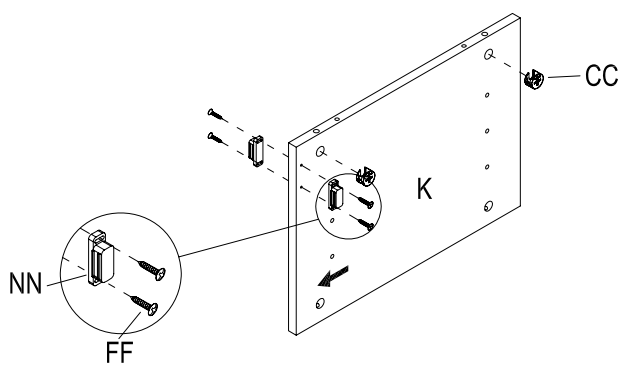

- c) Join panel (J) to the partition (J) with dowel (AA).

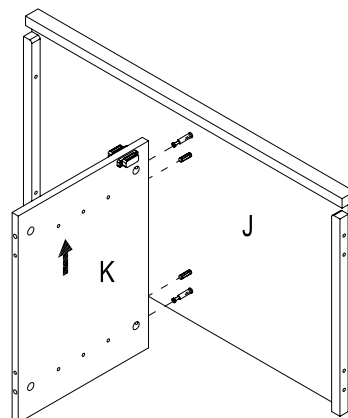

- d) Tighten bolt (BB) with lock (CC) in the pre-drilled holes.

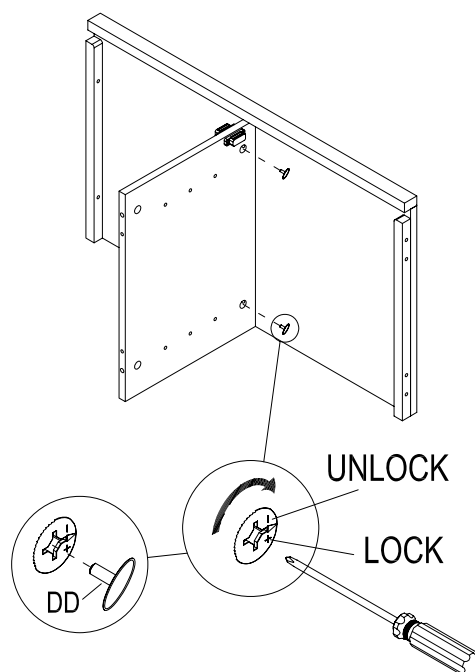

- e) Cover the cam holes with the cover (DD).

Wood dowel	Cam lock bolt	Cam lock	Plastic cover	5/8 in. Round head screw	Magnet	Small head	Large head
(AA) x 2	(BB) x 2	(CC) x 2	(DD) x 2	(FF) x 4	(NN) x 2		

Assembly (continued)

7 Attaching the bottom panel

- a) Install dowel (AA) bolt (BB) into panel (L).

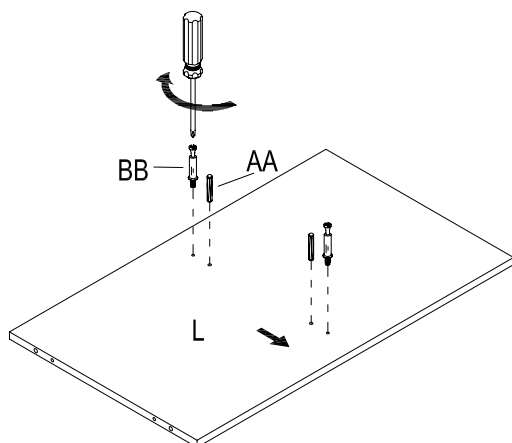

- b) Insert lock (CC) into partition (K).

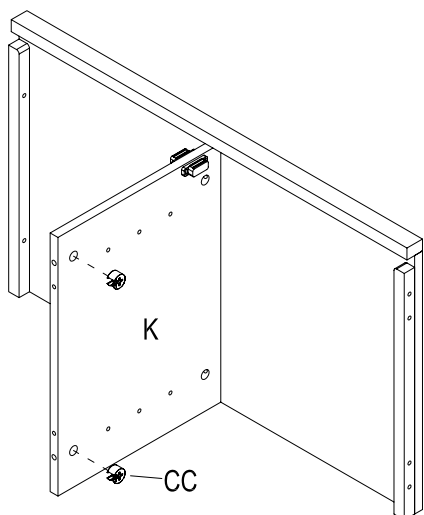

- c) Join panel (L) to the partition (K) with dowel (AA).

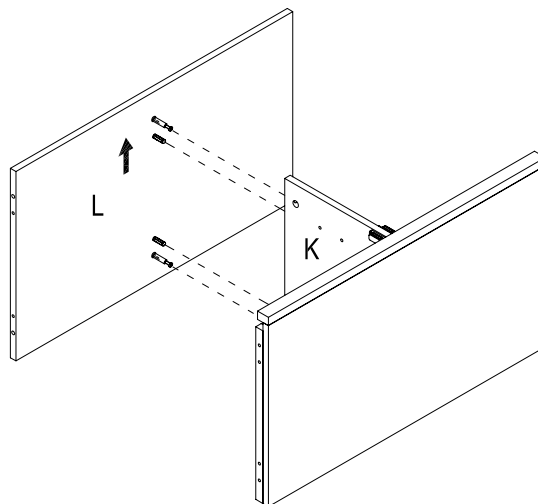

- d) Tighten bolt (BB) with lock (CC) in the pre-drilled holes. Cover the cam holes with the cover (DD).

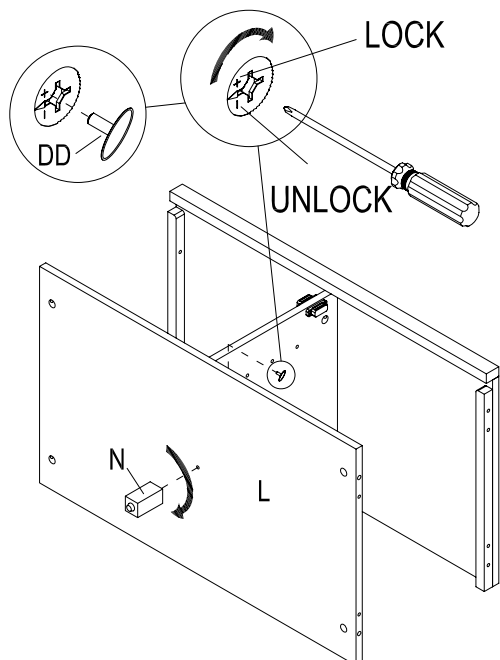

- e) Tighten foot (N) to panel (L).

Wood dowel Cam lock bolt Cam lock Plastic cover

(AA) x 2

(BB) x 2

(CC) x 2

(DD) x 2

Small head

Large head

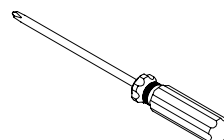
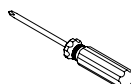
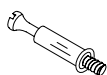

Assembly (continued)

8 Attaching the bottom left side panel

- a) Install dowel (AA) bolt (BB) into panel (D).

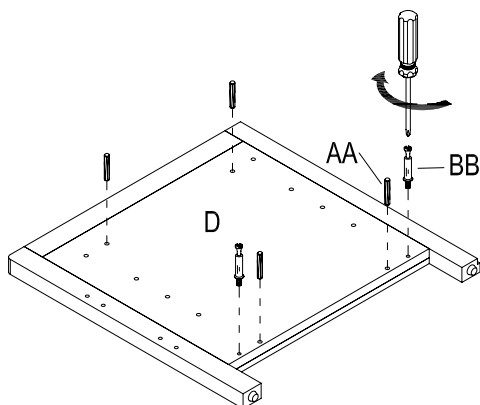

- b) Insert lock (CC) into panel (L).

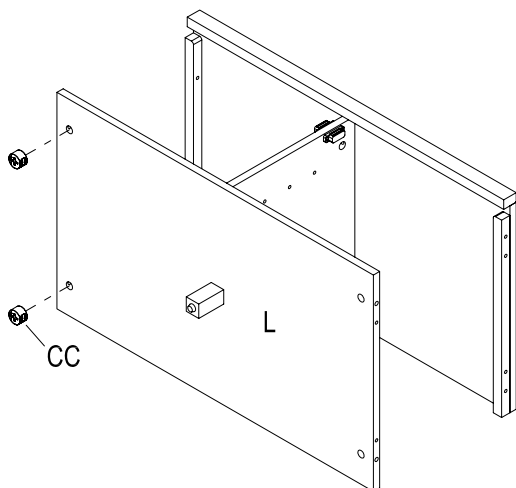

- c) Join panel (D) to the assembled body with dowel (AA).

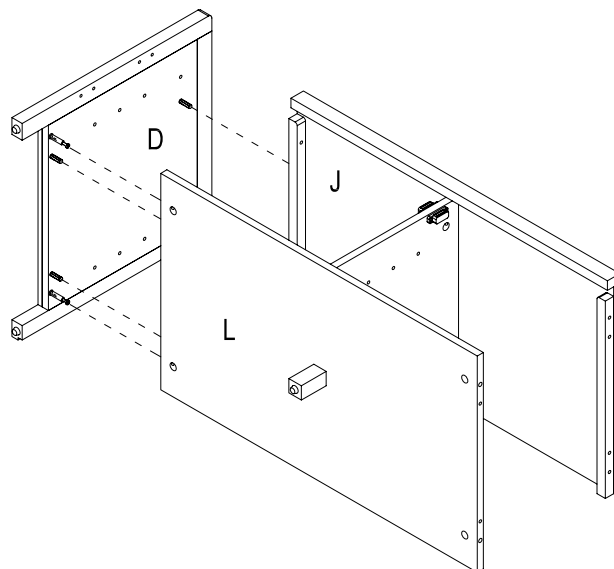

- d) Tighten bolt (BB) with lock (CC) in the pre-drilled holes.

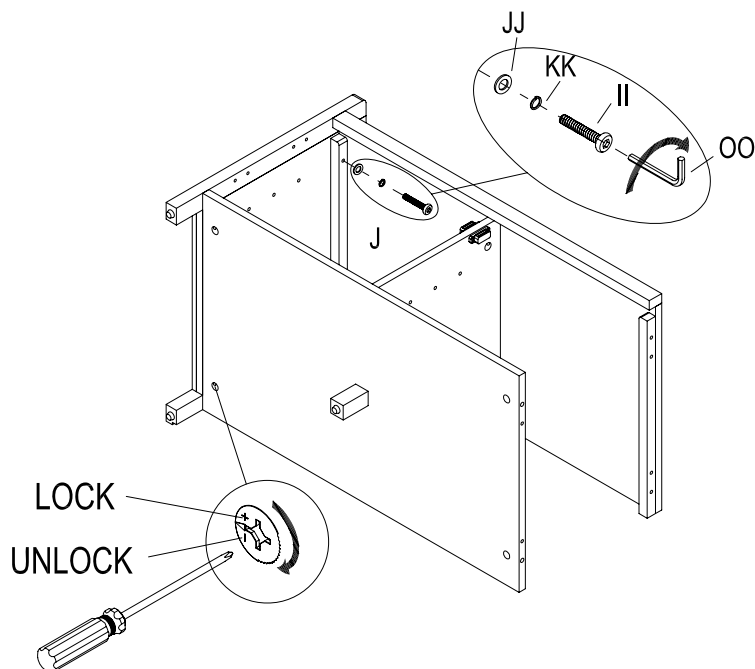

- e) Attach panel (J) with washers (JJ) and (KK), and bolt (II). Turn and tighten bolt (II) with wrench (OO).

Wood dowel Cam lock bolt Cam lock Washer Spring washer Bolt Wrench Small head Large head

(AA) x 4

(BB) x 2

(CC) x 2

(JJ) x 2

(KK) x 2

(II) x 2

(OO) x 1

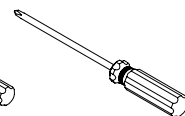
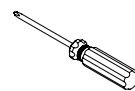
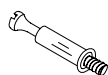

Assembly (continued)

9 Attaching the bottom right side panel

- a) Install dowel (AA) bolt (BB) into panel (E).

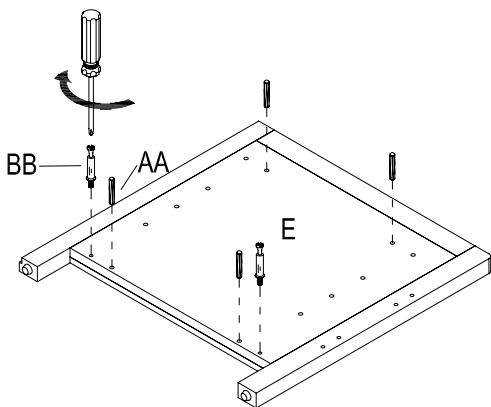

- ☐ **b) Insert lock (CC) into panel (L).**

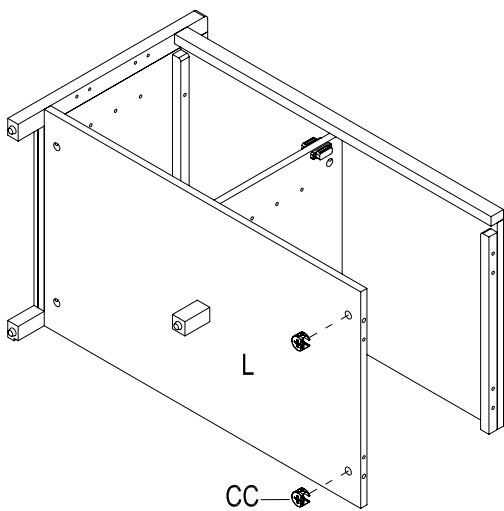

- ☐ c) Join panel (E) to the assembled body with dowel(AA).

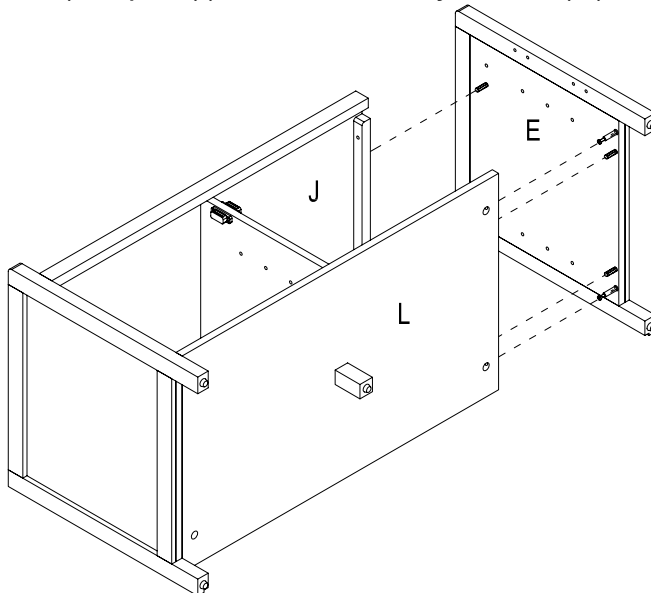

- d) Tighten bolt (BB) with lock (CC) in the pre-drilled holes.

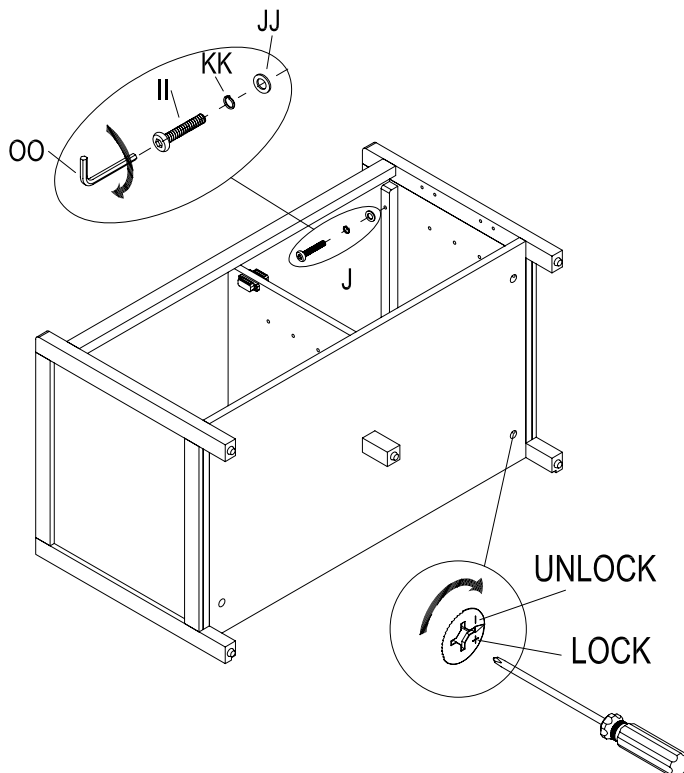

- e) Attach panel (J) with washers (JJ) and (KK), and bolt (II). Turn and tighten bolt (II) with wrench (OO).

Wood dowel	Cam lock bolt	Cam lock	Washer	Spring washer	Bolt	Wrench	Small head	Large head
------------	---------------	----------	--------	---------------	------	--------	------------	------------

(AA) x 4

(BB) x 2

(CC) x 2

(JJ) x 2

(KK) x 2

(II) x 2

(00) x 1

Small head	Large head
------------	------------



Assembly (continued)

10 Attaching the assembled base

- a) Install dowel (AA) bolt (BB) into panels (D) and (E).

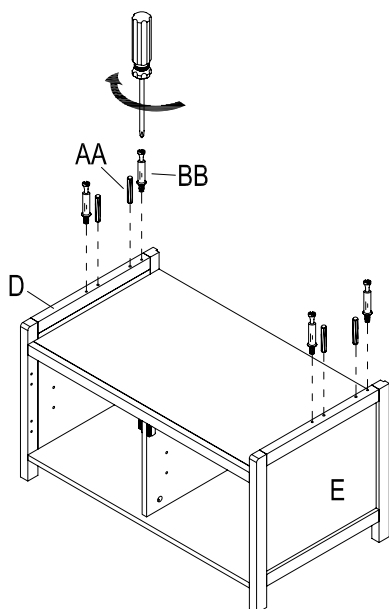

- b) Insert lock (CC) into panels (B) and (C).

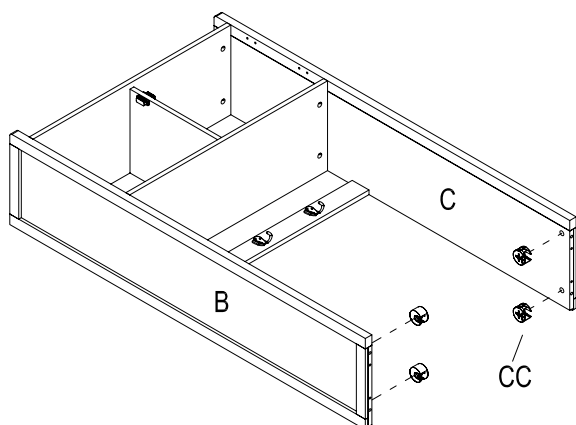

- c) Join panels (B) and (C) to the assembled base with dowel(AA).

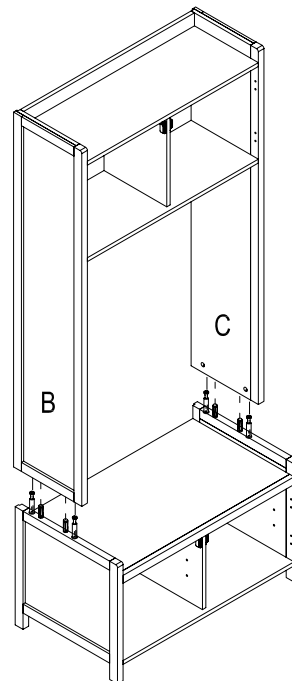

- d) Tighten bolt (BB) with lock (CC) in the pre-drilled holes.

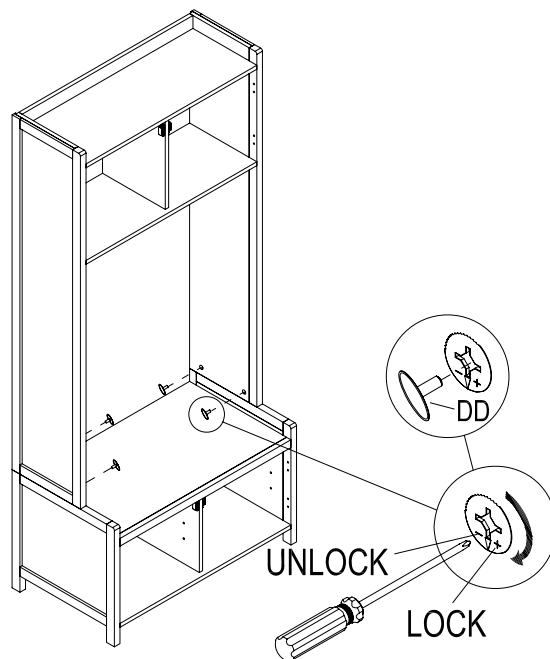

- e) Cover the cam holes with the cover (DD).

Wood dowel Cam lock bolt Cam lock Plastic cover

(AA) x 4

(BB) x 4

(CC) x 4

(DD) x 4

Small head

Large head

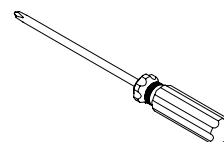
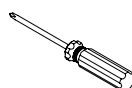
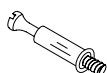

Assembly (continued)

11 Attaching the back panel

- Tighten panels (S) and (T) to the assembled body with screws (FF) and metal plates (PP) as shown.

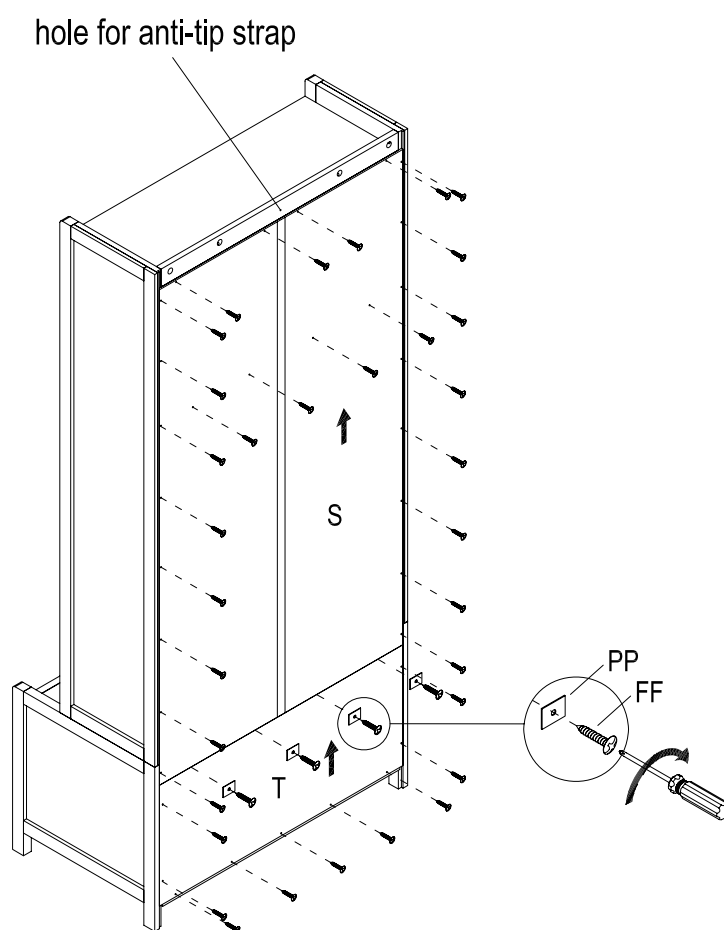

5/8 in. Round head
screw
(FF) x 37



Metal plate
(PP) x 4



Small head

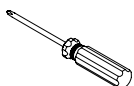

Assembly (continued)

12 Attaching the adjustable shelf

- Insert the shelf supports (HH) in desired positions and place shelf (M) on the supports.

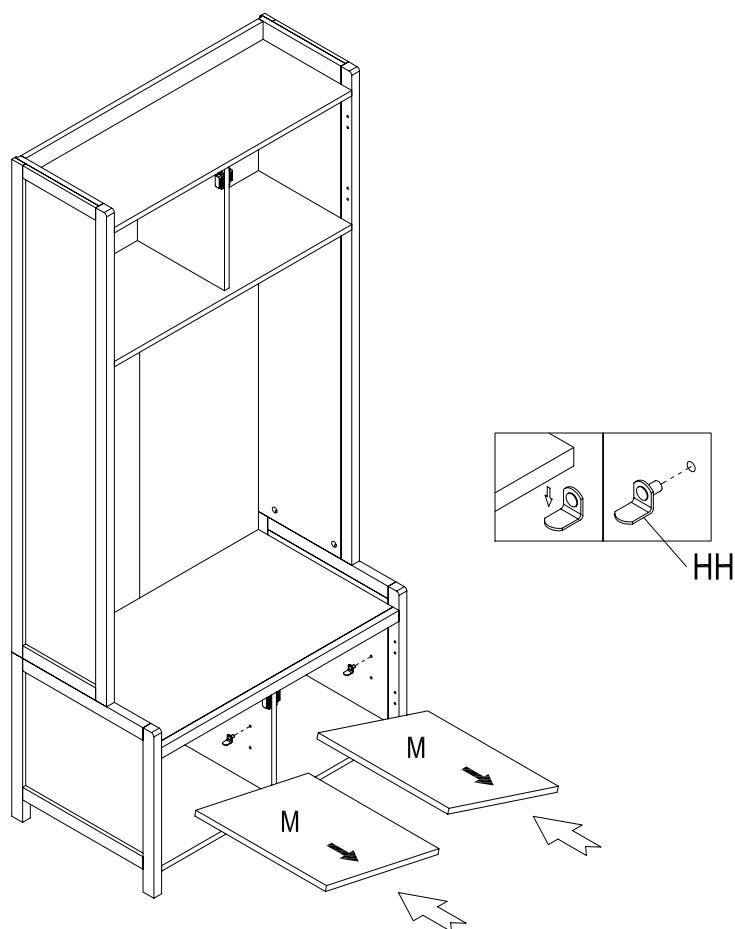

Shelf support

(HH) x 8



Assembly (continued)

13 Attaching the door

- a) Attach doors (O),(P),(Q) and (R) to the assembled body with screw (EE) as shown.

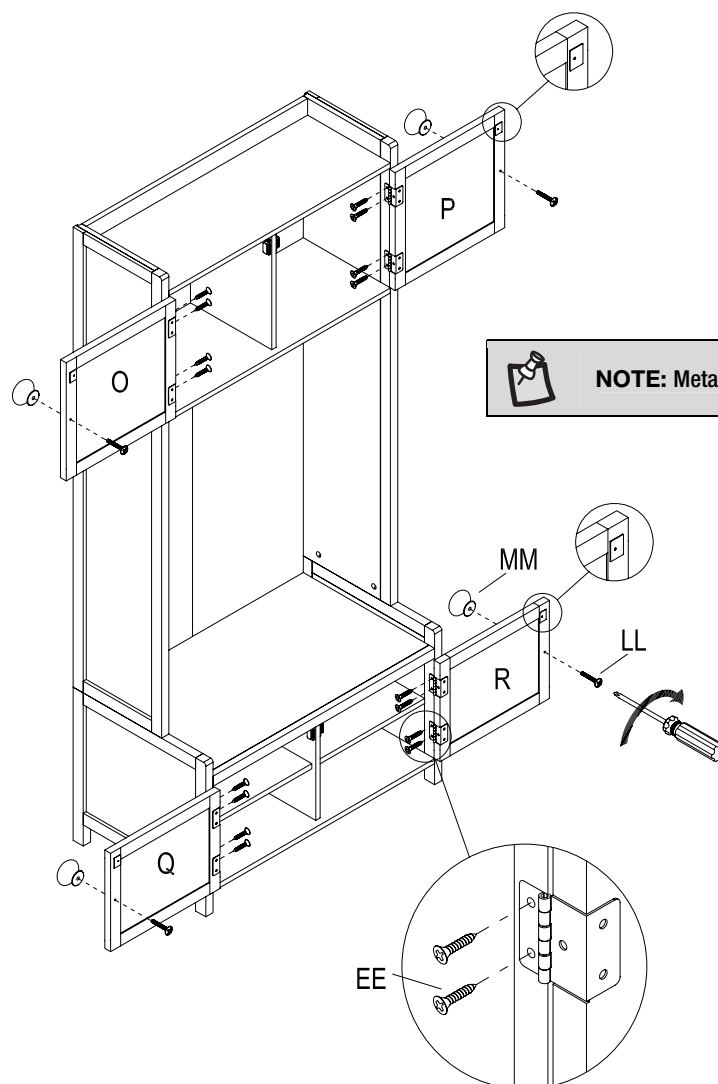

- b) Attach knob (MM) to doors (O),(P),(Q) and (R) with the bolt (LL) .



NOTE: A helper who can hold the door in position makes the door installation easier.

Knob bolt

Knob

1/2 in. Flat head screw

Small head

(LL) x 4

(MM) x 4

(EE) x 16

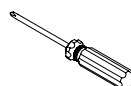

Assembly (continued)

14 Finalizing the assembly

- Install the anti-tipping hardware as shown.

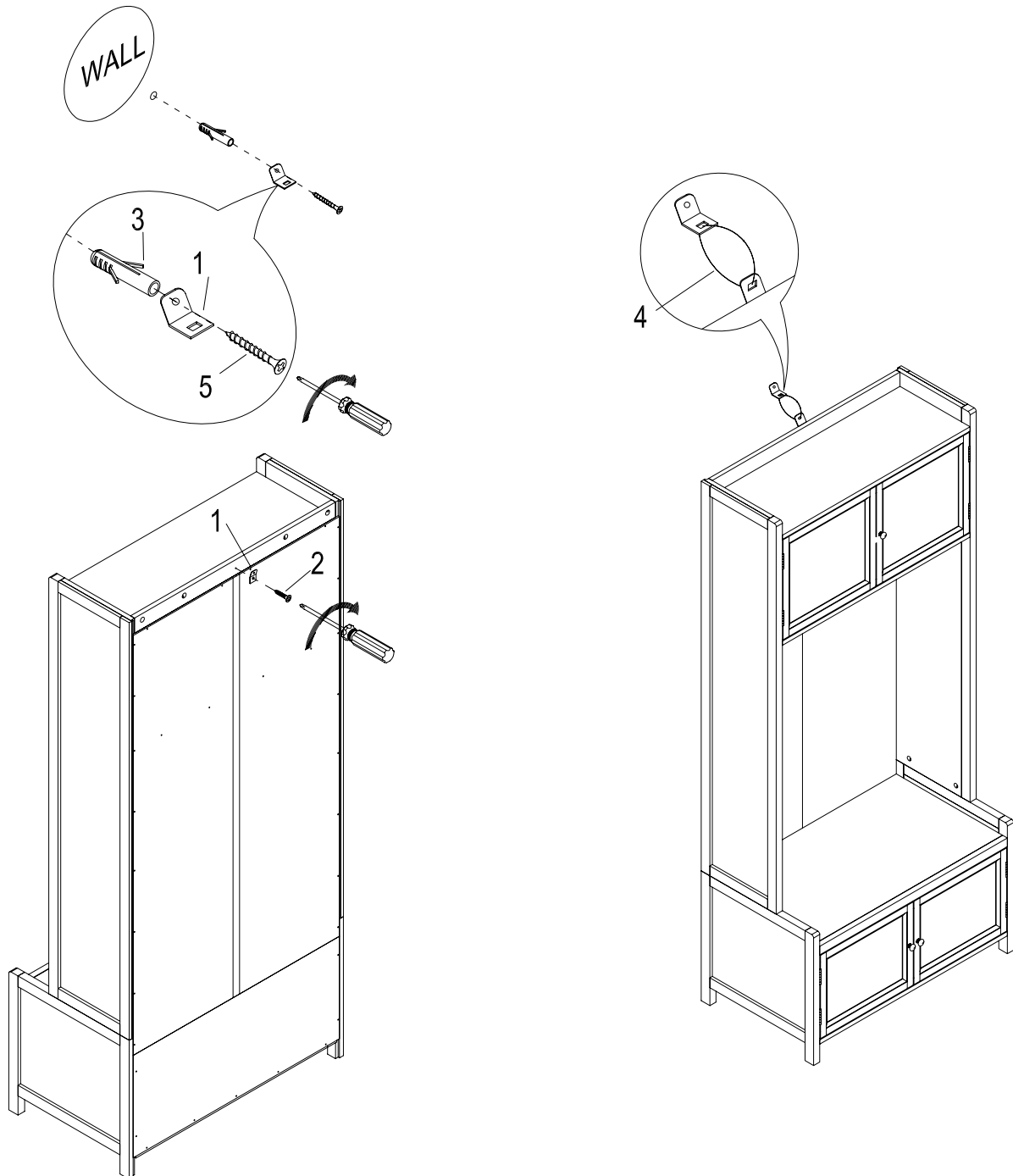

Rectangle
metal plate
(1) x 2



1/2 in. Flat head screw
(2) x 1



Plastic anchor
(3) x 1



Plastic band
(4) x 1



1-1/2 in. Flat head
screw
(5) x 1

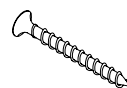

Small head

QQ

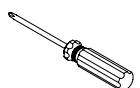

The logo for Home Decorators Collection is centered within a dark gray rectangular box. It features the word "HOME" in a large, white, serif font. Below it, the word "DECORATORS" is written in a smaller, white, sans-serif font. At the bottom, the word "COLLECTION" is written in an even smaller, white, sans-serif font, followed by a registered trademark symbol (®).

HOME DECORATORS COLLECTION®

Questions, problems, missing parts?
Before returning to the store, call Home Decorators Collection Customer Service.
8 a.m. – 7 p.m., EST, Monday – Friday, 9 a.m. – 6 p.m., EST, Saturday

1-800-998-7021

HOMEDEPOT.COM/HOMEDECORATORS

Retain this manual for future use.