

# INSTALLATION MANUAL

## METAL OUTDOOR PARCEL LOCKER

### TYPE 1

### 1590 SERIES

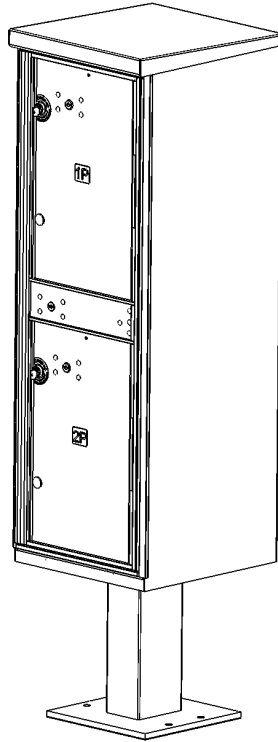

## TABLE OF CONTENTS

<i>DESCRIPTION</i>	<i>PAGE</i>
<i>OPL INFORMATION</i>	<i>2</i>
<i>SECURITY TOOL REQUIREMENTS</i>	<i>3</i>
<i>SITE PREPARATION AND PEDESTAL INSTALLATION</i>	<i>4</i>
<i>INSTALLATION OF THE MASTER LOAD ARROW LOCK</i>	<i>6</i>
<i>PARCEL ARROW LOCK INSTALLATION</i>	<i>8</i>
<i>PEDESTAL TO OPL INSTALLATION</i>	<i>10</i>
<i>NUMBER PLACARDS INSTALLATION</i>	<i>12</i>

**AF FLORENCE**  
manufacturing company

5935 Corporate Drive • Manhattan, KS 66503  
www.florencemailboxes.com • 800.275.1747

A GIBALTAR INDUSTRIES COMPANY   
www.florencemailboxes.com

# OPL INFORMATION

## METAL OPL TYPE I

### 1590 SERIES

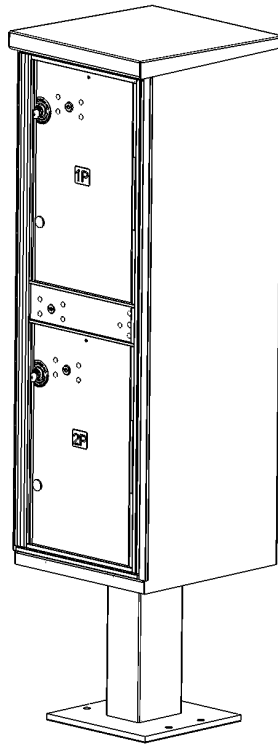

**1590T1AF**

	<i>1590T1AF</i>
<i>INSTALLED HEIGHT</i>	<i>62"</i>
<i>DEPTH</i>	<i>17-7/8"</i>
<i>WIDTH</i>	<i>15-7/8"</i>
<i>WEIGHT (WITHOUT PEDESTAL)</i>	<i>83 LBS</i>
<i>WEIGHT (WITH PEDESTAL)</i>	<i>100 LBS</i>
<i>QTY OF STANDARD COMPARTMENTS</i>	<i>0</i>
<i>QTY OF PARCEL COMPARTMENTS</i>	<i>2</i>
<i>PARCEL COMPARTMENT HEIGHT</i>	<i>19.8"</i>
<i>PARCEL COMPARTMENT WIDTH</i>	<i>12.3"</i>

**SECURITY TOOL REQUIREMENTS**  
**METAL OPL TYPE I**  
**1590 SERIES**

**IMPORTANT NOTICE FOR USPS INSTALLERS**

*USPS PERSONNEL MUST HAVE A McGARD SCREW DRIVER  
(USPS - MAIL EQUIPMENT SHOP PART NUMBER 110050)  
TO INSTALL AND SERVICE THE PARCEL DOOR ARROW LOCK COVER  
ON THE FLORENCE OPL.*

*IF THE  
**McGARD SCREW DRIVER MES NO. 110050**  
NEEDS TO BE ORDERED  
IT MAY BE ORDERED BY FAXING AN "OFF CATALOG" eBUY REQUEST TO:*

*USPS MAIL EQUIPMENT SHOP  
FAX NO. (202) 281-2643*



*QUESTIONS? CALL THE USPS MAIL EQUIPMENT SHOP AT (202) 281-2620  
PLEASE NOTE THAT FLORENCE MANUFACTURING DOES NOT SELL THE MCGARD SCREWDRIVER.*

# SITE PREPARATION AND PEDESTAL INSTALLATION

## METAL OPL TYPE I 1590 SERIES

SINGLE UNIT

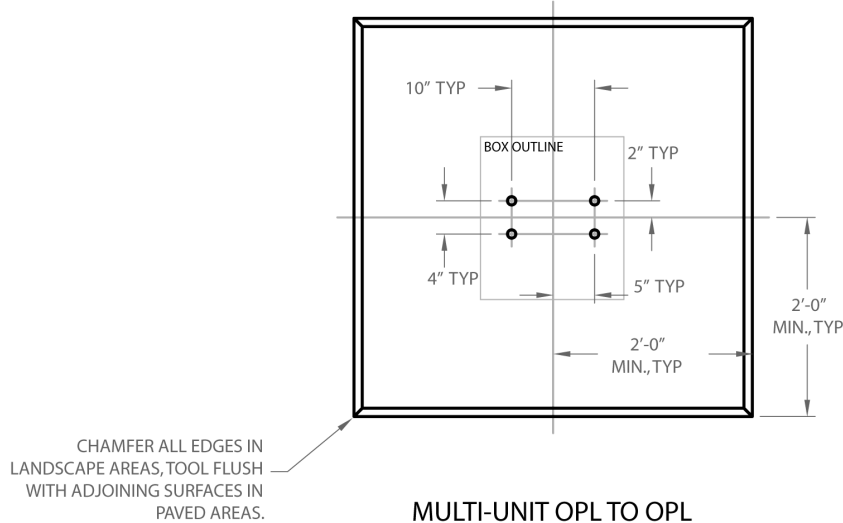

MULTI-UNIT OPL TO OPL

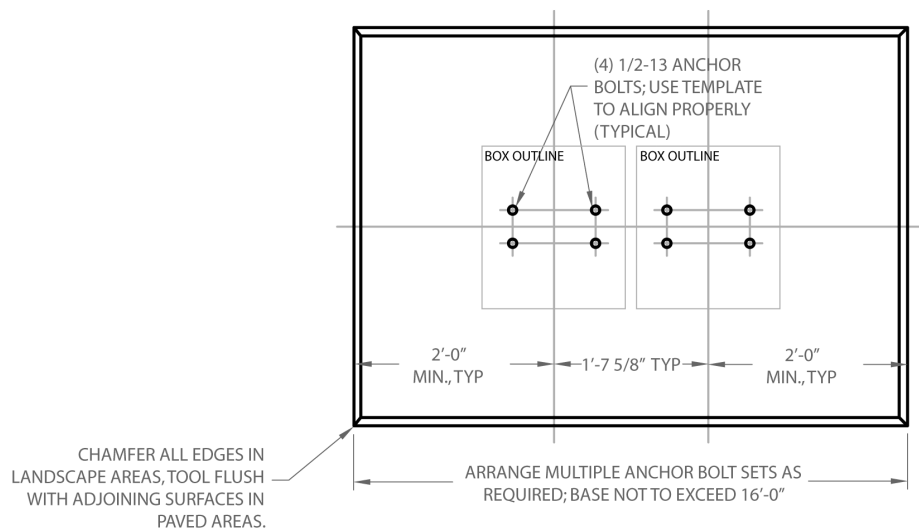

MULTI-UNIT OPL TO CBU

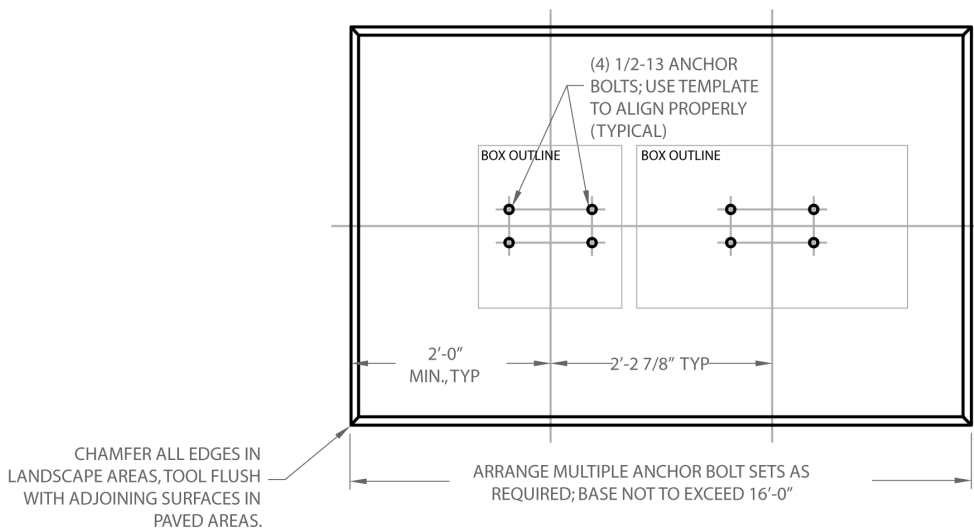

# SITE PREPARATION AND PEDESTAL INSTALLATION

## METAL OPL TYPE I

### 1590 SERIES

NOTE:  
CONCRETE SHALL HAVE A  
COMPRESSIVE STRENGTH OF  
3000 PSI @ 28 DAYS, CONTAIN  
4% MIN. ~ 6% MAX AIR  
ENTRAPMENT AND BE  
PLACED WITH A 3.50 ~ 4.50"  
SLUMP IN ACCORDANCE TO  
301.

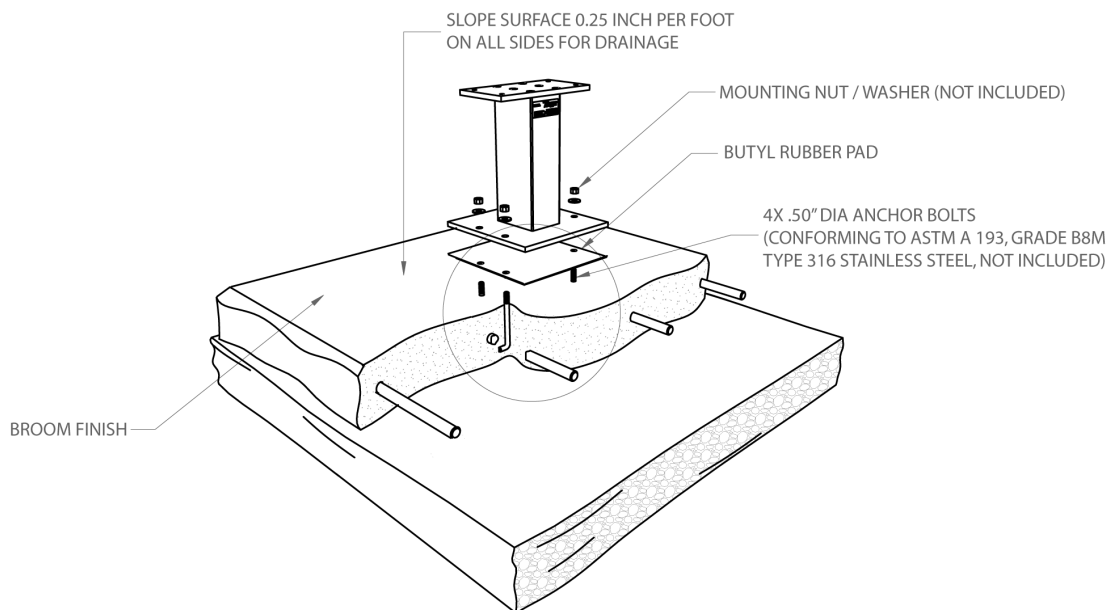
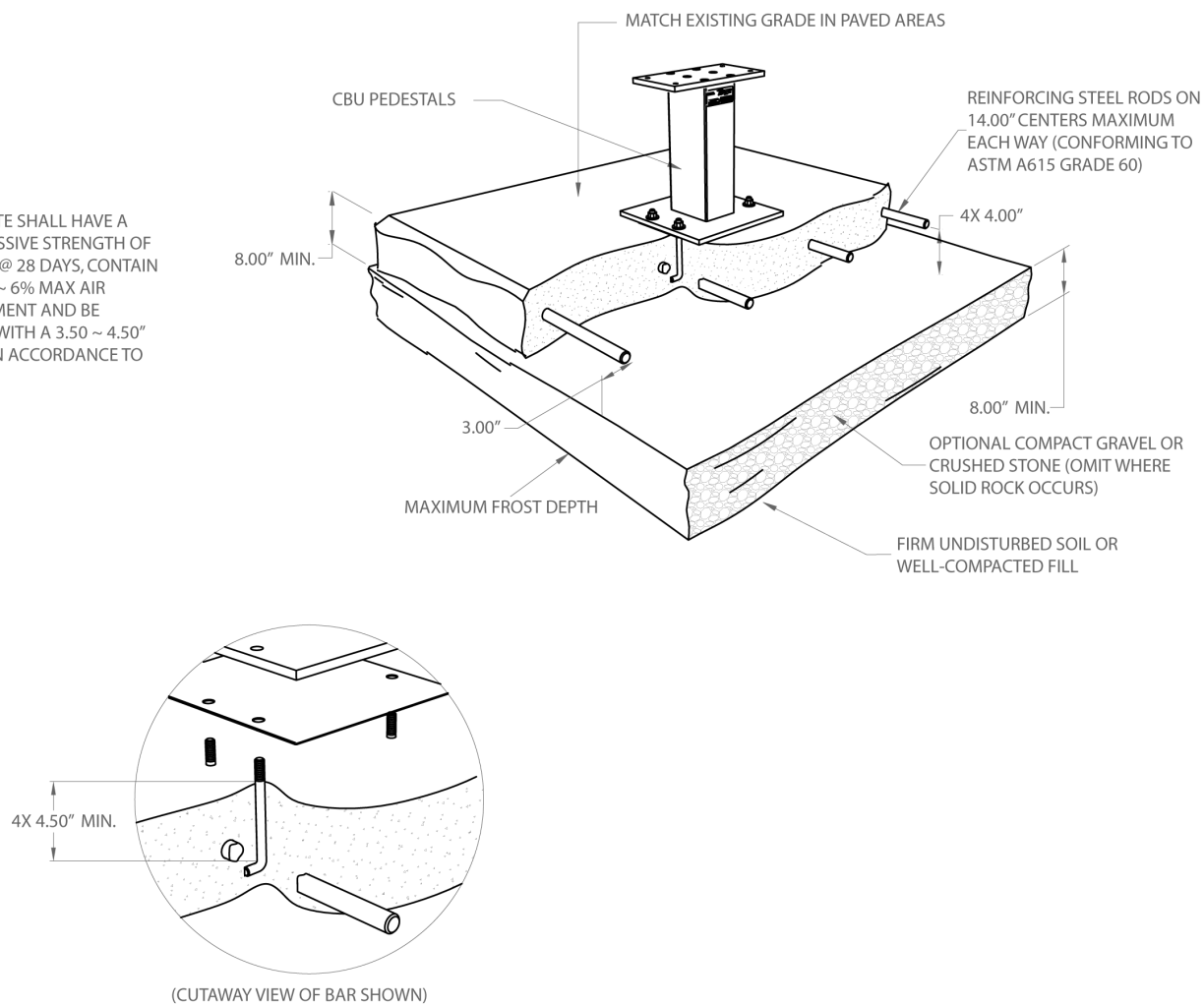

# INSTALLATION OF MASTER LOAD ARROW LOCK

## METAL OPL TYPE I

### 1590 SERIES

*TO BE INSTALLED BY AUTHORIZED USPS  
PERSONNEL ONLY*

1. *OPEN ARROW LOCK DOOR.*
2. *REMOVE FIVE (5) 86091 10-32 LOCK NUTS WITH 92303 LOCK SUPPORT PLATE (DISPOSE OF PLASTIC SHIPPING SPACER).*
3. *PLACE ARROW LOCK IN ONE (1) PH92300-F ARROW LOCK SECURITY BRACKET AND POSITION ON DOOR.*
4. *REPLACE ONE (1) 86091 10-32 LOCK NUT IN THE REAR POSITION TO SECURE 92300 ARROW LOCK SECURITY BRACKET.*
5. *INSTALL 92303 LOCK SUPPORT PLATE AS SHOWN.*
6. *REPLACE FOUR (4) 86091 10-32 LOCK NUTS. TORQUE 25 TO 30 INCH-POUNDS (OVERTIGHTENING MAY KEEP ARROW LOCK FORM OPERATING CORRECTLY).*

PART #	DESCRIPTION
86091	10-32 LOCK NUT
92303	LOCK SUPPORT PLATE
	ARROW LOCK (PROVIDED BY U.S.P.S.)
PH92300-F*	ARROW LOCK SECURITY BRACKET
K92300	KIT ARROW LOCK SECURITY BRACKET (INCLUDES LOCK NUTS, LOCK SUPPORT PLATE & SECURITY BRACKET)
	*ONLY AVAILABLE IN K92300

#### REQUIRED TOOLS

3/8" SOCKET WRENCH

## INSTALLATION OF MASTER LOAD ARROW LOCK

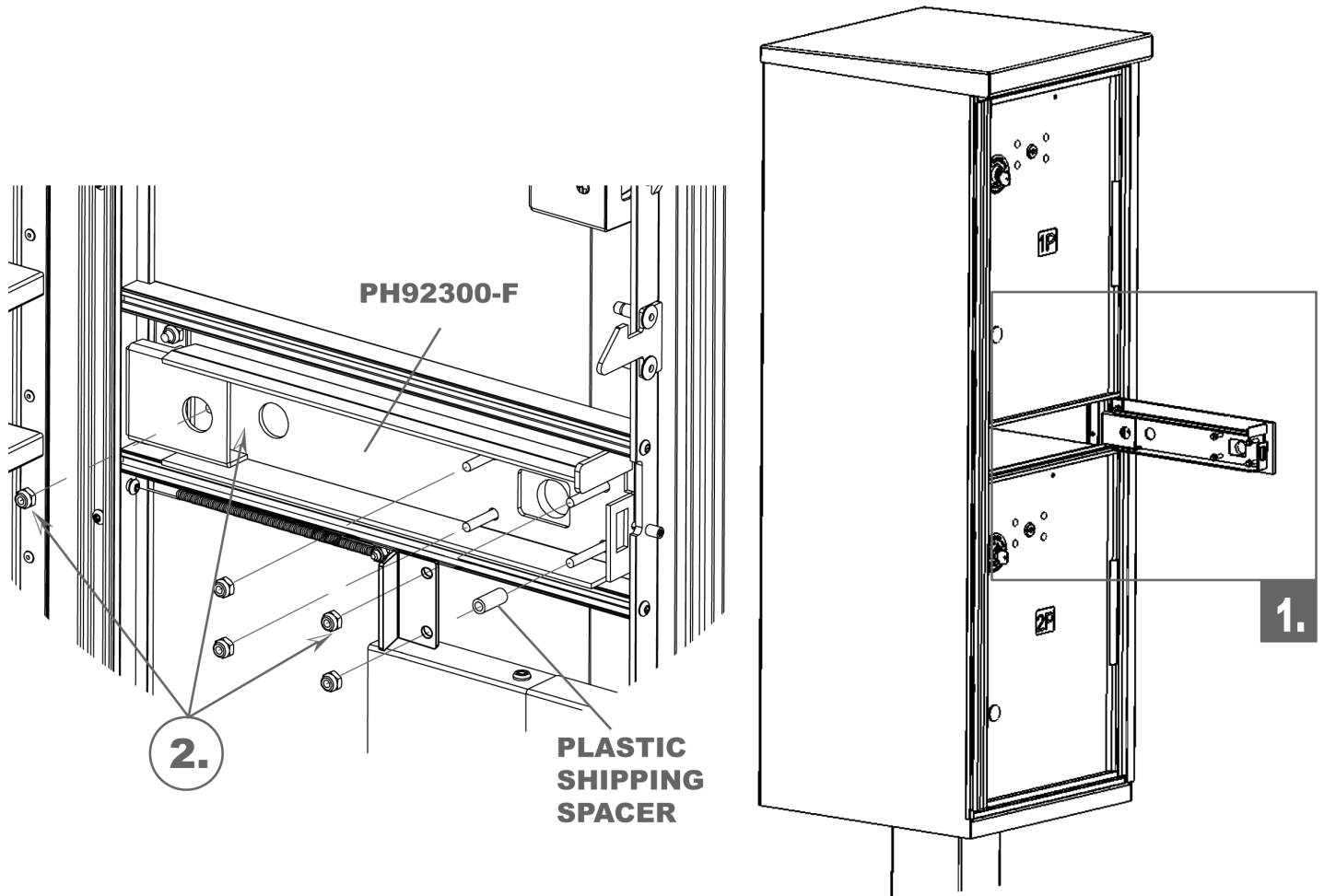

**ARROW LOCK  
(PROVIDED BY U.S.P.S.)**

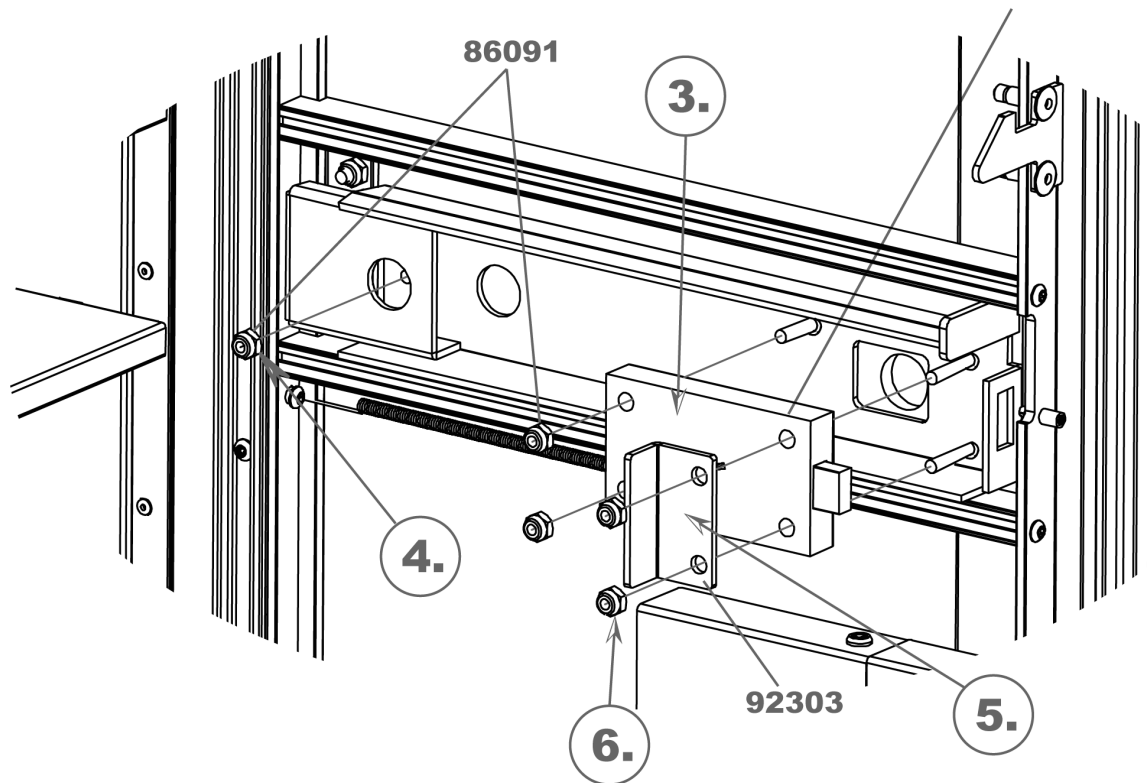

# PARCEL ARROW LOCK INSTALLATION

## METAL OPL TYPE I

### 1590 SERIES

*TO BE INSTALLED BY AUTHORIZED USPS  
PERSONNEL ONLY*

# 1. *OPEN PARCEL DOOR AND LOCK PARCEL DOOR CUSTOMER LOCK.*

*NOTE: PARCEL DOOR CUSTOMER LOCK  
MUST BE IN THE LOCKED POSITION FOR  
KEY TO BE REMOVED.*

# 2. *POSITION 64042-SS PARCEL DOOR LOCK STIFFENER ON THE PARCEL DOOR BOLTS AS ORIENTED IN ILLUSTRATION.*

# 3. *INSTALL ARROW LOCK AS SHOWN, SECURING WITH FOUR (4) 86455 10-32 THIN LOCK NUTS. TORQUE 25 TO 30 INCH-POUNDS (OVERTIGHTENING MAY KEEP ARROW LOCK FORM OPERATING CORRECTLY).*

# 4. *POSITION 64216-SS PARCEL DOOR ARROW LOCK COVER, SECURING WITH TWO (2) 84993 10-32 18-8 SS PASSIVATED MCGARD FASTENERS.*

*NOTE: THESE FASTENERS REQUIRE A  
MCGARD SCREW DRIVER, (SEE PAGE 3).*

<i>REQUIRED TOOLS</i>	
U.S.P.S. PROPRIETARY MCGARD TOOL	
3/8" SOCKET WRENCH OR NUT DRIVER	

<i>PART #</i>	<i>DESCRIPTION</i>
64042-SS	SS PARCEL DOOR LOCK STIFFENER
	ARROW LOCK (PROVIDED BY U.S.P.S.)
86455	10-32 THIN LOCK NUT
64216-SS	SS PARCEL DOOR ARROW LOCK COVER
84993	10-32 x .312 18-8 SS PASSIVATED MCGARD FASTENER
K64216-SS	KIT PARCEL LOCK COVER SS (INCLUDES SS PARCEL DOOR ARROW LOCK COVER, SS PARCEL DOOR LATCH MECHANISM COVER AND HARDWARE)



## PARCEL ARROW LOCK INSTALLATION

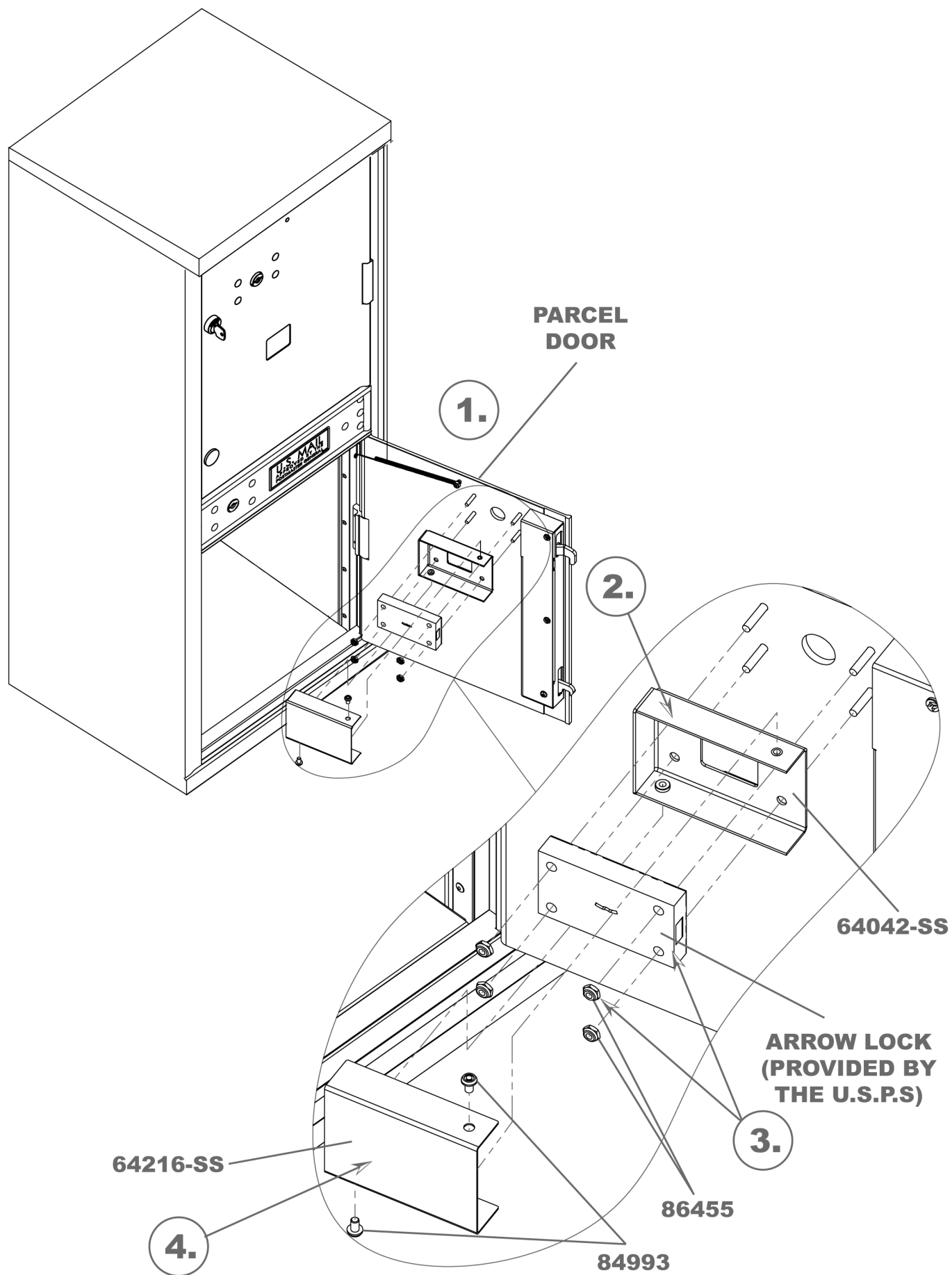

# PEDESTAL TO OPL INSTALLATION

## METAL OPL TYPE I

### 1590 SERIES

*WARNING: UNIT IS TOP-HEAVY.  
PEDESTAL SHOULD BE MOUNTED TO PAD  
BEFORE INSTALLING CABINET.*

- 1.** *OPEN MASTER LOADING DOOR.*
- 2.** *REMOVE 91079 FLOATING SHELF,  
EXPOSING MOUNTING HOLES.*
- 3.** *PLACE UNIT ON ONE (1) 91121  
PEDESTAL.*
- 4.** *FROM UNDERNEATH UNIT, INSERT FOUR  
(4) 86101 3/8-16 X 1.25 CARRIAGE BOLTS  
UPWARD.*
- 5.** *FROM INSIDE PARCEL COMPARTMENTS,  
ADD FOUR (4) 86097 3/8" X .688 OD LOCK  
WASHER AND TIGHTEN FOUR (4) 86089B  
3/8-16 HEX NUTS. TORQUE TO 22  
FOOT-POUNDS.*
- 6.** *REPLACE 91079 FLOATING SHELF.*

REQUIRED TOOLS	
9/16" SOCKET WRENCH	

PART #	DESCRIPTION
91079	FLOATING SHELF
91121	PEDESTAL
86101	3/8-16 X 1.25 CARRIAGE BOLT
86097	3/8" X .688 OD LOCK WASHER
86089B	3/8-16 HEX NUT
K86101-F	KIT HARDWARE PEDESTAL TO UNIT MOUNTING (INCLUDES CARRIAGE BOLTS, LOCK WASHERS AND HEX NUTS)

## PEDESTAL TO OPL INSTALLATION

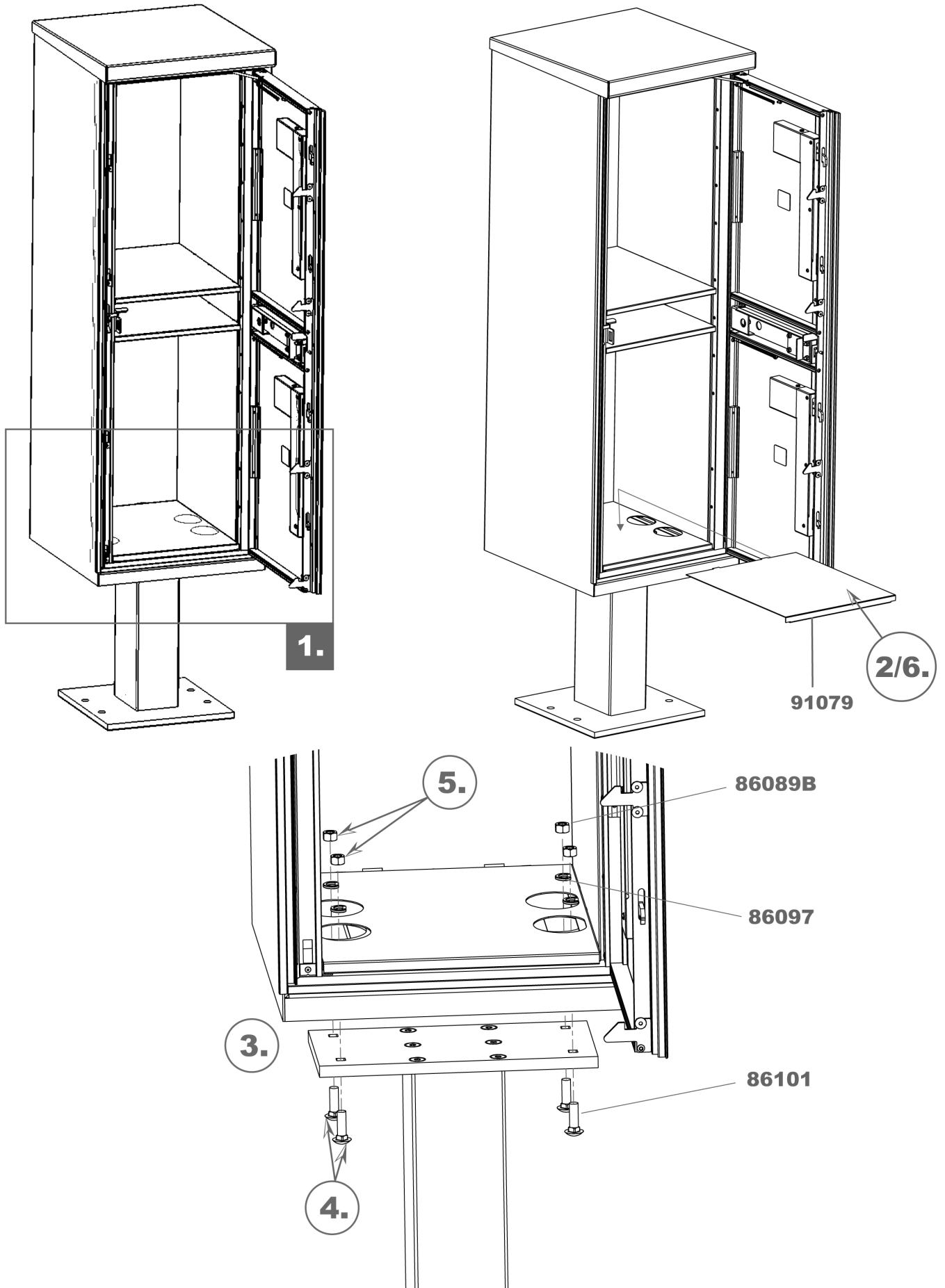

# NUMBER PLACARD INSTALLATION

## METAL OPL TYPE I

### 1590 SERIES

*TO ALLOW FOR ALTERNATE  
NUMBERING WE SHIP THE NUMBER  
PLACARDS LOOSE (FOR UNITS THAT ARE  
NOT ENGRAVED).*

*IF YOU DESIRE TO USE PLACARDS OTHER  
THAN PROVIDED '1P' AND / OR '2P', YOU  
CAN ORDER DIFFERENT NUMBERS FROM  
YOUR LOCAL AUTHORIZED FLORENCE  
DEALER. THE OPTIONS RANGE FROM '1P'  
TO '99P'.*

- 1.** *REMOVE ADHESIVE COVER ON BACK  
OF PLACARD AND PLACE APPROPRIATE  
NUMBER PLACARD IN DOOR EMBOSS.*

*NOTE: TO ADHERE TO POSTAL  
REGULATIONS, PLACE THE LOWER  
NUMBER PLACARD ON THE TOP PARCEL  
DOOR.*

- 2.** *FOR EACH OF THE (3) THREE 86159 KEY  
TAGS PER DOOR CLEARLY PRINT THE  
DOOR PLACARD NUMBER IN SPACE  
INDICATED ON TAG.*

- 3.** *CHECK KEY OPERATION FOR DOOR AND  
PLACE 86159 MARKED KEY TAGS IN EACH  
OF THE CORRESPONDING 86160-3  
PLASTIC KEY RINGS AS INDICATED.*

PART #	DESCRIPTION
91511-1P	NUMBER PLACARD '1P'
91511-2P	NUMBER PLACARD '2P'
91516	INDIVIDUAL NUMBER PLACARD '3P' - '99P'
86159	1 KEY TAG
86160-3	3 KEY RINGED TAG HOLDERS
K86160	KIT TAG HOLDERS W/ TAGS (INCLUDES THREE KEY RINGED TAG HOLDERS AND THREE KEY TAGS)

#### REQUIRED TOOLS

PERMANENT FINE POINT PEN

# NUMBER PLACARD INSTALLATION

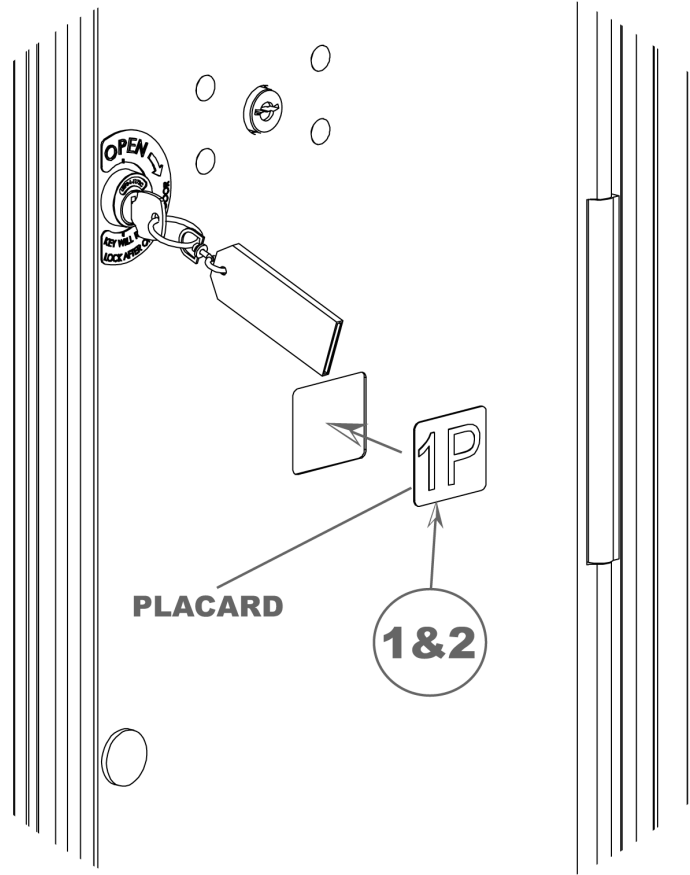
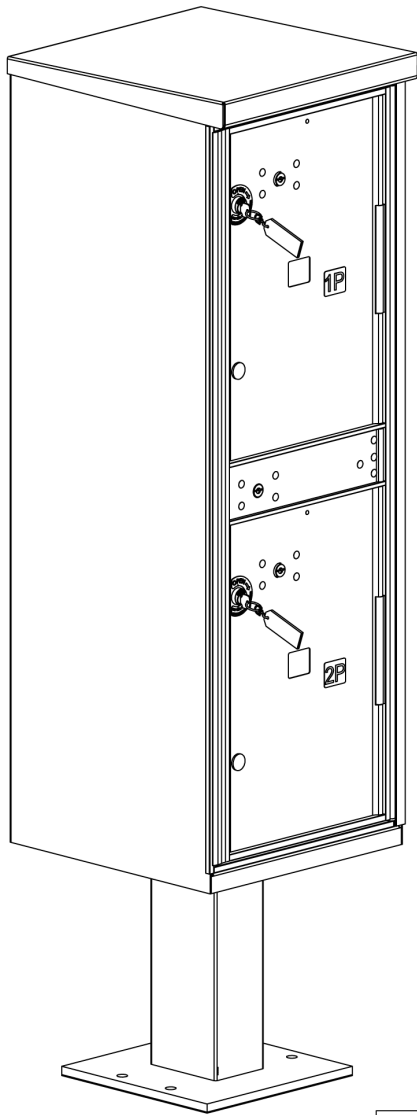

86159

**POSTAL CUSTOMER: YOU HAVE  
MAIL IN RECEPTACLE # \_\_\_\_,  
PLEASE UNLOCK THE TOP LOCK  
AND REMOVE MAIL. KEY WILL BE  
RETAINED IN THE LOCK.**

3

86160-3

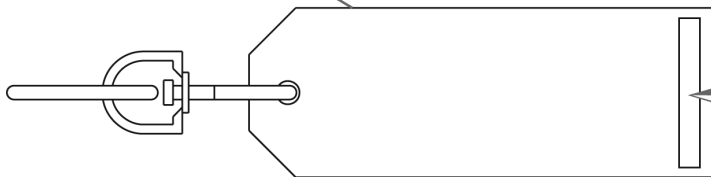

**POSTAL CUSTOMER: YOU HAVE  
MAIL IN RECEPTACLE # \_\_\_\_,  
PLEASE UNLOCK THE TOP LOCK  
AND REMOVE MAIL. KEY WILL BE  
RETAINED IN THE LOCK.**

4