

Control Panel

LED Display Control Panel

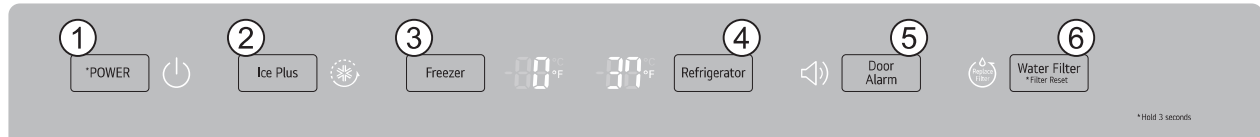

① Power

The Power button turns off all electrical power to the unit.

Press and hold the Power button for 3 seconds to turn off the power. When the power is off, the indicator light is off. There is no need to turn off power at the circuit breaker or wall receptacle. Use this function for service or extended vacations.

② Ice Plus

Press the Ice Plus button once to activate the Ice Plus function.

The Ice Plus icon on the display panel illuminates when activated.

The Ice Plus function runs the freezer compartment at the coldest setting for a 24-hour period to increase icemaking by up to 20%, and then turns off automatically.

NOTE

- Press the button again to cancel the Ice Plus function.

③ Freezer

To adjust the temperature in the freezer compartment, press the Freezer button to cycle through the range of available settings.

④ Refrigerator

To adjust the temperature in the refrigerator compartment, press the Refrigerator button to cycle through the range of available settings.

NOTE

- The actual inner temperature varies depending on the food status, since the indicated temperature setting is the target temperature and not the actual temperature within the refrigerator.
Initially set the REFRIGERATOR CONTROL at 37°F(3°C) and the FREEZER CONTROL at 0°F(-18°C). Leave them at these settings for 24 hours (one day) to stabilize.
Then adjust the compartment temperature as illustrated above.
- To change temperature display from Fahrenheit to Celsius press and hold the Freezer and Refrigerator buttons simultaneously for approximately 5 seconds. Do the same to convert back to Fahrenheit.

⑤ Door Alarm 

The Door Alarm sounds three times at 30-second intervals when a compartment door is left open for more than 60 seconds. The alarm stops sounding when the door is closed. Press the Door Alarm button once to activate or deactivate the door alarm function.

NOTE

- Contact your local service center if the alarm continues to sound after the doors are closed.

⑥ Water Filter 

Press and hold the Water Filter button for approximately 3 seconds to reset the filter indicator after the water filter has been replaced.

NOTE

- Replace the water filter approximately every 6 months, when the water filter indicator light reaches 0 or if the ice or water starts to taste bad.

Dispenser Control Panel

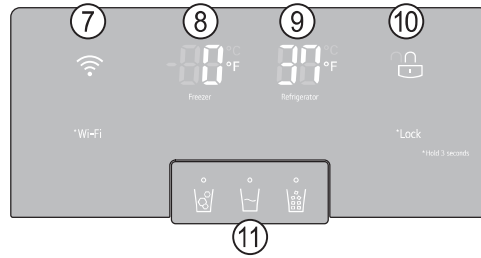

⑦ Wi-Fi 

Use the Wi-Fi button with the LG Smart Refrigerator smart phone app to connect the refrigerator to a home Wi-Fi network. Refer to the Smart Features section of the manual for information on the initial setup of the application.

The Wi-Fi icon displays the status of the refrigerator's network connection. When the refrigerator is connected to the network, the Wi-Fi icon is illuminated. Press and hold the Wi-Fi button for 3 seconds to connect to the network. The icon blinks while the connection is being made, then turns on once the connection is successfully made.

⑧ Freezer 

Freezer temperature indicator.

⑨ Refrigerator 

Refrigerator temperature indicator.

⑩ Lock 

Press and hold the Lock button for three seconds to lock the dispenser and all of the other control panel functions. Press and hold again for 3 seconds to unlock.

⑪ Dispenser Selection Indicator

Dispensing Cubed Ice 

Press the dispenser selection button repeatedly until the cubed ice icon illuminates. Press the dispenser switch with a glass or other container to dispense cubed ice.

Dispensing Water 

Press the dispenser selection button repeatedly until the water icon illuminates. Press the dispenser switch with a glass or other container to dispense water.

Dispensing Crushed Ice 

Press the dispenser selection button repeatedly until the crushed ice icon illuminates. Press the dispenser switch with a glass or other container to dispense crushed ice.

⚠ CAUTION

NOTE

- Hold the glass or other container in place for a couple of seconds after dispensing ice or water to catch the last few cubes or drops. The dispenser is designed to not operate while either refrigerator door is open.

Cleaning

The water collector has no self-drainage function, so it should be cleaned regularly. Remove the cover by pulling the front of the water collector cover and dry it with a cloth.

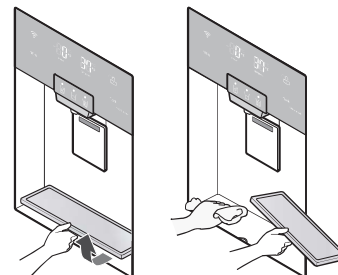

Automatic Icemaker

- The automatic icemaker can automatically make 6 cubes at a time, 70~120 pieces per day. This quantity may vary by circumstance, including ambient temperature, door opening, freezer load. etc.
- Icemaking stops when the ice storage bin is full.
- To turn the icemaker off, turn the icemaker switch to OFF. To turn the icemaker back on, turn the switch to ON.

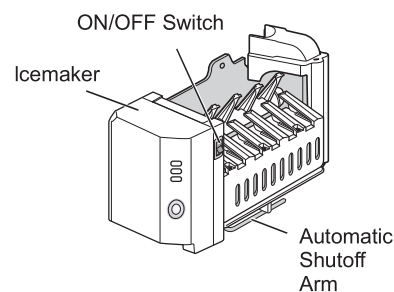

NOTE

- It is normal to hear noise when ice drops into the ice storage bin.
- Occasionally shake the ice storage bin so that the ice does not pile higher on one side. If the ice piles up high next to the ice maker, ice production will stop.

Icemaker Not Working Properly

Ice is Lumped Together

- When ice is lumped together, take the ice lumps out of the ice storage bin, break them into small pieces, and return the pieces to the ice storage bin.
 - When the ice produced by the icemaker is too small or is lumped together, the amount of water supplied to the icemaker may need to be adjusted. Contact the service center.
- ※ If ice is not used frequently, it may lump together.

Power Failure

- Ice may drop into the freezer compartment. Take the ice storage bin out and discard all the ice. Dry the ice bin and place it back in the freezer.

The Refrigerator is Newly Installed

- It takes about 12 hours for a newly installed refrigerator to make ice.

How to remove and reinstall the ice storage bin

Remove

- Grip the handle as shown in the figure 1.

BIN

- Lift the lower part slightly
- Take the Ice Storage bin out slowly

Cover

- Lift up the cover
- ※ Watch the hooks inside of cover.

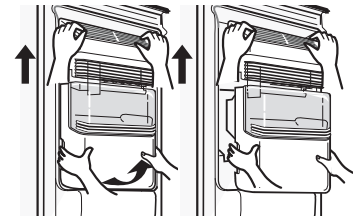

figure 1

Reinstall (Bin&Cover)

- Assembly is the reverse order of disassembly.
- You will hear the bin snap into place when it is in the correct position.

⚠ WARNING

- Do not dismantle the ice storage bin unless it is necessary.
- Use both hands to remove the ice bin to avoid dropping it.
- Do not touch the ejector mechanism with hands or tools. It may damage the icemaker or hurt your hands (figure 2).

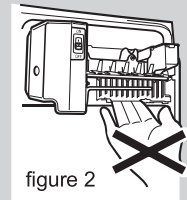

figure 2

Auto-Closing Door System

The doors automatically close when in the 60 degree position.

NOTE

- This function is performed by a spring-damper mechanism. Closing speed and strength depends on the ambient temperature, frequency of door opening/closing and contents of the door bins.

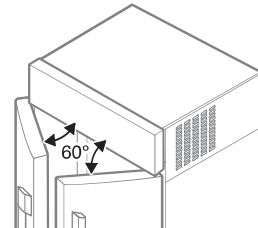

Other Functions

Open Door Alert

- A warning tone will sound 3 times at thirty-second intervals if the refrigerator or freezer door is left open for more than sixty seconds.
- Please contact a local service center if the warning continues to sound after the door is closed.

 **CAUTION**

Throw away the first few batches of ice (about 24 cubes) and water (about 7 glasses) first made after refrigerator installation.

The first ice and water may include particles or odor from the feed water pipe or feed water box. This is also necessary if the refrigerator has not been used for a long time.

Children should be supervised when using the dispenser.

Be careful that frost does not block the ice passage.

The ice passage may become blocked with frost if only crushed ice is used. Remove the frost that accumulates by removing the ice bin and clearing the passage with a rubber spatula. Dispensing cubed ice can also help prevent frost buildup.

Never store beverage cans or other items in the ice bin for the purpose of rapid cooling.

Doing so may damage the icemaker or the containers may burst.

Never use thin crystal glass or crockery to collect ice.

Such containers may chip or break resulting in glass fragments in the ice.

Dispense ice into a glass before filling it with water or other beverages.

Splashing may occur if ice is dispensed into a glass that already contains liquid.

To avoid personal injury, keep hands out of the ice door and passage.

Part breakage or injury may occur.

Never remove the icemaker cover.

If discolored ice is dispensed, check the water filter and water supply. If the problem continues, contact service center. Do not use the ice or water until the problem is corrected.

Never use a glass that is exceptionally narrow or deep.

Ice may jam in the ice passage and refrigerator performance may be affected.

Keep the glass at a proper distance from the ice outlet.

A glass held too close to the outlet may prevent ice from dispensing.

Shelf

The shelves in the refrigerator are adjustable to meet individual storage needs.

Disassembling

1. Lift the front of the shelf slightly.

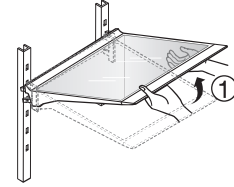
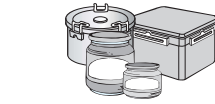

2. While supporting the shelf, tilt it and pull it out.

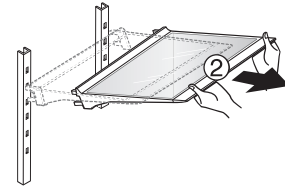

Reassembling

Tilt the front of the shelf up and guide the shelf hooks into the slots at a desired height. Then, lower the front of the shelf so that the hooks drop into the slots.

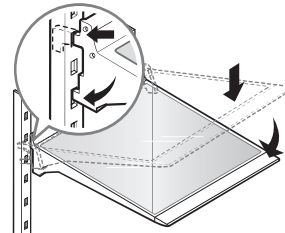

CAUTION

Make sure that shelves are level from one side to the other.

Failure to do so may result in the shelf falling or food spilling.

Freezer Door Bin

Use to store small packaged frozen food.

Do not use door bins to store ice cream or for long-term food storage.

Disassembling

Hold the bin with both hands and slightly lift up the front part to pull the bin out.

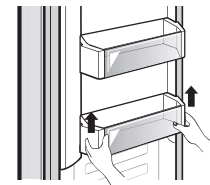

Reassembling

Hold the bin with both hands and reassemble one side at a time by pushing it in.

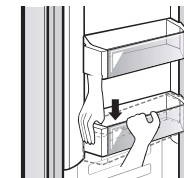
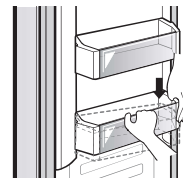

Dairy Corner

Use to store dairy goods like butter and cheese.

Disassembling

To remove the dairy corner, simply lift it up and pull straight out.

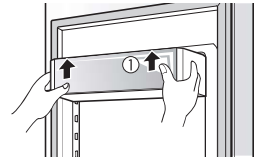

- ▶ Close the dairy corner completely after use. The refrigerator door may not close properly if the dairy corner is left open.

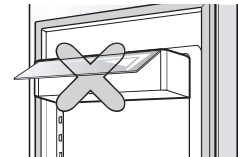

Adjustable Door Bins

Use to store small, packaged refrigerated food or beverages such as milk, canned drinks, etc. The adjustable door bins are removable for easy cleaning and adjustment.

Disassembling

You must remove the dairy corner before disassembling the adjustable door bin.

To remove the door bin, pull the levers on each side and pull the bin up off of the rail.

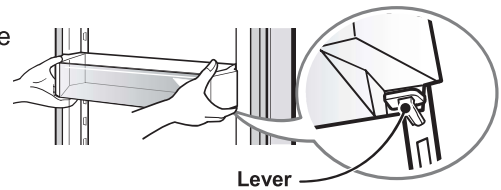

Reassembling

Before reassembling the adjustable door bin, remove the dairy corner.

Hold the door bin with both hands and place it on top of the rail. Push the basket down while holding the lever under the bin. The bin clicks when it is in the correct position.

CAUTION

- Always disassemble/assemble the adjustable door bin using two hands. Make sure that the adjustable door bins are empty before disassembling/ assembling them.

Refrigerator Gallon Bin

For storing larger containers, such as gallons of milk.

Disassembling

Hold the bin with both hands, lift up and pull out.

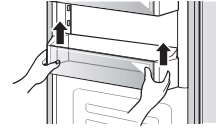

Reassembling

Hold the bin with both hands and click it into place, one side at a time.

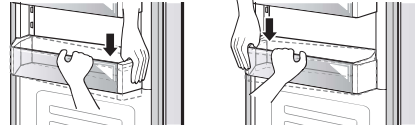

Refrigerator/Freezer Drawers

For convenient storage of items like fruits, vegetables and packaged frozen food.

Disassembling

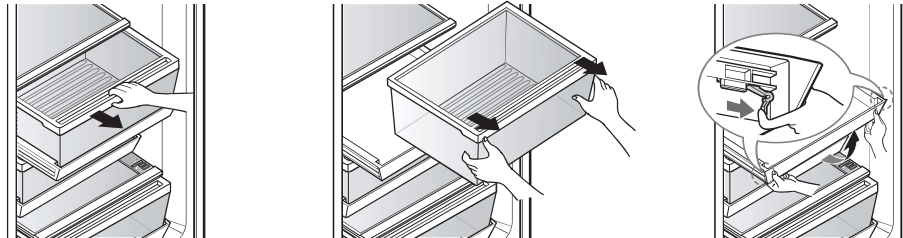

1. Hold the front handle of the drawer and pull it out until it stops.
2. When you cannot pull out the drawer any more, lift it up slightly to pull it out.
3. The lower compartment under the drawer is also removable.

The drawer is reassembled in the reverse order.

CAUTION

- Always disassemble the drawers using two hands.
Make sure that the drawers are empty before removing them.

Reassembling the Lower Compartment

1. Slide both rails in simultaneously.
2. Hook the support **1** into the rail tabs **2** on both sides.
3. Lower the front of the compartment.
The compartment clicks when it is in the correct position.

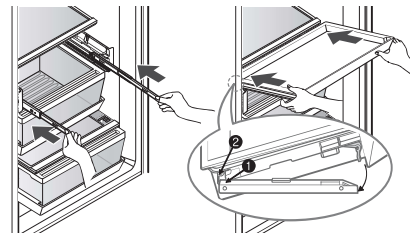

Disassembling**Upper/Lower Drawer Covers**

1. Lift the front of the cover slightly, then lift the back of the cover from below.
2. Pull the cover forward firmly.
3. Tilt the cover up 45° and remove it.

The cover is reassembled in the reverse order.

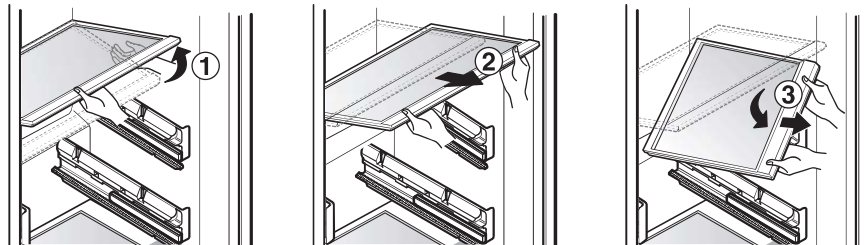
**CAUTION**

Never wash the inside accessories of the appliance in the dishwasher. They must be cleaned by hand.

Replacing the Water Filter

Replace the water filter:

- Approximately every six months.
- When the water filter indicator turns on.
- When the water dispenser output decreases.
- When the ice cubes are smaller than normal.

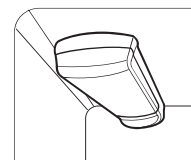

1. Remove the old water filter.

- Lower or remove the top left shelf to allow the water filter to rotate all the way down.
- Press the push button to open the water filter cover.

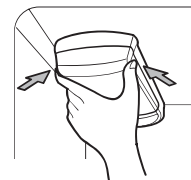
**NOTE**

- Replacing the water filter causes a small amount of water (around 1 oz. or 25 cc) to drain. Place a cup under the front end of the water filter cover to collect any leaking water. Hold the water filter upright, once it is removed, to prevent any remaining water from spilling out of the water filter.

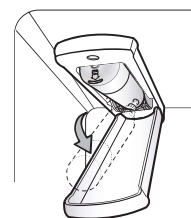

- Pull the water filter downward and pull out. Make sure to rotate the filter down completely before pulling it out of the manifold hole.

2. Replace with a new water filter.

- Take the new water filter out of its packing and remove the protective cover from the o-rings. With water filter tabs in the horizontal position, push the new water filter into the manifold hole until it stops.

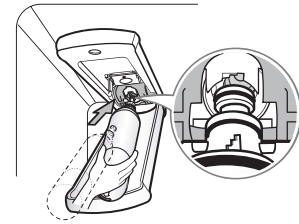

- Rotate the water filter up into position and close the cover. The cover clicks when closed correctly.

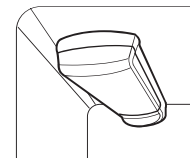
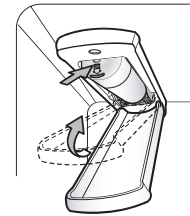

3. After the water filter is replaced, dispense 2.5 gallons of water (flush for approximately 5 minutes) to remove trapped air and contaminants from the system. Do not dispense the entire 2.5 gallon amount continuously. Depress and release the dispenser pad for cycles of 30 seconds ON and 60 seconds OFF.

4. Water Filter Bypass Plug

- Keep the water filter bypass plug. You **MUST** use the water filter bypass plug when a replacement water filter cartridge is not available.

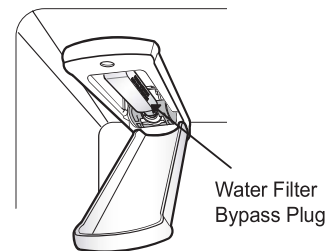

CAUTION



DO NOT operate refrigerator without water filter or water filter bypass plug installed.

NOTE

- To purchase a replacement water filter:
 - Visit your local dealer or distributor
 - Web: Find Parts & Accessories from Support section of lg.com
 - Call : 1-800-243-0000 (USA), 1-888-542-2623 (Canada)
- Part number of the replacement water filter: ADQ36006113

Food Storage Guide

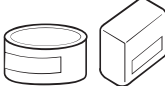
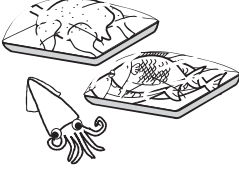
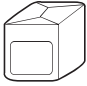
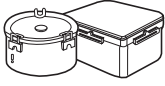
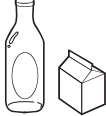
(Refer to the Product Overview for identification of parts.)

Freezer Compartment Shelf	Store various frozen foods such as meat, fish, ice cream, frozen snacks, etc.	
Freezer Compartment Door Bin	<ul style="list-style-type: none"> • Store small packed frozen food. • The temperature in the door bins is likely to increase as the door opens; therefore, do not store long-term foods such as ice cream in the door bins. 	
Freezer Compartment Drawer	<ul style="list-style-type: none"> • Store meat, fish, chicken, etc. after wrapping them with thin foil. • Store dry. 	
Dairy Corner	Store dairy products such as cheese and butter.	
Refrigerator Compartment Shelf	Store side dishes or other foods at a proper distance.	
Refrigerator Compartment Door Bin	Store small packed food or beverages such as milk, juice, etc.	
Vegetable Drawer	Store vegetables or fruits.	

Food storage guide

- Store fresh food in the refrigerator compartment. How food is frozen and thawed is an important factor in maintaining its freshness and flavor.
- Do not store food that spoils quickly, such as bananas and melons, at low temperatures.
- Allow hot food to cool prior to storing it in the refrigerator. Placing hot food in the refrigerator could spoil other food and lead to a higher energy consumption.
- Tightly wrap food or store it in a container with a lid.
- Do not block air vents with food. Smooth circulation of chilled air keeps refrigerator temperatures even.
- Do not open the door frequently. Opening the door lets warm air enter the refrigerator and causes temperatures to rise.
- Do not overfill the door bins.
- For dated products, check date code to ensure freshness.
- Leave enough space in the freezer for air to circulate around packages.
- Your freezer will not quick-freeze a large quantity of food. Do not put more unfrozen food into the freezer than will freeze within 24 hours (no more than 2 to 3 pounds of food per cubic foot of freezer space).

Freezer compartment

- Do not store bottles or glass in the freezer compartment. They may break or shatter.
- Do not refreeze food that has been thawed. This causes loss of taste and nutrients.
- When storing frozen food for an extended period of time, such as ice cream, keep it on a shelf, not in a door bin.
- Do not touch frozen containers made of metal with wet hands.

Refrigerator compartment

- Always clean food prior to refrigerating. Vegetables and fruits should be washed and dried. Packed food should be wiped to prevent adjacent food from spoiling.
- When storing eggs in their storage rack or box, ensure that they are fresh, and always store them in an upright position.

NOTE

- If you keep the refrigerator in a hot and humid place, frequent opening of the door or storing a lot of vegetables in it may cause condensation to form which has no effect on its performance. Remove the condensation with a paper or kitchen towel.

LG ThinQ Application Features

LG ThinQ Application

This feature is only available on models with Wi-Fi.

The **LG ThinQ** application allows you to communicate with the appliance using a smartphone.

Energy Monitoring†

This feature keeps track of the refrigerator's power consumption and the number of door openings.

Remote Control

Control the Refrigerator Temperature, Fresh Air Filter and Ice Plus from the smart phone app.

Push Messages

If the door remains open for more than ten minutes, you will receive a push message. When Ice Plus is finished, you will receive a push message.

Smart Diagnosis™

This function provides useful information for diagnosing and solving issues with the appliance based on the pattern of use.

Settings

Allows you to set various options on the refrigerator and in the application.

† This feature is only available on some models.

NOTE

- If you change your wireless router, Internet service provider, or password, delete the registered appliance from the **LG ThinQ** application and register it again.
- This information is current at the time of publication. The application is subject to change for product improvement purposes without notice to users.

Before Using LG ThinQ Application

1. Use a smartphone to check the strength of the wireless router (Wi-Fi network) near the appliance.
 - If the distance between the appliance and the wireless router is too far, the signal becomes weak. It takes long time to register or fails to install the application.
2. Turn off the **Mobile data** or **Cellular Data** on your smartphone.

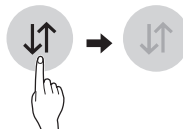

3. Connect your smartphone to the wireless router.



NOTE

- To verify the Wi-Fi connection, check that **Wi-Fi**  icon on the control panel is lit.
- The appliance supports 2.4 GHz Wi-Fi networks only. To check your network frequency, contact your Internet service provider or refer to your wireless router manual.
- **LG ThinQ** is not responsible for any network connection problems or any faults, malfunctions, or errors caused by network connection.

- The surrounding wireless environment can make the wireless network service run slowly.
- If the appliance is having trouble connecting to the Wi-Fi network, it may be too far from the router. Purchase a Wi-Fi repeater (range extender) to improve the Wi-Fi signal strength.
- The network connection may not work properly depending on the Internet service provider.
- The Wi-Fi connection may not connect or may be interrupted because of the home network environment.
- If the appliance cannot be registered due to problems with the wireless signal transmission, unplug the appliance and wait about a minute before trying again.
- If the firewall on your wireless router is enabled, disable the firewall or add an exception to it.
- The wireless network name (SSID) should be a combination of English letters and numbers. (Do not use special characters.)
- Smartphone user interface (UI) may vary depending on the mobile operating system (OS) and the manufacturer.
- If the security protocol of the router is set to **WEP**, network setup may fail. Change the security protocol (**WPA2** is recommended), and register the product again.

Installing the LG ThinQ Application

Search for the **LG ThinQ** application from the Google Play Store or Apple App Store on a smart phone. Follow instructions to download and install the application.

Connecting to Wi-Fi

The Wi-Fi button, when used with the LG ThinQ application, allows the refrigerator to connect to a home Wi-Fi network. The Wi-Fi icon shows the status of the refrigerator's network connection. The icon illuminates when the refrigerator is connected to the Wi-Fi network.

Initial Appliance Registration

Run the LG ThinQ application and follow the instructions in the application to register the appliance.

Re-registering the Appliance or Registering Another User

Press and hold the Wi-Fi button for 3 seconds to temporarily turn it off. Run the LG ThinQ application and follow the instructions in the application to register the appliance.

Wireless LAN module Specifications

Model	LCW-003
Frequency Range	2412 to 2462 MHz
Output Power (Max)	< 30 dBm

FCC Notice

The following notice covers the transmitter module contained in this product. This equipment has been tested and found to comply with the limits for a Class B digital device, pursuant to Part 15 of the FCC Rules. These limits are designed to provide reasonable protection against harmful interference in a residential installation. This equipment generates, uses, and can radiate radio frequency energy and, if not installed and used in accordance with the instructions, may cause harmful interference to radio communications. However, there is no guarantee that interference will not occur in a particular installation. If this equipment does cause harmful interference to radio or television reception, which can be determined by turning the equipment off and on, the user is encouraged to try to correct the interference by one or more of the following measures:

- Reorient or relocate the receiving antenna.

- Increase the separation between the equipment and the receiver.
- Connect the equipment to an outlet on a circuit different from that to which the receiver is connected.
- Consult the dealer or an experienced radio/TV technician for help.

This device complies with part 15 of the FCC Rules. Operation is subject to the following two conditions:

- 1) This device may not cause harmful interference and
- 2) This device must accept any interference received, including interference that may cause undesired operation.

Any changes or modifications in construction of this device which are not expressly approved by the party responsible for compliance could void the user's authority to operate the equipment.

FCC RF Radiation Exposure Statement

This equipment complies with FCC radiation exposure limits set forth for an uncontrolled environment. This transmitter must not be co-located or operating in conjunction with any other antenna or transmitter.

This equipment should be installed and operated with a minimum distance of 20 cm (7.8 inches) between the antenna and your body. Users must follow the specific operating instructions for satisfying RF exposure compliance.

Industry Canada Statement

This device contains licence-exempt transmitter(s)/receiver(s) that comply with Innovation, Science and Economic Development Canada's licence-exempt RSS(s). Operation is subject to the following two conditions:

- (1) This device may not cause interference.
- (2) This device must accept any interference, including interference that may cause undesired operation of the device.

IC Radiation Exposure Statement

This equipment complies with IC radiation exposure limits set forth for an uncontrolled environment.

This equipment should be installed and operated with a minimum distance of 20 cm (7.8 inches) between the antenna and your body.

NOTE

- THE MANUFACTURER IS NOT RESPONSIBLE FOR ANY RADIO OR TV INTERFERENCE CAUSED BY UNAUTHORIZED MODIFICATIONS TO THIS EQUIPMENT. SUCH MODIFICATIONS COULD VOID THE USER'S AUTHORITY TO OPERATE THE EQUIPMENT.

Open Source Software Notice Information



To obtain the source code under GPL, LGPL, MPL, and other open source licenses, that is contained in this product, please visit <http://opensource.lge.com>.

In addition to the source code, all referred license terms, warranty disclaimers and copyright notices are available for download.

LG Electronics will also provide open source code to you on CD-ROM for a charge covering the cost of performing such distribution (such as the cost of media, shipping, and handling) upon email request to opensource@lge.com.

This offer is valid for a period of three years after our last shipment of this product. This offer is valid to anyone in receipt of this information.

Smart Diagnosis™ Feature

This feature is only available on models with the  or  logo.

Use this feature to help you diagnose and solve problems with your appliance.

NOTE

- For reasons not attributable to LGE's negligence, the service may not operate due to external factors such as, but not limited to, Wi-Fi unavailability, Wi-Fi disconnection, local app store policy, or app unavailability.
- The feature may be subject to change without prior notice and may have a different form depending on where you are located.

Using LG ThinQ to Diagnose Issues

If you experience a problem with your Wi-Fi equipped appliance, it can transmit troubleshooting data to a smartphone using the **LG ThinQ** application.

- Launch the **LG ThinQ** application and select the Smart Diagnosis feature in the menu. Follow the instructions provided in the **LG ThinQ** application.

Using Audible Diagnosis to Diagnose Issues

Follow the instructions below to use the audible diagnosis method.

- Launch the **LG ThinQ** application and select the Smart Diagnosis feature in the menu. Follow the instructions for audible diagnosis provided in the **LG ThinQ** application.

1. Hold the **Lock** button for three seconds.
 - If the display has been locked for over five minutes, you must deactivate the lock and then reactivate it.



2. Open the right refrigerator door.

3. Hold the mouthpiece on your phone in front of the speaker that is located on the right hinge of the refrigerator door.

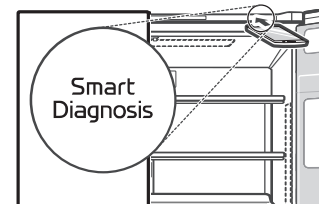

4. Press and hold the **Freezer** button for three seconds while continuing to hold your phone to the speaker.



5. After you hear three beeps, release the **Freezer** button.

6. Keep the phone in place until the tone transmission has finished. The display will count down the time. Once the countdown is over and the tones have stopped, the diagnosis will be displayed in the application.

NOTE

- For best results, do not move the phone while the tones are being transmitted.

General information

Vacation Time

If you choose to leave the refrigerator on while you are away, follow these steps to prepare the refrigerator before you leave.

1. Use up any perishables and freeze other items.
2. Turn off the icemaker and empty the ice bin.

If you choose to turn the refrigerator off before you leave, follow these steps.

1. Remove all food from the refrigerator.
2. Depending on your model, set the thermostat control (refrigerator control) to OFF.
3. Clean the refrigerator, wipe it and dry well.
4. Tape rubber or wood blocks to the tops of both doors to prop them open far enough for air to get in. This stops odor and mold from building up.

Power Failure

1. If the power will be out for 24 hours or less, keep all refrigerator doors closed to help foods stay cold and frozen.
2. If the power will be out for more than 24 hours, remove all frozen food and store it in a frozen food locker.

Anti-Condensation Pipe

The outside wall of the refrigerator cabinet may sometimes get warm, especially just after installation. This is due to the anti-condensation pipe, which pumps hot refrigerant to prevent sweating on the outer cabinet wall.

Replacing LED Lighting

Check to make sure that the LED lamp is turned on.

- LED lamp is not a user-serviceable item.
- If the LED array fails, contact LG Electronics call center for service.

Cleaning

Keep the refrigerator clean to prevent undesirable odors. Wipe up spilled food immediately, since it may acidify and stain plastic surfaces if allowed to settle.

WARNING

Always unplug the refrigerator prior to cleaning. Wipe up excess moisture with a sponge or cloth to prevent water or liquid from getting into any electrical part and causing an electric shock. Never use metallic scouring pads, brushes, coarse abrasive cleaners, strong alkaline solutions, or flammable or toxic cleaning liquids on any surface. Do not touch frozen surfaces with wet or damp hands, because skin could stick to extremely cold surfaces.

Exterior

Use a lukewarm solution of mild soap or detergent to clean the durable finish of the refrigerator. Wipe with a clean damp cloth and then dry.

Interior

Clean the interior regularly. Wash all compartments using a baking soda solution or a mild detergent and warm water. Rinse and dry.

NOTE

- Do not clean the lower drawers in a dishwasher. The high temperature may damage the bins and make them unusable.

After Cleaning

Verify that the power cord is not damaged or overheated. Insert power plug completely into outlet.