

# ALLEGRO COPPER BATEAU DOUBLE SLIPPER TUB

Cat. No.  
COTDSN66P-AC



L: 66"  
W: 30-5/8"  
H: 30-3/8"  
Water depth: 18-1/8" to top of tub  
Wall to center drain: 15-1/4"

The following is recommended for  
COTDSN66P tubs without faucet holes:

- Faucet: part # 4602, 4604 or 7082
- Freestanding bath supplies: part # 4502
- Leg tub drain: Part# 5599LT or 5599TS



Overflow can be drilled.  
With overflow drilled this tub  
requires drain **5599E**.  
**Tubs that have been  
drilled with overflow are  
"special order" and  
are not returnable.**

Gallon Capacity:	63
Shipping Weight:	325 lbs.
Empty Weight:	170 lbs.
Filled Weight:	696 lbs.

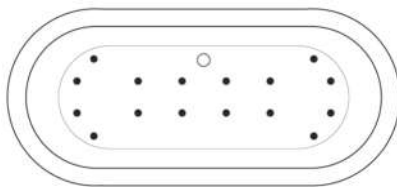

(Air jet configuration if system is added,  
more info on page 2.)

## Features:

- ▶ Made of 16 gauge copper  
(Copper is a living finish and will patina over time)
- ▶ Hammered antique copper exterior
- ▶ Available with hammered antique copper (Allegro)  
or nickel plated interior (Ankara)
- ▶ Hand polished
- ▶ Double Slipper
- ▶ Includes base
- ▶ No overflow
- ▶ No faucet holes
- ▶ Tub is thoroughly inspected before shipment
- ▶ **New:** Air jet system now available, more info on page 2

## Tub Finish:

**AC** Hammered Antique Copper

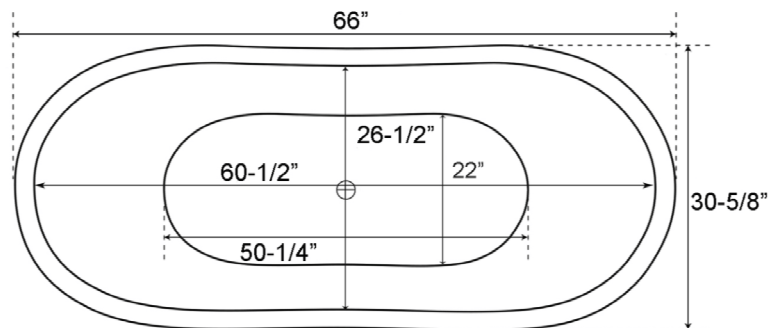
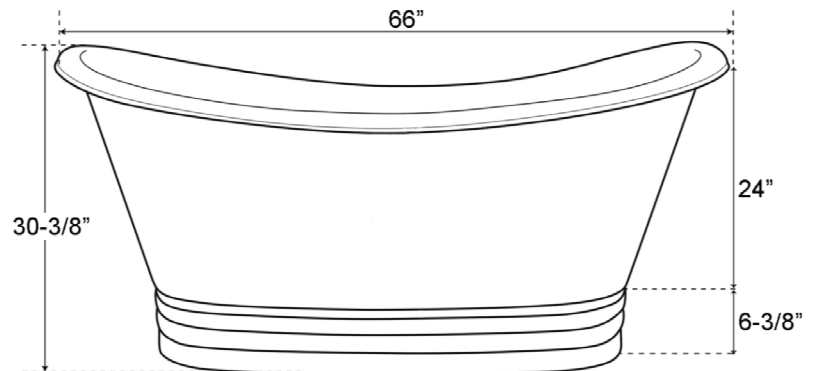

Dimensions and specifications subject to change without notice.

08/15/2022

P 847•244•1234

www.barclayproducts.com

# BATHTUB AIR JET KIT

Cat. No.  
AIR KIT 1, AIR KIT 2

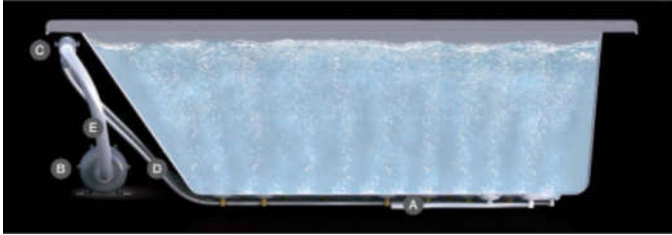

- A** AIR JET - Bottom air jets for maximum bubble action.
- B** BLOWER - The heart of the massage system.
- C** MANIFOLD - Double back flow security prevention device.
- D** FLEXIBLE PVC HOISING - IAPMO certified.
- E** MAIN AIR INTAKE HOSE - High temperature and pressure resistant.

## Features:

- ▶ 750 Watt blower motor operates system
- ▶ 300 Watt air heater warms air
- ▶ System powered by 120V
- ▶ 16 brass air jets placed in bottom of tub
- ▶ Each air jet has 24 holes
- ▶ Air jet caps available in white (AIR KIT 1) or black (AIR KIT 2)
- ▶ Includes 1 1/4" x 3' main air hose plus 1 1/4" x 9' extension hose
- ▶ Automatic system purge after each use
- ▶ Automatic safety timer turns off system after 20 minutes
- ▶ Includes water tight remote control
- ▶ Compatible with most acrylic, copper and resin tubs with no feet
- ▶ Not available with cast iron tubs or tubs with feet

**Air Kit is installed in tub before shipment**

## INSIDE TUB VIEW - WILL VARY BY TUB DESIGN



Air Jet



Remote

**Oval bathtub**  
Sample jet configuration

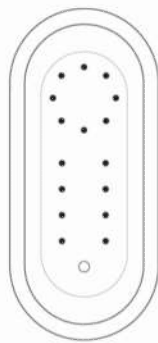

with end drain

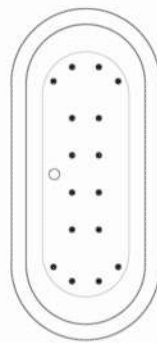

with center drain

**Rectangular bathtub**  
Sample jet configuration

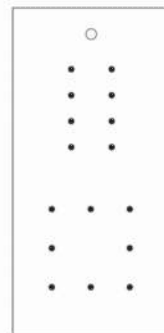

with end drain

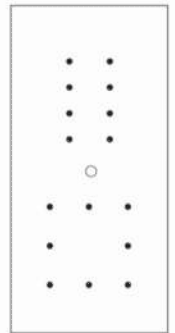

with center drain

**Round bathtub**  
Sample jet configuration

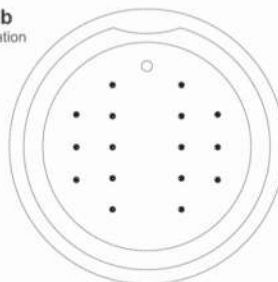

These diagrams are general representations.  
Jet placement may vary dependent on tub shape

### Features:

(16) Maxi Air Jets



Elbows for air jets



Tees for air jets