

# easylift

Thank you for your purchase of EASY LIFT.

View the Easy Lift trimming and installation video at [www.redishade/easy-lift.com](http://www.redishade/easy-lift.com).

 Customer Service: 1-888-608-6611

What's Included:

Easy Lift Shade with Trimming Scale | Trimming Guide

## 1 Measure



Measure your window width in 3 locations. Use the smallest measurement.

*(Please note our patented cutting scale already takes into account the clearance deduction for inside mount.)*

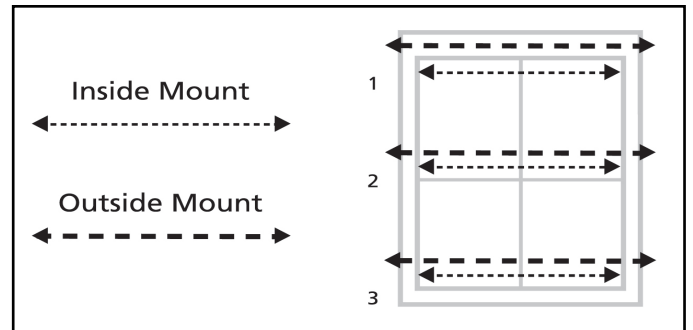

## 2 Trim



A smooth kitchen knife with a 3.5" inch blade is recommended.

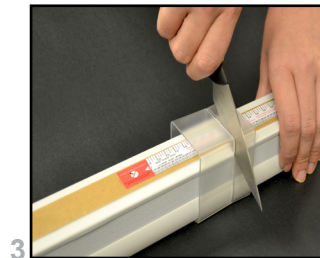
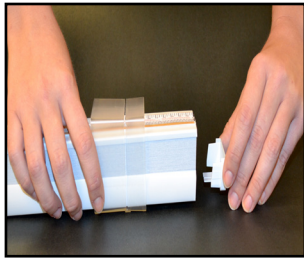

1) Remove bottom rail end caps.

2) Place cutting guide at exact desired width. *(No clearance deduction needed; it's already included).*

3) Position the knife blade at an angle on the top of the shade at your exact measurement.

a) Press firmly cutting through rails and fabric with a rocking motion and constant pressure.

b) Trim each side of the shade to the same exact window measurement.

4) Replace end caps on bottom rail.

## 3 Install & Operate

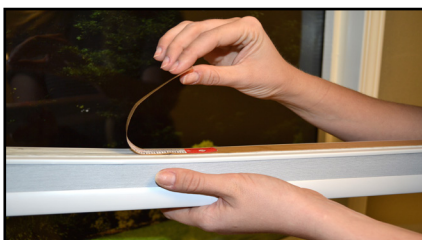

a) Peel to remove liner.



b) Press firmly across width of shade to install.



c) Pull shade down to lower and push up to raise.