

SMART WI-FI
LIGHT SWITCH
START GUIDE



Thank you for purchasing your Geeni smart home product. Ready to get started? Download the Geeni app to manage your TAP (and all other Geeni devices) straight from your phone or tablet. Easily connect to your home Wi-Fi and control multiple devices with the touch of your fingertips.

Contents

Download & Register	2-4
Install	5-7
Reset & Restart	8-9
Connect (Easy Mode)	10-11
Connect (AP Mode)	12-13
FAQ, Troubleshooting, Notices	14-17

WARNING: RISK OF ELECTRIC SHOCK OR FIRE. Please follow all safety instructions on page five before installing, servicing, or removing your TAP.

What's in the Box

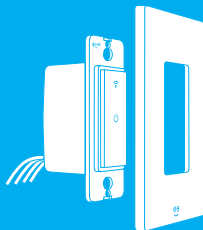

SMART WI-FI
LIGHT
SWITCH
START GUIDE

VOICE
CONTROL
GUIDE

- Smart Wi-Fi Light Switch
- Face Plate
- 4 x Wire Nut
- Start Guide
- Voice Control Guide

Get Ready

- Turn OFF power supply at the circuit breaker or fuse. Use a noncontact voltage tester to ensure that power is off. More than one disconnect switch may be required to turn off power.
- Confirm that you are replacing a single pole (single switch), one-way switch (not a 3-way switch where 2 switches control one fixture).
- Make sure the existing switch box has a neutral wire.

1 Download the Geeni app

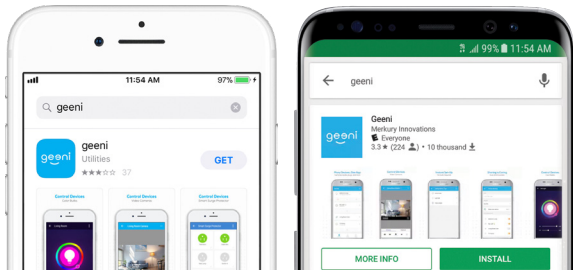

2 Register a Geeni account

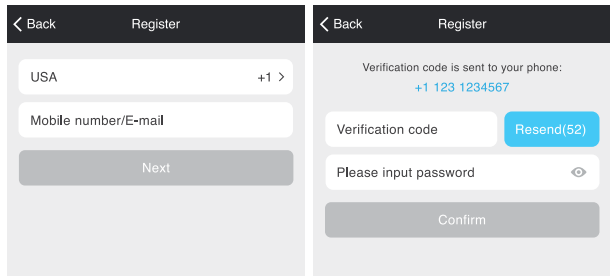

STEP 1
Enter your mobile phone number
or email address.

STEP 2
Enter the verification code
and create a password.

2

Register a Geeni account, cont.

The screenshot shows the login interface of the Geeni app. At the top, there are navigation options: a back arrow and the word "Login". Below this, there are four input fields: "Country / Region" (with "USA +1" selected), "Mobile number/E-mail", "Password" (with an eye icon for visibility), and a "Login" button. At the bottom, there are two links: "Sign in with SMS verification" and "Forgot password".

STEP 3
Log into the app.

3

Install

STEP 1

Shut off power at the circuit breaker for the switch that you are replacing. More than one disconnection may be required to turn off power. Use a noncontact voltage tester to ensure that power is off.

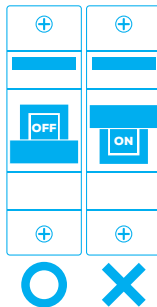

STEP 2

Make sure the existing switch box has a neutral wire*. Remove old switch by disconnecting all wires.

*Neutral wire is typically white.

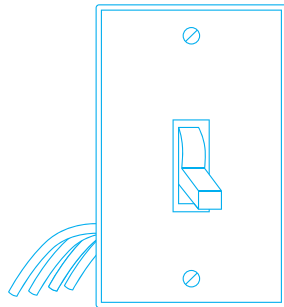

Disconnect all wires.

3 Install (cont'd)

STEP 3
Connect TAP's neutral wire (white) to your home's neutral wire. Connect TAP's two live/load (black) wires (labeled as "switch" on the back of TAP) to your home's live/load wires. Be mindful not to reverse the live and load wires. Connecting TAP's ground wire (green) to your home's ground wire is optional. Check that all wire nuts are secured.

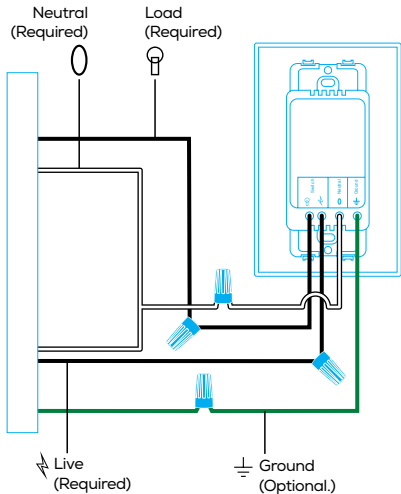

3 Install (cont'd)

STEP 4
Use screws to secure TAP into your wall. Snap on the included faceplate.

STEP 5
Restore power by reversing step 1.

STEP 6
Once power is connected, the blue indicator light will blink to indicate that TAP is ready to connect to Wi-Fi.

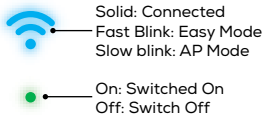
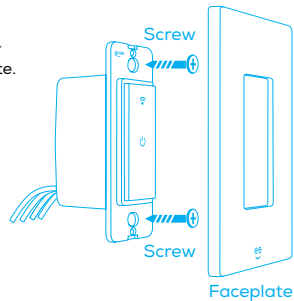

4

Reset and restart

QUICK TIP: On the TAP Faceplate, the Reset button is also known as the **Power Reset** button and the Restart button is also known as the **Wi-Fi Reset** button.

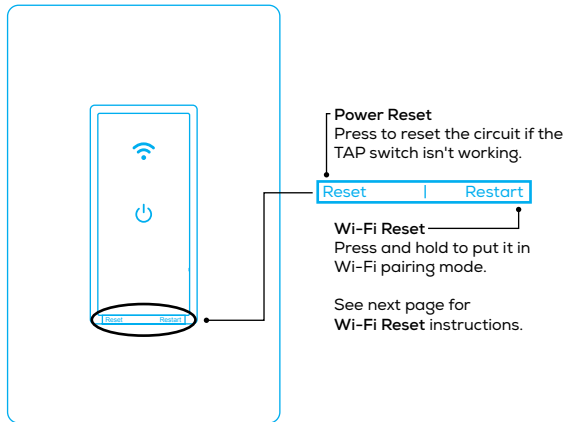

4

Reset and restart (cont'd)

How do I reset TAP and what does the blinking light mean?

Reset TAP by pressing and holding the **Wi-Fi Reset (Restart)** button for 3 seconds until the indicator begins to rapidly flash. The **Wi-Fi Reset** button is located on the bottom right side of the switch (not the switchplate) labeled "Restart".

- Reset one time (press and hold) to reach Easy Mode (Rapidly blinking blue, 2x per second)
- Reset again (press and hold) to reach AP Mode (Slowly blinking blue, every 3 seconds)

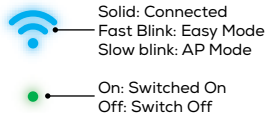

5

Connect: Easy Mode

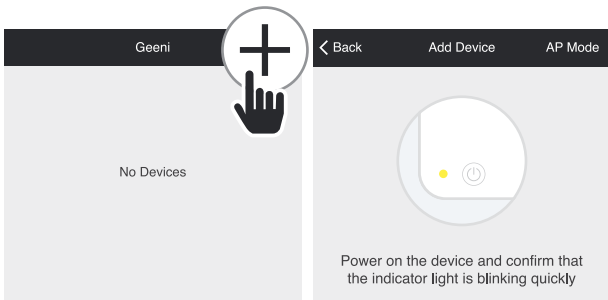

STEP 1

Open the Geeni app. In the top corner of the Devices screen, click (+).

Choose "Smart Power".

STEP 2

Make sure TAP's light is rapidly flashing blue.

If not, reset to reach Easy Mode to connect (Page 9).

Press "Next Step" in the app.

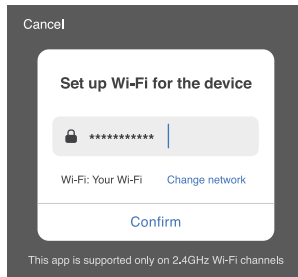

STEP 3

Enter your Wi-Fi network and password.

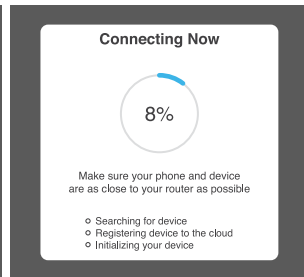

STEP 4

The Geeni app will connect to TAP.

NOTE: Geeni can't connect to 5GHz networks.
*If the connection fails, try to connect using AP Mode.

STEP 1

Make sure TAP's light is slowly flashing blue.
If not, reset to reach AP mode (page 9).

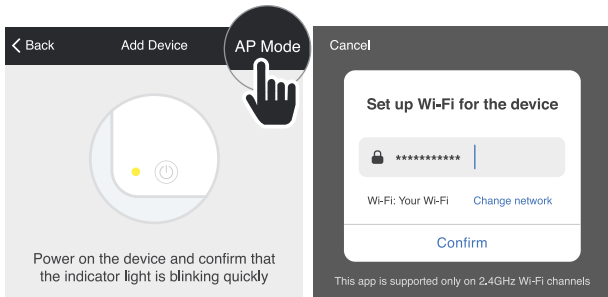

STEP 2

Open the Geeni app. In the top corner of the Devices screen, click (+).

Choose "Smart Power".

Choose "AP Mode" in the top corner.

STEP 3

Press "Next" and enter your Wi-Fi details.

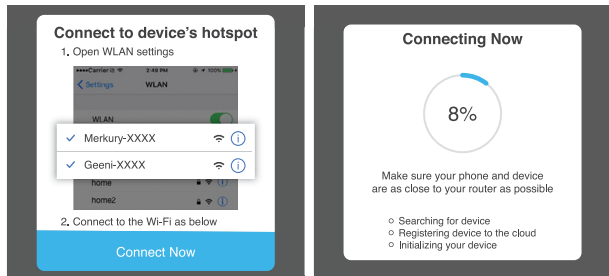

STEP 4

Follow the instructions to choose the device from your Wi-Fi list.

STEP 5

The Geeni app will connect to TAP.

NOTE: Geeni can't connect to 5GHz networks.

Frequently Asked Questions

1. Can I share with family and friends?

Yes, you can share access to TAP and any other Geeni device. In the Geeni app, press the "Profile" button and click on "Device Sharing" to give or revoke sharing permissions. In order to share, the other user should already have downloaded the Geeni app and registered an account.

2. Can I group multiple Geeni devices together?

Yes, you can group multiple same-type devices by room, location, or however else you want. The same devices can be in multiple groups. For example, if you create a group for "Bedroom" and another group for "Entire House," your Bedroom lights can be included in both groups. From your main device list, click on one of the devices you want to group, press the "...", and click "Create Group." You'll be able to name a new group and choose which devices you'd like to group together.

3. How many devices can I control?

Geeni's app can control an unlimited amount of devices in an unlimited amount of locations. Your router may have a limit of how many devices can be connected to one router.

4. My Geeni device has a funny name. How do I rename it?

From your main device list, click on one of the devices you want to rename, press the "...", and click "Modify Device Name" (or "Modify Group Name"). You'll then be able to choose a more familiar name. To rename a particular outlet, click the small pencil icon next to its name.

5. What should I do if the device appears offline or is unreachable?

Make sure your Wi-Fi router is online and in range, and check that you have the latest Geeni functionality by clicking "Check for firmware update" in your device settings. If power is connected but TAP is not responding, hold down the Restart button to cycle the fuse and give TAP a jump start.

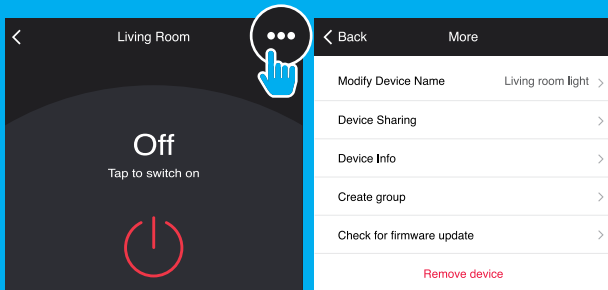

6. What's the wireless range?

The range of your home Wi-Fi is heavily dependent on your home router and the conditions of the room. Check with your router specifications for exact range data.

7. If my Wi-Fi/Internet goes down, will Geeni still work?

Geeni products need to be connected to Wi-Fi in order to use them remotely.

8. What do the green and blue lights mean?

The green light indicates power. If the green light is on, TAP is receiving power; if it is off, TAP is not receiving power. The blue light indicates connection. If the blue light is solid, TAP is connected; if it is flashing quickly, TAP is ready to connect using the Easy Mode (page 10); if it is flashing slowly, TAP is ready to connect using the AP Mode (page 12).

Troubleshooting

Can't connect to Wi-Fi?

Make sure you entered the correct Wi-Fi password during the Wi-Fi setup. Check whether there are any Internet connection problems. If the Wi-Fi signal is too weak, reset your Wi-Fi router and try again.

Reset the device

To reconnect to Wi-Fi, hold down the Reset button for 3 seconds.

- Reset 1 time (press and hold) to reach Easy Mode, indicated by rapidly blinking blue light. Refer to page 10 to connect in Easy Mode.
- Reset 2 times (press and hold) to reach AP Mode, indicated by slowly blinking blue light. Refer to page 12 to connect in AP Mode.

System Requirements

- Existing neutral wire
- Two existing screws
- Existing single pole, one-way (not multi-location) light switch with box more than 2 inches deep
- Mobile device running iOS® 9 or higher or Android™ 5.0 x or higher
- Existing 2.4GHz Wi-Fi network (not compatible with 5GHz Wi-Fi networks)
- Geeni app

IMPORTANT: TAP requires a neutral wire and single pole. TAP is a one-way switch, not a multi-location switch. Please consult a licensed electrician if you cannot locate a neutral wire or are unfamiliar with electrical installations.

Technical Specifications

- Rated Current: 10A
- Input - 100V-240V,50/60Hz
- Max Output - 800W INC
400W CFL / 400W LED

FCC Notice:

This device complies with Part 15 of the FCC Rules. Operation is subject to the two following conditions:

1. This device may not cause harmful interference.
2. This device must accept any interference received, including interference that may cause undesired operation.

Note: This equipment has been tested and found to comply with the limits for a Class B digital device, pursuant to Part 15 of the FCC Rules. These limits are designed to provide reasonable protection against harmful interference in a residential installation.

Important Information:

Before installing, read and follow all precautions, including the following:

CAUTION: RISK OF ELECTRIC SHOCK OR FIRE

TAP must be installed and used in accordance with the National Electric Code. Please consult a licensed electrician if you are uncomfortable or unfamiliar with electrical work. Disconnect power before installing or modifying this product.

CAUTION: Suitable for indoor use only.

Support:

If you encounter any issues, please call (888) 232-3143 (Toll Free)

or email support@mygeeni.com for help. Support is available seven days a week.

To explore our full selection of products, visit us at: www.mygeeni.com

© 2019 Mercury Innovations • 45 Broadway 3rd FL, New York NY 10006.

The illustrated product and specifications may differ slightly from those supplied. Geeni is a trademark of Mercury Innovations LLC. iPhone, Apple and the Apple logo are trademarks of Apple Inc., registered in the U.S. and other countries. App Store is a service mark of Apple Inc. Galaxy S is a registered trademark of Samsung Electronics Co., Ltd. Google, Google Play, and related marks and logos are trademarks of Google LLC. iOS is a registered trademark of Cisco in the U.S. and other countries and is used under license. Amazon, Alexa and all related logos are trademarks of Amazon.com, Inc. or its affiliates. All other trademarks and trade names are those of their respective owners.

Made in China

Can't connect? Need help?



DO NOT RETURN THIS
PRODUCT TO THE STORE

Geeni support:

support@mygeeni.com

1 (888) 232-3143

Tap "Support" in the Geeni app