



Item #1002916252
Model #KECP10-LED

Use and Care Guide

Low Voltage Pathlight Kit

PACKAGE CONTENTS



A - Transformer x1



B - Bracket x1



C - Photocell x1



D - Dust cap x1



E - 4.8 x 30 Screw x4



F - 3.5 x 15 Screw x2



G - Wall anchor x4



H - Wire x1



I - Lamp body x6



J - Lamp post x6



K - Wire connector x6



L - Ground stake x6



M - Mounting template x1

Safety Information



WARNING: Risk of Electric shock. Do not install the path lights within 10 ft. (3m) of a pool, spa, or fountain.



WARNING: These path lights are for use with outdoor landscape lighting systems only.



WARNING: Do not disassemble the power supply unit.



WARNING: Do not submerge the transformer.



WARNING: Do not connect two or more transformers in parallel.



WARNING: Do not use with a dimmer.



WARNING: Plug the power supply directly into a GFCI wet location outlet.



WARNING: Do not use an extension cord.



WARNING: Do not overload the transformer. The maximum output of the transformer is 30 watts. Ensure that the total cumulative wattage of all 12 volt fixtures connected to the transformer is equal to or less than 30 watts.



WARNING: Do not install where airflow around the unit is overly restricted.



NOTE: This landscape lighting system must be installed in accordance with all local codes and ordinances. If you are expecting problems, contact a qualified electrician.



IMPORTANT: The main low voltage cable is intended for shallow burial - less than 6 in. (15.2 cm).



IMPORTANT: Route fixture unit low voltage cable in close proximity to the luminaire or next to a building structure such as a house or deck.



IMPORTANT: The fixture low voltage cable is only intended for shallow burial of less than 6 in. (15.2 cm) when connecting to the main low voltage cable.



IMPORTANT: The fixture low voltage cable may be trimmed to make an electrical connection within 6 in. (15.2 cm) from a building structure, luminaire, or fitting.

CABLE SELECTION

12 VOLT TAP	Cable Length		
	0 - 50 ft.	51 - 100 ft.	101 - 150 ft.
Total Fixture Wattage	0 - 30 Watts	18 AWG	18 AWG
			16 AWG

Assembly and Installation

1 ASSEMBLING AND INSTALLING THE LIGHT FIXTURE



WARNING: Do not push the fixture into the ground by the lamp body or use a hammer to insert the ground stake.

- Screw the lamp body (I) into the lamp post (J).
- Insert the wire with the wire connector (K) into the groove located on the top of the ground stake (L), then screw the lamp post (J) into the top of the ground stake (L).
- Prepare a hole in the installation location. Ensure that the hole is not larger than the ground stake (L).
- Install the fixture in the ground by pushing on the foot step on the ground stake (L). Do not push on the lamp body (I).

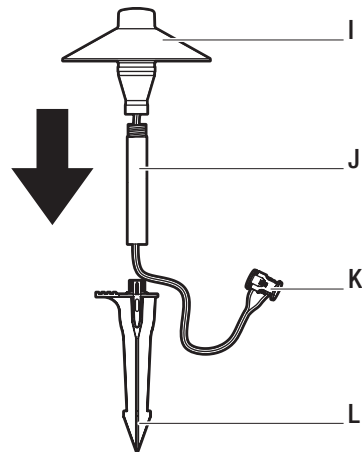

2 WIRING THE TRANSFORMER



WARNING: Ensure that there is no wire insulation under the clamping plate and that the terminal screws are firmly tightened.

- Gently split the end of the wire (H). Strip 1/2 in. from both wires and twist the ends.
- With the transformer (A) on a flat surface, insert one wire into the clamping plate labeled “COM” and one wire in the clamping plate labeled “12V”.
- Gently pull on the wire (H) to verify that the connection is strong.
- Verify that there are no loose cable strands.

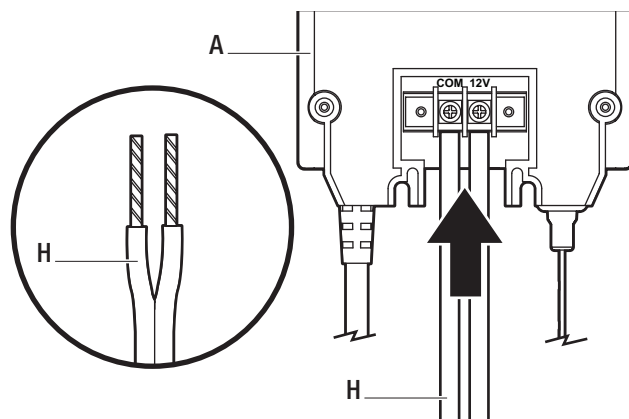

3 MOUNTING THE TRANSFORMER

- Install the screws (E). The spacing between the screw centers is 3.15 in. (80 mm). See the mounting template (M) for correct spacing.
- Hang the transformer (A) onto the screws (E).
- Ensure that the transformer (A) is installed between 12 in. and 48 in. from the ground.

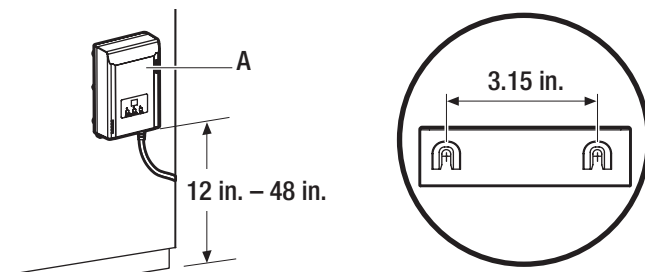

Assembly and Installation (continued)

4 MOUNTING THE PHOTOCELL

- Mount the photocell bracket (B) on the wall using the screws (F) provided.
- Snap the photocell (C) into the bracket (B). Route or coil the excess wire to protect it. Avoid pointing the photocell at nighttime light sources.
- Cover the connection hole with the dust cap (D) when no photocell control wire is connected.



NOTE: Replacement photocells may be purchased at your local retailer.

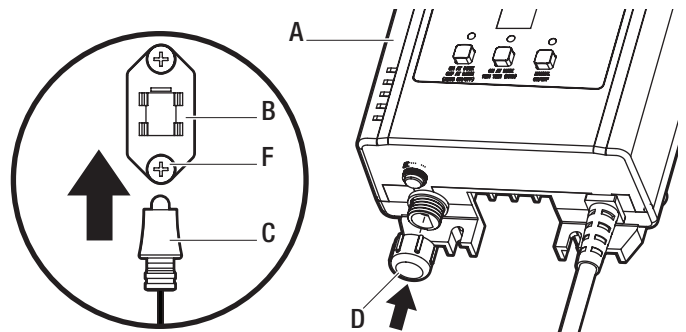

5 CONNECTING THE LIGHT FIXTURES

- Route the wire (H) to the light fixtures. Be sure to leave about 12 in. of wire after the last light fixture.
- Align the wire (H) in the slot of the wire connector (K).
- Press the wire connector (K) together until it is locked around the main wire (H). The metal contacts should pierce the insulation of the wire (H).
- Secure the connection with electrical tape (not included).
- Cover the wire (H) with mulch or bury it up to 6 in.



WARNING: Be sure to leave a minimum of 10 ft. of wire between the transformer and the first light fixture.



CAUTION: The wire connector contacts have sharp edges. To avoid injury, do not touch the metal contacts.

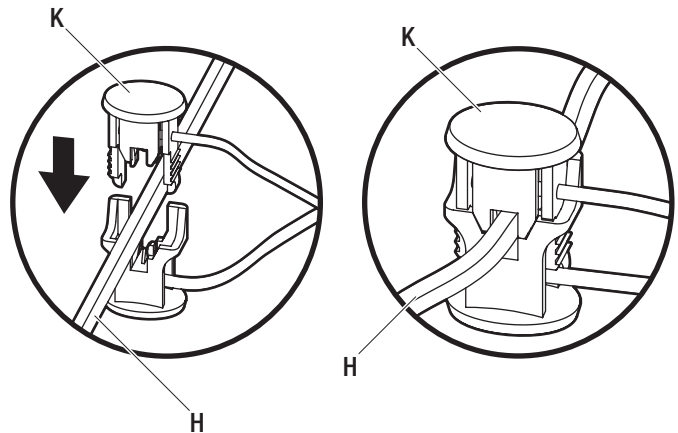

Operation

1 SETTING THE ON AT DUSK/OFF AT DAWN FUNCTION (FACTORY DEFAULT SETTING)

- In this mode, the landscape lights will automatically come on at dusk and turn off at dawn.
- Press ON AT DUSK /OFF AT DAWN button. The related indicator light will illuminate and “AU” (Auto) will display on screen. This mode is now active.



NOTE: The photocell should be installed and secured tightly before transformer operation is set.

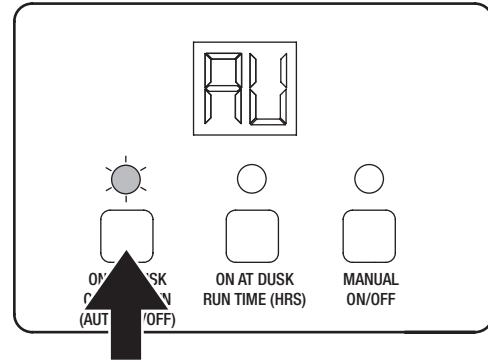

2 SETTING THE ON AT DUSK /RUN TIME FUNCTION

- In this mode, the landscape lights will automatically turn on at dusk and off after the set time (hrs).
- Press ON AT DUSK /RUN TIME button. The related indicator light will illuminate. Increase RUN TIME by pressing ON AT DUSK/RUN TIME button repeatedly until desired RUN TIME is displayed (The time will be displayed as 1,2,...,12 hours).



NOTE: The photocell should be installed and secured tightly before transformer operation is set.

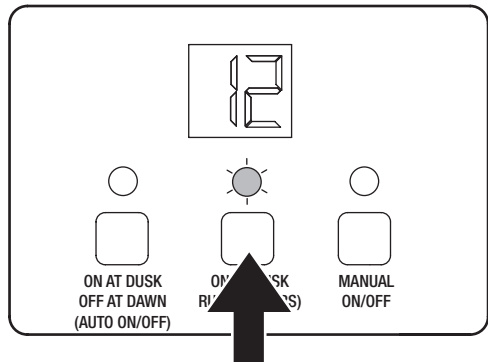

3 SETTING THE MANUAL ON/OFF FUNCTION

- In this mode, the landscape lights can be turned on & off manually.
- Press the MANUAL ON/OFF button. The related indicator light will illuminate. The transformer has now entered MANUAL ON/OFF MODE. Display will first show OFF mode, press button again to toggle landscape lights ON.



NOTE: After 30 seconds the transformer display will go into standby mode, press any button to remove transformer from standby mode.



NOTE: Transformer will retain settings in the event of complete power loss.

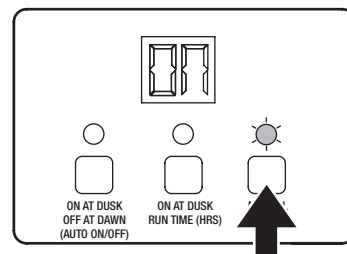
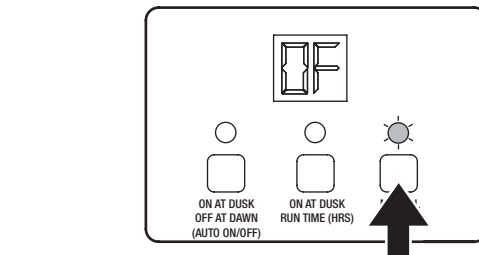

4 RESTORING THE FACTORY DEFAULT FUNCTION

- In any mode, press & hold MANUAL ON/OFF button for 10 seconds. “88” will be displayed on the screen and all the indicator lights will illuminate. The transformer will reset to ON AT DUSK /OFF AT DAWN mode.

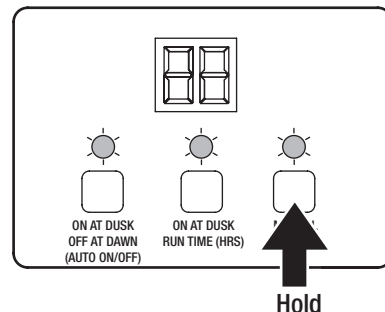

Care and Cleaning

- Clean the light fixture with a soft, dry cloth.
- Do not use cleaners with chemicals, solvents, or harsh abrasives.

Troubleshooting

Problem	Possible Cause	Solution
The fixture will not light.	<ul style="list-style-type: none"><input type="checkbox"/> There is no power.<input type="checkbox"/> There is a disconnection, or break, in the wire.<input type="checkbox"/> The transformer setting is incorrect.	<ul style="list-style-type: none"><input type="checkbox"/> Check the outlet and ensure that the circuit breaker or GFCI has not been tripped.<input type="checkbox"/> Check the wire.<input type="checkbox"/> Check the transformer settings.
One light fixture flickers.	<ul style="list-style-type: none"><input type="checkbox"/> There is a loose wire connector.	<ul style="list-style-type: none"><input type="checkbox"/> Tighten the wire connector and ensure that the metal contacts pierce the insulation on the wire from the transformer.
All light fixtures flicker.	<ul style="list-style-type: none"><input type="checkbox"/> There is a loose connection at the transformer.	<ul style="list-style-type: none"><input type="checkbox"/> Unplug the transformer and check the wire connections.
The lights do not switch on at dusk.	<ul style="list-style-type: none"><input type="checkbox"/> The photocell is mounted in an area that has too much nighttime light.	<ul style="list-style-type: none"><input type="checkbox"/> Install the photocell in a place with little nighttime light.

Warranty

WHAT IS COVERED

The manufacturer warrants this lighting fixture to be free from defects in materials and workmanship for a period of five (5) years from date of purchase. The manufacturer warrants this transformer to be free from defects in materials and workmanship for a period of two (2) years from date of purchase. This warranty applies only to the original consumer and only to products used in normal use and service. If this product is found to be defective, the manufacturer's only obligation, and your exclusive remedy, is the repair or replacement of the product at the manufacturer's discretion, provided that the product has not been damaged through misuse, abuse, accident, modifications, alterations, neglect or mishandling.

WHAT IS NOT COVERED

This warranty shall not apply to any product that is found to have been improperly installed, set-up, or used in any way not in accordance with the instructions supplied with the product. This warranty shall not apply to a failure of the product as a result of an accident, misuse, abuse, negligence, alteration, or faulty installation, or any other failure not relating to faulty material or workmanship. This warranty shall not apply to the finish on any portion of the product, such as surface and/or weathering, as this is considered normal wear and tear.

The manufacturer does not warrant and specifically disclaims any warranty, whether express or implied, of fitness for a particular purpose, other than the warranty contained herein. The manufacturer specifically disclaims any liability and shall not be liable for any consequential or incidental loss or damage, including but not limited to any labor / expense costs involved in the replacement or repair of said product.

Contact the Customer Service Team at 1-855-HD-HAMPTON or visit www.HamptonBay.com.

FCC Warning

Please note that changes or modifications not expressly approved by the party responsible for compliance could void the user's authority to operate the equipment.

NOTE: This equipment has been tested and found to comply with the limits for a Class B digital device, pursuant to part 15 of the FCC Rules. These limits are designed to provide reasonable protection against harmful interference in a residential installation. This equipment generates, uses and can radiate radio frequency energy and, if not installed and used in accordance with the instructions, may cause harmful interference to radio communication.

If this equipment does cause harmful interference to radio or television reception, which can be determined by turning the equipment off and on, the user is encouraged to try to correct the interference by one or more of the following measures:

- Reorient or relocate the receiving antenna.
- Increase the separation between the equipment and receiver.
- Connect the equipment into an outlet on a circuit different from that to which the receiver is connected.
- Consult the dealer or an experienced radio/TV technician for help.



NOTE: Most LED landscape lighting fixtures can operate with full illumination from 15V down to as little as 8V. It is possible to have extended length runs with LED fixtures that go beyond the specifications shown in the guidelines above.