

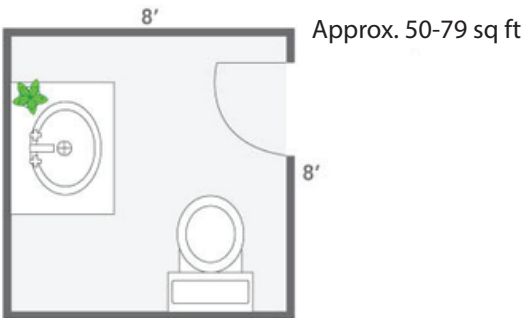

Half Bath

Commonly referred to as a powder room, half bathrooms consist of a toilet and a sink. This bathroom is a low humidity area where the ventilation fan is primarily used to exhaust odor.



Recommended Models

- RVS50
- RVL50
- RVS80
- RVL80

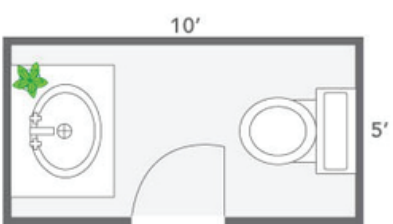

Three Quarter Bath

A three-quarter bathroom is a small to medium sized bathroom commonly housing a vanity, toilet, and either a shower or a bath tub. This bathroom is normally found off a main living area in your home and is often referred to as a guest or common bathroom. This room sees higher levels of humidity and therefore will need a larger CFM model.

We would recommend Humidity Protection for commonly used rooms

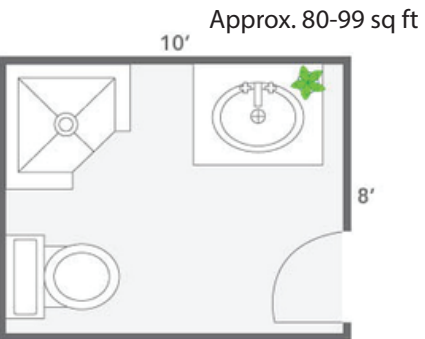

Recommended Models

- RVM80-D
- RVSH80
- RVLH80
- RVL80-D
- RVS80-D

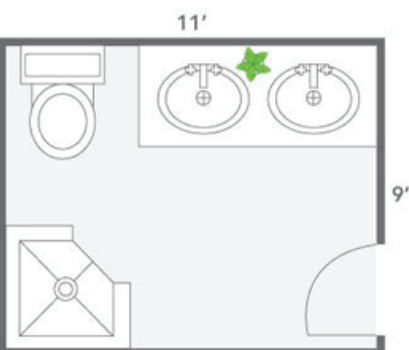



Full Bath

This is a medium to large sized bathroom with a toilet, sink, shower and bath tub. This high traffic bathroom is often used by family and guests and accumulates high levels of moisture and humidity.

Select a Humidity Protection fan in this bathroom to control your fan when your friends and family forget to.

Approx. 100-129 sq ft

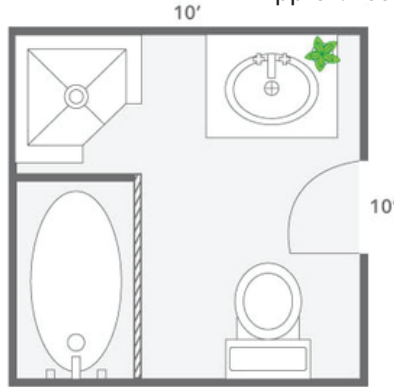

Recommended Models

RVM80-D

RVSH110-D

RVLH110

RVL110-D

RVS110

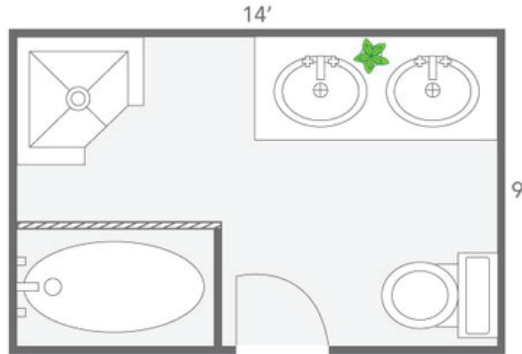

Master Bath

This is the largest bathroom in your home, typically containing a double vanity, shower, bathtub, and toilet. This room is your relaxation destination and can often be a highly humid climate. To control the high volume of air within this space, a larger CFM fan is needed.

Approx. 130 sq ft and up

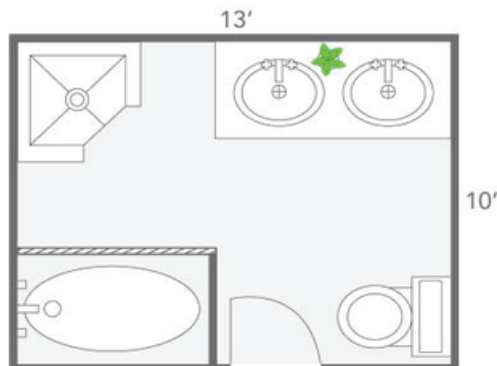

Recommended Models

RVM80-D

RVSH110-D

RVLH110

RVL150

RVSH150



Laundry Room

Unknown to most, the laundry room can create ideal conditions for mold to grow, as the dryer often generates large amounts of heat and moisture. Installing an exhaust fan in the laundry room is an effective tool for eliminating moisture.

Approx. 10-80 sq ft
Avg = 48 sq ft

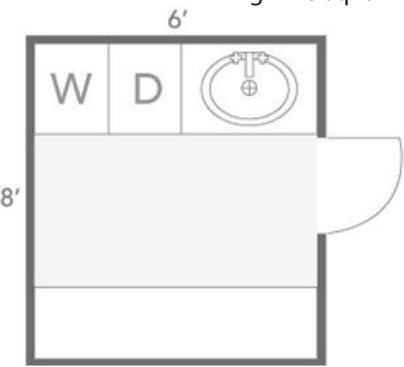

Recommended Models

- RVSH80
- RVSH110-D
- RVL80-D
- RVL110-D



Garage

Unhealthy fumes from vehicles, moisture build up from rain or snow, and deadly carbon monoxide are all hazardous elements that can be found in the average garage. Having a ventilation fan in the garage can help remove the chemicals that could potentially be entering your home. A larger CFM model should be used for most garages.

Avg 2-Car = approx. 676 sq ft

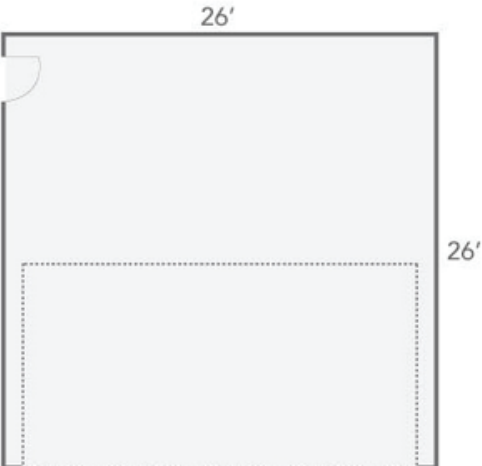

Recommended Models

- RVM80-D
- RVLH110
- RVSH110-D (x2)
- RVS150
- RVSH150