

## Thank You

Thank you for purchasing this product. It was carefully engineered to provide excellent performance when properly operated and maintained.

Please read this entire manual prior to operating the equipment. It instructs you how to safely and easily set up, operate and maintain your machine. Please be sure that you, and any other persons who will operate the machine, carefully follow the recommended safety practices at all times. Failure to do so could result in personal injury or property damage.

All information in this manual is relative to the most recent product information available at the time of printing. Review this manual frequently to familiarize yourself with the machine, its features and operation. Please be aware that this Operator's Manual may cover a range of product specifications for various models. Characteristics and features discussed and/or illustrated in this manual may not be applicable to all models. We reserve the right to change product specifications, designs and equipment without notice and without incurring obligation.

If applicable, the power testing information used to establish the power rating of the engine equipped on this machine can be found at [www.opel.org](http://www.opel.org) or the engine manufacturer's web site.

If you have any problems or questions concerning the machine, phone an authorized service dealer or contact us directly. Customer Support telephone numbers, website address and mailing address can be found on this page. We want to ensure your complete satisfaction at all times.

Throughout this manual, all references to *right* and *left* side of the machine are observed from the operating position.

The engine manufacturer is responsible for all engine-related issues with regards to performance, power-rating, specifications, warranty and service. Please refer to the engine manufacturer's Owner's/Operator's Manual, packed separately with your machine, for more information.

## Contents of Carton

• Edger (1)	• Wing Knob and Rope Guide (1)	• Trenching Blade Kit † (1)
• Edger Operator's Manual (1)	• Engine Operator's Manual (1)	• Fast Start Guide † (1)
• Registration Card (1)	• Parts/Warranty Supplement Sheet (1)	• Oil (1)

† If Equipped

**NOTE:** This machine is shipped WITHOUT GASOLINE or OIL. After setting up the edger, service the engine with gasoline and oil as instructed in the Engine Operator's Manual.

**NOTE:** Reference to right or left hand side of the edger is observed from the operating position.

## Assembly

### Handle

Remove and discard any packaging cardboard that may be present between the upper handle and the lower handle.

1. Pivot the upper handle upward until it snaps into place. See 1 in Figure 2-1.

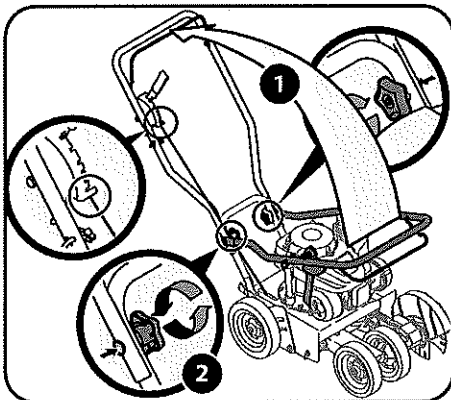

Figure 2-1

2. Tighten the star knobs (a), which are located on both the left and right sides of the handle. See 2 in Figure 2-1.

### Control Cable Z-Fitting

Unwrap the control cable from the engine and route it under the lower handle.

1. Hook the Z end of the brake cable into the control from the outside to inside. See Figure 2-2.

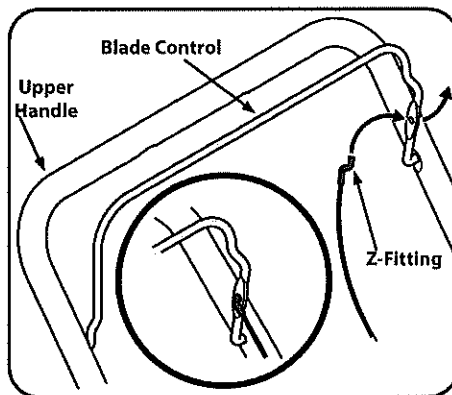

Figure 2-2

### Securing Control Cable



**WARNING:** The cable must be routed properly to avoid contact with all sharp edges and hot surfaces. Such contacts damage the cable and render the controls inoperative.

1. Press the stud found inside the snap fitting into the hole found on the left side of the upper handle, as shown in Figure 2-3.

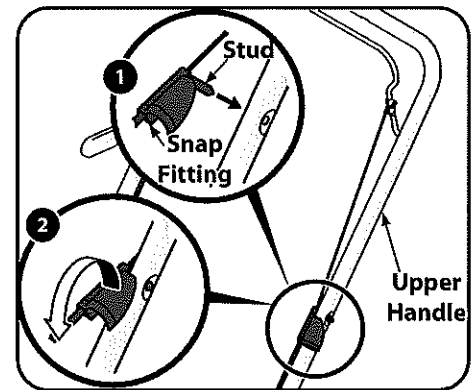

Figure 2-3

2. Push the snap fitting down on the handle to secure it into place.

### Securing Blade Depth Control Cable

Unwrap the blade depth control cable from around the rear axle and route it up through the slot on the frame and up the right side of the handle.

1. Pull the depth control lever out of the first position of the depth control bracket.
2. Push lever all the way forward.
3. Release lever into last position of bracket.
4. Hook the Z end of the depth control cable into the hole on the depth control lever as shown in Figure 2-4.

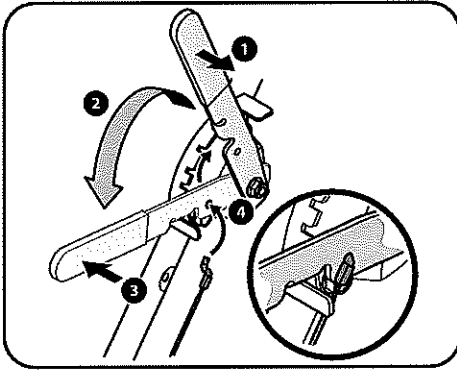

Figure 2-4

### Starter Rope

Locate the rope guide and wing knob found in the manual bag. Using the wing knob (a), secure but do not tighten the rope guide to the right side of the upper handle.

1. Stand behind the edger and hold the blade control against the upper handle. See Figure 2-5.

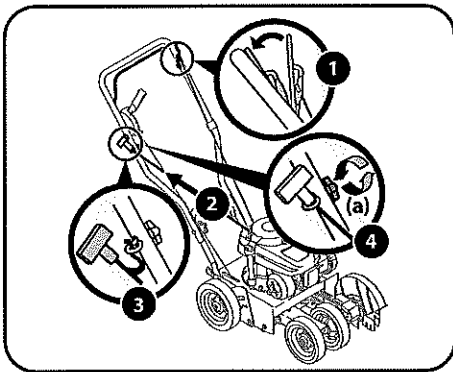

Figure 2-5

2. Gently pull the starter rope out of the engine.



**WARNING!** The edger blade **WILL** rotate when the starter rope is pulled.

**NOTE:** The starter rope will not pull out of the engine unless the blade control (refer to Figure 2-5) is depressed against the upper handle.

3. Slip the starter rope through the top of the rope guide.
4. Tighten the wing knob (a) which secures the rope guide to the upper handle.

### Adjustments

#### Bevel Adjustment (IF EQUIPPED)

The angle of the edger blade can be adjusted by placing the bevel adjustment in one of three positions for edging. See Figure 2-6.

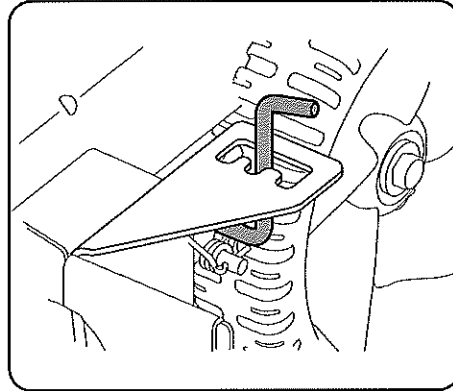

Figure 2-6