

CHILDREN'S ELECTRONIC TOY RIDE-ON

- Suitable for 3+ Years
- Maximum user weight: 50 kg



WARNING Must be assembled by an adult.

OWNERS MANUAL

with Assembly Instructions

Read and understand this entire manual before using!

Please keep this manual for future reference as it contains important information. Before first time use, charge the battery for at least 4-6 hours, but no more than 10 hours.

On the purchase of your new Ride-On.

This ride-on car will provide your child with many miles of riding of enjoyment. To help assure you and your rider a safe ride we ask you to please read this manual carefully, and keep it for future reference.

Follow the recommendations in this manual, they are designed to improve the safety and operation of your ride-on car and its rider.

Specification

Battery	12V4.5AH X1	12V7AH X1	12V10AH X1
Charger	12V500mA	12V700-1000mA	12V1000mA
input	Depend on local voltage		
Motor	550-12000	550-12000	550-12000

Suitable age: 3+ Years

Charge time: 8~12 hours

Load capacity: Under 50 kg

Size of car:v 1145×725×730MM mm

Speed: 2-8 km/h



BATTERY INFORMATION

- Non-rechargeable batteries are not to be recharged.
- If removable rechargeable batteries are used, the are only to be charged under adult supervision.
- Remove rechargeable batteries from the product before charging.
- Do not mix old and new batteries. Do not mix different types of batteries: alkaline, standard (carbon-zinc) or rechargeable (nickel-cadmium).
- Insert batteries as indicated inside the battery compartment, anode to anode, cathode to cathode.
- Remove batteries during long periods of non-use. Always remove exhausted batteries from the product. Battery leakage and corrosion can damage this product. Dispose of batteries safely.
- Never short circuit the battery terminals.

NO.	PART NAME	Q'TY (PCS)		REMARK
1	Vehicle body	1		
2	Gear box	2		
3	Wheel driver	2		
4	Wheel	4		
5	Ø12 washer	2		
6	Ø10 washer	4		
7	Lock nut	4		
8	Wheel cover	4		
9	Driving wheel house	1		
10	Rear axle	1		
11	Front axle	1		
12	Ø4x12 screws	38		
13	Side mirror	1		left and right
14	Steering wheel	1		
15	M5x45 machine screw	1		
16	Ø5 nut	1		
17	Windshield	1		
18	Seat	1		
19	Seat back	1		
20	Light bar linkage	1		
21	Light bar support	2		left and right
22	Front bumper	1		
23	Right front fender	1		
24	Right rear fender	1		
25	Spanner	2		
26	Charger	1		
27	Remote controller	1		If equipped

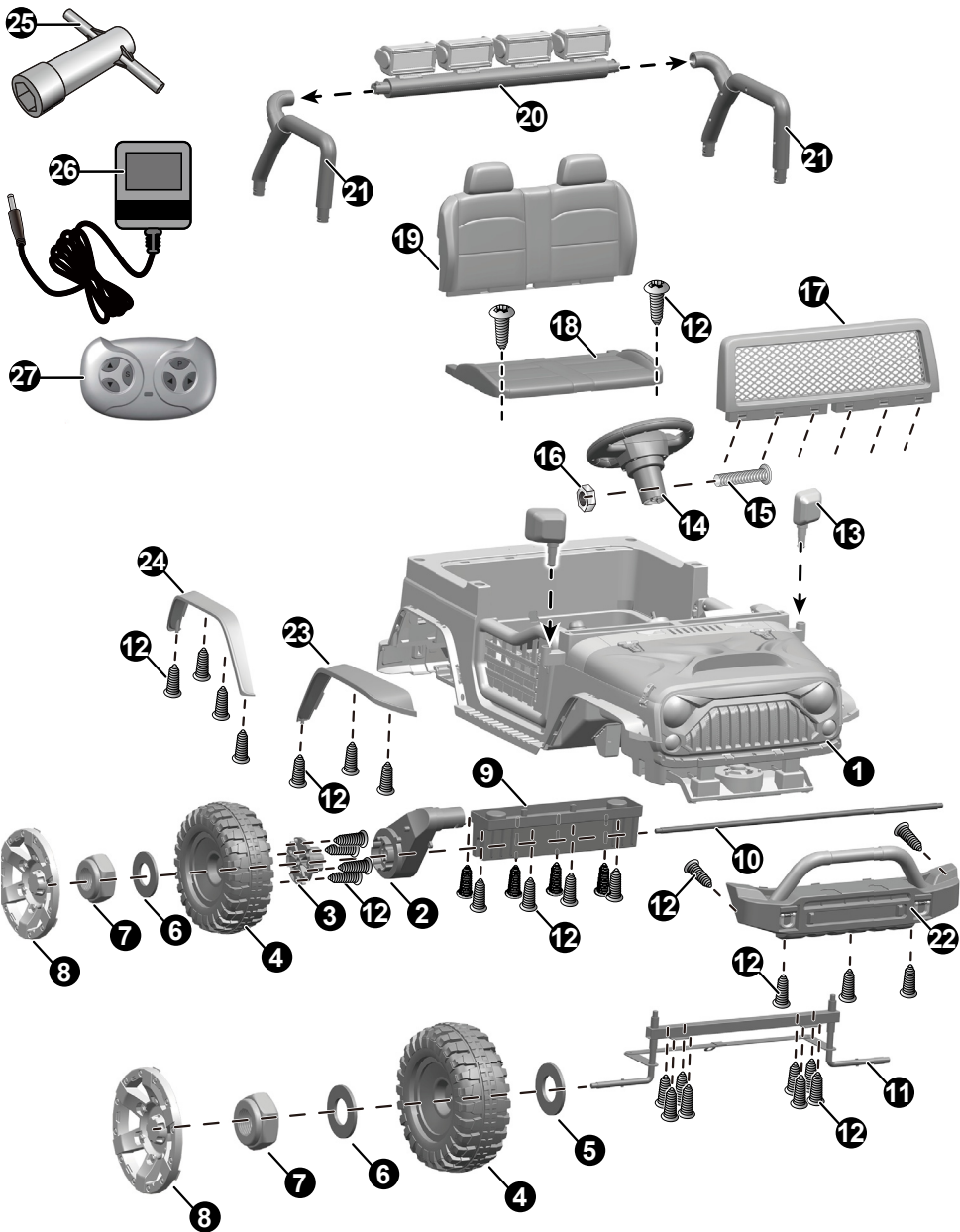

HINT: Some parts shown are assembled on both sides of vehicle

**PREVENT INJURIES AND DEATHS:**

- **NEVER LEAVE CHILD UNATTENDED. ADULT DIRECT SUPERVISION IS REQUIRED.** Always keep child in view when child is in vehicle.
- This toy should be used with caution since skill is required to avoid falls or collisions causing injury to the user or third parties.
- Protective equipment should be worn.
- Never use in roadways, near cars, or on near steep inclines or steps, swimming pools or other bodies of water.
- Always wear shoes, always sit on the seat.
- Not to be used in traffic.
- This toy is unsuitable for children under 36 months due to its maximum speed; Maximum user weight is 50 kg.
- This toy has no brake.

**WARNING:**

- **CHOKING HAZARD!** Not suitable for children under 36 months.
- **Must be assembled by an adult.**

Rules for Safe Riding

- Keep Children within Safe Riding Areas:
 - Never use in roadway, near motor vehicles, on lawn space, on or near steep inclines or steps, swimming pools or other bodies of water;
- Use the toy only on flat surfaces. Such as inside your house, garden or playground.
- Never use in the dark. A child could encounter unexpected obstacles and have an accident. Operate the vehicle only in the daytime or a well-lit area.
- It is prohibited to change the circuit or add other electric parts
- Inspect wires and connections of the vehicle periodically.
- Do not let any child touch the wheels or be near them when the car is moving .
- This vehicle has adjustable play seat belts. Please instruct children how to tie the safety belt before using, guarantee the security.

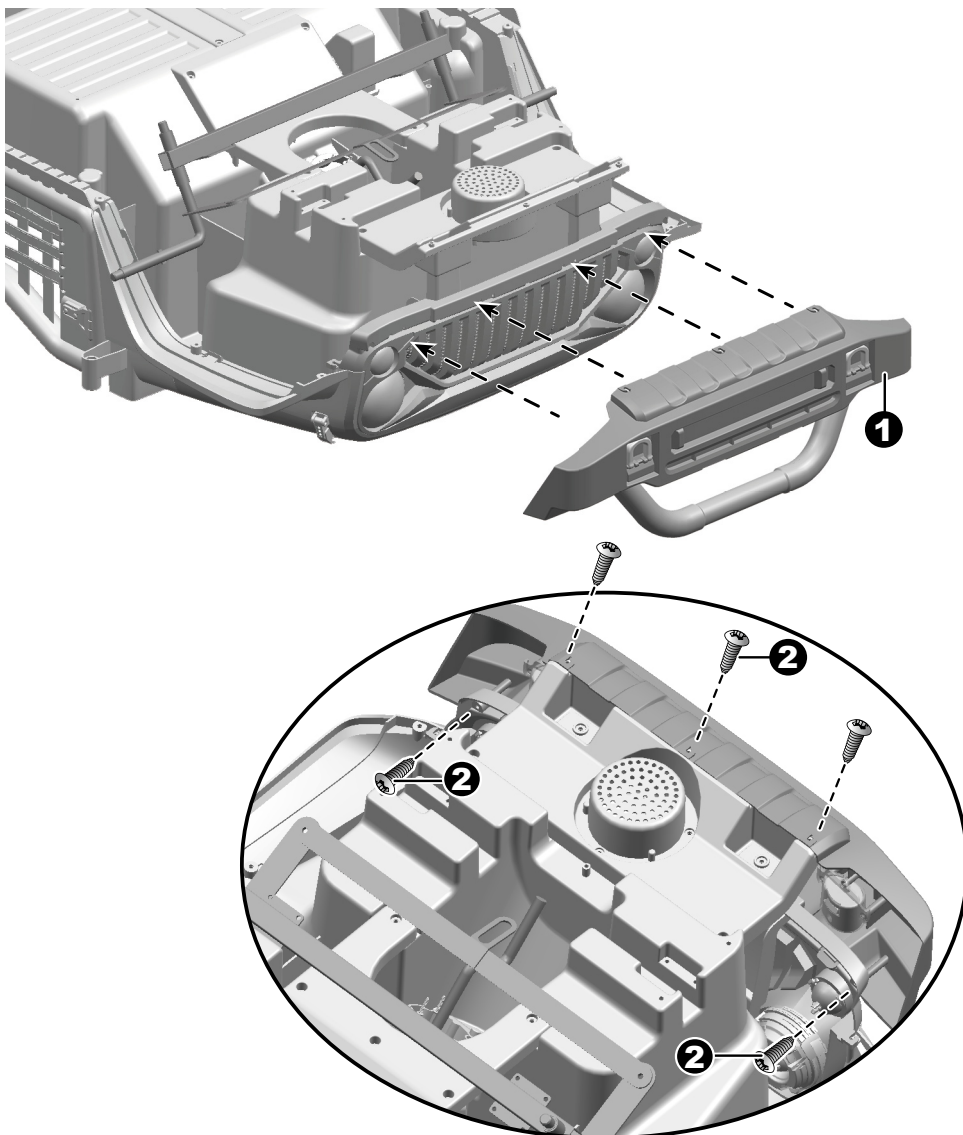

Turn the vehicle body upside down.

1. “Snap” the front bumper to the vehicle body.
2. Tighten five $\varnothing 4 \times 12$ screws with a screwdriver.

HINT: The front and rear fenders on the left side have been assembled by factory.

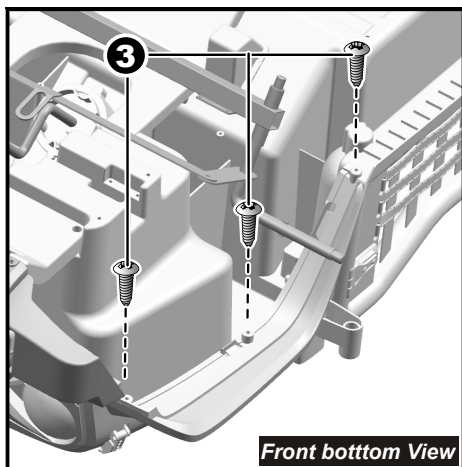
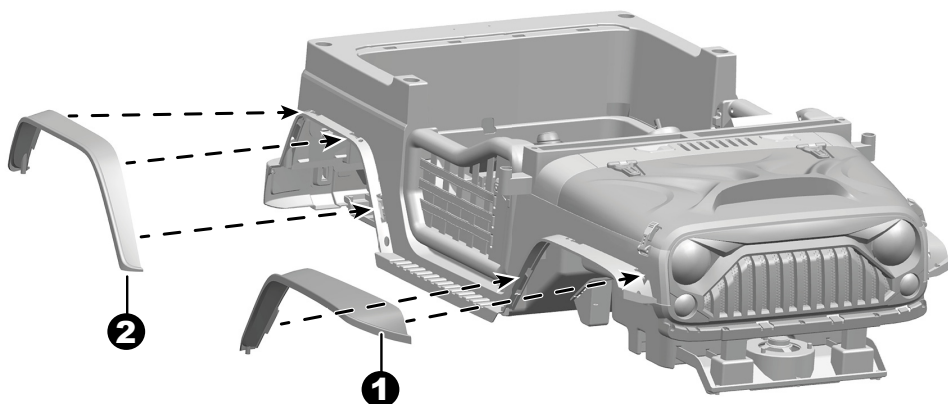

Front bottom View

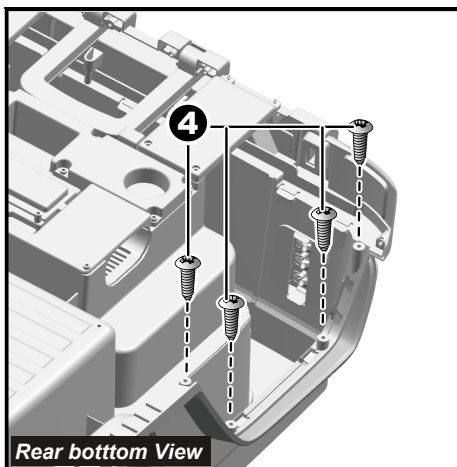

Rear bottom View

Turn the vehicle body upright.

1. “Snap” the front fender to the vehicle body.
2. “Snap” the rear fender to the vehicle body.

Turn the vehicle body upside down.

3. Insert three Ø4x12 screws through the vehicle body and into the front fender, tighten with a screwdriver.
4. Insert four Ø4x12 screws through the vehicle body and into the rear fender, tighten with a screwdriver.

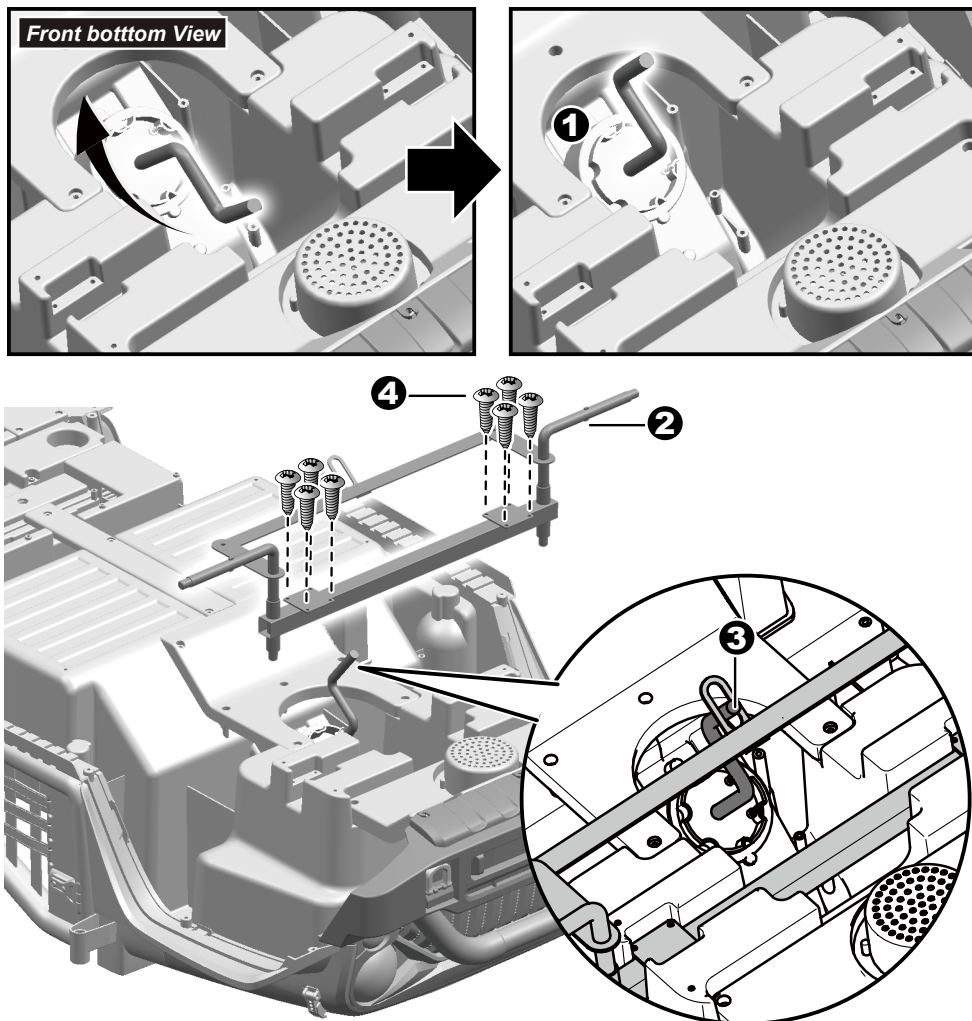

1. Rotate the front axle 180 degrees as shown.
2. Fit the front axle to the vehicle body.
3. Insert the bent end of the steering column into the hole in the front axle linkage.
4. Insert eight Ø4x12 screws and tighten with a screwdriver.

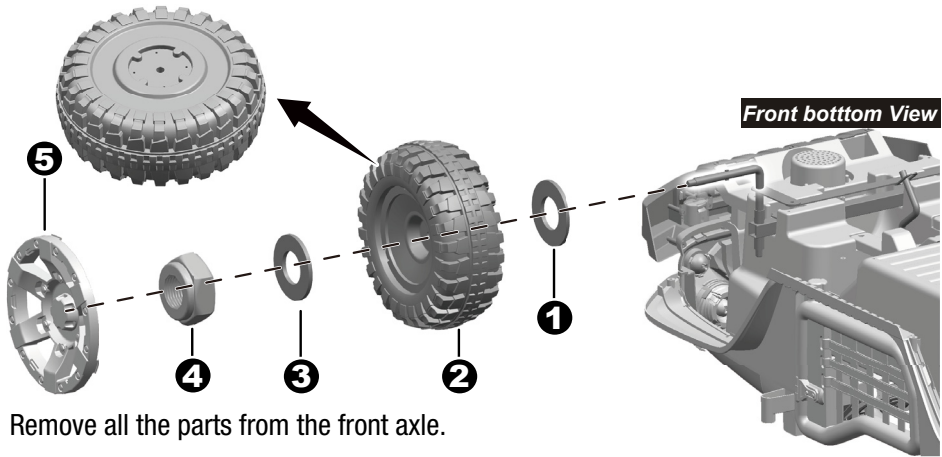

Remove all the parts from the front axle.

1. Slide a **Ø12** washer onto the front axle.
2. Slide a front wheel onto the front axle.
3. Slide a **Ø10** washer onto the front axle.
4. Tighten a lock nut to the end of the front axle with a spanner. DO NOT over tighten.
5. “Snap” the hubcap to the wheel.

Repeat the above procedure to assemble the other rear wheel.

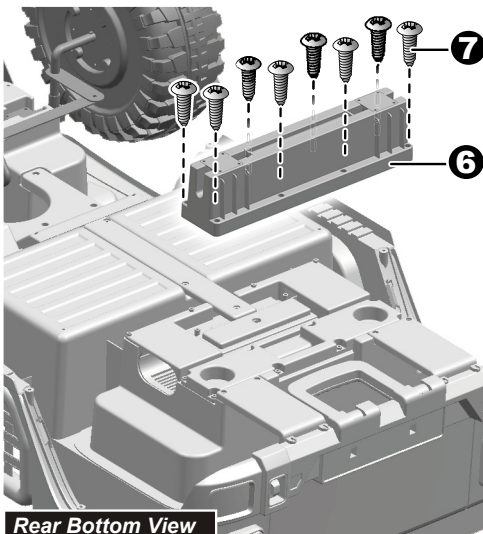

6. Fit the rear wheel house onto the vehicle body.
7. Insert eight **Ø4x12** screws and tighten with screwdriver.

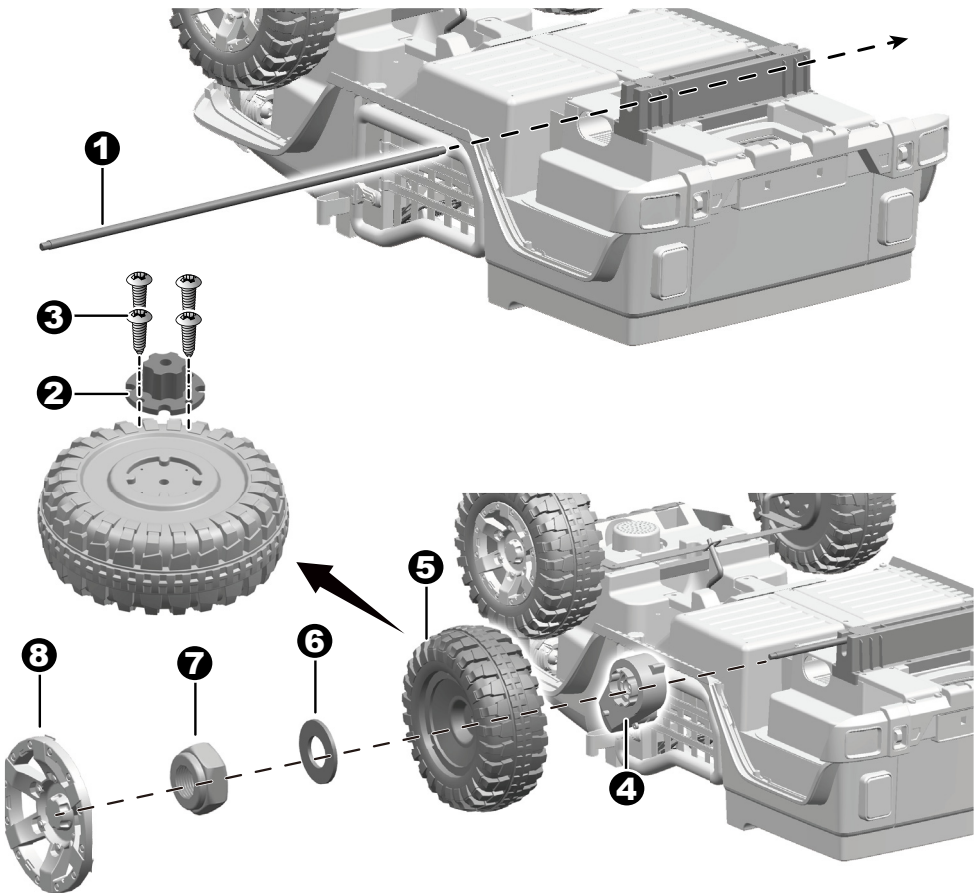

Remove all the parts from the rear axle.

1. Insert the rear axle through the hole in the rear wheel house.
- 2-3. Fit the wheel driver to the wheel, Tighten four Ø4x12 screws with screwdriver.
4. Slide a gear box on the rear axle, and ensure the motor on the gear box passes through the hole in the vehicle body.
5. Slide a driving wheel onto the rear axle. The gear part on the driving wheel should match up with the gear box.
6. Slide a **Ø10** washer onto the front axle.
7. Tighten a lock nut to the end of the front axle with a spanner. DO NOT over tighten.
8. "Snap" the hubcap to the wheel.

Repeat the 2-8 procedures to assemble the other rear wheel.

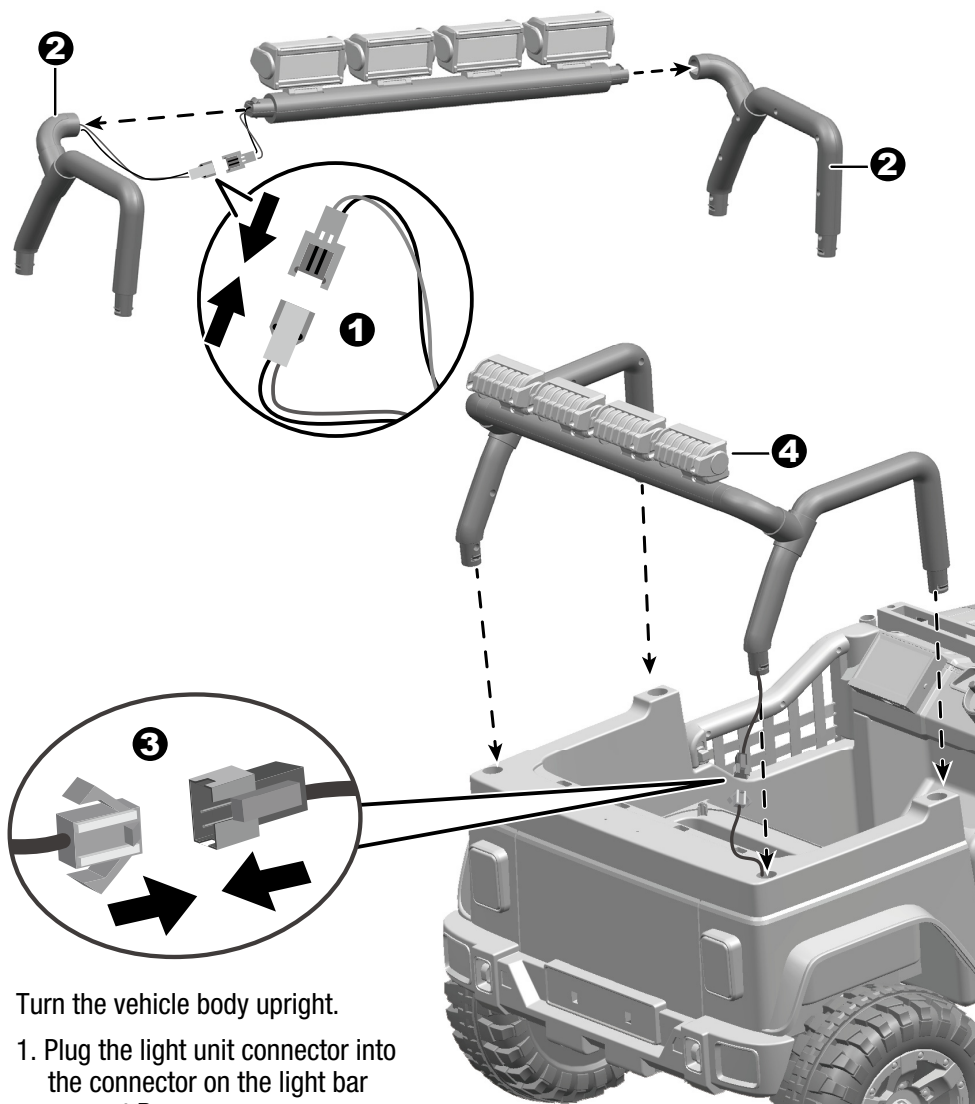

Turn the vehicle body upright.

1. Plug the light unit connector into the connector on the light bar support R.
2. Fit the light bar supports to the light bar.
3. Plug the connector on the light bar into the connector in the vehicle body.
4. Insert the tabs on the light bar into the holes, and push it until you hear it “click” into place.

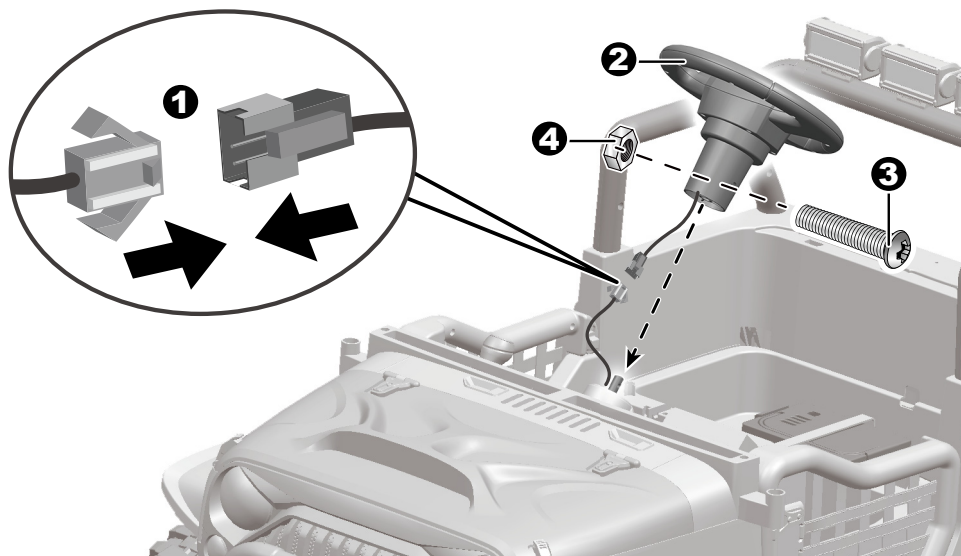

1. Plug the sound unit connector on the steering wheel into the connector on the vehicle body.
2. Fit the steering wheel to the end of the steering column.
3. Line up the holes on the steering wheel with the holes on the steering column, insert the M5x45 machine screw.
4. Fasten a nut on the opposite end of the screw with a screwdriver.
5. Insert the tabs on the windshield into the grooves on the vehicle body, push until you hear it “click” into place.

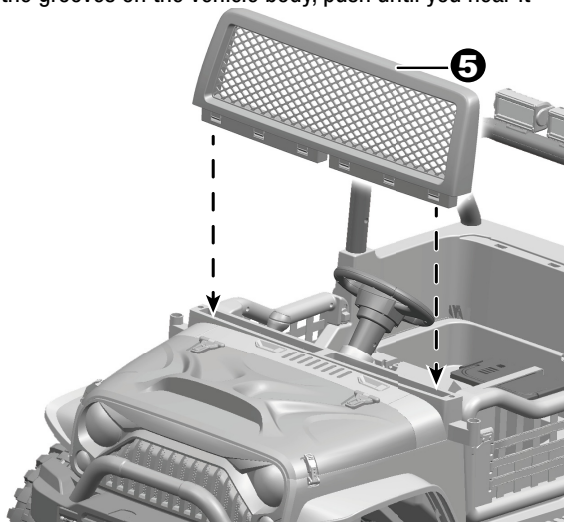

1. Insert the mirror into the hole on the side of the vehicle body.
2. Plug the red connector on the vehicle body into the red connector on the battery.
3. Plug the white connector on the motor into the white connector of the vehicle body.
Repeat for the other side.

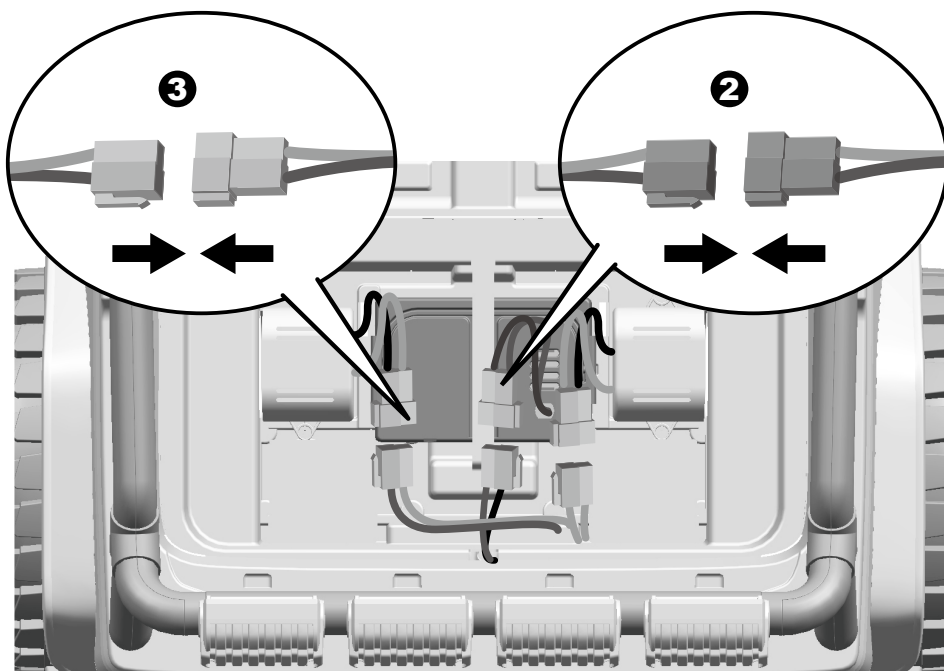
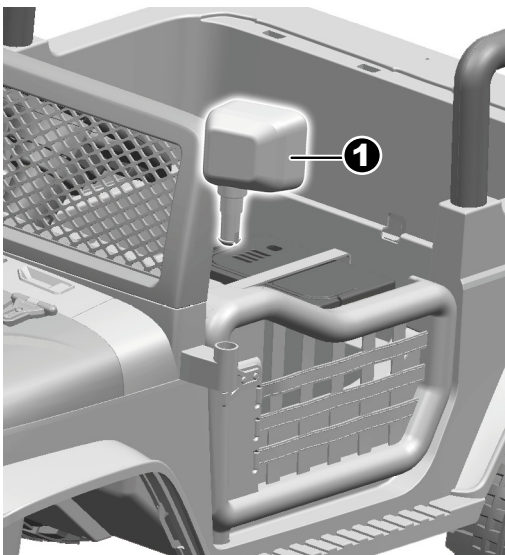

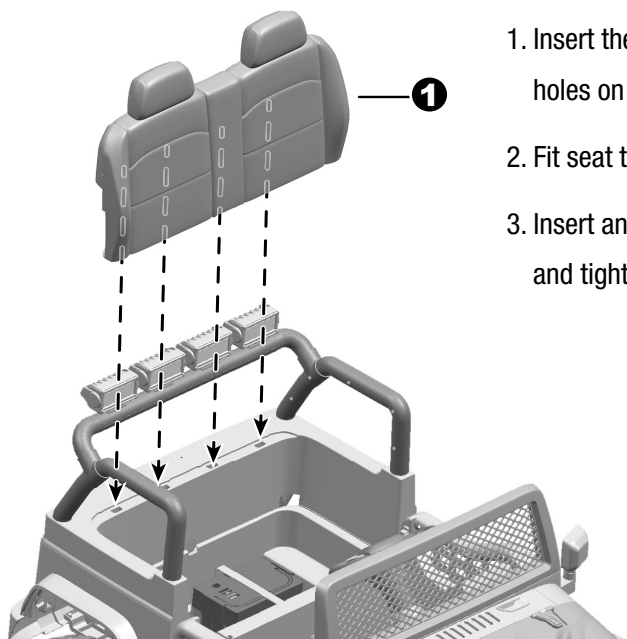

1. Insert the tabs on seat back into the holes on the vehicle body.
2. Fit seat to the vehicle body.
3. Insert and tighten two $\varnothing 4 \times 12$ screws and tighten with a screwdriver.

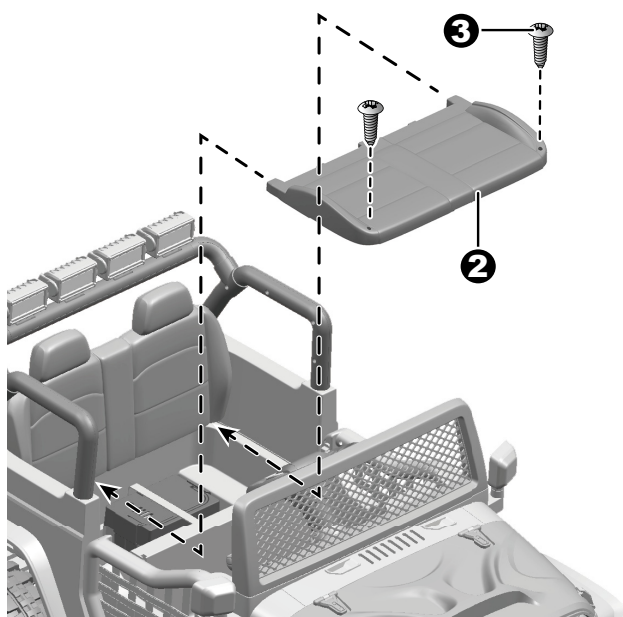



IMPORTANT!

Always stop vehicle when changing the speed or direction to avoid damage the gears and motor.

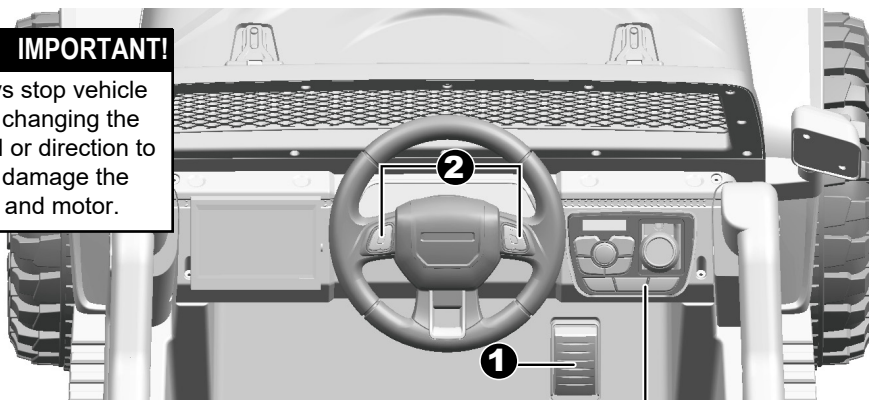

1. **Foot pedal:**
 - To move the vehicle, press the pedal down.
 - To brake or slow down, release pressure from the pedal.

2. **Horn button:** Press for horn playing.

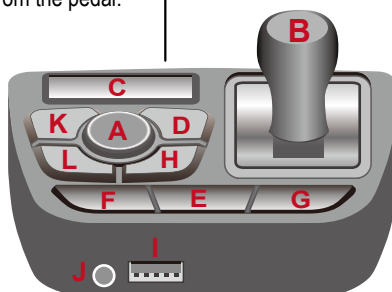

- A. **Power Switch:** Press it to power on the vehicle, long press it for 3 seconds to power off.

B. Forward/Reverse switch:

Changes the direction that vehicle moves from forward to reverse. The vehicle equipped with 2 speeds in forward: high speed / low speed.

- C. **Display screen:** It displays the power level of the battery when the vehicle stops. When the numerical value is less than 12, recharge the battery please.

- D: **Lights button:** Turns the lights on and off.

E: Play / Pause

F. Previous / decrease volume

G. Next / Increase volume

H. Rocking mode

- I. **USB interface:** Allow the audio from your portable device to be played through the vehicle speakers. MP3 format ONLY.

- J. **3.5mm AUX input:** Allow the audio from your portable music player or phone to be played through the vehicle speakers. MP3 format ONLY.

K. Music mode

L. Change the audio input from the FM radio, USB, AUX input or Bluetooth

Under the FM radio mode, long press button E (play/pause) for radio searching. When your phone connected to the product with bluetooth, the product could answer the call through the microphone inside the dash.

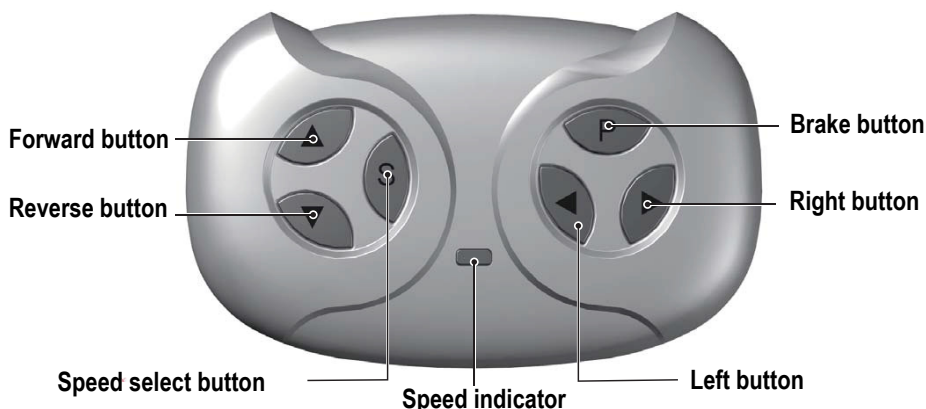

Attach the batteries of controller

Lift the battery compartment door on the back of the controller and insert two AAA(LR03) batteries.

HINT: Batteries not included. Refer to the Battery Information on the page 1.

1. Build connection

Long press the forward and reverse buttons for 3 seconds, and the speed indicator flashes. Then power on the vehicle, the speed indicator goes to long bright, means the connection successful. If the speed indicator no response, means the connection failed. Replace the batteries and retry.

2. Brake button

Press the button to stop the vehicle, press it again to release the brake.

3. Speed select button

The switch operates the vehicle to move in low, normal or high speed.

HINT: This switch won't work while your vehicle moves reverse.

NOTE:

- Leave the remote controller idling for about 10 seconds, it will shut down automatically.
- Rebuild connection when you replace the batteries of the remote controller.

**WARNING!**

ONLY AN ADULT CAN CHARGE AND RECHARGE THE BATTERY!

**WARNING!**

This product with **Charging Protection**: when charging, all functions will be cut off! Only an adult can charge and recharge the battery!

- The POWER SWITCH must be turned in **OFF** position when charging.
- Before the first use, you should charge the battery for 4-6 hours. Do not recharge the battery for more than 10 hours to avoid overheating the charger.
- When the vehicle begins to run slowly, recharge the battery.
- After each use or once a month minimum recharge time as 8 to 12 hours, less than 20 hours at most.
- Use the only rechargeable battery and charger supplied with your vehicle. NEVER substitute the battery or the charger with another brand. Using another battery or charger may cause a fire or explosion.
- Do not use the battery or charger for any other product.

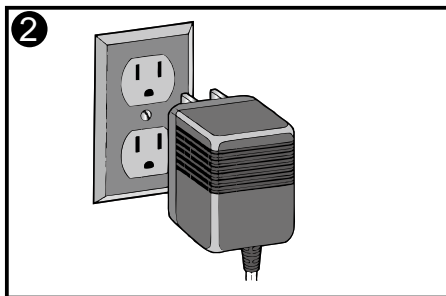
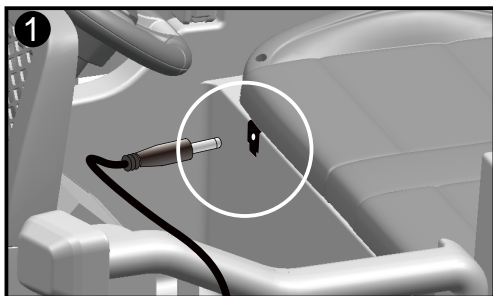

1. Plug the charger port into the input socket. (below the seat)
2. Plug the charger plug into a wall outlet. The battery will begin charging.

Problem	Possible Cause	Solution
Vehicle does not run	Battery low on power	Recharge battery.
	Thermal fuse has tripped	Reset fuse, see <Fuse>
	Battery connector or wires are loose	Check that the battery connectors are firmly plugged into each other. If wires are loose around the motor contact your distributor please.
	Battery is dead	Replace battery, contact your distributor please.
	Electrical system is damaged	Contact your distributor please.
	Motor is damaged	Contact your distributor please.
Vehicle does not run very long	Battery is under charged	Check that the battery connectors are firmly plugged into each other when recharging
	Battery is old	Replace battery, contact your distributor please.
Vehicle runs sluggishly	Battery low on power	Recharge battery, contact your distributor please.
	Battery is old	Replace battery, contact your distributor please.
	Vehicle is overload	Reduce weight on vehicle.
	Vehicle is being used in harsh conditions	Avoid using vehicle in harsh conditions ,see <Safety>.
Vehicle needs a push to go forward	Poor contact of wires or Connectors	Check that the battery connectors are firmly plugged into each other. If wires are loose around the motor, contact your distributor please.
	"Dead Spot" on motor	A dead spot means the electric power is not being delivered to the terminal connection and the vehicle needs repair. Contact your distributor please.
Difficult shifting from forward to reverse or vice-versa	Attempting to shift while the vehicle is motion	Completely stop the vehicle and shift, see <Use Your New Vehicle>
Loud grinding or clicking noises coming from motor or gear box	Motor or gears are damaged	Contact your distributor please.
Battery will not recharge	Battery connector or adapter connector is loose	Check that the battery connectors are firmly plugged into each other.
	Charger not plugged in	Check that the battery charger is plugged into a working wall outlet.
	Charger is not working	Contact your distributor please.
Charger feels warm when recharging	This is normal and not a cause for concern	

Completely read through this manual and the troubleshooting guide table before calling. If you still need help resolving the problem **Contact your distributor please.**

- It is parents' responsibility to check main parts of the toy before using, must regularly examine for potential hazard, such as the battery, charge, cable or cord, plug, screws are fastening enclosure of other parts and that in the event of such damage, the toy must not be used until that damage had been properly removed.
- Make sure the plastic parts of the vehicle are not cracked or broken.
- Occasionally use a lightweight oil to lubricate moving parts such as wheels.
- Park the vehicle indoors or cover it with a tarp to protect it from wet weather.
- Keep the vehicle away from sources of heat, such as stoves and heaters. Plastic parts may melt.
- Recharge the battery after each use. Only an adult can handle the battery. Recharge the battery at least once a month when the vehicle Raider is not being used.
- Do not wash the vehicle with a hose. Do not wash the vehicle with soap and water. Do not drive the vehicle in rainy or snowy weather. Water will damage the motor, electric system and battery.
- Clean the vehicle with a soft, dry cloth. To restore shine to plastic parts, use a non-wax furniture polish. Do not use car wax. Do not use abrasive cleaners.
- Do not drive the vehicle in loose dirt, sand or fine gravel which could damage the moving parts, motors or the electric system.
- When not using, all the electrical source should be turn off. Turn off the power switch and disconnect the battery connection.

The battery features a thermal fuse with a reset fuse that will automatically trip and cut all power to the vehicle if the motor, electric system or battery is overloaded. The fuse will reset and power will be restored after the unit is turned OFF for 20 seconds and then turned ON again. If the thermal fuse trips repeatedly during normal use, the vehicle may need repair. **Contact your distributor please.**

To avoid losing power, follow these guidelines:

- Do not overload the vehicle.
- Do not tow anything behind the vehicle.
- Do not drive up steep slopes.
- Do not drive into fixed objects, which may cause the wheels to spin, causing the motor to overheat.
- Do not drive in very hot weather, components may overheat.
- Do not allow water or other liquids to come in contact with the battery or other electric components.
- Do not tamper with the electric system. Doing so may create a short, causing the fuse to trip.

Disposal Of Battery



- Your sealed lead-acid battery must be recycled or disposed of in an environmentally sound manner.
- Do not dispose of your lead-acid battery in a fire. The battery may explode or leak.
- Do not dispose of a lead-acid battery in your regular, household trash. The incineration, land filling or mixing of sealed lead-acid batteries with household trash is prohibited by law.

Our products are suitable for ASTM F963; GB6675; EN71 and EN62115 standard.