

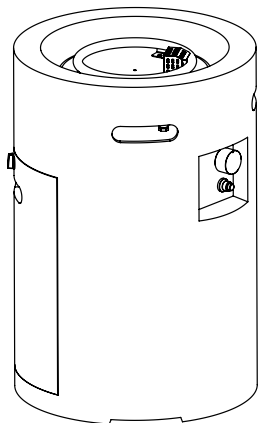

USE AND CARE GUIDE

26" Round Concrete Propane Gas Fire Column

Item#
Model# FP20306



INSTALLER:

Leave this manual with the appliance.

CONSUMER:

Retain this manual for future reference.

WARNING

Do not store or use gasoline or other flammable vapors and liquids, in the vicinity of this or any other appliance.

An LP-cylinder not connected for use shall not be stored in the vicinity of this or any other appliance.

DANGER

FIRE OR EXPLOSION HAZARD

If you smell gas:

- 1.Shut off gas to the appliance.
- 2.Extinguish any open flame.
- 3.If odor continues, leave the area immediately.
- 4.After leaving the area, call your gas supplier or fire department.

Failure to follow these instructions could result in fire or explosion, which could cause property damage, personal injury, or death.

WARNING

When Fire Pit is not in use—disconnect Propane Tank.

If Fire Pit is stored indoors—remove Propane Tank.

WARNING

This Fire Pit must be attended at all times!

WARNING

USE PROPANE GAS ONLY.

For use with tanks marked propane only. DO NOT connect to a remote gas supply. Propane Tanks sold separately.

WARNING

FOR OUTDOOR USE ONLY!

Installation and service must be performed by a qualified installer, service agency, or the gas supplier.

WARNING

If the information in this manual is not followed exactly, a fire or explosion may result causing property damage, personal injury, or loss of life.

DANGER

CARBON MONOXIDE HAZARD

This appliance can produce carbon monoxide which has no odor. Using it in an enclosed space can kill you.

Never use this appliance in an enclosed space such as camper, tent, car or home.



DANGERS AND WARNINGS



WARNING

Read and follow all instructions and warnings in this Owner's Manual thoroughly before installing, operating, or servicing this fire column.

Improper installation, use, maintenance, adjustment or storage can cause fire or explosion, resulting in serious injury or property damage.

prepare for use:

Keep away from Combustible/Flammable Items

- Do not put any other fireplace cover or anything flammable on or beneath fire column.
- Combustible materials should never be within 1.83 m/6 ft of the top, 1.22 m/4 ft of back or sides of fire column.
- For use on noncombustible floor material only.
- Keep fire column area clear and free from combustible materials, gasoline, and other flammable vapors and liquids.

Inspect for leaks, wear and damage

- Check for gas leaks before use - See page 7, Step #8 for instructions on how to check for gas leaks.
- Inspect burner and hose before use - Replace if there is evidence of excessive abrasion, wear, or damage.
- Inspect hose before each use. Hose assembly must be replaced prior to use if there is evidence of excessive abrasion or wear or if hose is damaged. Use a manufacturer-specified replacement hose only.

Prepare area, ensure proper use of Fire Column Cover

- Make sure ventilation openings on sides of fire column (BODY) are open and clear of debris.
- Do not lay nylon cover over fire column for at least 4 hours after it is turned OFF and has completely cooled down.
- Do not use fire column if any part has been under water. Immediately call a qualified service technician to inspect fire column and to replace any part of the control system and any gas control that has been under water.
- Remove nylon cover from fire column before operating.

when in use:

Do's

- Use propane cylinders with the following required measurements only: 30.5 cm/12 in (diameter) x 45.7 cm/18 in (tall) with capacity 9 kg/19.84 lbs.)
- If flame goes out while operating, turn gas valve OFF. Wait five minutes before attempting to relight.
- Due to high surface temperatures always keep a safe distance to avoid burning or clothes catching fire.
- Keep fuel supply hose away from any heated surfaces.

Don't's

- Never lean over the open fire column or place hands or fingers on the upper portion while in use.
- Do not use fire column for cooking.
- Do not burn any other materials other than what is supplied with and intended for use in fire column .
- Solid fuels shall not be burned in this fire column.
- Do not pour water into fire column .
- Do not move fire column while in operation.
- Fire pit should never be operated by children. Children must be supervised when they are anywhere near fire column .
- Do not rest feet on fire column
- Do not use fire column on vehicles or boats. Always operate fire column on flat ground outdoors.

When not in use:

- The cylinder must be disconnected when the fire column is not in use.
- Remove Battery from ignitor when not using fire column for an extended length of time.
- Clean battery contacts and also those of the device prior to battery installation.

DANGERS AND WARNINGS

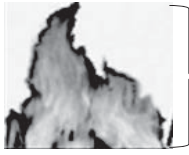

2 inches to
10 inches.

Observe flame color and flame height when the fire column after being lit :

- 1.) Flame color should be yellow.
- 2.) Flame height burns at 2 - 10 inches high.

THIS PRODUCT USES PROPANE ONLY

- Use propane cylinders with the following required measurements only: 30.5 cm/12 in (diameter) x 45.7 cm/18 in (tall) with capacity 9 kg/19.84 lbs.)
- Max gas supply 28cm/11 in w.c. (2.74kpa)
- Only cylinder marked "propane" may be used.
- If you see, smell or hear the hiss of escaping gas from the propane cylinder:
 1. Turn off gas supply and get away from gas cylinder and fire column at once.
 2. Do not attempt to correct the problem yourself.
 3. Call your gas supplier and / or the fire department for help.
- A dented or rusty propane cylinder may be hazardous and should be cleared by your gas supplier prior to use.
- Do not attempt to disconnect gas regulator or any gas fitting while fire column is in operation.
- The gas pressure regulator provided with fire column must be used.
- Do not use a propane cylinder with a damaged valve and any other worn out parts.
- Transport and store empty propane cylinders carefully and properly.

Children and adults should be alerted to the hazards of high surface temperatures and should stay away to avoid burns or clothes catching fire.

- Young children should be carefully supervised when they are in the area of fire column.
- Clothing or other flammable materials should not be hung from fire column or placed on or near fire column.

Propane-gas supply cylinder to be used must be:

- constructed and marked in accordance with the U.S. Department of Transportation (DOT) Specifications for LP-Gas Cylinders , or the *Standard for Cylinders, Spheres and Tubes for Transportation of Dangerous Goods and Commission, CAN/CSA-B339*, as applicable;
- provided with a listed overfilling prevention device.
- provided with a cylinder connection device compatible with the connection for the appliance.

when storing fire column:

Storage of fire column indoors is permissible only if the cylinder is disconnected and removed from fire column. Cylinders must be stored outdoors in a well-ventilated area out of reach of children. Disconnected cylinders must have threaded valve plugs tightly installed and must not be stored in a building, garage or any other enclosed area.

Turn OFF control knob and close propane cylinder valve. Turn coupling nut counterclockwise by hand only—do not use tools to disconnect. Loosen cylinder screw beneath bottom shelf, then lift propane cylinder up and out of shelf. Place dust cap on cylinder valve outlet whenever the cylinder is not in use.

WARNING! *Improper installation, adjustment, alteration, service or maintenance can cause injury or property damage. Refer to the owner's information manual provided with this appliance. For assistance or additional information consult a qualified installer, service agency or the gas supplier.*

The Propane-gas supply cylinder must be disconnected when this appliance is not in use.

Repairs should be done by a qualified service person. Fire column should be inspected before use and at least annually by a qualified service person.

More frequent cleaning may be required as necessary. It is imperative that the control compartment, burners, and circulating air passageways of the appliance are kept clean.

Any guard or other protective device removed for servicing the appliance shall be replaced prior to operating the appliance.

Installation and repair should be done by a qualified service person. The appliance should be inspected before use and at least annually by a qualified service person. More frequent cleaning may be required as necessary. It is imperative that the control compartment, burners, and circulating air passageways of the appliance are kept clean.

Any guard or other protective device removed for servicing the appliance shall be replaced prior to operating the appliance

FOR YOUR SAFETY: Surfaces of fire pit can remain extremely hot for a period after use. Allow 45 minutes to cool down before touching or moving the fire pit

PREPARATION FOR ASSEMBLY

Before beginning assembly of fire column, make sure all parts are present.

Compare parts with package contents list. If any part is missing or damaged, do not attempt to assemble fire column.

Estimated Assembly Time: 25 minutes

NOTE: You must follow all steps to properly assemble fire column. Make sure the gas valve is turned OFF before assembling. Do not attempt to assemble without proper tools.

PACKAGE CONTENTS AND COMPONENTS

PART	DESCRIPTION	QTY
A	Fire Plate	1
B	Fire Pit Body	1
C	Door	1
D	Burner (preassembled)	1
E	Guard(preassembled)	1
F	Lava Rock	5.5 lbs
G	AAA Battery	1
H	PVC Cover	1
I	Adjustable feet (preassembled)	4
J	Control Knob (preassembled)	1
K	Igniter (preassembled)	1
L	Regulator(preassembled)	1
M	Touch-Up Kit	1
N	Door Knob	1

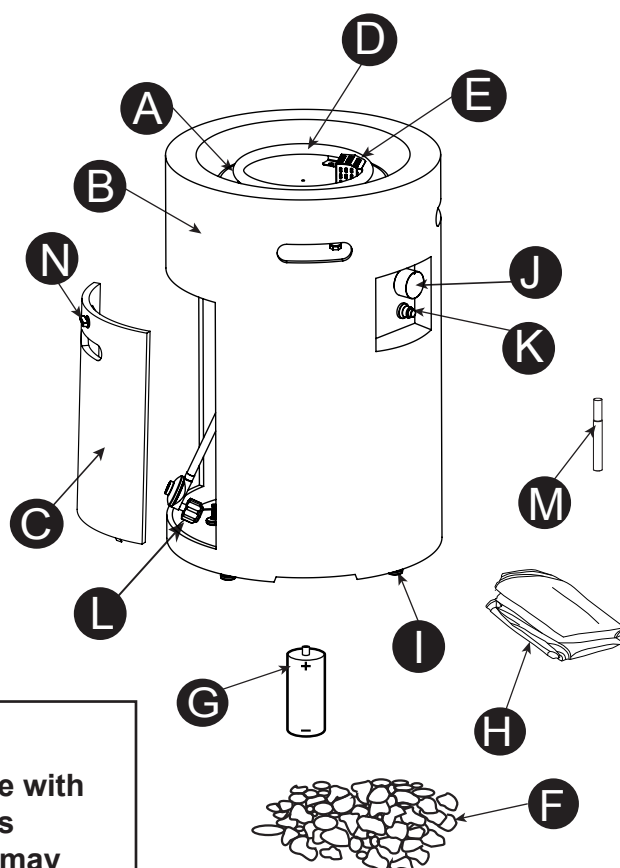

WARNING

Failure to position the parts in accordance with these diagrams or failure to use only parts specifically approved with this appliance may result in property damage or personal injury.

ASSEMBLY INSTRUCTIONS

1

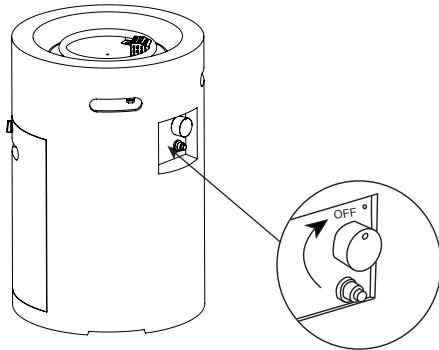

- 1** Make sure the gas supply system is turned to “OFF”.



WARNING

This fire column requires air flow under the unit. Do not place on uneven surface or on grass, turf or carpet.

2

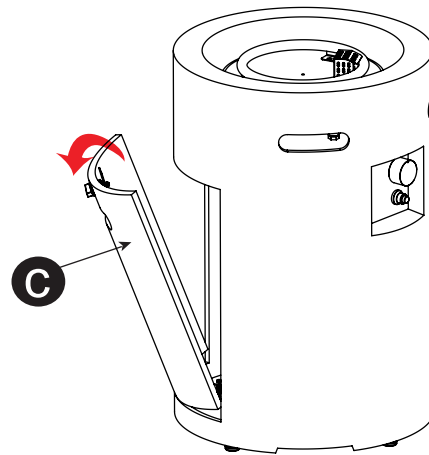

- 2** Turn door knob (N), Remove door (C) .

3

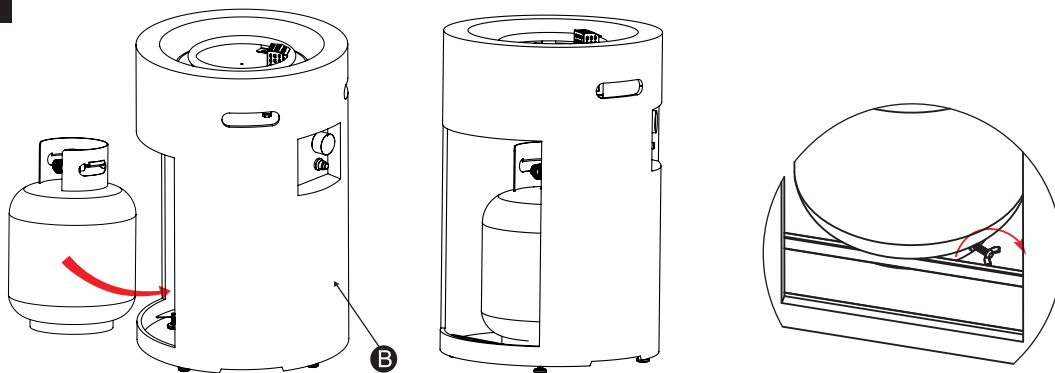

- 3** Place propane tank (not included) in the metal stand inside Body (B) and make sure the gas tank sits on the metal stand completely. Turn the wing screw on the outer part of metal stand clockwise to secure the gas tank tightly.

ASSEMBLY INSTRUCTIONS

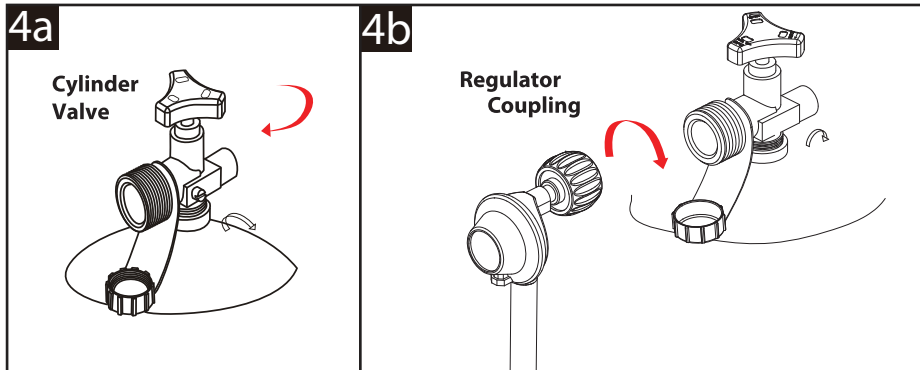

- 4** a) Turn cylinder valve on the top of propane tank clockwise to close off gas supply. See Figure 4a
 b) Screw regulator coupling clockwise by hand only. Make sure it is fastened. See Figure 4b

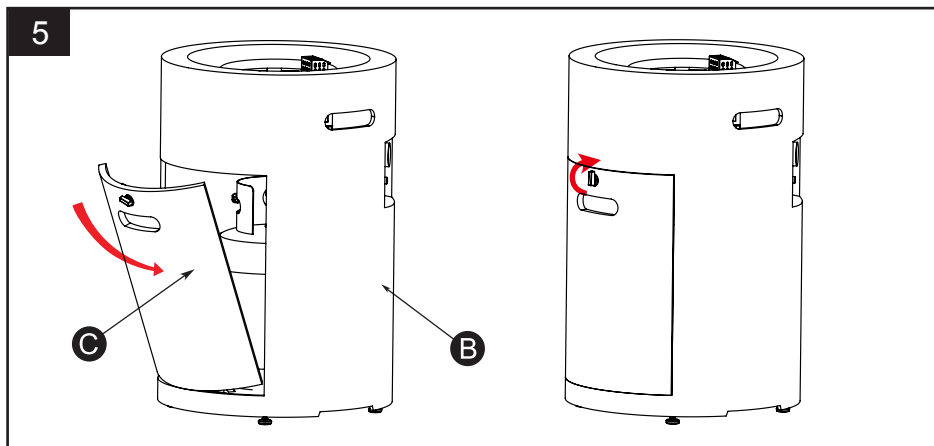

- 5** Replace Door (C) onto Body (B) and turn door knob to secure .

- 6** To install battery (G), unscrew rubber cap of electric igniter (K) and place battery (G) into the battery case. Make sure the positive pole ("+") faces out towards cap. Screw cap back to battery case tightly.

Hardware Used

H

AAA Battery
(included)



x 1

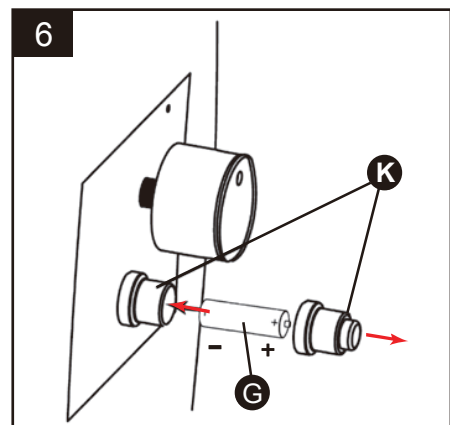

ASSEMBLY INSTRUCTIONS

- 7** a) Place Lava Rock(F) evenly in fire bowl.
 Use caution when handling lava rock as it is sharp. See Figure 7a
 b) Do not place any lava rock over the screen. See figure 7b
 c) Completely cover the entire burner ring with lava rock. See figure 7c

Failure to completely cover the burner ring with the lava rock will cause flame to extinguish occasionally.

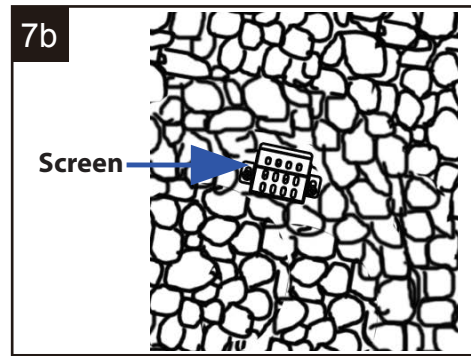
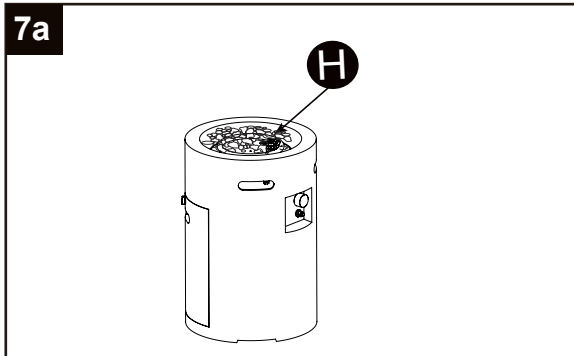

WARNING

keep lava rock and other objects off of screen (shown at left)

Holes in the screen must be exposed in order to allow gas to escape

Blocked screen can cause gas to build inside fire column and ultimately cause an explosion and risk of serious injury.

7c

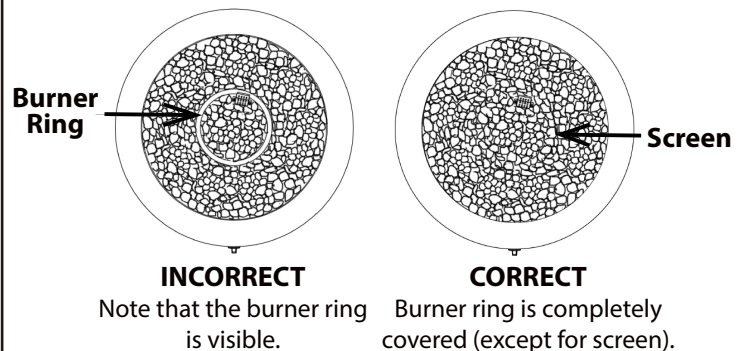

- 8** Before using fire column, check for gas leaks.
 Perform leak test in a well-ventilated area outside and where no source of spark can occur.

- a) After opening door for access, open tank valve fully (counter-clockwise).
 b) Turn control knob to the OFF position.
 c) Apply soapy water solution (3 drops dish detergent plus 4 oz. water) to check all connections for leaks before attempting to light fire column.
 d) Coat soapy water onto all connections (shown in figure at right, 1, 2, 3, 4, 5). See Figure 8.
 e) Turn control knob to the ON position. If there are any leaks, soapy water will bubble where leak is occurring.
 If a leak is found, turn tank valve off and do not use fire column until repairs are made.

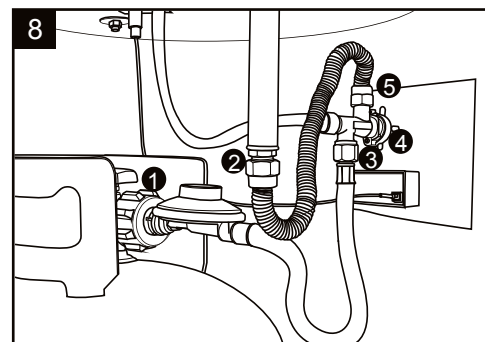

OPERATING INSTRUCTIONS

Before each use, Ensure to inspect hose. Replace hose if there are any signs of cutting, wear or abrasion.

WARNING! During initial lighting of the fire column, stay away from fire column for 30 minutes as lava rock may pop and cause injury to the face or eyes.

Caution: Only use pressure regulator and hose assembly supplied with fire column. Replacement pressure regulator and hose assemblies must be specified or supplied by manufacturer.

To Light

1. Turn cylinder valve on top of propane tank counterclockwise to open gas supply
2. To ignite Burner Ring: See Figure 9
 - a) press and hold Electric Igniter button (a).
 - b) at the same time, push in and turn Control Knob (b) counterclockwise to LOW position.
 - c) Keep the Control Knob (b) pushed in to light the Burner Ring.

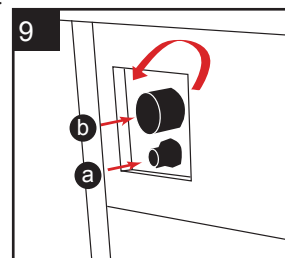

WARNING! If ignition does NOT immediately occur

- release Electric Igniter Button (a) and turn Control Knob to OFF (clockwise).
- WAIT 5 MINUTES to clear out the gas!
- repeat lighting instructions in Step 2 as above

3. After ignition, release Electric Igniter Button (a).

Continue to push and hold the Control Knob for 45 seconds.

Note: Flame should be yellow/blue color.

To Extinguish See Figure 10

1. Push and turn Control Knob clockwise to "OFF" position.
2. Turn cylinder valve on gas tank to close gas supply if not in use for a long time.

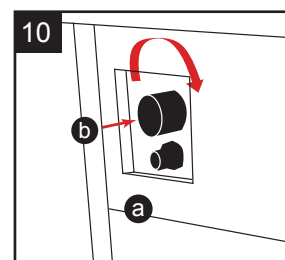

WARNING! Do not place lid or nylon cover on top of fire column for at least 4 hours after use and until fire pit has cooled.

CARE AND MAINTENANCE

- Store the fire column in a cool dry place away from direct sunlight.
- The propane tank must be disconnected and removed from the fire column before the fire column can be stored indoors.
- Make sure both the gas and the fire column are turned off before changing battery. Please refer to the process of installing the battery (Step 6).
- Use manufacturer approved or supplied replacement parts and accessories only. Use of unauthorized replacement parts may void the warranty.
- Keep fire column free and clear from combustible materials.
- Visually inspect burner ring for blockages (spider webs, dirt, etc.). Keep fire column free and clear from debris.
- After burner ring and lava rock are completely cooled down, use a soft brush to get rid of mild stains, loose dirt and soil. Wipe with a soft cloth.

WARRANTY

The manufacturer's warranty will be voided by, and manufacturer disclaims any responsibility for following actions:

- Modification of the fire bowl and/or components including the gas valve assembly.
- Use of any component part not manufactured or approved by manufacturer.
- Use and installation other than as instructed in this manual.



WARNING: FUELS USED IN LIQUEFIED PROPANE GAS APPLIANCES ,AND THE PRODUCTS OF COMBUSTION OF SUCH FUELS,CAN EXPOSE YOU TO CHEMICALS INCLUDING BENZENE,WHICH IS KNOWN TO THE STATE OF CALIFORNIA TO CAUSE CANCER AND CAUSE BIRTH DEFECTS OR OTHER REPRODUCTIVE HARM For more information go to :www.P65Warnings.ca.gov

ADVERTENCIA: LOS COMBUSTIBLES USADOS EN EQUIPOS PARA LICUAR GAS PROPANO, ASÍ COMO LOS PRODUCTOS DE SU COMBUSTION, PUEDEN EXPONERTE A SUSTANCIAS QUÍMICAS, ENTRE ELLAS EL BENCENO, QUE EL ESTADO DE CALIFORNIA RECONOCE COMO CAUSA DE CANCER Y DE MALFORMACIONES CONGENITAS Y OTROS DANOS AL SISTEMA REPRODUCTOR Para mas informacion, visite www.P65Warnings.ca.gov

TROUBLESHOOTING

Problem		Cause	Solution
No spark between ignition wire and burner's hole while pushing the igniter button.	No power in igniter	No Igniter battery or igniter battery short of power	Replace with new igniter battery
		Igniter battery is incorrectly inserted	Reinsert the battery properly
		Igniter broken or cracked	Call the customer service for replacement part
	The ignition wire didn't conduct electricity	Ignition wire is loose or disconnected to igniter	Reinsert the ignition wire
		Electricity leakage in ignition wire or the needle of ignition wire can not aim at the hole of burner while lighting	Call the customer service for replacement part
No or Short of gas	The switch of gas cylinder was not switch on	Not switch on the valve of gas cylinder	Switch on the valve of gas cylinder
	Improperly connect between regulator and gas cylinder	Regulator is loose or disconnected to gas cylinder	Check and reconnect the regulator to gas cylinder
	No gas in gas cylinder	No or short of gas	Check if the gas cylinder is empty ,if yes, replace it
	Excess flow safety valve has been activated	Switch on the gas cylinder when the balance gas still existed in hose cause excess flow safety valve activated	Turn the control knob to "OFF", Switch off the valve of gas cylinder and disconnect the regulator from the valve of gas cylinder. Turn the control knob to "LOW", Wait 30 seconds, Turn the control to "OFF", Reconnect the regulator to the gas cylinder. Light the appliance as indicated in the "To Light" section of manual
		Obvious gas leakage in gas system cause excess flow safety valve activated	Check the gas system to see if gas leakage, if yes, Call the customer service for help.
	Bends or kinks in regulator	Regulator was bends or kinks cause the poor fluent gas inside of hose	Straighten hose of all bends or kinks
Flame blow out	No or short of gas	See "No or Short of gas" above	See "No or Short of gas" above
	High or gusting winds	Flame was blow out by high or gusting winds	Remove the appliance to the place without high or gusting winds
	Loose connected in thermocouple	Loose connected between thermocouple and valve	Call the customer service for help
	Inside guard blocked by media	Media fall into inside guard cause block the entrance of oxygen	Open and clean the guard
		Media fall into inside guard and cover the flame in burner hole which also cause the low temperature while conduction	
	Guard covered by media	Guard cover by media cause the inproperly burning inside hole of guard	Remove the media from the guard as indicated in manual
	Too much carbon deposition inside guard	The carbon deposition will occur since the gas can not sufficient burning when using the appliance	Open the top of guard by using pincer and clean the carbon deposited in guard, thermocouple, ignition wire, burner. lastly recover the top of guard .