

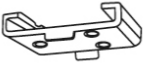



# Installation Instructions for Cordless Mini Blind

## TOOLS NEEDED

- Metal Tape Measure
- Pencil
- Step Stool or Step Ladder
- Phillips Head Screw Driver
- Drill and 1/8" Drill Bit
- Level

## HARDWARE CONTENTS

- Mounting Screws 
- Spacers for Inside or Ceiling Mount 
- Mounting Brackets 
- Wand 
- Tilter 

## HOW TO MEASURE

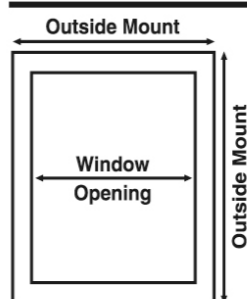

### Outside Window Frame:

Measure window width, including frame. Measure window opening. Blind should overlap window opening 2" or more. Attach bracket to window frame or wall.

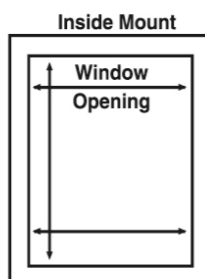

### Inside Window Frame:

Accurately measure the width of your window opening. Select size that is nearest to this dimension.

## HOW TO INSTALL BLIND—For Best results mount on window frame or wall.

### Outside Window Frame or On Wall:

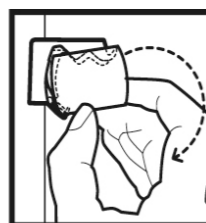
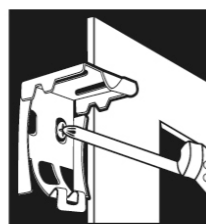
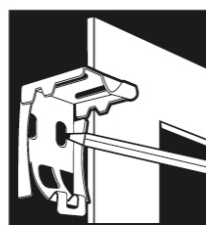
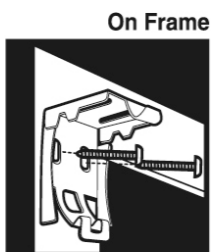
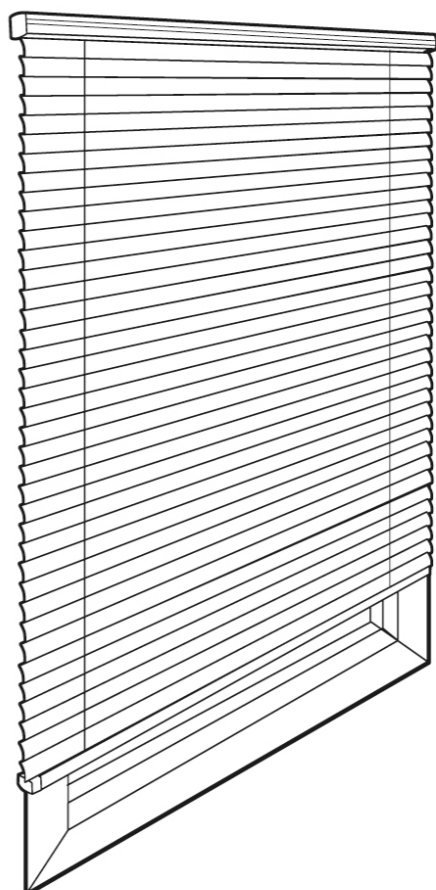

- 1) Pencil mark the mounting screw holes at the back or top of the bracket.
  - Pre-drill holes for mounting screws.
  - Use level at top of brackets to ensure straight alignment.
- 2) Attach the brackets with the mounting screws provided and tighten the screws in place.
  - For wider widths and added support, install the center support bracket when provided. Install at approximate center of the headrail.
  - When mounting brackets on wall board or plaster, use the plastic screw plugs provided.
- 3) Insert the top front of the head rail into the front lip of the brackets. Push the rail into place.
- 4) **See page 2 for important safety device installation as well as Wand and Tilter installation.**

## HOW TO INSTALL BLIND (Continued)

### Inside Window Frame Or On Ceiling:

When installing inside the window frame, 1 1/2" depth minimum is required.

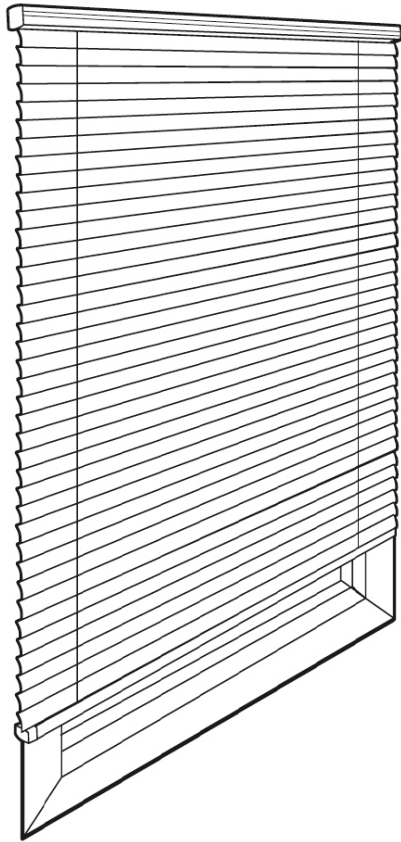

Inside Window Frame

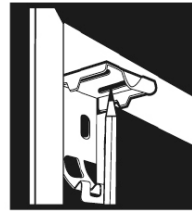
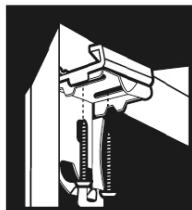

- 1) Pencil mark the mounting screw holes at the back or top of the bracket.

- Pre-drill holes for mounting screws.

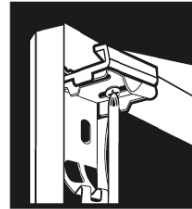

- 2) Attach the brackets with the mounting screws provided and tighten the screws in place.

- For wider widths and added support, install the center support bracket when provided. Install at approximate center of the headrail.

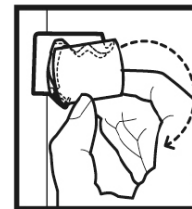

- 3) Insert the top front of the head rail into the front lip of the brackets. Push the rail into place.

- 4) **Follow important safety device installation below before operating your mini blind.**

## ATTACH THE TILTER AND CONTROL WAND

1. Insert the Tilter into the tilt control mechanism in the headrail assembly by aligning and pushing into the unit until it clicks and locks into place.
2. Place the hook at top of Tilter Control Wand through the hang hole in the Tilter.
3. Rotate the tilter control wand clockwise or counterclockwise to open or close the blind slats.

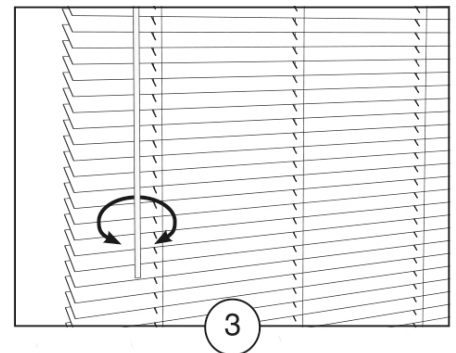
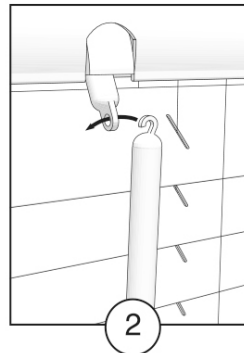
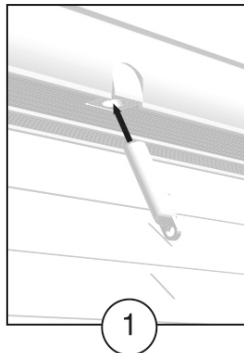

## OPERATION

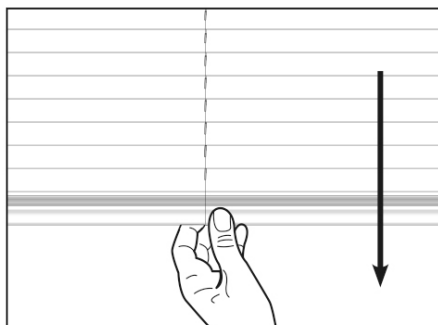

To lower the blind pull down from the bottom to the desired position and release.

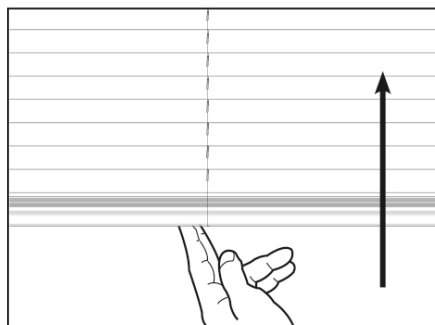

To raise the blind push up from the bottom to the desired position and release.