

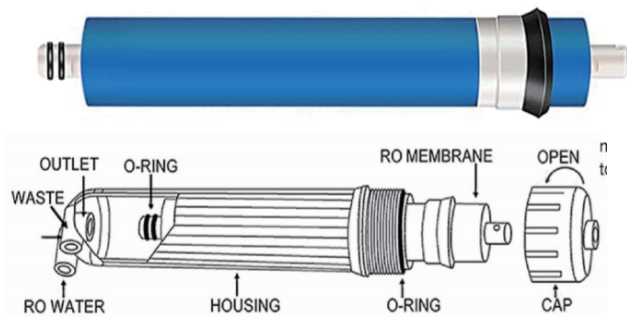

How to change the stage 1-3 pre-filters:

1. Shut off the cold water supply valve and tank valve, and open the RO faucet to depressurize the system. Place a bucket or towel under the system to catch any water spills.
2. If there is enough room under the sink and the filter system is hung on the wall, you can twist the filter housing off without removing the system from the wall. Otherwise, you will need to pull the system out, lay it down, and remove the housings at that point. Be careful with the tubing connections when removing the system.
3. Twist off the filter housings in a counter-clockwise direction using the filter housing wrench.
4. Place the new filters inside the housings. Make sure the O-Rings are in their proper locations, and tighten the filter housings back on. Remember not to over tighten them or they will be hard to unscrew next time.

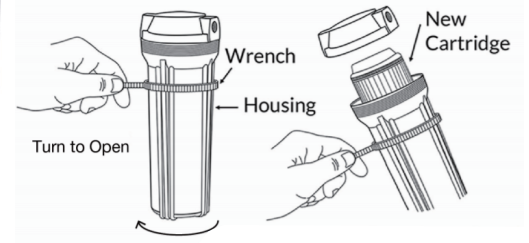

How to Change the Reverse Osmosis Membrane:

1. The RO membrane typically lasts about 2 - 3 years. The membrane life span depends on the source water quality, your water usage, and how often the three pre-filters are replaced. To ensure the system's performance and water purity, it is important to replace the pre-filter cartridges on schedule. Use a TDS meter to periodically check the RO water purity.
2. Shut off the cold water supply valve and tank valve, and open the RO faucet to depressurize the system. Place a bucket or towel under the system to catch any water spills.
3. Remove the tubing from the quick-connect fitting on the membrane housing cap. Use the membrane housing wrench to twist off the housing cap in a counter-clockwise direction.

4. Pull out the old membrane. Use scissors or pliers to apply leverage if necessary.
5. Clean the membrane housing using hot water and scent-free dish soap (optional). Rinse thoroughly.
6. Cut open the small end of the vacuum sealed packaging containing the new RO membrane. Hold the new membrane through the packaging, and insert it into the housing without touching the membrane with your bare hands to avoid contamination of the membrane.
7. Make sure the O-ring is properly seated on the end of the membrane housing as shown in the previous images. We recommend replacing the O-ring every 3 years to prevent leaking due to an expired or dried out O-ring.
8. Place the membrane housing cap back on and hand tighten it, then use the housing wrench to tighten it another 1/4-1/2 of a turn. Do not over tighten.

How to Change Inline Cartridges in 5th-7th Stages:

1. Please note that the 5th - 7th stages (model specific) have directions and each end may have a different kind of fitting.
2. For cartridges that connect with Quick-Connect fittings, simply press down on the lock sleeve from the cartridge to remove the fittings. Unwrap a new cartridge, follow the arrow sign on the cartridge label to push in the correct fitting on each end, and reconnect the tubing.



HOW TO CONNECT

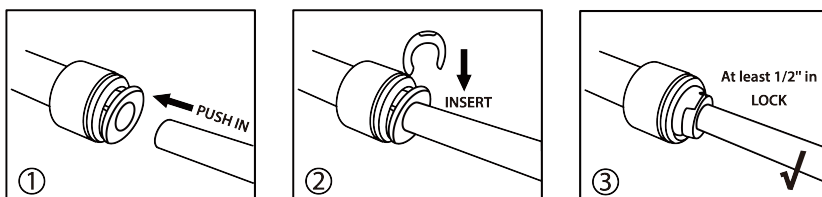

HOW TO DISCONNECT

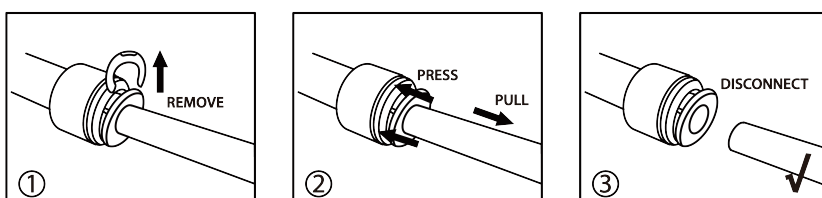

Please check out our YouTube channel for more installation videos and tips.

@ispringwater

iSpring Water Systems

iSpring Water Systems

