

(MH-BS-901A)



ASSEMBLY INSTRUCTIONS

Do not throw away the packaging material until the assembly is complete.

To protect the product, assemble this item on a soft surface such as a cardboard or a carpet.

While assembling the product, first tighten the allen bolts up to 50%. Once all parts are in place, only then fully tighten the allenbolts!

CARE INSTRUCTIONS

Wipe only with a soft & dry cloth.

To protect product, avoid the use of chemicals and household cleaners.

Any liquid spilled on the product should be cleaned up immediately with a damp cloth.

PRODUCT PARTS

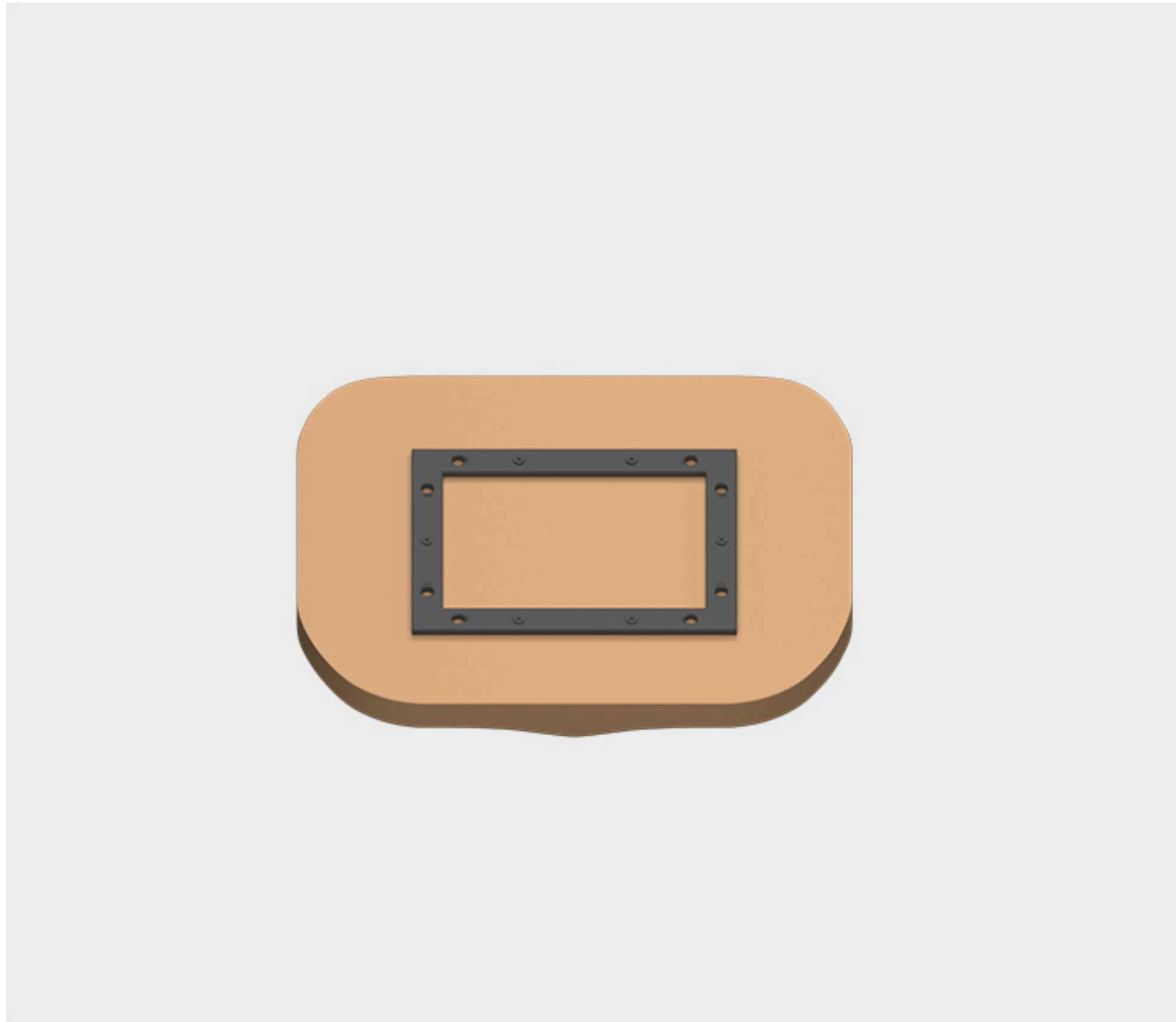

A
Wooden Top



B
Metal Legs

HARDWARE PROVIDED

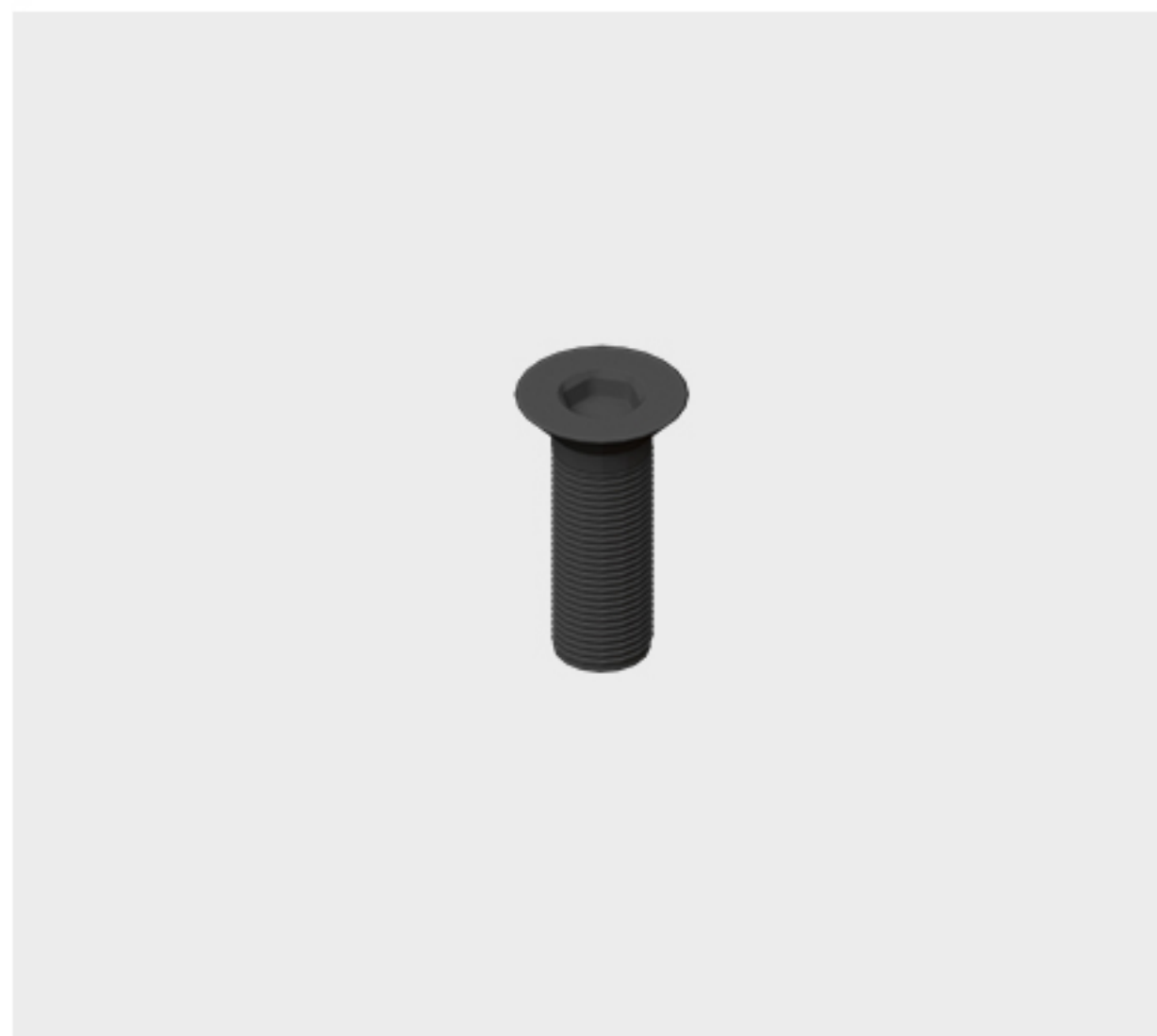

C
Allen Bolt
8x



D
Allen-Key
1x

STEP 1

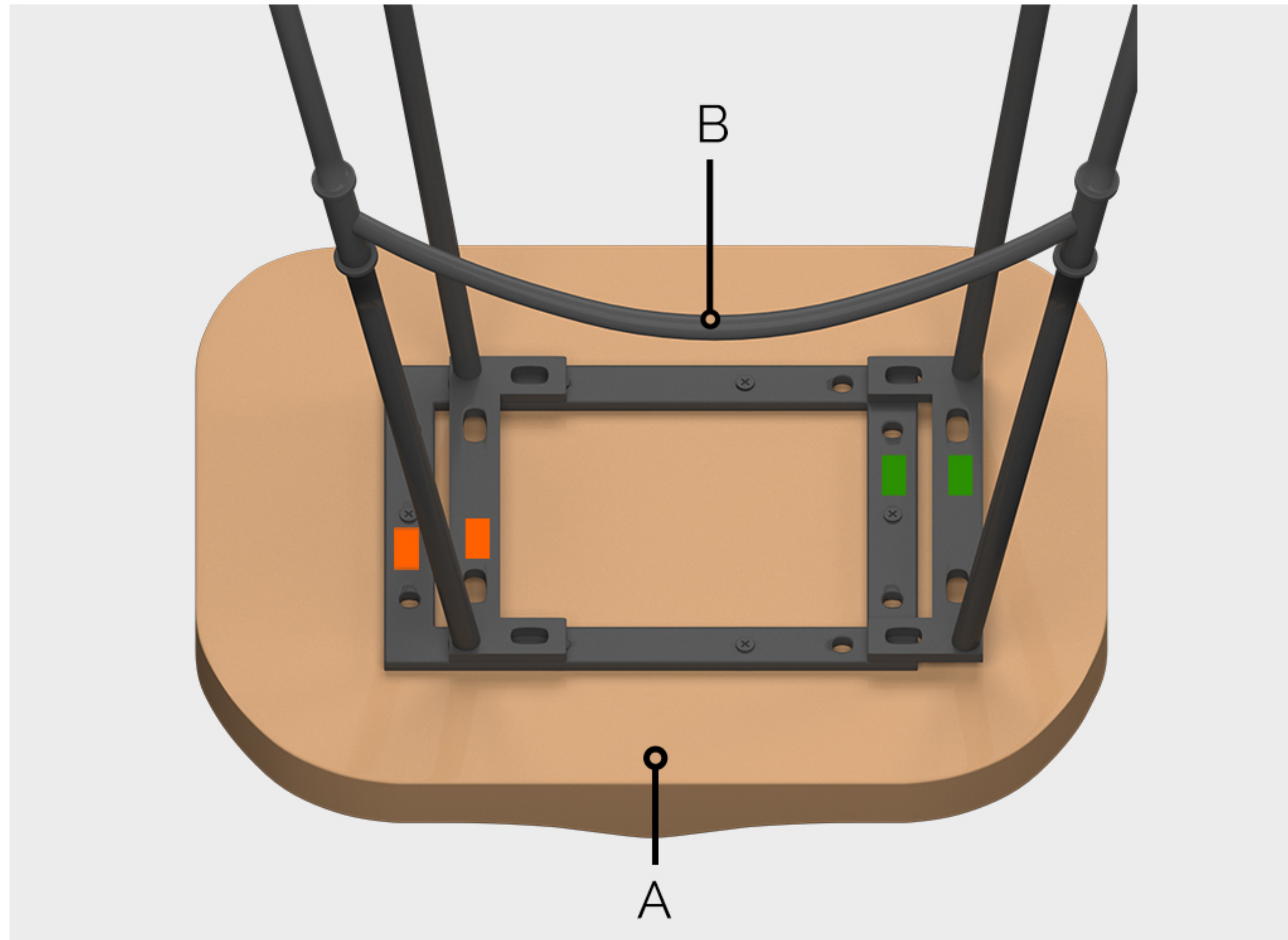

Turn the wooden top (A) of the stool upside down.
Put the metal legs (B) of the stool on top of the wooden top.

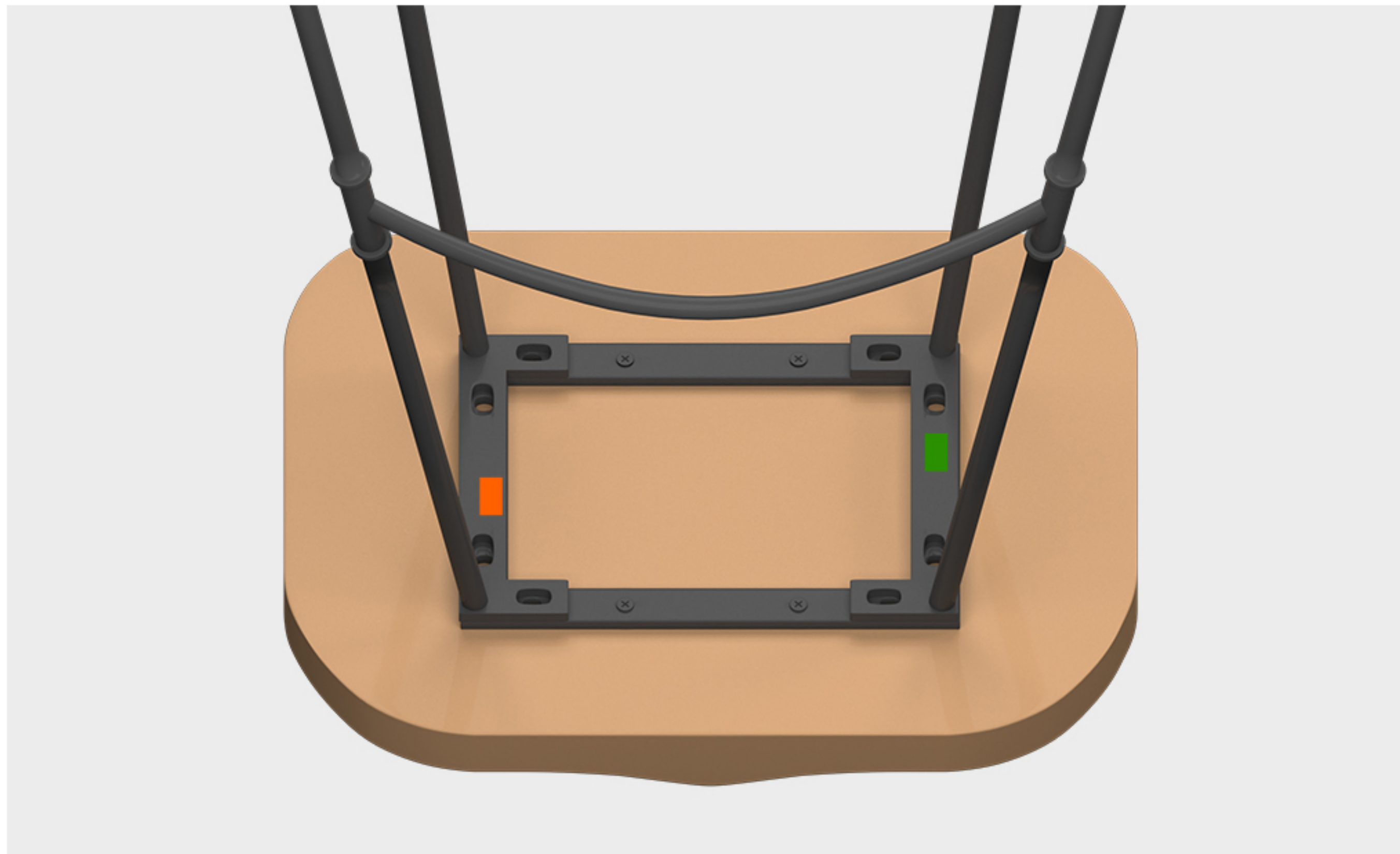

Align the metal legs (B) on the wooden top (A) in such a way
that the orange and green stickers align with their respective
others.

STEP 2

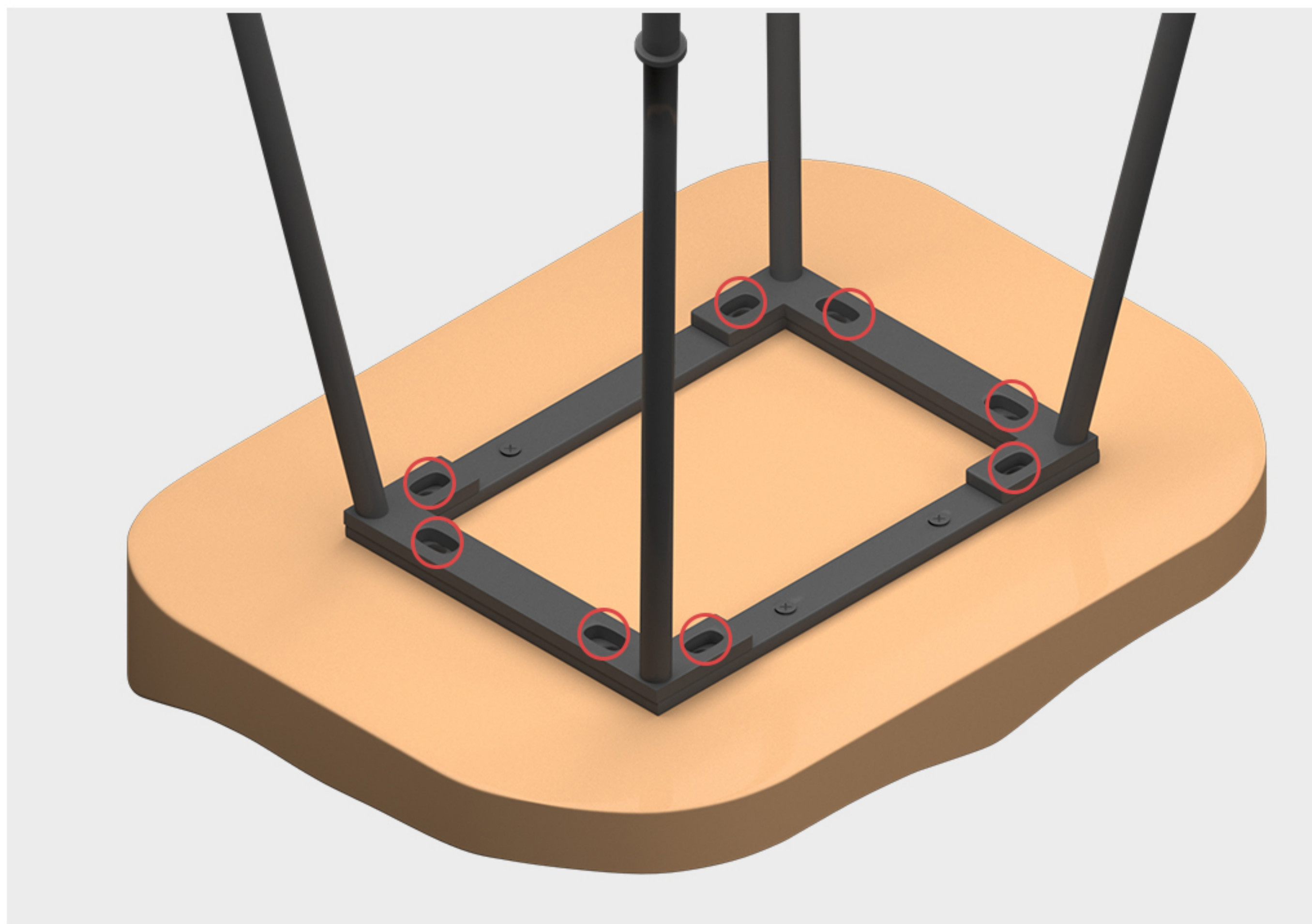

See the highlighted red circles to know where to tighten Allen Bolts (C).

Note - While assembling the product, first tighten the allen bolts up to 50%. Once all parts are in place, only then fully tighten the allen bolts!

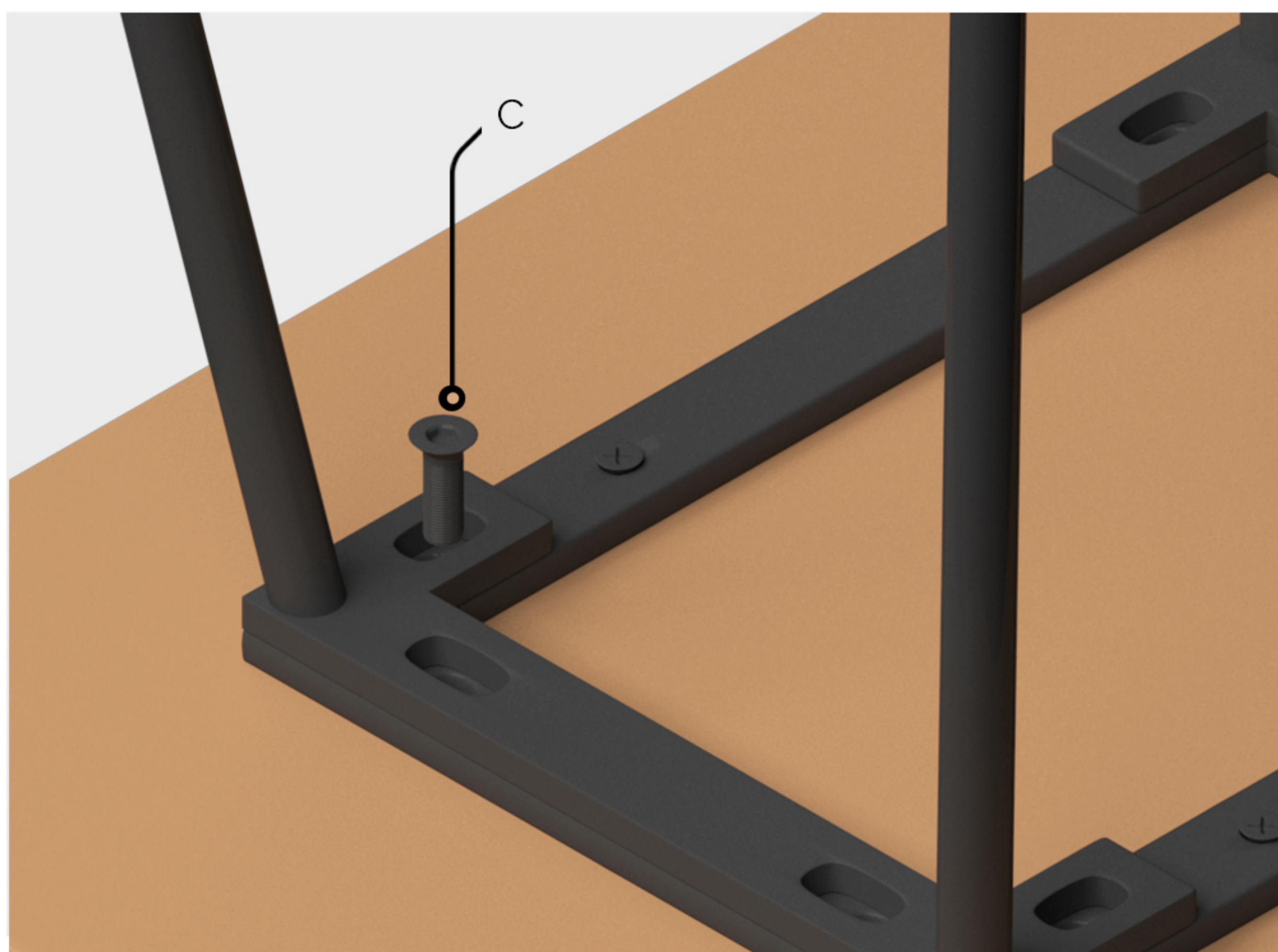

STEP 3

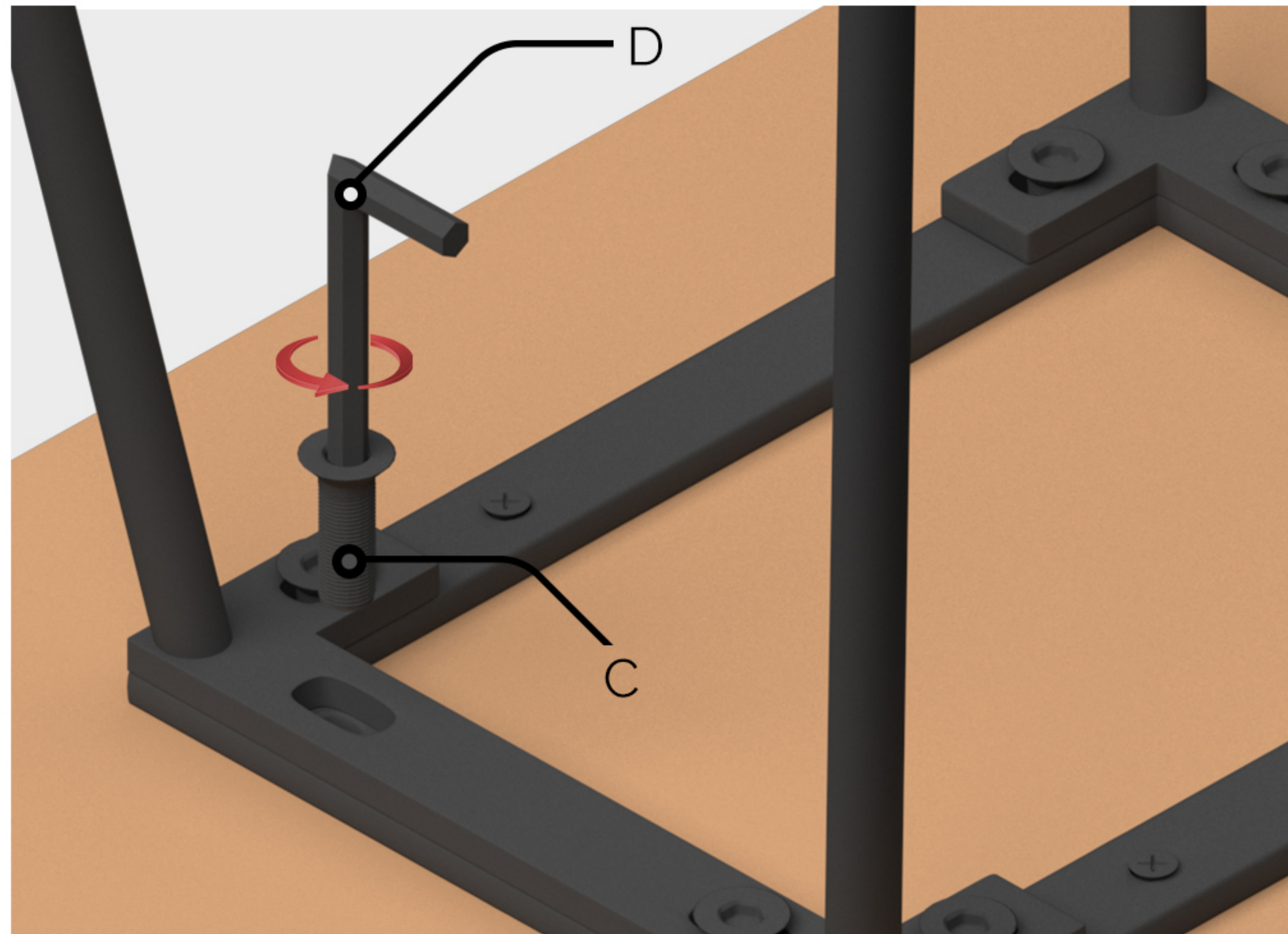

Place the Allen Bolts (C) on the highlighted parts as shown in Step 2 and using a Allen-Key (D), tighten them.



Your installation is now complete!