



3-BURNER LP GAS GRILL

Model #DGC310CNP/DGC310CNP-D
#DGC310RNP/DGC310RNP-D
#DGC310BNP/DGC310BNP-D
#DGC310GNP/DGC310GNP-D

Français p. 28

Español p. 55

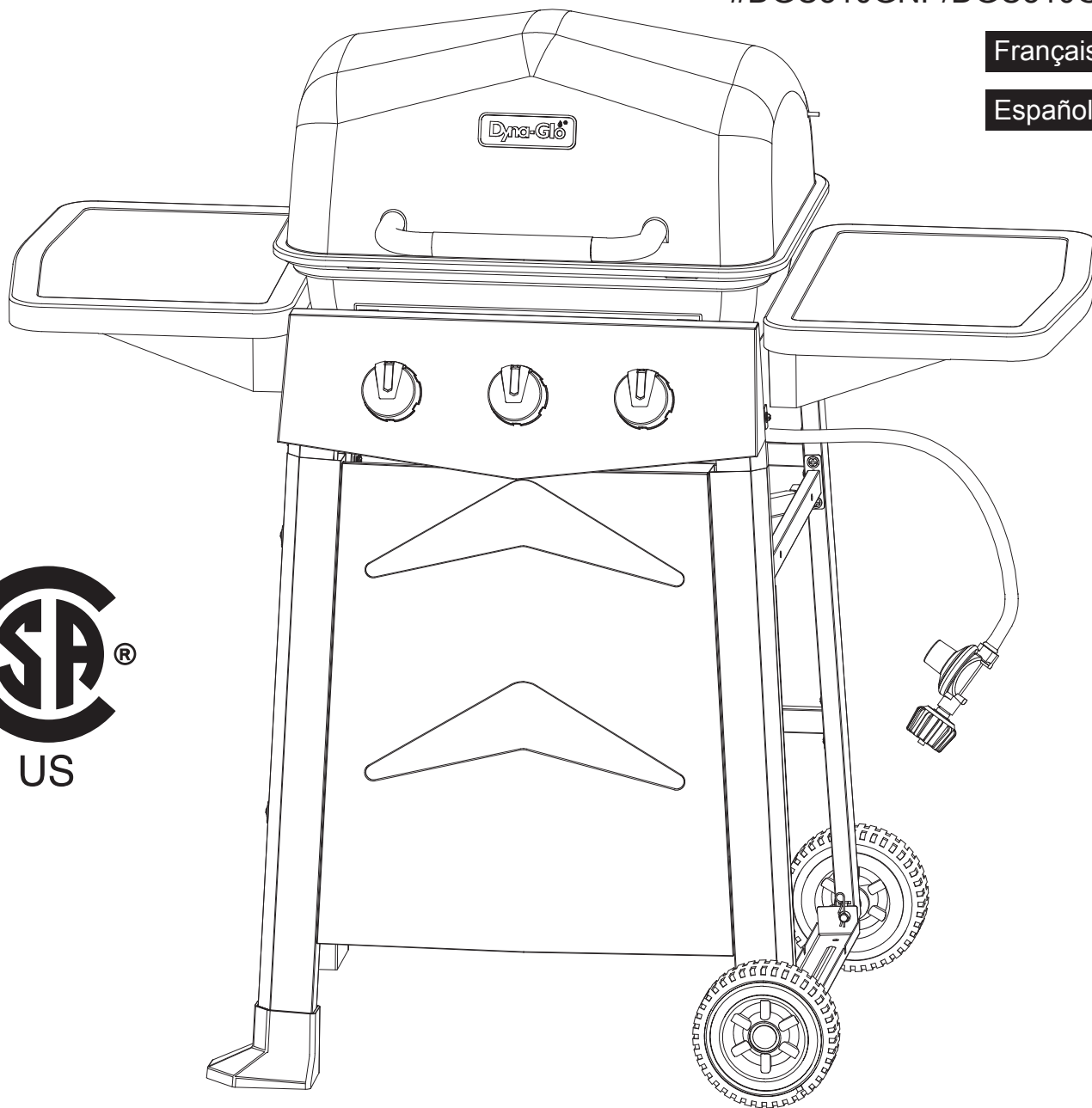

ATTACH YOUR RECEIPT HERE

Serial Number _____ Purchase Date _____



Questions, problems, missing parts? Before returning to your retailer, call our customer service department at 1-877-447-4768, 8:30 a.m. – 4:30 p.m., CST, Monday – Friday or e-mail us at customerservice@ghpgroupinc.com.

TABLE OF CONTENTS

Safety Information	3
Package Contents	5
Hardware Contents	6
Preparation	6
Assembly Instructions	7
Operation Instructions	15
Care and Maintenance	20
Troubleshooting	23
Warranty	25
Replacement Parts List	26

Assembler/Installer: This manual contains important information necessary for the proper assembly and safe use of this appliance. Read and follow all warnings and instructions before assembling and using this appliance. **Leave these instructions with the consumer.**

Consumer/User: Follow all warnings and instructions when using this appliance.
Retain these instructions for future reference.

DANGER

If you smell gas:

- 1. Shut off gas to the appliance.**
- 2. Extinguish any open flame.**
- 3. Open lid.**
- 4. If odor continues, keep away from the appliance and immediately call your local fire department.**

WARNING

- 1. Do not store or use gasoline or other flammable liquids or vapors in the vicinity of this or any other appliance.**
- 2. An LP (liquid propane) cylinder not connected for use shall not be stored in the vicinity of this or any other appliance.**
- 3. This grill is for outdoor use only and shall not be used in a building, garage, under overhangs or any other enclosed area.**
- 4. Do not leave a lit grill unattended. Keep children and pets away from the grill at all times.**

SAFETY INFORMATION

Please read and understand this entire manual before attempting to assemble, operate or install the product. If you have any questions regarding the product, please call customer service at: 1-877-447-4768, 8:30 a.m. – 4:30 p.m., CST, Monday – Friday.

DANGER

- Do not use in an explosive atmosphere. Keep grill area clear and free from combustible materials, gasoline and other flammable vapors and liquids.



WARNING: FUELS USED IN LIQUEFIED PROPANE GAS APPLIANCES, AND THE PRODUCTS OF COMBUSTION OF SUCH FUELS, CAN EXPOSE YOU TO CHEMICALS INCLUDING BENZENE, WHICH IS KNOWN TO THE STATE OF CALIFORNIA TO CAUSE CANCER AND CAUSE BIRTH DEFECTS OR OTHER REPRODUCTIVE HARM. For more information go to: www.P65Warnings.ca.gov.

CAUTION

- Never use charcoal or lighter fluid with the grill.
- Do not use gasoline, kerosene or alcohol for lighting.
- The LP gas cylinder used with this appliance must be:
 - (a) Constructed and marked in accordance with the Specifications for LP-Gas Cylinders of the U.S. Department of Transportation (D.O.T.) or the National Standard of Canada, CAN/CSA-B339, Cylinders, Spheres and Tubes for Transportation of Dangerous Goods; and Commission, as applicable; and
 - (b) Provided with a listed overfilling prevention device.
 - (c) Provided with a cylinder connection device compatible with the connector for outdoor cooking appliances. This grill is not intended to be used in or installed on recreational vehicles and/or boats.
- Never keep a filled container in a hot car or car trunk. Heat will cause the gas pressure to increase, which may open the relief valve and allow gas to escape.
- Always open grill lid slowly and carefully as heat and steam trapped within the grill can burn you severely.



SAFETY INFORMATION

⚠ WARNING

- Do not place the grill under overhead combustible construction or awnings. Minimum clearance from sides and back of unit to combustible construction, 36 inches (914.4mm) from sides and back.

NOTE: The installation must conform with local codes or, in the absence of local codes, with either the National Fuel Gas Code, ANSI Z223.1/NFPA 54, Natural Gas and Propane Installation Code, CSA B149.1, or Propane Storage and Handling Code, B149.2.

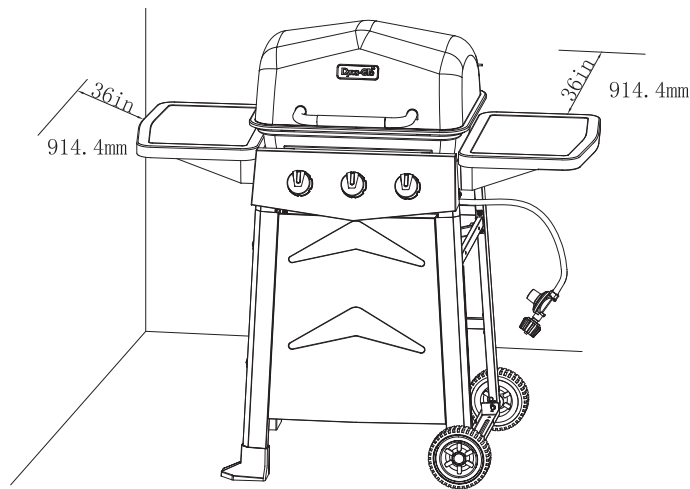

⚠ CAUTION

- Do not store or use gasoline or other flammable liquids or vapors in the vicinity of this or any other appliance.
- An LP cylinder not connected for use shall not be stored in the vicinity of this or any other appliance.
- This grill is for use with propane gas only (propane cylinder not included).
- Never attempt to attach this grill to the self-contained propane system of a boat, camper trailer, motor home or house.
- Do not attempt to move the grill while it is lit or when it is hot. The casters should be locked when not moving the grill.
- Do not use the grill unless it is completely assembled and all parts are securely fastened and tightened.
- Keep all combustible items and surfaces at least 36 inches (91.44 cm) away from the grill at all times.
- Do not touch metal parts of grill until it has completely cooled (about 45 minutes) to avoid burns, unless you are wearing protective gear (pot holders, gloves, BBQ mittens, etc...).
- Do not alter this grill in any manner.
- Clean and inspect the hose before each use. If there is evidence of abrasion, wear, cuts, or leaks, the hose must be replaced prior to operating the appliance. The replacement hose assembly will be that which is specified by the manufacturer.
- Move gas hoses as far away as possible from hot surfaces and dripping hot grease.
- Keep the grill's valve compartment, burners and circulating air passages clean. Inspect the grill before each use. Do not obstruct the flow of gas or ventilation air.
- The use of alcohol, prescription or non-prescription drugs may impair the operator's ability to properly assemble or safely operate the grill.
- **Do not leave a lit grill unattended. Keep children and pets away from the grill at all times.**
- Do not place this grill on any type of tabletop surface. The grill should be placed on a flat and level surface.
- Do not use the grill in high winds.

PACKAGE CONTENTS

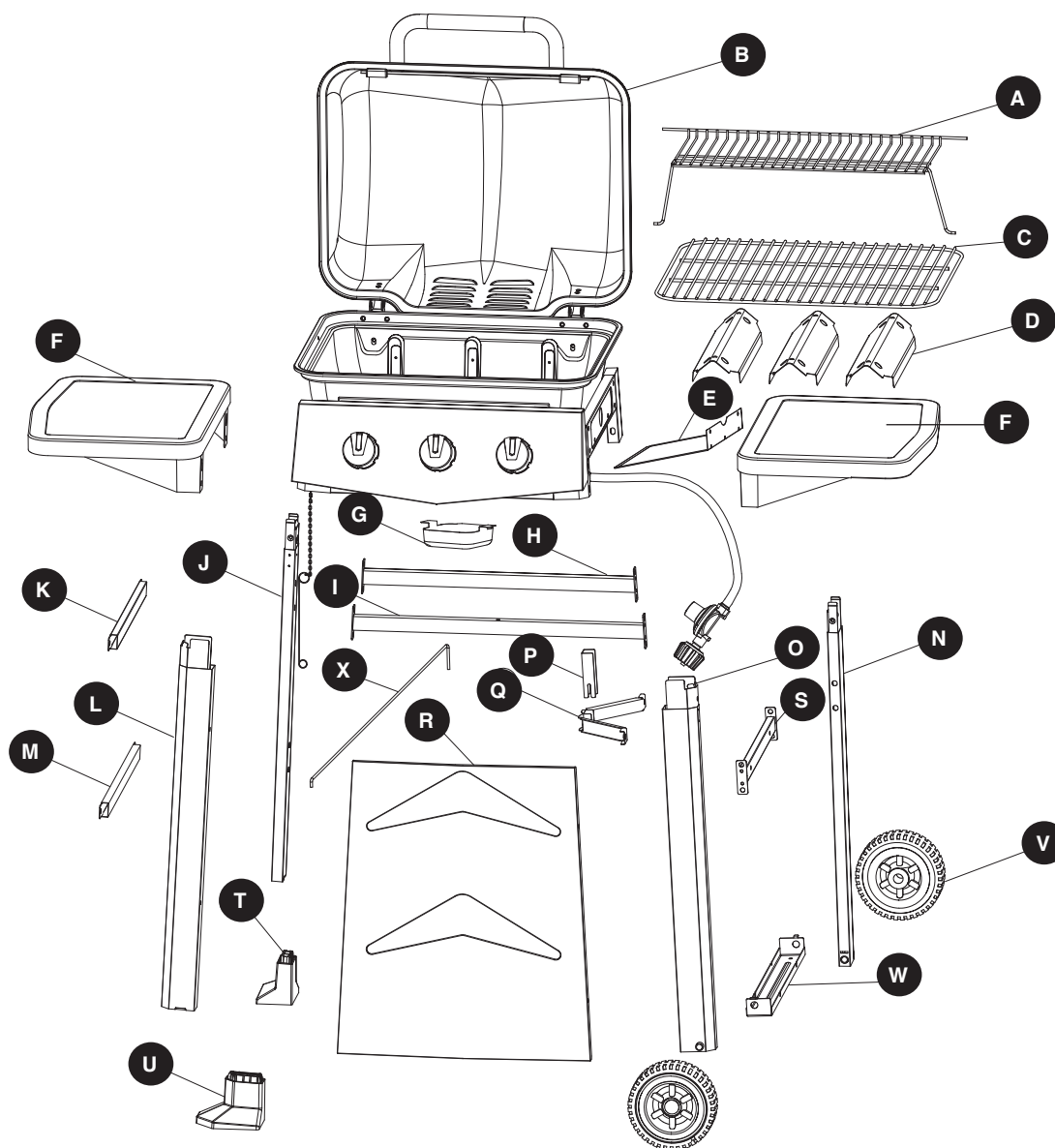

PART	DESCRIPTION	QUANTITY
A	Warming Rack	1
B	Hood and Grill Body Assembly	1
C	Cooking Grate	1
D	Heat Tent	3
E	LP Gas Tank Heat Shield	1
F	Side Table Assembly	2
G	Grease Cup	1
H	Cart Rear Upper Brace Assembly	1
I	Cart Rear Lower Brace Assembly	1
J	Left Rear Leg Assembly	1
K	Cart Left Upper Brace Assembly	1
L	Left Front Leg Assembly	1

PART	DESCRIPTION	QUANTITY
M	Cart Left Lower Brace Assembly	1
N	Right Rear Leg Assembly	1
O	Right Front Leg Assembly	1
P	Tank Retention Bracket	1
Q	Tank Retention Support Bracket	1
R	Cart Front Panel	1
S	Cart Right Upper Brace Assembly	1
T	Left Rear Leg Cap	1
U	Left Front Leg Cap	1
V	Wheel	2
W	Tank Support Bracket	1
X	Cylinder Block Bar	1

HARDWARE CONTENTS

AA



M6x12
Bolt

Qty. 30

BB

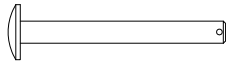

Wheel axle

Qty. 2

CC



Cotter pin

Qty. 2

DD



M4x12
Bolt

Qty. 6

EE



M6x26
Bolt

Qty. 1

FF



M6
Wingnut

Qty. 1

GG



M6x18
Bolt

Qty. 2

HH



M5
Wingnut

Qty. 1

PREPARATION

Before beginning assembly of product, make sure all parts are present. Compare parts with package contents list on previous page and hardware contents above. If any part is missing or damaged, do not attempt to assemble the product. Contact customer service for replacement parts.

Estimated Assembly Time: 50 minutes with 2 people

Tools Required for Assembly and Leak Testing (not included): Phillips screwdriver, Spray bottle, Plier, Adjustable wrench

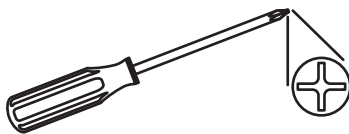

⚠ CAUTION

THIS UNIT IS HEAVY. Two people required for safe assembly.

Two people required for safe assembly. Some parts may contain sharp edges. Wear protective gloves if necessary. Read and follow all safety statements, warnings, assembly instructions and use and care instructions before attempting to assemble and use.

ASSEMBLY INSTRUCTIONS

1. Install left rear leg cap (T) onto left rear cart leg (J). Then install left front leg cap (U) onto left front cart leg (L) as illustrated. Use four M6x12 bolts (AA) to fasten the Cart Left Upper Brace Assembly (K) and Cart Left Lower Brace Assembly (M) onto Left Front Leg Assembly (L) and Left Rear Leg Assembly (J).

DO NOT TIGHTEN BOLTS AT THIS TIME.

Hardware Used

AA	M6x12 Bolt		x 4
-----------	------------	---	-----

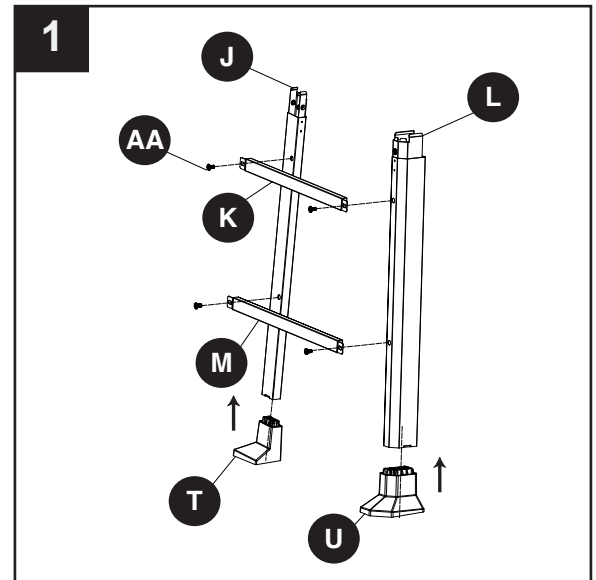



2. Place the tank support bracket (W) between the Right Front Leg Assembly (O) and Right Rear Leg Assembly (N), use two wheel axles (BB) to go through the both two wheels (V), right front leg assembly (O) and right rear leg assembly (N), then insert the two cotter pins (CC) to secure. Use four M6x12 bolts (AA) to fasten the Cart Right Upper Brace Assembly (S) onto the right front leg assembly (O) and right rear leg assembly (N).

Note: Follow the arrow direction on the Cart Right Upper Brace Assembly (S) when install.

DO NOT TIGHTEN BOLTS AT THIS TIME.

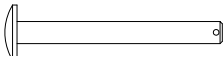
Hardware Used

AA	M6x12 Bolt		x 4
BB	Wheel Axle		x 2
CC	Cotter Pin		x 2

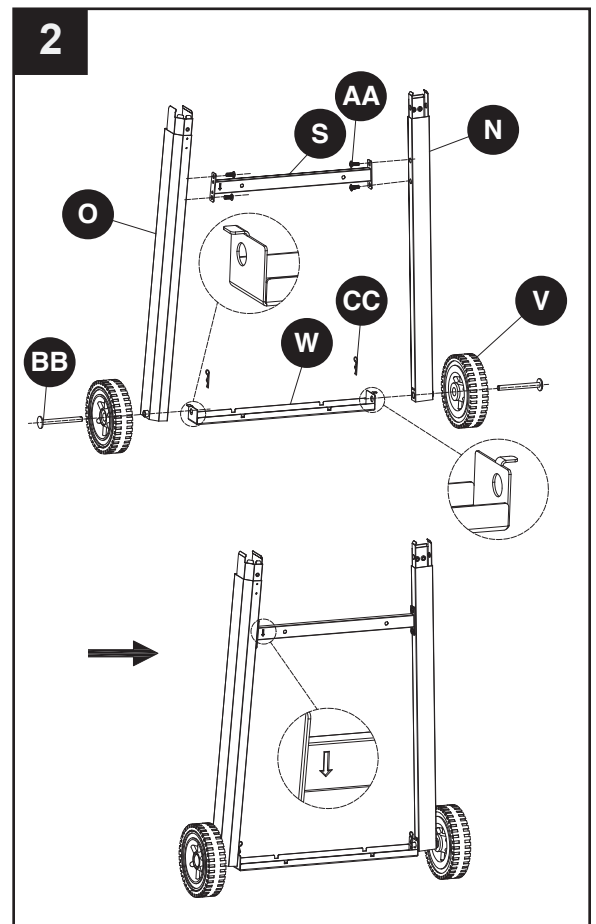

ASSEMBLY INSTRUCTIONS

3. Use four M4x12 bolts (DD) to assemble the cart front panel (R) between the Right Front Leg Assembly (O) and Left Front Leg Assembly (L).

Note: The small edge of the front panel (R) should be on top.

DO NOT TIGHTEN BOLTS AT THIS TIME.

Hardware Used

DD M4x12 Bolt  x 4

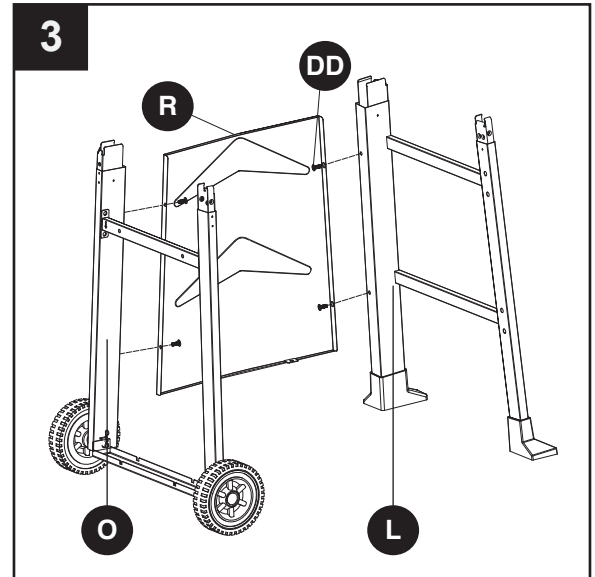

4. Use four M6x12 bolts (AA) Fasten the Cart Rear Upper Brace Assembly (H) onto Left Rear Leg Assembly (J) and Right Rear Leg Assembly (N).

Note: Follow the arrow direction on the Cart Rear Upper Brace Assembly (H) when installing.

DO NOT TIGHTEN BOLTS AT THIS TIME.

Hardware Used

AA M6x12 Bolt  x 4

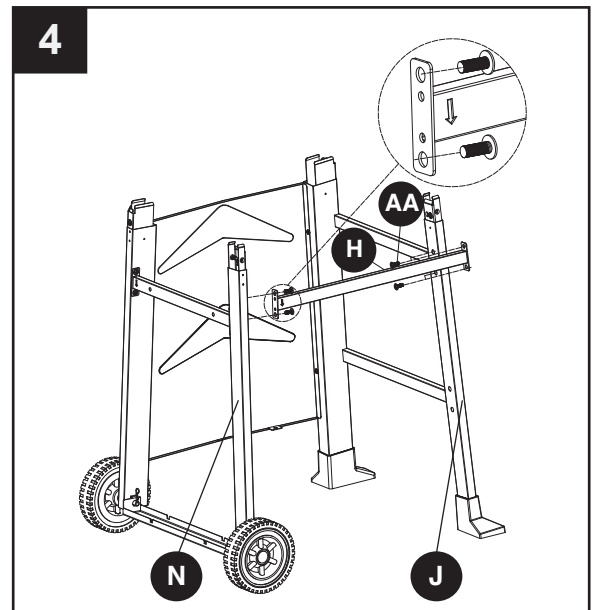

ASSEMBLY INSTRUCTIONS

5. Use one M6X26 bolts (EE) and one M6 wing nut (FF) to assemble the Tank Retention Bracket (P) to Tank Retention support Bracket (Q). Fasten Tank Retention Bracket (P) and Tank Retention support Bracket assembly (P+Q) in the Cart Right Upper Brace Assembly (S) by using two M6x18 bolts (GG).

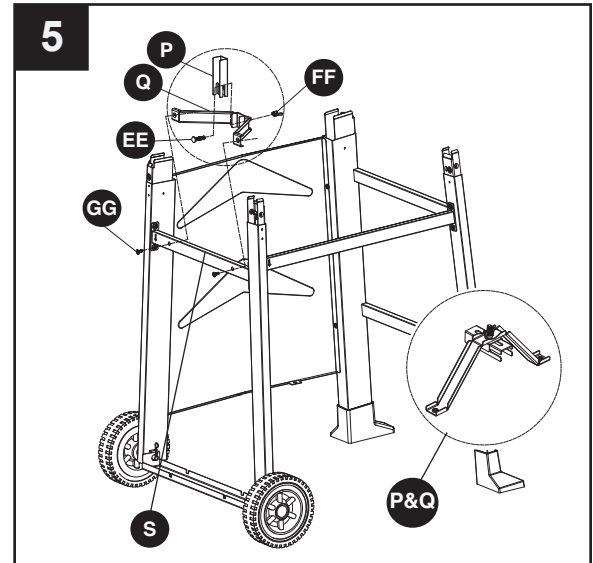

Hardware Used

EE	M6x26 Bolt		x 1
FF	M6 Wingnut		x 1
GG	M6x18 Bolt		x 2



6. Insert one of the end of cylinder block bar (X) into the hole on the bottom of front panel, insert the other end with thread onto the Cart Rear Lower Brace Assembly (I). Use one M5 wingnut (HH) to fasten the cylinder block bar (X) onto the Cart Rear Lower Brace Assembly (I). Use four M6x12 bolts (AA) to fasten the Cart Rear Lower Brace Assembly (I) onto the two rear leg assembly. Note: Follow the arrow direction on the Cart Right Lower Brace Assembly (I) when install. **DO NOT TIGHTEN BOLTS AT THIS TIME.**

Hardware Used

AA	M6x12 Bolt		x 4
HH	M5 Wingnut		x 1

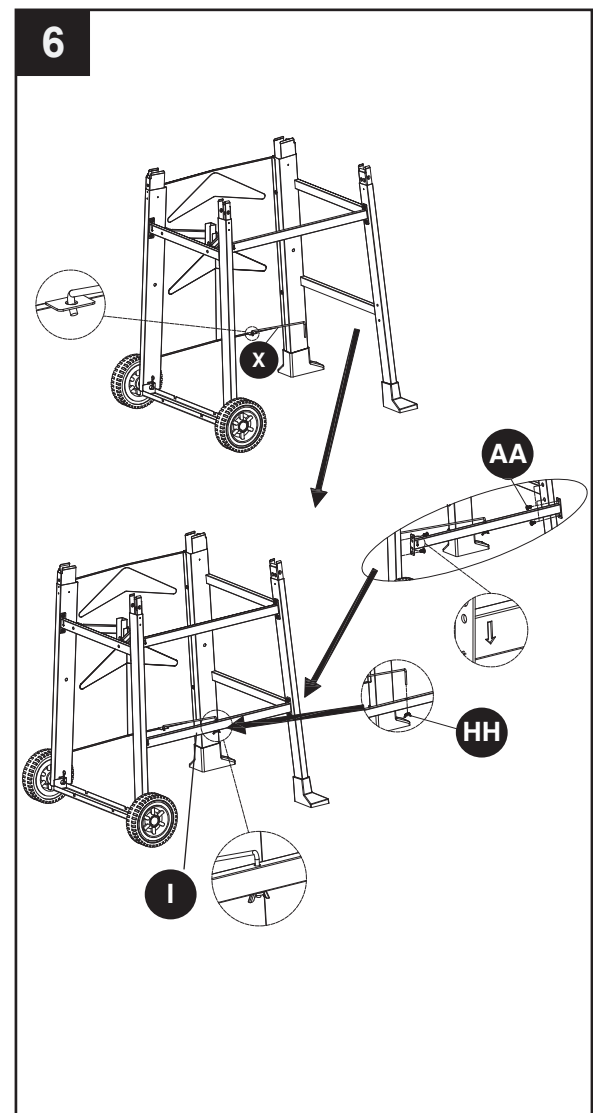

ASSEMBLY INSTRUCTIONS

7. With the help of a friend, place hood and grill body assembly (B) on cart assembly. Use six M6x12 bolts (AA) to fasten.

Note: When performing Step 7, lift grill body from front and rear panels to avoid injury to hands and fingers.

Once hood and grill body assembly (B) is placed correctly onto cart assembly, tighten ALL bolts securely from Steps 1, 2, 3, 4, and 6.

Hardware Used

AA M6x12 Bolt  x 6

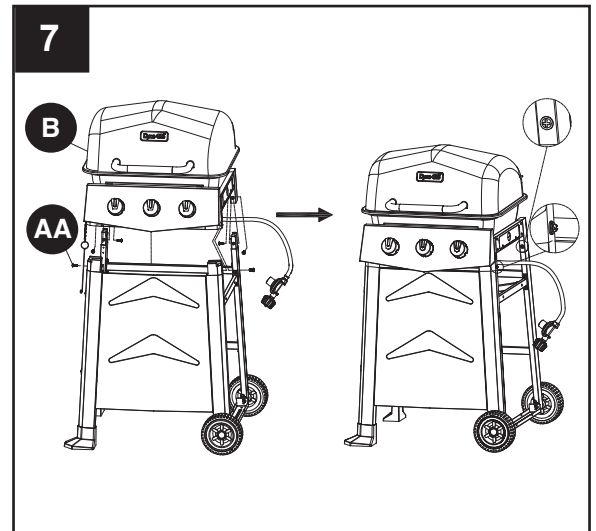

8. Use two M4x12 bolts (DD) to fasten the LP gas tank heat shield (E) on the grill body right brace.

Hardware Used

DD M4x12 Bolt  x 2

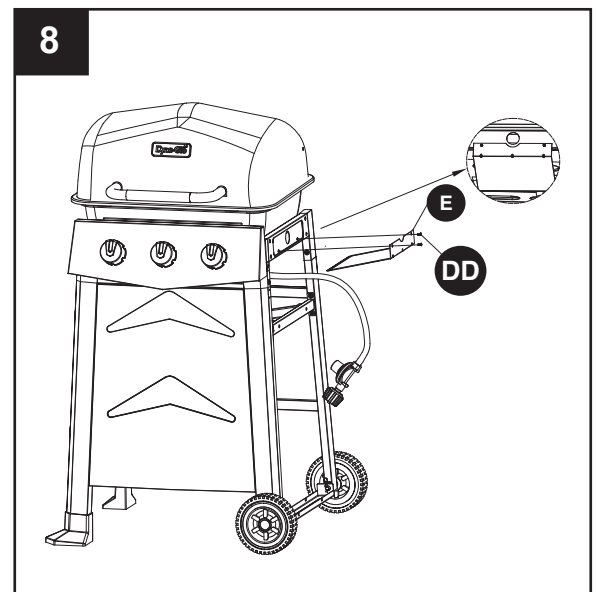

ASSEMBLY INSTRUCTIONS

9. Pre-assemble two M6x12 bolts (AA) onto the upper of left brace of hood and grill body assembly (B) and do not tighten them and make sure to leave a 5mm gap between the bolt and left brace of hood and grill body. Hang one of the Side Table Assembly (F) on the bolts and fasten the Side Table Assembly (F) with two M6x12 bolts (AA). Then tighten all the four bolts.

Hardware Used

AA M6x12 Bolt  x 4

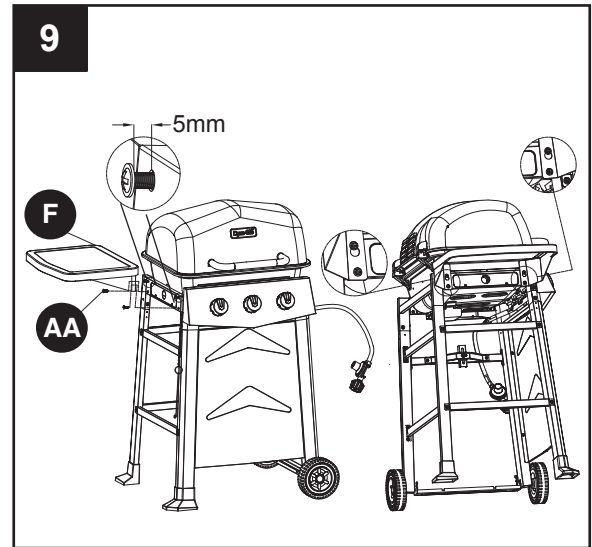

10. Pre-assemble two M6x12 bolts (AA) onto the upper of right brace of hood and grill body assembly (B) and do not tighten them and make sure to leave a 5mm gap between the bolt and right brace of hood and grill body. Hang one of the Side Table Assembly (F) on the bolts and fasten the Side Table Assembly (F) with two M6x12 bolts (AA). Then tighten all the four bolts.

Hardware Used

AA M6x12 Bolt  x 4

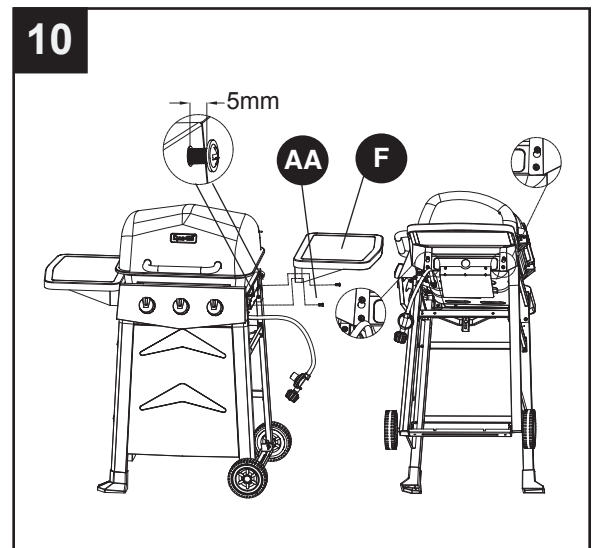

ASSEMBLY INSTRUCTIONS

! WARNING: IT IS VERY IMPORTANT TO CHECK AND ENSURE THAT EACH AND EVERY BURNER IS FULLY ENGAGED WITH THE ADJACENT VALVE ORIFICE BEFORE COMPLETING STEP 11. FAILURE TO DO SO MAY RESULT IN FIRE OR EXPLOSION, POSSIBLY CAUSING SERIOUS INJURY OR DEATH. REFER TO MAINTENANCE SECTION INSTRUCTIONS TO PROPERLY CHECK THE ENGAGEMENT.

11. Put the three heat tents(D) into place over each burner.

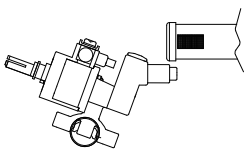

Wrong

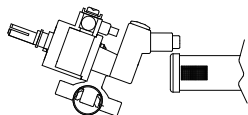

Wrong

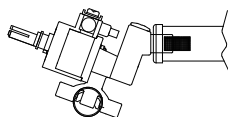

Correct

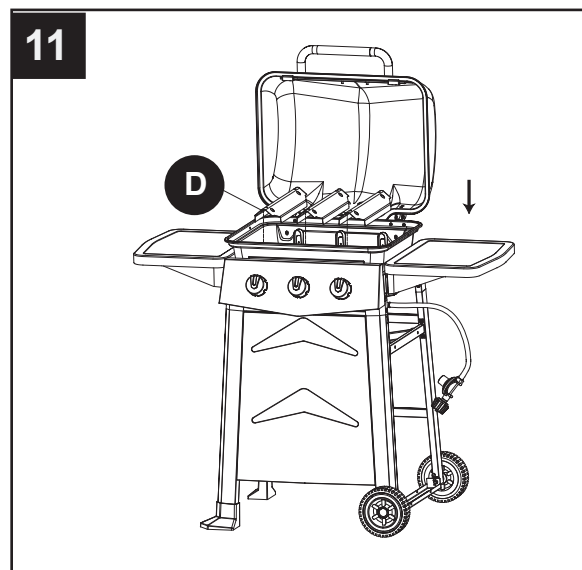

12. Put one cooking grate(C) in place.

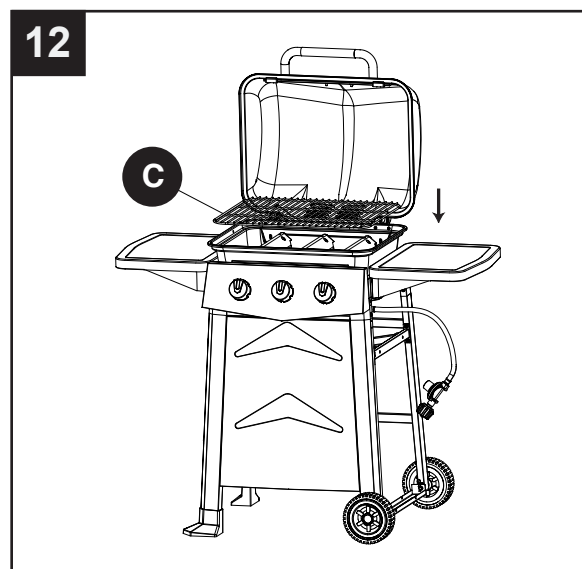

ASSEMBLY INSTRUCTIONS

13. Put one warming rack (A) in place.

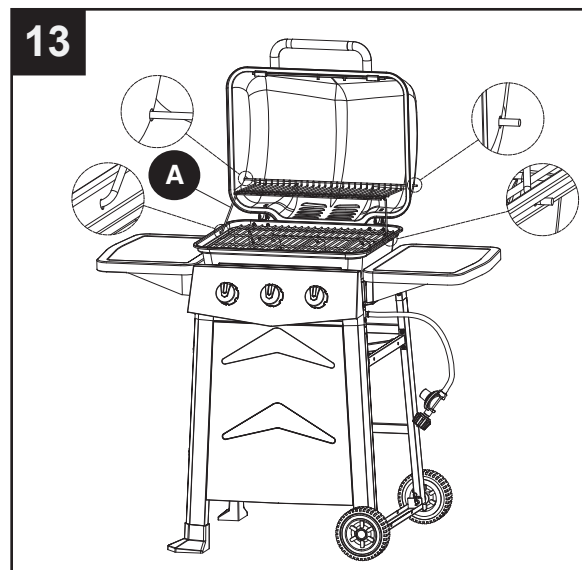

14. Slide grease cup (G) onto tracks in the bottom of firebox as illustrated.

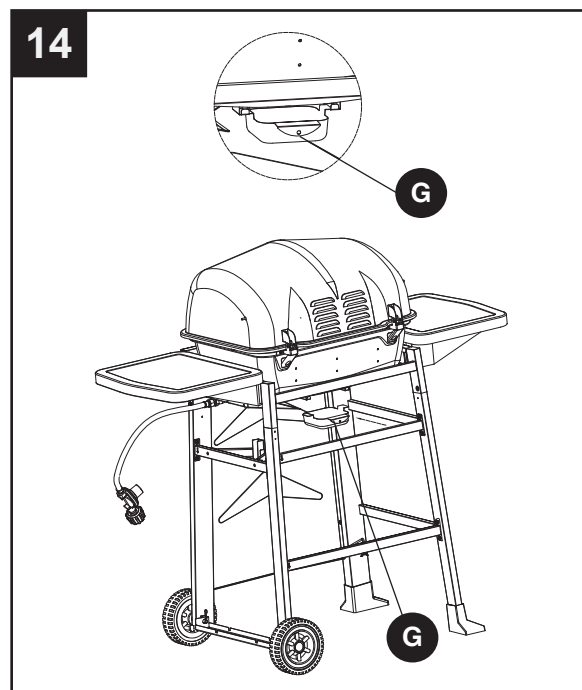

ASSEMBLY INSTRUCTIONS

15. Place gas cylinder (sold separately) upright into the notches of the tank support bracket on the bottom of right legs, orient the cylinder such that the valve opening faces the right side of the grill, and the hose is not kinked or damaged. Loosen and slide down tank retention bracket over LP Gas cylinder collar, then use the wing nut to secure tightly. Hand-tighten the hose/regulator coupling to the threaded valve of the LP gas cylinder.

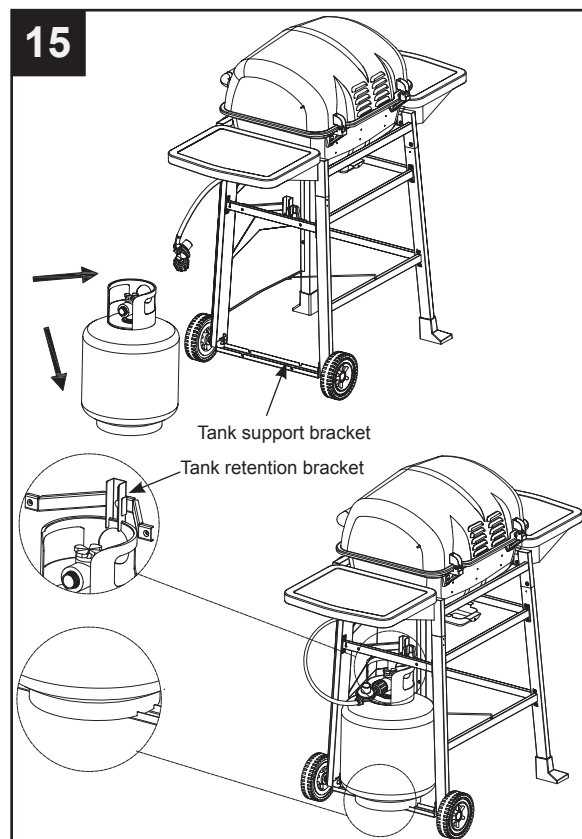

Front

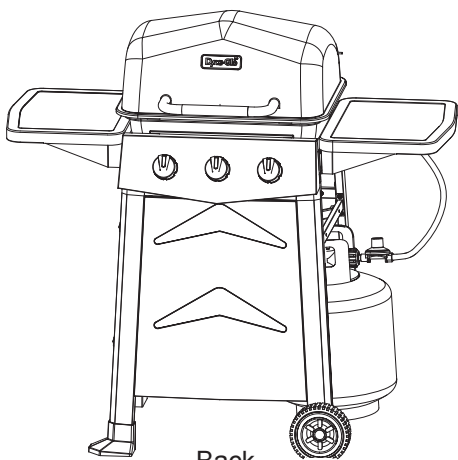

Back

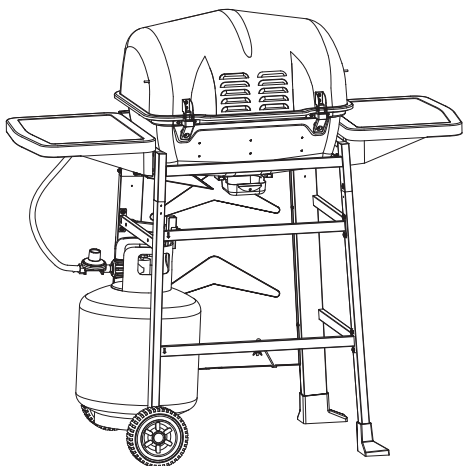

OPERATION INSTRUCTIONS

CHECKING FOR LEAKS

After all connections are made, check all connections and fittings on the LP gas tank valve, gas hose and regulator for leaks with a water and soap solution.

To prevent fire or explosion while testing for a leak:

- Always perform leak test prior to lighting the grill.
- Do not smoke while testing for a leak.
- Always perform leak tests outdoors in a well-ventilated area.
- Do not use any source of flame while testing for leaks.
- Do not use the grill until any and all leaks are corrected.
- If you are unable to correct a leak, disconnect the propane supply and call a gas appliance service dealer.

PERFORM LEAK TEST

- Prepare leak test solution by 50/50 ratio of liquid dish soap and water.
Total solution required is approximately 2 - 3 ounces (70 - 90 ml).
Put leak test solution in a spray bottle.
- Ensure all control knobs are in the **OFF** position.
- Connect the gas hose to the gas supply.
- Open the LP gas tank valve.
- Spray leak test solution on all gas carrying connections and fittings. Presence of bubbles at areas of applied test solution indicates a gas leak. If leaks are detected or you smell or hear gas, shut off the gas supply valve immediately and repair or replace the defective part. Do not use the grill until all leaks are corrected.

CAUTION

Only use the regulator and hose assembly provided! If a replacement is necessary, please call our customer service center. Do not use replacement parts that are not intended for this grill.

WARNING

ALL INSTRUCTIONS AND SAFEGUARDS ON THIS PAGE MUST BE FOLLOWED TO PREVENT FIRE, DAMAGE AND/OR INJURY.

REPLACEMENT PARTS LIST

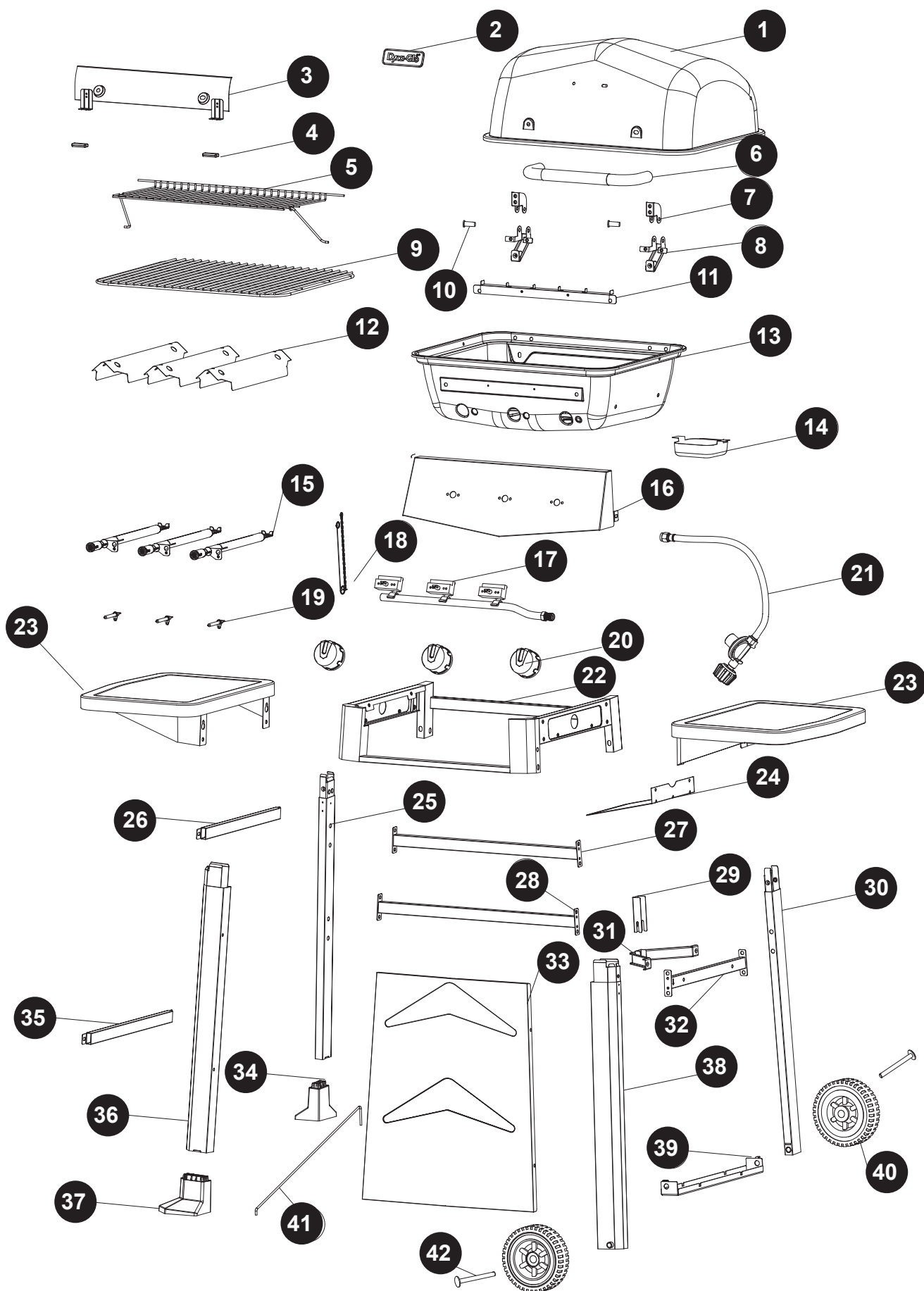

REPLACEMENT PARTS LIST

For replacement parts, call our customer service department at 1-877-447-4768, 8:30 a.m. – 4:30 p.m., CST, Monday – Friday.

PART	DESCRIPTION	PART#
1	Hood	Black 70-01-663 / Blue 70-01-757 / Red 70-01-758 / Green 70-01-759
2	Badge	70-10-540
3	Lid Handle Heat Shield Assembly	70-01-664
4	Lid Bumper	70-01-665
5	Warming Rack	70-01-666
6	Hood Handle	70-01-667
7	Lid Hinge	70-01-668
8	Grill Body Hinge	70-01-669
9	Cooking Grate	70-01-670
10	Lid Axle with cotter pin	70-01-671
11	Heat Tent Bracket	70-01-672
12	Heat Tent	70-01-673
13	Grill Body	70-01-674
14	Grease Cup	70-01-675
15	Main Burner with cotter pin	70-01-676
16	Control Panel Assembly US only	70-01-677
17	Main Valves And Manifold Assembly	70-01-679
18	Match Holder with Chain	70-01-204
19	Main Burner Sparker	70-01-680
20	Control Knob	70-01-681
21	Regulator and Hose Assembly	70-01-647
22	Grill Body Support Assembly	70-01-682
23	Side Table Assembly	70-01-683
24	LP Gas tank Heat Shield	70-01-684
25	Left Rear Leg Assembly	70-01-685
26	Cart Left Upper Brace Assembly	70-01-686
27	Cart Rear Upper Brace Assembly	70-01-687
28	Cart Rear Lower Brace Assembly	70-01-688
29	Tank Retention Bracket	70-01-689
30	Right Rear Leg Assembly	70-01-690
31	Tank Retention Support Bracket	70-01-691
32	Cart Right Upper Brace Assembly	70-01-692
33	Cart Front Panel	Black 70-01-693 / Blue 70-01-760 / Red 70-01-761 / Green 70-01-762
34	Left Rear Leg Cap	70-01-694
35	Cart Left Lower Brace Assembly	70-01-695
36	Left Front Leg Assembly	70-01-696
37	Left Front Leg Cap	70-01-697
38	Right Front Leg Assembly	70-01-698
39	Tank Support Bracket	70-01-699
40	Wheel	70-01-700
41	Cylinder Block Bar	70-01-701
42	Wheel axle	70-01-702
n/a	Instruction manual	70-10-661
n/a	Hardware pack	70-09-522