

Square Punch Linear Drain

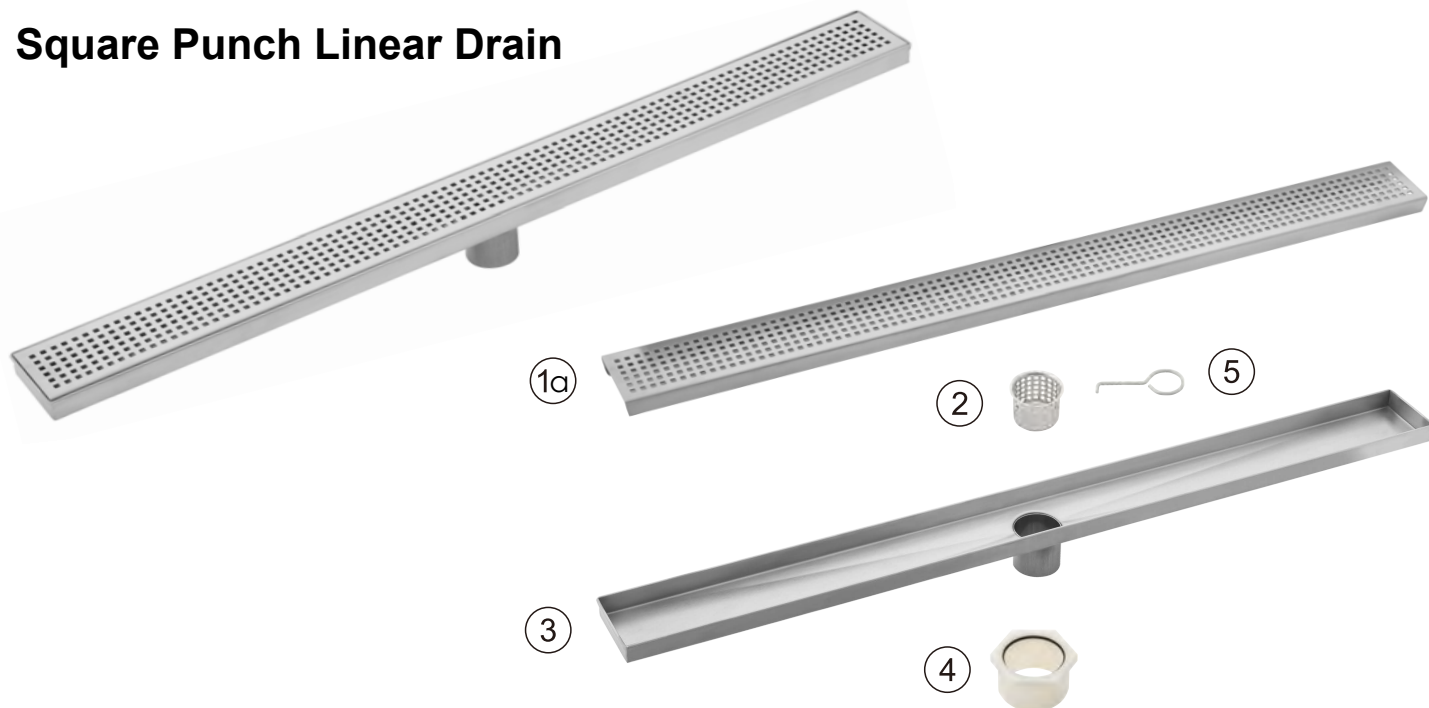

Tile Insert Linear Drain

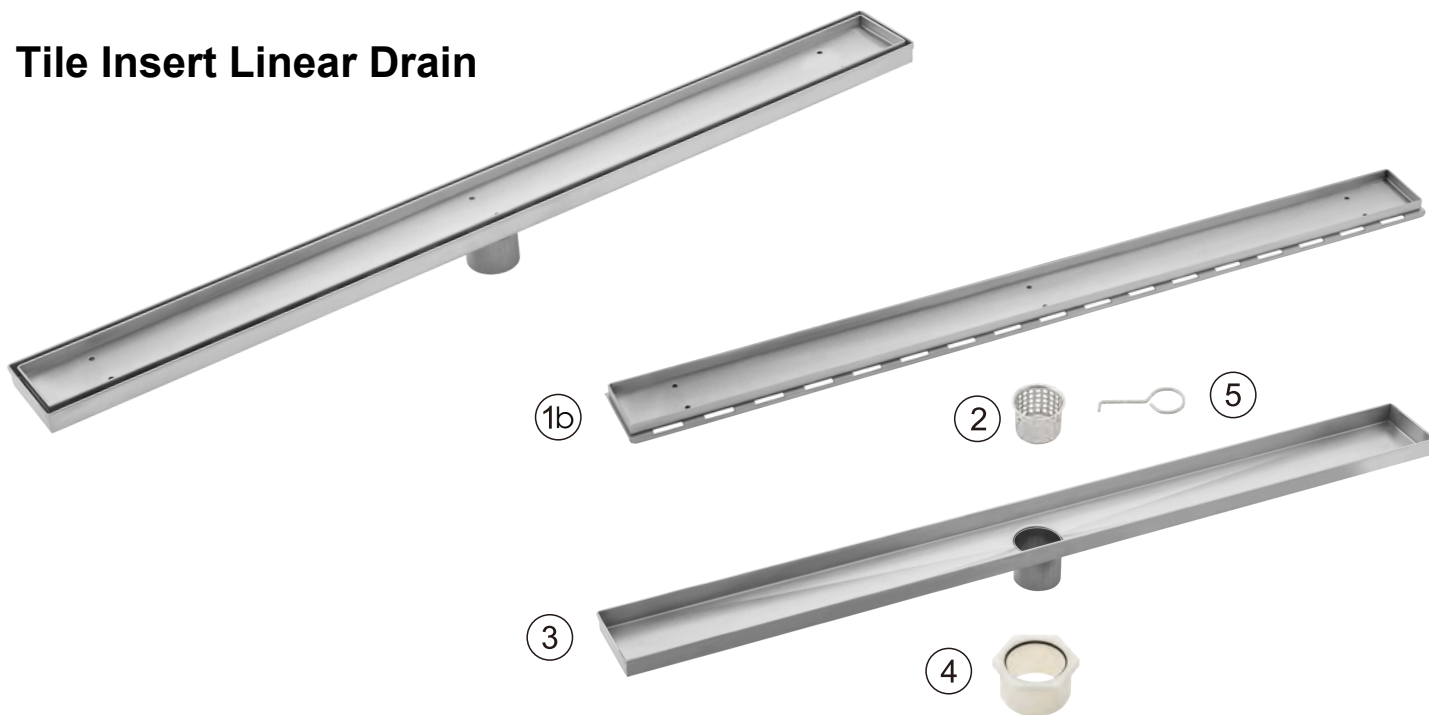

1. (a) Grate Tray
(b) Tile Tray

2. Hair Strainer
3. Linear Channel

4. Optional Adapter
5. Lift-Out Key

An exploded view of a typical shower flanged drain assembly is shown on the left for your reference. This assembly can be made from PVC, cast iron or other composite materials.

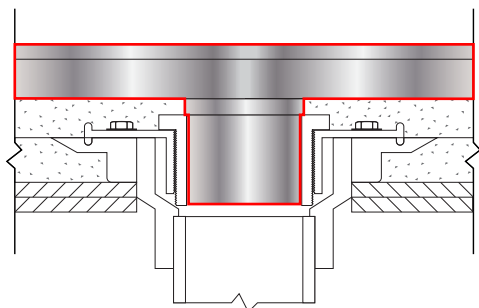
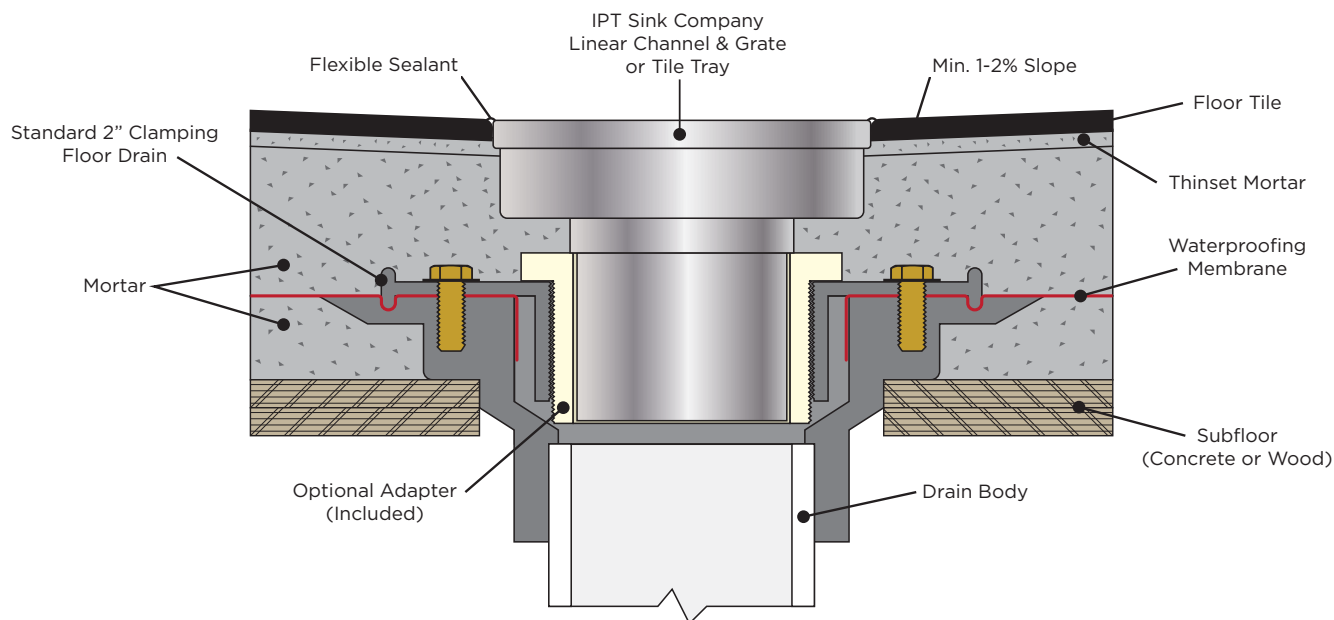

Simply place the (2) hair strainer into the (3) channel; and place the (1) tray on the top.

Use the (5) lift-out key to pull (2) hair strainer out when you clean it.

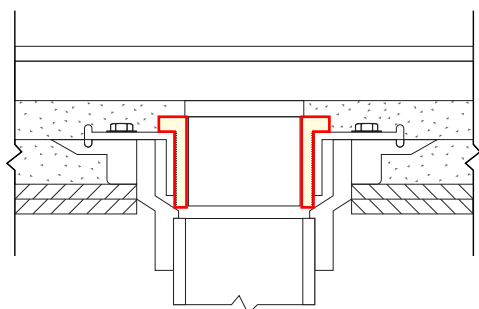
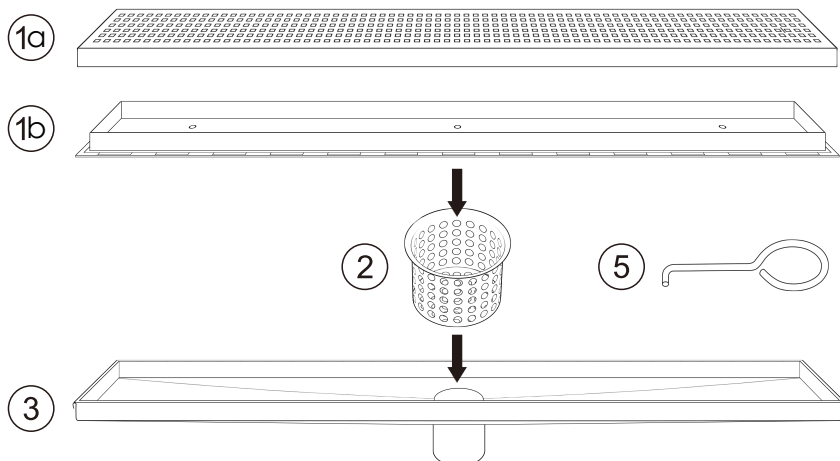

Screw the (4) optional adapter clockwise to adjust the heights of channel.

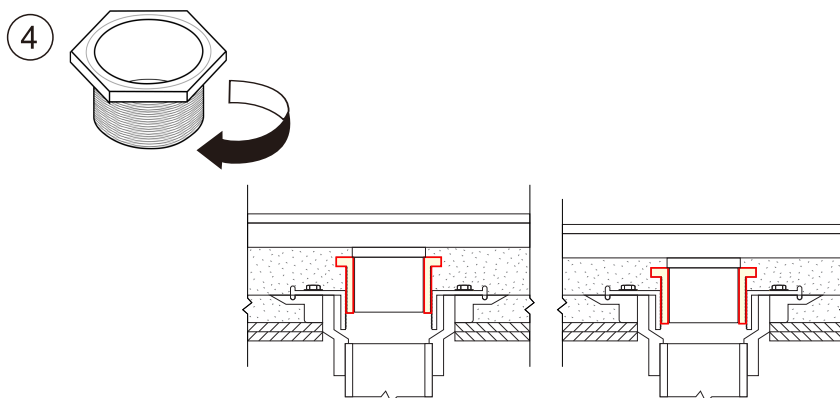

Step 1 - Prepare Shower Pan

Pre-slope shower pan and install waterproofing membrane per manufacturer's instructions. Any waterproofing membrane material or procedure can be used (vinyl, CPE Membrane, Roll/Paint On, Metal Pan, Hot Mop, Surface Sheet Membrane, etc.). Perform a leak test as required.

Step 2 - Rough Opening

The IPT Sink Company Linear Drain channel width is 3-3/16". Confirm rough opening is approximately 2" wider than drain length to accommodate backer board and wall tile thickness (A 38" rough opening will close to almost a 36" finish opening based on the thickness of materials).

Step 3 - Flexible Sealant Application #1

Cut a 2x4 to length for use as a Linear Drain placeholder. This allows for a 1/8" gap around the channel's perimeter to apply a bead of flexible sealant. Note: Channel depths are 1.25" for the IPT Sink Company Tile Insert Linear Drain and 0.78" for all other IPT Sink Company Linear Drains.

Step 4 - Mortar Bed Installation

Using mortar, build up the shower base. Slope the mortar creating a 1-2% grade towards the drain. Allow the mortar to cure overnight before installing tiles.

Step 5 - Tile Installation

Using a thinnest mortar, install the floor tile and entire shower alcove. Install tile into tile insert tray (Tile Insert Drains Only). Grout, clean, and seal all tile in the shower area.

Step 6 - Linear Drain Installation

Remove the 2x4, clean out the void and install the IPT Sink Company Linear Drain channel as you would any tile building up and supporting as necessary with mortar. Ensure drain channel is level and just slightly below (1/6" or less) the adjacent tile.

Step 7 - Flexible Sealant Application #2

Line perimeter of linear drain channel with a color-matching flexible, waterproof sealant. This will allow the stainless steel to expand and contract with damaging the grout or tiles.



Standard Drain Pipe



Drain Hub with Adapter



with Vinyl Pan Liner

