

## Care & Maintenance

Rivuss Glass Vessel Sinks are hand crafted from the finest quality tempered glass which is durable and corrosion resistant. However, by following certain measures for care and maintenance you can keep its shine and luster for a lifetime.

Rivuss recommends using a non abrasive sponge along with soapy warm water and a dampened soft cloth to maintain luster and shine of the glass sink. We do not recommend using any household cleaners to clean the product. Please do not apply any force or scrub the glass while cleaning your glass sink.

**For more information please visit [www.rivuss.com/support](http://www.rivuss.com/support)**

## RIVUSS BRAND GLASS VESSEL SINK LIMITED LIFETIME WARRANTY

All products created under RIVUSS brand name are tested by an intricate system of quality control protocols. RIVUSS brings to its customers products that are luxurious and engineered to last forever.

Rivuss Glass Vessel Sinks carry a \*Limited lifetime warranty from the original date of purchase.

If a product fails as a result of a defect in manufacturing during the warranty period, Rivuss will repair or replace the product at its sole discretion. Proof of purchase (Original invoice / Sales receipt) must be provided to Rivuss for all warranty claims. The Warranty applies only to sinks installed in the United States of America & Canada. Rivuss extends its warranty to the first consumer purchaser.

This warranty does not apply unless RIVUSS product is installed by fully insured licensed professional plumber or contractor. RIVUSS strongly recommends that such licensed professionals have experience in the installation of bathroom and kitchen products. Installation of certain products, including without limitation, glass products (i.e. Glass Sinks or Faucets) by an inexperienced person may result in glass breakage and consequently, cause personal injury.

Rivuss makes no representation that its products comply with any or all local building or plumbing codes. It is consumer's responsibility for determining local code compliance.

**Limitations:** \*Limited lifetime warranty shall not apply to instances of incorrect operating procedures, breakages chipped, cracked, scratches, shattered or damages caused by fault through improper installation, carelessness, abuse, misuse, misapplication, improper maintenance and alteration of the product. The owner/end-user of the product covered by the present warranty is entirely responsible for its proper installation and use.

RIVUSS IS NOT LIABLE FOR ANY INCIDENTAL, CONSEQUENTIAL OR ACCIDENTAL DAMAGES, LABOR CHARGES, TRAVEL TIME, FREIGHT COSTS INCURRED OR CONTINGENT LIABILITIES.

Contact us at Toll Free 1-855-5-RIVUSS  
visit our website [www.rivuss.com](http://www.rivuss.com) © 2013 - 2015 Rivuss USA



### MISSION & GOAL

Company's mission is to keep up with the trend and provide customers with the finest quality merchandise, and its goal is to evaluate customer needs and enhance their home style by offering the product that is high in "Quality and Value", competitively priced, backed by personal service and prompt delivery. Our innovative bathroom and kitchen products are a breeze to use, and environment friendly.

### VISION

RIVUSS strives to offer timeless styles mixed with fresh accents that will help customers to create a casual, comfortable lived-in look for less. Our products combine elegant, minimalist aesthetic designs with an ease to create the ultimate experience in your day to day life. We believe in Performance with Purpose, our innovative range of products are designed to minimize water consumption without compromising on luxury, as every home deserves the best. Our inspiring bath and kitchen designs will turn your day-to-day tasks into an invigorating experience.

### SAFETY CAUTION:

Products made from glass such as Glass Vessel Sink, Glass Disc (with Water fall faucet) and related accessories require extra caution. Please BE CAREFUL to open the packaging and handling such products.

**DO NOT try to install them without a licensed professional.**

Rivuss is not liable for any consequences as a result of failure to comply with the safety caution.

Contact us at Toll Free 1-855-5-RIVUSS  
visit our website [www.rivuss.com](http://www.rivuss.com) © 2013 - 2015 Rivuss USA



Dear Valued Customer,  
Thank you for choosing Rivuss, our success lies in our prompt, professional and personal attention we strive to give. We are committed towards each and every product we sell. We welcome any questions or comments that you may have, please feel free to contact us.

Sincerely, **Rivuss** customer service

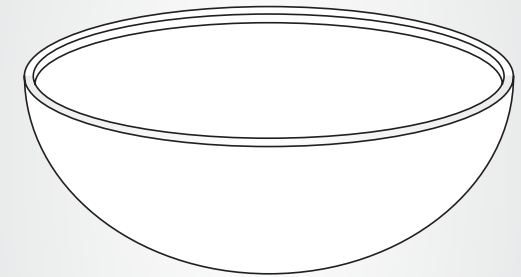

## INSTALLATION INSTRUCTIONS

### Tempered Glass Vessel Sink

### “Rivuss Glass Atelier”

**Handcrafted and Infused with Colors & Textures of Fashion Trends**

Glass Thickness: 12mm – 19mm  
Diameter: 16 -17 inches  
Drain Opening: 1-3/4” Standard  
Installation: Above counter

Contact us at Toll Free 1-855-5-RIVUSS  
visit our website [www.rivuss.com](http://www.rivuss.com) © 2013 - 2015 Rivuss USA

## Important

1. Please check this Product immediately to ensure that it has not been damaged, broken, scratched or chipped.
2. Keep the product in its original box until you are ready to install it.
3. Before installation, please make sure this product is the correct model and you have all the parts required for installation and use.
4. Verify if the packaging includes all essential parts such as :
  - Vessel sink
  - Pop up drain (optional / may be sold separately)
  - Mounting ring (optional / may be sold separately)
5. We recommend that this product is installed by a qualified professional plumber/ contractor.
6. Turn off water supply before commencing work, this should be done at the isolating valves of inlet feeds if fitted or main stopcock
7. Please read these instructions carefully and keep it for future reference.

## Rough-In Dimensions

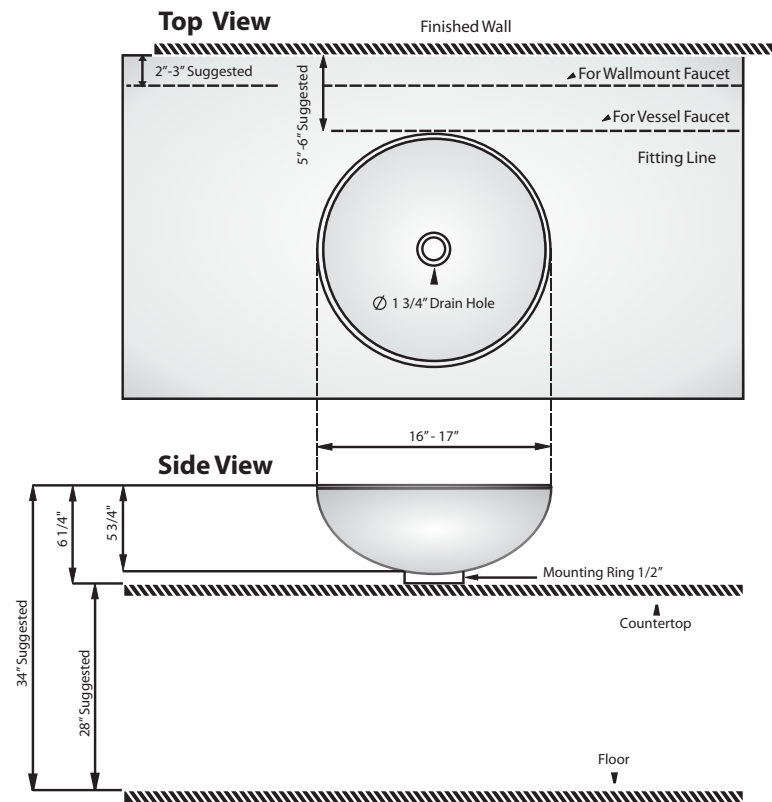

## Pop Up Drain & Mounting Ring (ONLY IF INCLUDED)

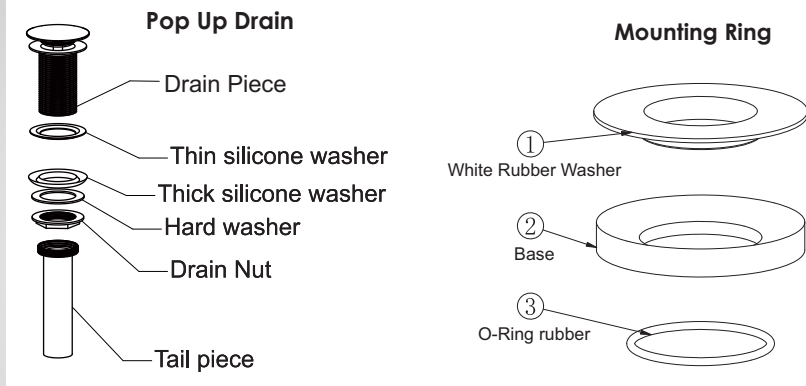

- Disassemble your pop up drain in the following order (only if included)
- Unscrew the tail piece and the drain nut
  - Remove the hard washer and thick silicone washer; leave the top thin silicone washer on.

## Glass Vessel Sink Installation Procedure

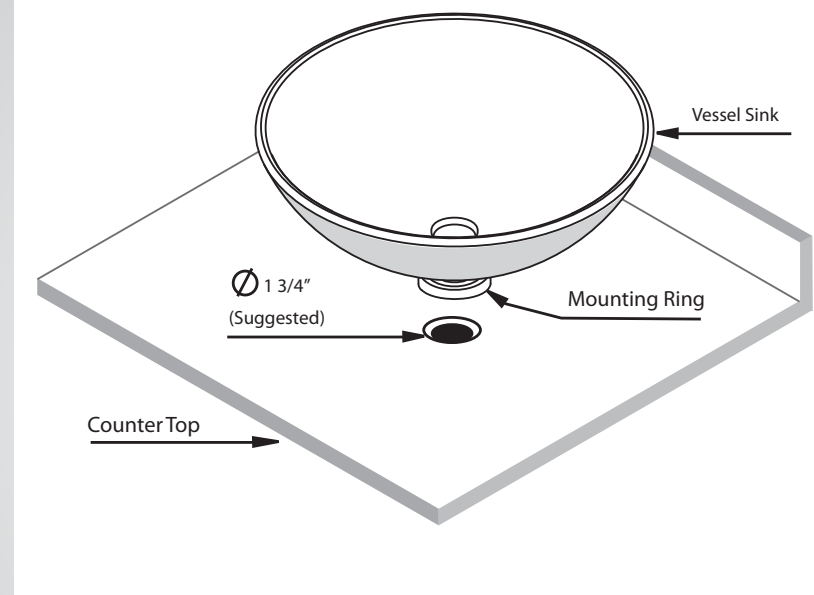

- Step 1: Prepare counter top and drill a 1-3/4" hole for the drain at the preferred position.
- Step 2: Then place the vessel sink on the mounting ring or counter top as shown above.

## Pop Up Drain & Mounting Ring Installation

(ONLY IF INCLUDED)

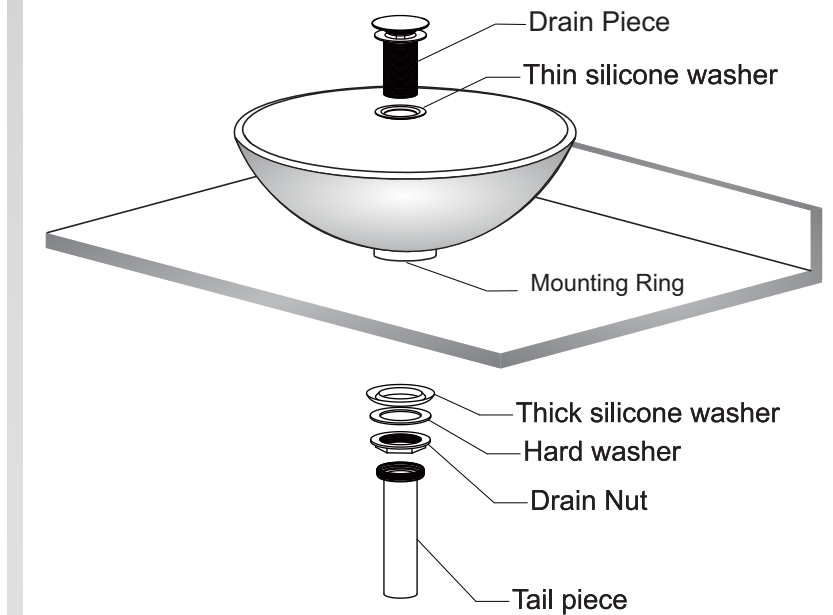

**DO NOT OVER TIGHTEN THE DRAIN.**

(Please Note: No tools are required. Installation should be done by hand.)

- Step 1: Place the mounting ring over the drain hole with O-ring rubber base side facing down and the white rubber washer side facing up and then gently set your sink on the top of the mounting ring.
- Step 2: From above the counter top, insert the drain piece with the thin silicone washer into 1-3/4" drain opening of your sink.
- Step 3: From underneath the counter top, insert thick silicone washer into the drain piece pushing the washer all the way up until it is in contact with the counter top.
- Step 4: Insert the hard washer onto the drain piece until it comes into contact with the thick silicone washer.
- Step 5: Screw and tighten the drain nut onto the drain piece until it touches the hard washer.
- Step 6: Screw and tighten the tail piece onto the drain piece.