

Installation Guide
English

DRINKPOD

DRINKPOD 2000

Countertop Purifier·Dispenser

Model: DP2000(B)

Customer Assistance
1-844-374-6576

www.drinkpod.com
Drinkpod and the Drinkpod logo are the registered
trademarks of Drinkpod, LLC.
All Rights Reserved.



Table Of Contents

IMPORTANT SAFETY INSTRUCTIONS	1
GETTING STARTED	1-1
Installation Components List	1-1
Configuration & Location	1-3
Preparation	1-8
Tapping Water Source	1-9
INSTALLING YOUR DRINKPOD	1-9
Running Water Source Line	2-12
Connecting Accessory Appliances (Optional)	2-13
Connecting Your DRINKPOD	2-23
Installing Filters	2-26
Enabling Water Flow To Your Drinkpod	2-30
Flushing Your Filters	2-31
Enabling Water Flow From Your Drinkpod (Optional)	2-31
Powering On Your Drinkpod	2-31
APPENDIXES	APP-1
Appendix A - Water Sources	App-1
Accessory Water Line Source - Wall Mounted	App-1
Accessory Water Line Source - Floor Mounted	App-2
Accessory Water Line Source - Unmounted	App-3
Faucet Cold Water Line Source	App-4
Appendix B - Component Connections	App-5
¼ in. Compression Tubing With Brass Fittings	App-5
¼ in. Compression Hose (Basic)	App-6
¼ in. Compression Braided Hose	App-7
NOTES	NOTES-1

Important Safety Instructions

When using electrical appliances, basic safety precautions should always be followed, including the following:

1. Read all instructions.
2. Should your appliance ever fail, please disconnect the power and water immediately before calling for assistance.
3. To avoid leakage and damage, never remove appliance parts.
4. Unsupervised children should not be allowed to operate the machine.
5. Please use the product in a dry place within the temperature ranges of 40°F and 100°F.
6. Ensure the power cord is always unplugged before performing any maintenance, troubleshooting, or filter upgrades.
7. Only use Kenmore or Drinkpod accessories and filters to avoid causing damage and voiding product warranty.
8. For all service and support related issues, please contact Drinkpod. [1-844-374-6576](tel:1-844-374-6576) or support@drinkpod.com
9. Any and all repairs should only be attempted by qualified persons designated by Drinkpod.
10. Do not install the machine in a location exposed to direct sunlight.
11. Never store or expose your DRINKPOD 2000 in an environment less than 32°F.
12. This appliance is not intended for use by persons with reduced physical, sensory, or mental capabilities, or lack of experience and knowledge, unless they have been given supervision or instruction concerning use of the appliance by a person responsible for their safety. Children should be supervised to ensure they do not play with the appliance.
13. If the supply cord is damaged, it must be replaced by the manufacturer, one of its designated service agents, or similarly qualified person, in order to avoid all hazards.
14. Do not store explosive substances such as aerosol cans, or other items with a flammable propellant, in this appliance.
15. This appliance is intended to be used in household and similar applications, kitchens, offices, and similar non-retail applications.
16. The appliance should only be plugged into a grounded three prong socket. A surge protector is recommended.
17. The appliance should never be turned upside down, or tilted more than 45°.
18. The appliance should never be cleaned utilizing a compressed water stream.
- 19. This product is designed for household use only!**
- 20. WARNING: To avoid any hazards due to instability of the appliance, it must be installed, maintained, and repaired, in accordance with this manual.**

SAVE THESE INSTRUCTIONS!

Getting Started

Installation Components List

Included with your DRINKPOD 2000 are a broad assortment of installation accessories. Do not get overwhelmed. While it is highly unlikely that you will require all of them, working with anything connected to your home's water system can be the wild west, and plumbers are rogue gunslingers. That's why we've done our best to provide enough accessories to accommodate almost any scenario, and easy to understand instructions to guide you through the process.

We highly recommend leaving the installation accessories in their labeled tray until you are instructed to remove them.

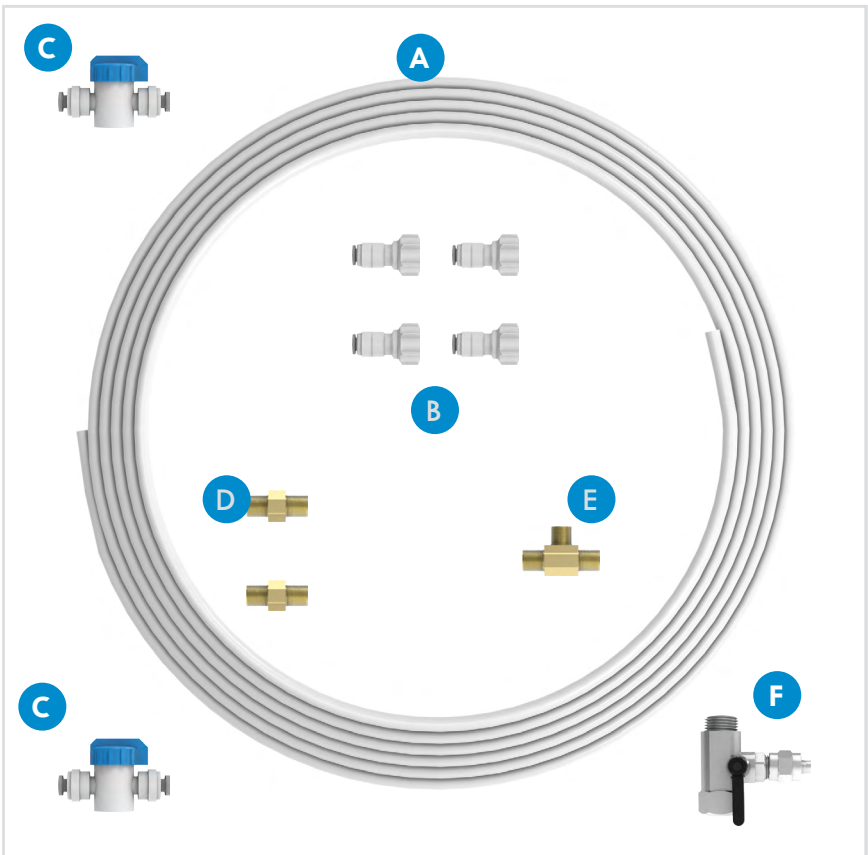

Getting Started

- A: 25 ft. Coil of 1/4 in. White PP Tubing
- B: 1/4 in. Compression To Quick Connect Adapter (x4)
- C: 1/4 in. Quick Connect Shutoff Valve (x1 + x1 pre-connected)
- D: 1/4 in. Brass Compression Union
- E: 1/4 in. Brass Compression Tee
- F: 3/8 in. Sink Adapter Valve (1/4 in. Custom x 3/8 in. Male x 3/8 in. Female x Compression Steel Angle Stop Valve Adapter)

Getting Started

Before we proceed with your installation, we must first identify how and where to install your new DRINKPOD 2000. This will be the most complicated part of the installation process. Don't be intimidated! We've worked hard to write the best set of instructions you'll ever read. Be prepared to feel like a DIY pro when you're finished!

Configuration & Location

First, let's decide **where** you want to install your DRINKPOD 2000. In almost all cases, this is easily decided by answering two simple questions.

1. **What water sources are available?** If you're not sure what you have, or how to check, see [“Appendix A - Water Sources” on page App-1](#) for pictures and more information.
 - A. **Water Accessory Line** (typically refrigerator ice maker line/source)
 - B. **Sink Faucet Cold Water Line** (i.e. underneath your kitchen sink)
2. **Do you want to connect any other appliances?** Your DRINKPOD 2000 is capable of providing purified water to up to two kitchen appliances* (i.e. refrigerator, ice maker, or coffee maker/espresso maker/barista machine with an in-line water connection) like the Drinkpod JAVAPod 1.

**The ability to provide purified water to external appliances is dependent on having sufficient water pressure.*

3. Following this are diagrams of the most common types of installations our customers like to use. Quickly review them to identify which configuration best suits you. We recommend connecting to a Water Accessory Line if both types of water sources are available.

Getting Started

Accessory Water Line Configurations



Example Installation #1.1

Accessory Water Line Source

BEFORE

Accessory Water Source
(Ice Maker)



AFTER

Accessory Water Source
(Ice Maker)



DRINKPOD
(Ice Maker Connection)

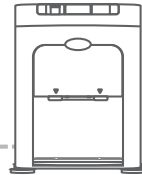

Diagram 2.1.1-A Accessory Water Line Source (Not Connected, No Accessory Appliances)



Example Installation #1.2

Accessory Water Line Source - 1x Accessory Appliance

BEFORE

Accessory
Water Source



Refrigerator
(Ice Maker Connection)



AFTER

Accessory
Water Source



DRINKPOD

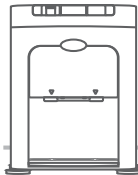

Refrigerator
(Ice Maker Connection)



Diagram 2.1.1-B Accessory Water Line Source (Connected, 1 Accessory Appliance)

Getting Started



Example Installation #1.3

Accessory Water Line Source - 2x Accessory Appliances

BEFORE

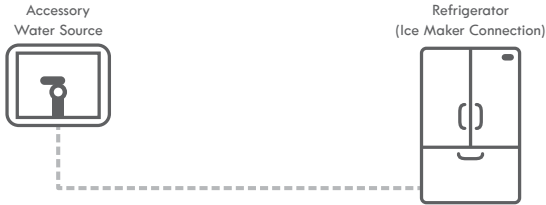

AFTER

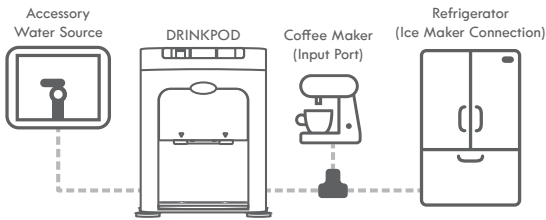

Diagram 2.1.1-C Accessory Water Line Source (Connected, 2 Accessory Appliances)

Sink Faucet Cold Water Line Configurations



Example Installation #2.1

Sink Faucet Cold Water Line Source

BEFORE

Sink Faucet Water Source
(Under Kitchen Sink)



AFTER

Sink Faucet Water Source
(Under Kitchen Sink)



DRINKPOD
(Sink Faucet Connection)

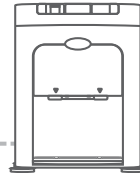

Diagram 2.1.2-A Faucet Cold Water Line Source (No Accessory Appliances)

Getting Started



Example Installation #2.2

Sink Faucet Cold Water Line Source - 1x Accessory Appliance

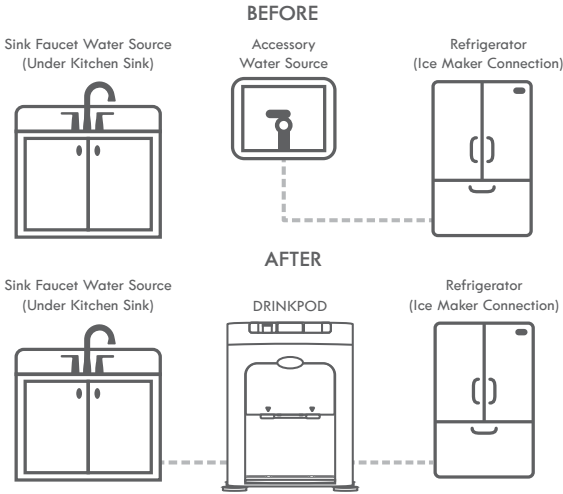

Diagram 2.1.2-B Faucet Cold Water Line Source (1 Accessory Appliance)



Example Installation #2.3

Sink Faucet Cold Water Line Source - 2x Accessory Appliances

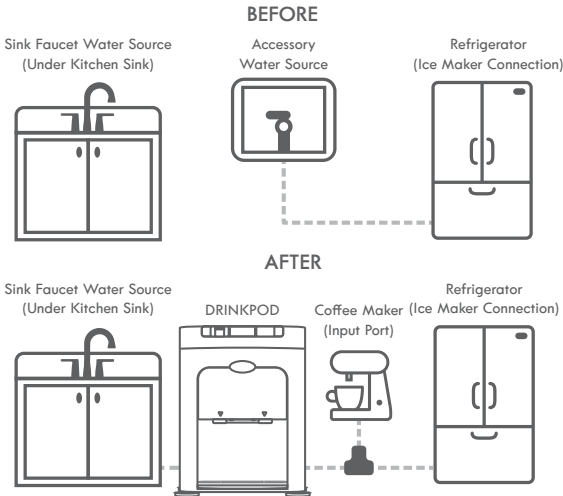

Diagram 2.1.2-C Faucet Cold Water Line Source (2 Accessory Appliances)

Getting Started

Alternative Configuration



Example Installation #3

Accessory Water Line Source - Low Pressure Alternative

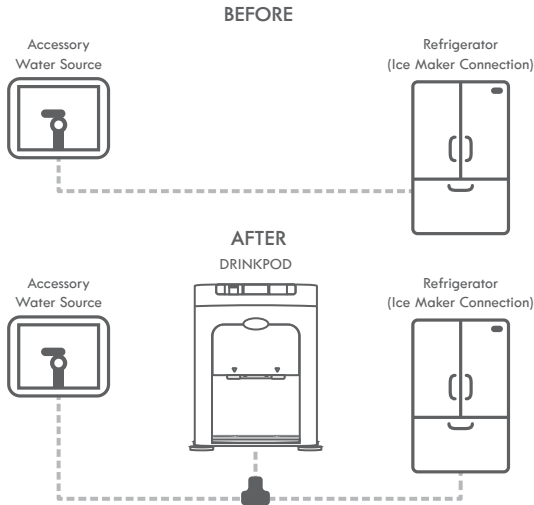

Diagram 2.1.3 Low Water Pressure Alternative (Shared in Parallel)

4. It's almost time to choose **where** to install your new DRINKPOD 2000. You should have a pretty good idea based on available space and whichever configuration you selected. There's only one remaining factor you need to consider, and that is your tubing (water lines).
5. Your water source, DRINKPOD, and any accessory appliances all need to be connected by the **white 1/4 in. PP tubing (included in your installation kit)** or existing water line hose. Take a moment to visualize where you'll need to run your water tubing, and visually inspect any potential trouble areas, and adjust your plans accordingly. Below are two examples:
 - A. Cabinets separating your DRINKPOD from a water source or appliance, requiring you to route tubing over/under, or drill holes.
 - B. Lack of vertical access from your water source under your sink to above your counter-top, requiring drilling holes to run the tubing inside your cabinets, or through your counter-top.

Congratulations, the most difficult part is out of the way! Let's get started

Getting Started

Preparation

Before we start tapping your water source, there are a few items you need to grab that weren't included in your installation kit.

- Sharp Knife or Scissors
- Pliers, or Adjustable Wrench, or Open-End 7/16 in. Wrench (all installations), 1/2 in. Wrench (most installations), and 11/16 in. Wrench (*sink water source installation only)
- Container To Drain Water Into (i.e. bucket, bowl, or pitcher)
- Flashlight or Lamp (if under sink installation area is poorly lit)
- Drill (if drilling holes to run tubing is required)



Diagram 2.0.1 Additional Items Needed For Installation

1. Remove the DRINKPOD and filters from the packaging and set them aside.
2. Let's get started. If your plan is to utilize your Accessory Water Line as your source, proceed to **Option A** (Accessory Water Line). If you plan to use your sink's cold water line, turn to "[Option B: Tapping Faucet Cold Water Line](#)" on page 2-5.

Installing Your Drinkpod

Tapping Water Source



Option A: Tapping Accessory Water Line

In this section, you will require **1/4 in. White PP Tubing**, and may also need **B** **1/4 in. Compression To Quick Connect Adapter**, and pliers, or an adjustable wrench or 1/2 in. wrench.

1. If **nothing is currently connected to your water accessory line**, skip forward to **Step #7 on page 2-3**.
2. If **appliance is connected to water accessory line**, start by powering off and unplugging the appliance.
3. Pull the refrigerator (or other appliance) away from wall sufficiently to allow access to wall and floor behind it.



Diagram 2.3A.3 Pulling Back Appliance To Access Water Source Line & Valve

4. In most scenarios, your shutoff valve and connection will look similar to the first diagram below. We've also included the second and third most common setups in the preceding diagrams. The instructions should remain accurate, regardless of which setup yours is, as long as it incorporates a shutoff valve. Should the latter not be the case, you will have to locate the shutoff valve before proceeding.

Installing Your Drinkpod

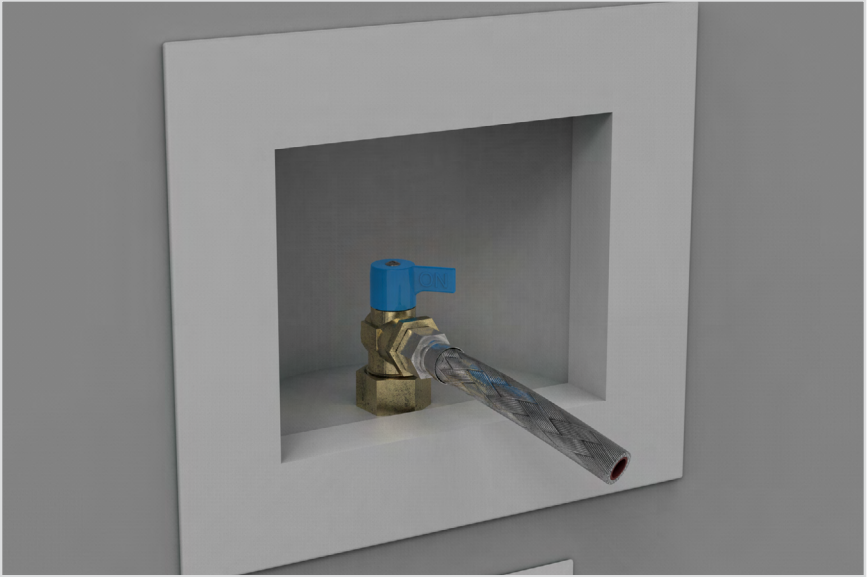

Diagram 2.3(A),4-A Wall Mounted Accessory Water Line Source

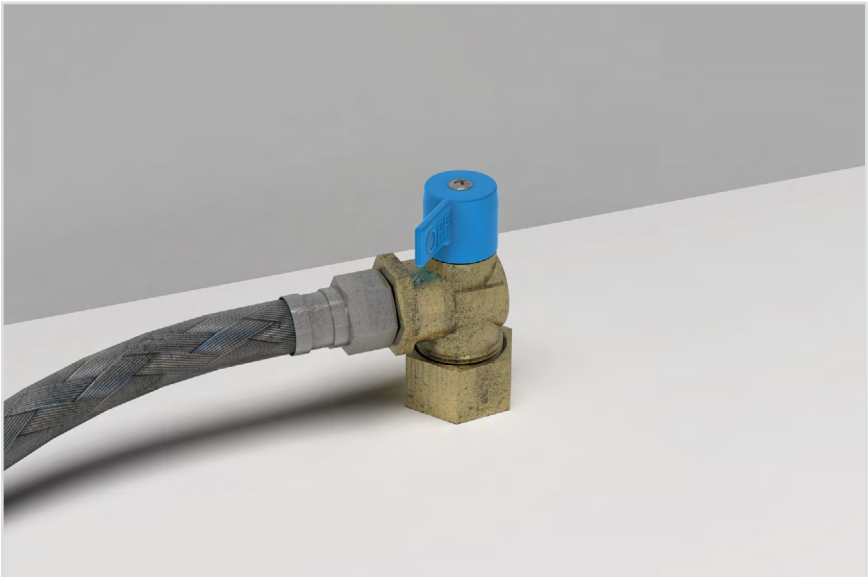

Diagram 2.3(A),4-B Floor Mounted Accessory Water Line Source

Installing Your Drinkpod

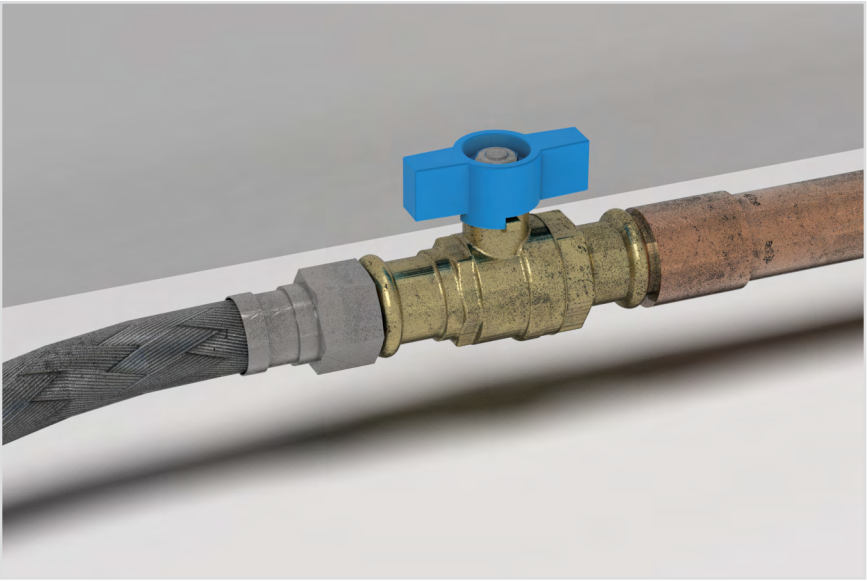

Diagram 2.3(A).4-C Unmounted/Free Accessory Water Line Source

5. Turn the valve handle clockwise until it stops to shut off water flow.

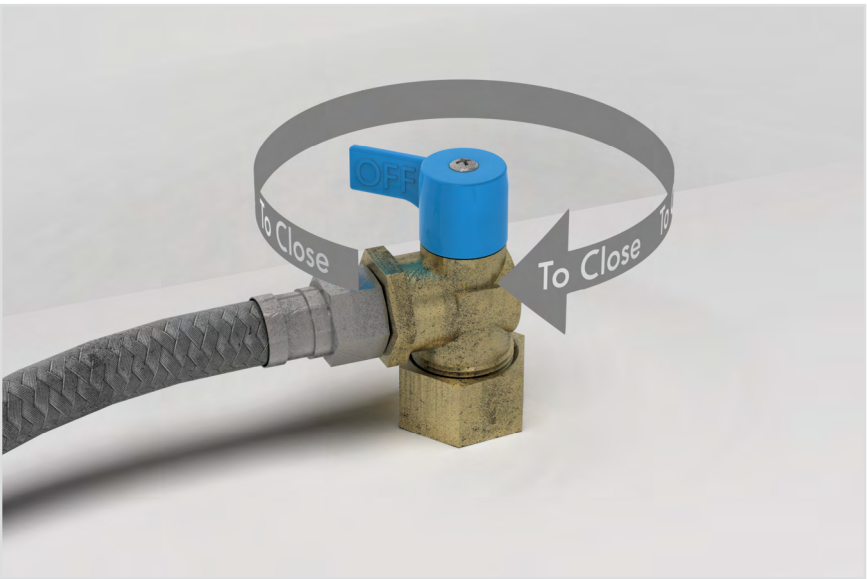

Diagram 2.3(A).5-A/B Closing Source Valve

Installing Your Drinkpod

6. Now, use pliers, adjustable or 1/2 in. wrench, to disconnect the appliance water line from the source shutoff valve. If you're unsure how to disconnect the water line, see [“Appendix B - Component Connections”](#) on page App-4. If its already adapted to quick connect (see) leave the adapter, and disconnect the tubing.

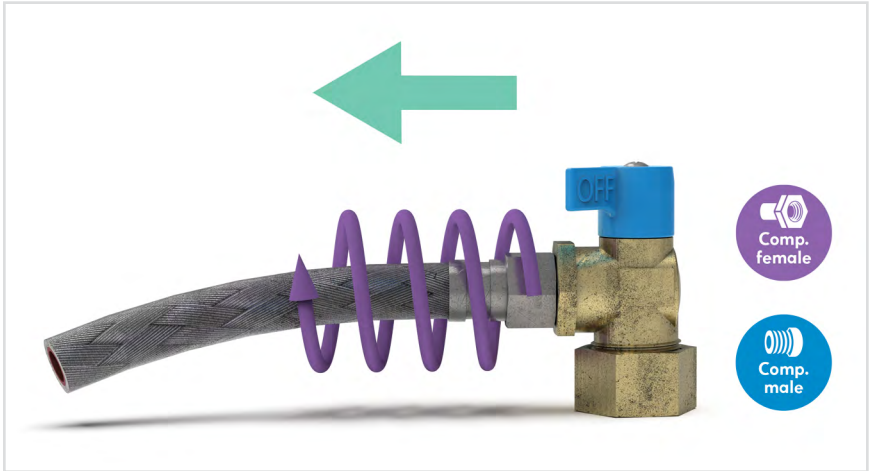

Diagram 2.3(A).6-A Disconnect Appliance Water Line (Compression)

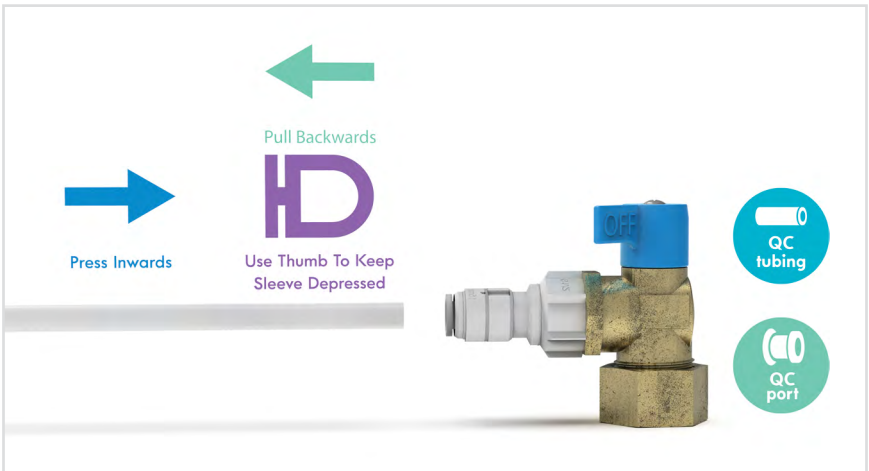

Diagram 2.3(A).6-B Disconnect Appliance Water Line (Quick Connect)

7. If the water source shutoff valve isn't already Quick Connect, connect **B** 1/4 in. [Compression To Quick Connect Adapter](#) to Accessory Water Line Shutoff Valve.

Installing Your Drinkpod

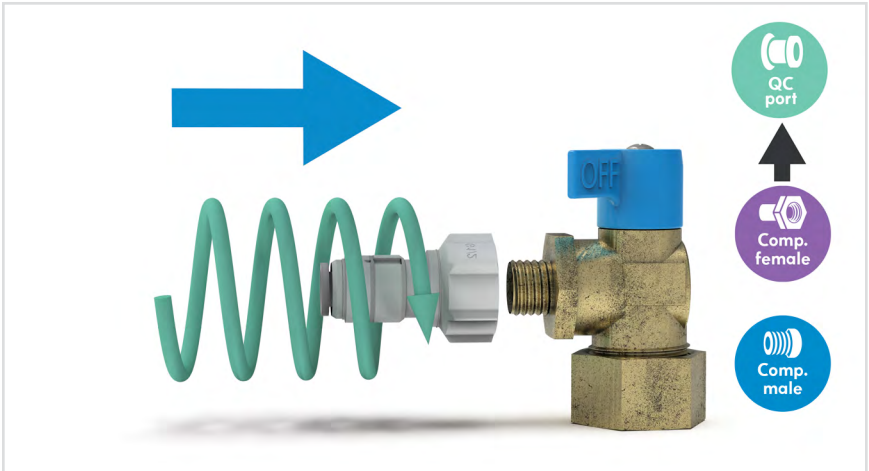

Diagram 2.3(A).7 Connect Compression-To-Quick Connect Adapter

8. Connect one end of **1/4 in. White PP Tubing** to **B**
1/4 in. Compression To Quick Connect Adapter.

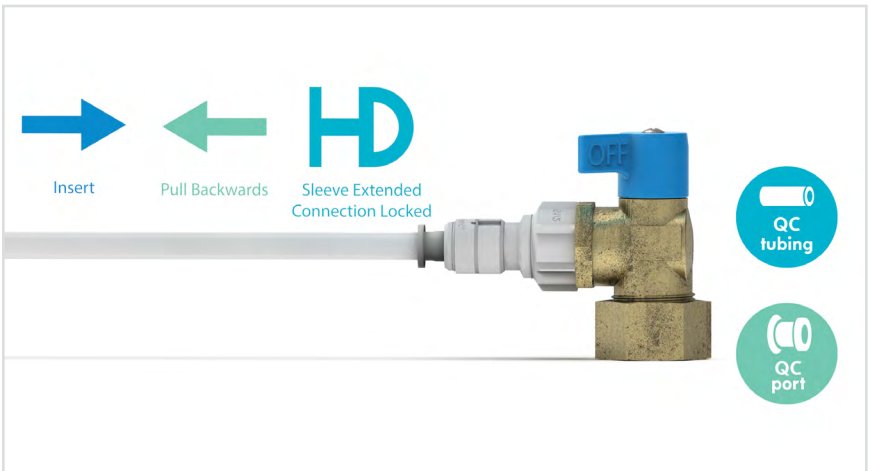

Diagram 2.3(A).8 Connect Tubing To Water Source

9. Congratulations! You've just completed the second most difficult part of your installation. Now jump ahead to **“Running Water Source Line Step #4”** on page 2-23.

Installing Your Drinkpod



Option B: Tapping Faucet Cold Water Line

1. For this section, you will need **F** 3/8 in. Sink Adapter Valve, as well as pliers, a crescent wrench, or 7/16 in. and 11/16 in. open ended wrenches (see “Preparation” on page 1-8).



Diagram 2.3(B).1 Connect Compression-To-Quick Connect Adapter

2. Open your cabinet doors to reveal the plumbing underneath your sink. **Don't get overwhelmed by all the piping and connections.** We've provided a diagram with labels to help you understand what you're looking at (accurate for most under sink setups). The blue items listed below are the ones that we'll be working with.

KS-A:	Drains
KS-B:	Hot Faucet Handle
KS-C:	Hot Water Feed Line
KS-D:	Hot Water Shutoff Valve
KS-E:	Faucet
KS-F:	Cold Water Shutoff Valve
KS-G:	Cold Water Feed Line
KS-H:	Cold Faucet Handle
KS-I:	Garbage Disposal

Installing Your Drinkpod

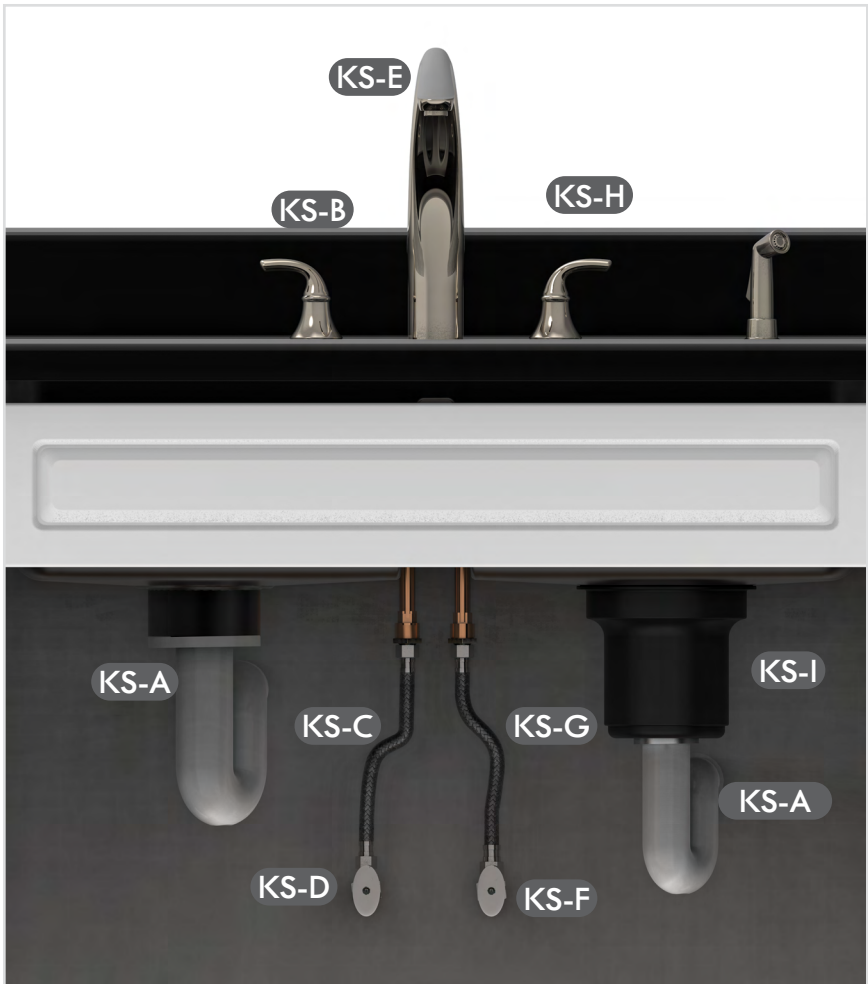

Diagram 2.3(B).2 Under Sink Reference Diagram

3. We will be tapping the cold water line, which is typically on the right, but its always smart to confirm the plumber didn't take any 'creative liberties'. Begin by turning on the cold water at your faucet **KS-H** .

Installing Your Drinkpod



Diagram 2.3(B).3 Turn On Cold Water In Sink

4. Now turn the handle of **KS-F Cold Water Shutoff Valve** clockwise until it won't turn any further. If your faucet stops pouring water, we've confirmed this is your cold water shutoff. If it doesn't turn off, then it is the valve on the left.



Diagram 2.3(B).4 Shutoff Cold Water Source Valve

5. Use our pliers, crescent wrench, or 11/16 in. wrench to loosen **KS-G Cold Water Feed Line** from **KS-F Cold Water Shutoff Valve**. **IF THE WRENCH FITS**, continue to loosen and detach the hose, and proceed. **IF IT DOESN'T FIT**, the

Installing Your Drinkpod

connection is almost certainly a 1/2 in. (Nominal/NPT) fitting. If you have a 15/16 in. and a 1 in. wrench, you can check to confirm by attempting to loosen the connection (there is 1/16 in. range of variance between different plumbing fittings). **IF THAT DOESN'T FIT, you have an extremely rare setup, and should contact a plumber.** IF THE LARGER WRENCH DOES FIT, we don't provide 1/2 in. adapter in your kit (only 2.5% of our customers require it), but we'd be more than happy to ship you one for free upon request. Call us at [1-844-374-6576](tel:1-844-374-6576), or email us at support@drinkpod.com. Or, if you don't want to wait, you can pick one up at your local hardware store. Ask for a 1/2 in (FIP) x 1/2 in. (MIP) x 1/4 in (OD) Push-to-Connect Angle Stop Adapter Valve.

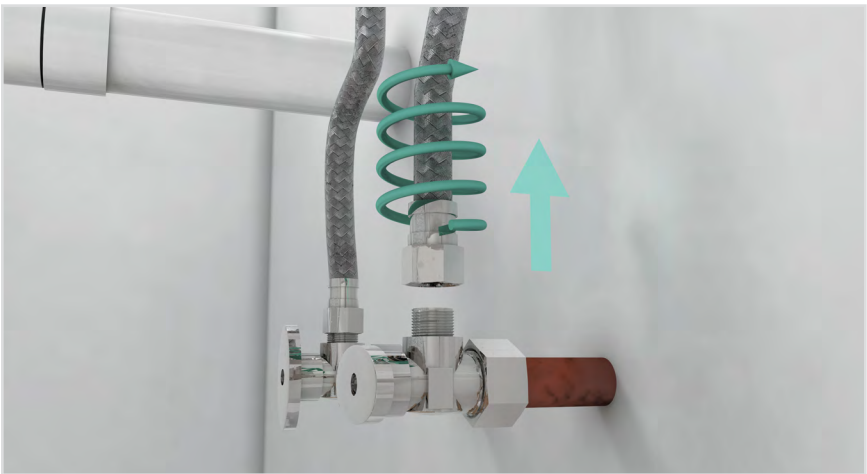

Diagram 2.3(B).5 Detach Cold Water Feed Line

- Next, screw the bottom (female) end of **F** 3/8 in. Sink Adapter Valve to the top (male) end of **KS-F** Cold Water Shutoff Valve using your hand. Then tighten using medium force with the same wrench (11/16 in.) you used to remove **KS-G** Cold Water Feed Line.

Installing Your Drinkpod

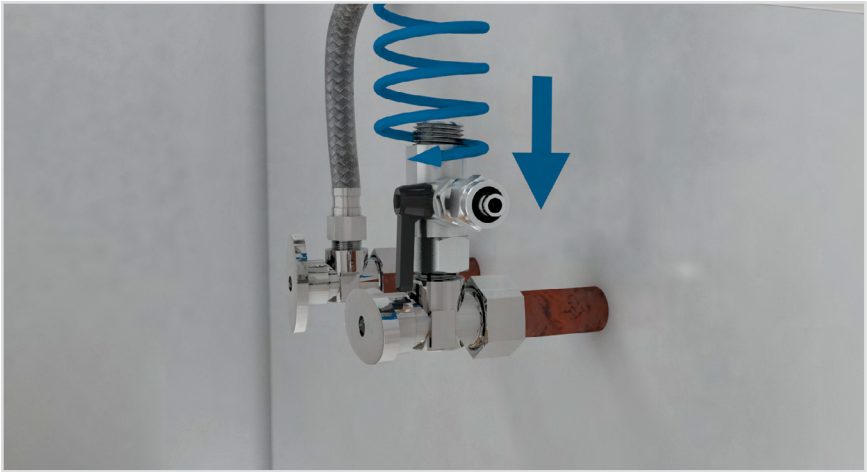

Diagram 2.3(B).6 Attach Sink Adapter Valve To Cold Water Shutoff Valve

- Now using your hand, screw the (female) end of **KS-G Cold Water Feed Line** onto the top (male) end of **F 3/8 in. Sink Adapter Valve**, and use wrench to tighten using medium force.

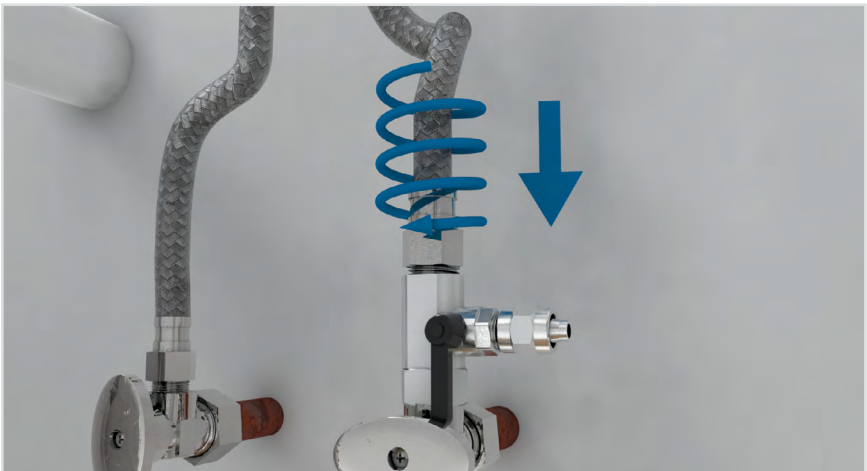

Diagram 2.3(B).7 Attach Cold Water Feed Line To Sink Adapter Valve

- Let's confirm there are no leaks. Check to make sure the valve on part **F 3/8 in. Sink Adapter Valve** is closed (pointing downward as shown above). Next, open the flow on **KS-F Cold Water Shutoff Valve** by repeating "**Step 4**" on page

Installing Your Drinkpod

1-1. Water should pour from faucet, and nothing should be no leaking below. If there are leaks, tighten connections with wrench, then turn off **KS-H** faucet and proceed.

9. With your hand, unscrew and remove the compression nut from the side of **F** **3/8 in. Sink Adapter Valve**.

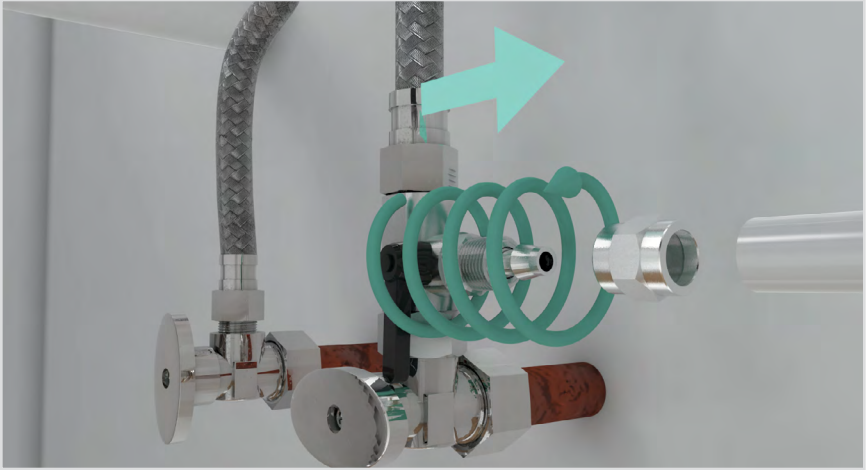

Diagram 2.3(B).9 - Unscrew Compression Bolt From Sink Adapter Valve

10. Uncoil end of **1/4 in. White PP Tubing**, and thread through the small end of nut.

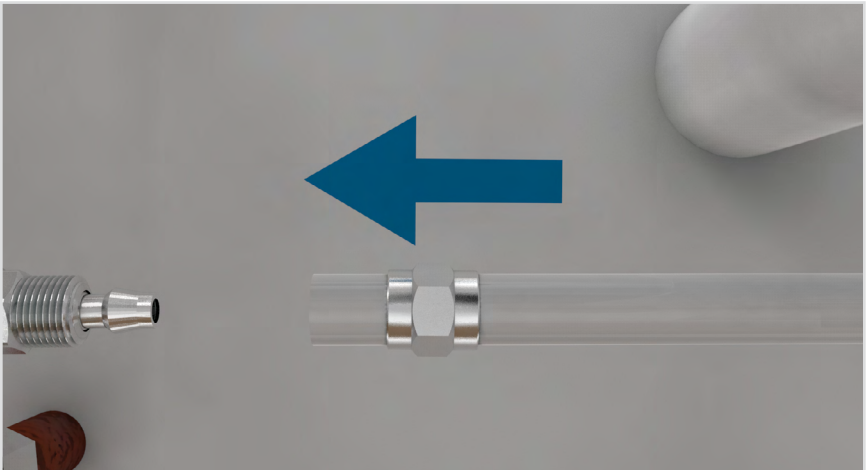

Diagram 2.3(B).10 - Thread Tubing Through Compression Nut

Installing Your Drinkpod

- Now stretch the same end of **A** 1/4 in. White PP Tubing over the 'nipple' of **F** 3/8 in. Sink Adapter Valve's side connection until it butts up against the threads. This may require pressing very firmly and twisting back and forth.

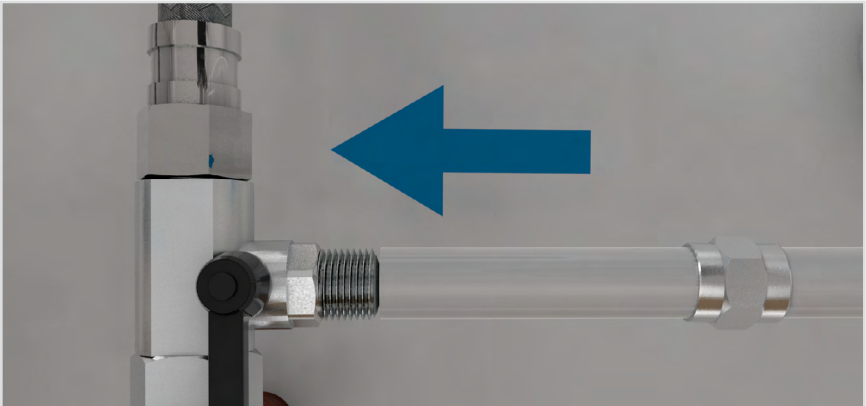

Diagram 2.3(B).11 - Stretch/Press Tubing Over Sink Adapter Valve Compression Nipple

- Using your hand to screw nut back onto threads of **F** 3/8 in. Sink Adapter Valve, then tighten with pliers, or 7/16 in. wrench.

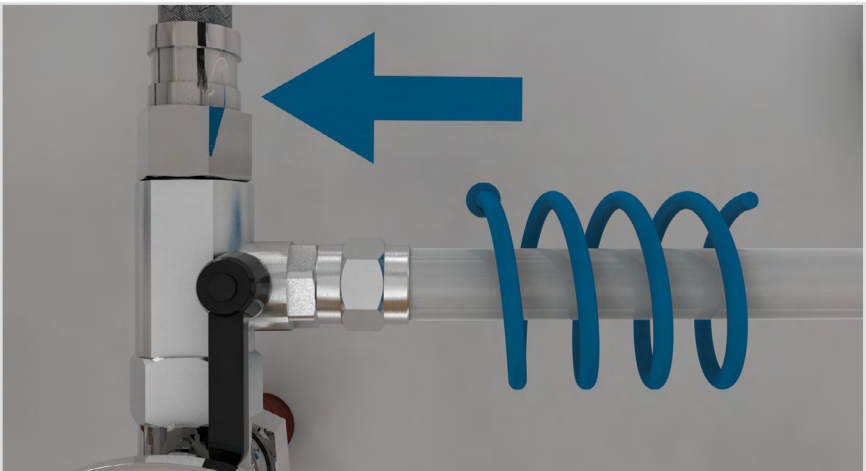

Diagram 2.3(B).12 - Screw Compression Nut Back Onto Sink Adapter Valve

Congratulations! You've just completed the second most difficult part of your installation. Now jump ahead to ["Running Water Source Line Step #4"](#) on page 2-23.

Installing Your Drinkpod

Running Water Source Line

It's time to run your water line (tubing) from your water source to where your DRINKPOD will be placed. For this section, you will require

1. Uncoil and run **A** **1/4 in. White PP Tubing**, from where its connected (to your water source) to wherever you intend to locate your DRINKPOD. Make any necessary adjustments (i.e. drilling holes) as you go.
2. Once you have the water line tubing ran all the way to where your DRINKPOD will be placed, measure out a 1 - 2 ft. of additional tubing. You want to ensure you have sufficient slack to pull the DRINKPOD away from the wall for maintenance.
3. Cut the tubing using your scissors or knife. Be careful to cut the tubing straight across (at a 90 degree angle) to avoid leaks.

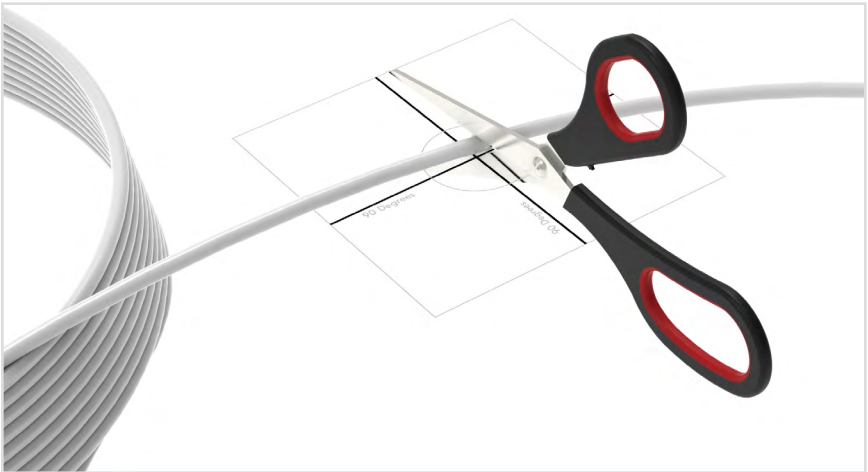

Diagram 2.4.3 Cut Tubing

4. You are ready to proceed to the next stage. If you plan to connect any other appliances to your DRINKPOD (i.e. refrigerator or coffeemaker) proceed to **“Connecting Accessory Appliances” on page 2-13**. Otherwise, proceed to **“Connecting Your DRINKPOD” on page 2-23**.



Installing Your Drinkpod

Connecting Accessory Appliances (Optional)

Alright! It's time to connect any additional appliances you want your new DRINKPOD 2000 to provide purified water to. These can include refrigerators (ice maker/water dispenser), stand alone ice makers, and coffee, espresso, or barista machines that support an in-line water feed. If you don't plan to connect any appliances, jump ahead to the next section [“Connecting Your DRINKPOD” on page 2-23](#).

Read this next paragraph thoroughly. The specific instructions required to complete the following steps differ broadly for each user, based on the type and number of connections. To simplify this, we've created icons to indicate **which instructions you should follow, and which you should ignore**. The first set of icons is in reference to the type of input connection available on your appliance(s), see [“Appendix B - Component Connections” on page App-4](#) for more details. The second set of icons reference your appliance accessories configuration (1, 2, or Parallel), covered in [“Accessory Water Line Configurations” on page 1-4](#).

INPUT CONNECTION TYPES

- A.  If your appliance has a [Quick Connect Tubing](#) hose running from (same as what was included with your DRINKPOD).
- B.  If your appliance is equipped with a [Quick Connect Port](#) (similar to ports on the back of your DRINKPOD 2000).

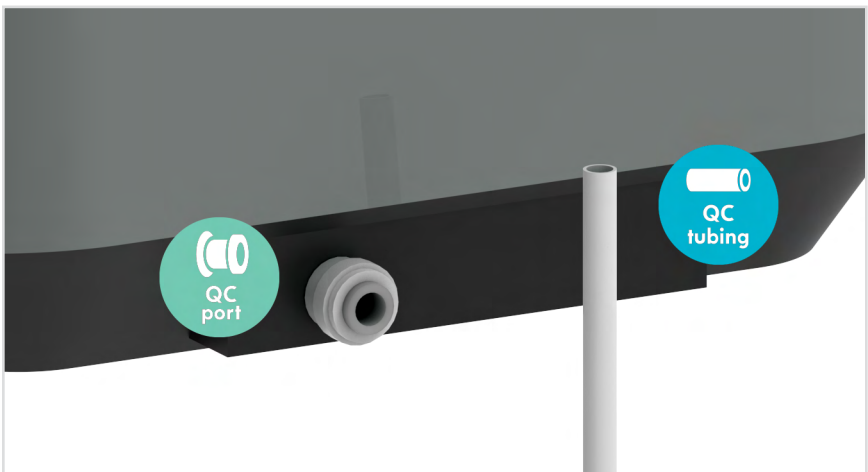



Diagram 2.6.0-A/B - Quick Connect Port & Tubing Examples

Installing Your Drinkpod

- C.  If your appliance is equipped with a **Male Compression Port** or (threaded connection like a hollow bolt, can be metal or plastic).

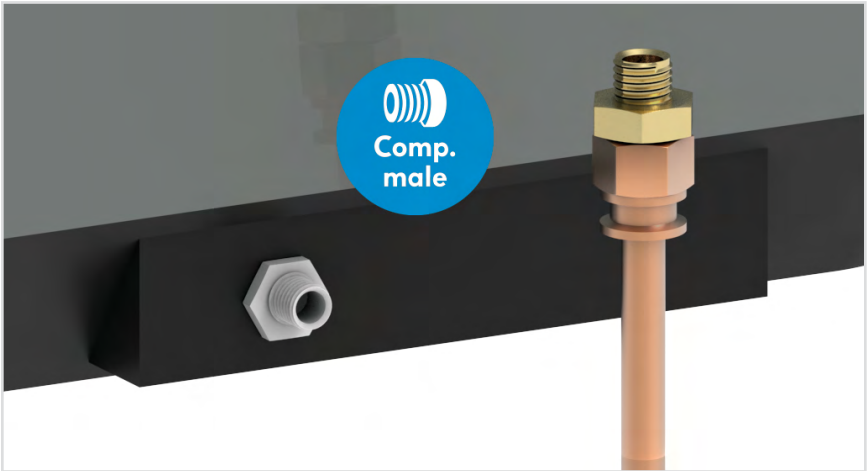



Diagram 2.6.0-C - Male Compression Port Example

- D.  If your appliance is equipped with either a **Female Compression Port** or **Hose** (threaded connection like an attached nut, can be metal or plastic).

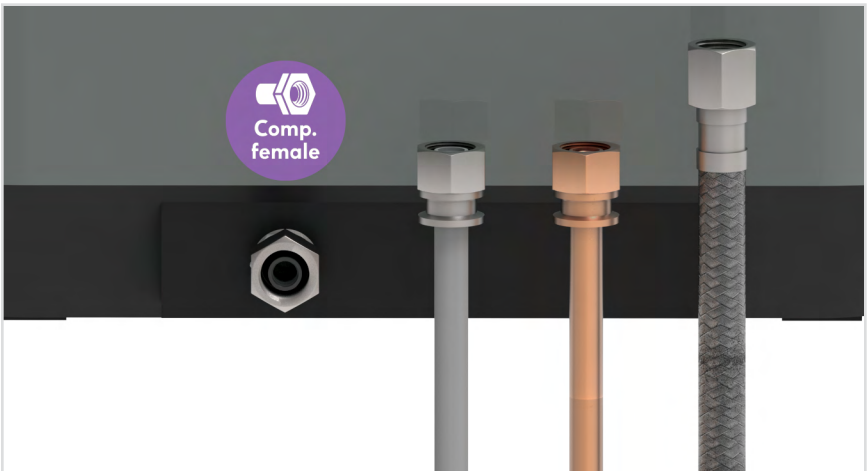





Diagram 2.6.0-D - Female Compression Port & Hose Examples

Installing Your Drinkpod

CONFIGURATION OF ACCESSORIES

- A.  If you are only connecting **1 Accessory Appliance**.
- B.  If you are connecting **2 Accessory Appliances**.
- C.  If you have low water pressure and require the **Parallel Configuration** (see below).

For safety reasons, we recommend powering off and unplug the appliances you want to connect.

NOTE REGARDING LOW WATER PRESSURE



While it is not typical, be aware that sufficient water pressure is required for the optimal experience. Insufficient water pressure to your DRINKPOD 2000 will degrade outgoing water flow, and in rare worst cases, even prevent the feature from functioning. If you experience any of these issues, we recommend speaking with a professional plumber.

*If your water pressure cannot be resolved, we do offer an Alternative Ice Maker Configuration for users that have chosen a Accessory Water Line as their source. This **“Alternative Configuration”** (see page 1-7) allows the water flow to be shared, rather than daisy-chained.*

Identify

1. If you haven't already, look at the back of your appliance(s), and identify which of the above listed connection(s) you will be connecting to. Only follow the directions with the relevant icon(s), and skip the others.

Location

2.  If you are planning to have **2 Accessory Appliances**, you will be connecting both to  **1/4 in. Brass Compression Tee** first, and then connecting that to **Accessory Output Port** (see **Use & Care Guide** or **In/Out sticker on bottom rear corner of right exterior panel**) on your DRINKPOD 2000. You can locate where they connect to the Brass Compression Tee wherever is most convenient. Just be sure to allow enough length when cutting sections of  **1/4 in. White PP Tubing**. Also, if your appliance has a hose (rather than port) that isn't long enough to reach, follow the instructions below for **“Extending”** on page 2-17.

Installing Your Drinkpod



If your low water pressure requires a **Parallel Configuration**, you will be connecting your DRINKPOD and refrigerator (or whatever other appliance was originally connected to your water source) first to **E**

1/4 in. Brass Compression Tee, and then connecting this to the water source. You can locate where they connect to the Brass Compression Tee wherever is most convenient.

Just be sure to allow enough length when cutting sections of **A**

1/4 in. White PP Tubing. Also, if your appliance has a hose (rather than port) that isn't long enough to reach, .

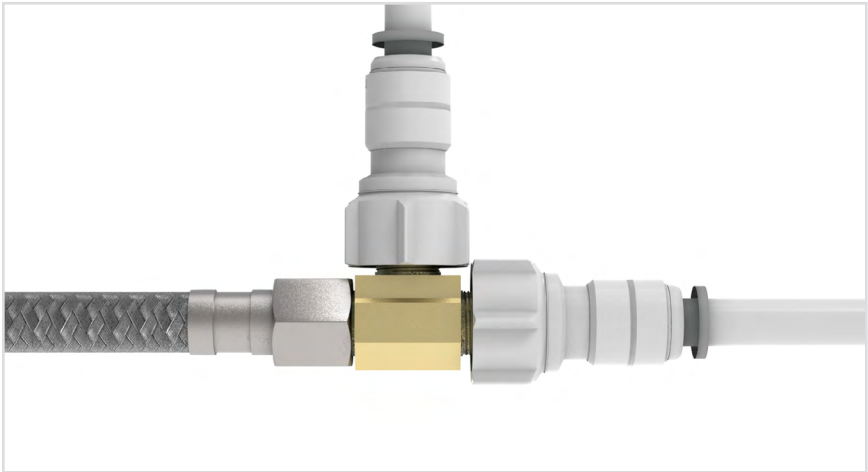



Diagram 2.6.2 - Example of Brass Compression Tee Used As Hub

Adapting

-  If your accessory appliance(s) has a **Male Compression Port** or **Hose**, you'll need to convert it to Quick Connect. Screw **B**
1/4 in. Compression To Quick Connect Adapter clockwise tightly onto the port. From this point on, you will follow the  **Quick Connect Port** instructions for this appliance.

Installing Your Drinkpod

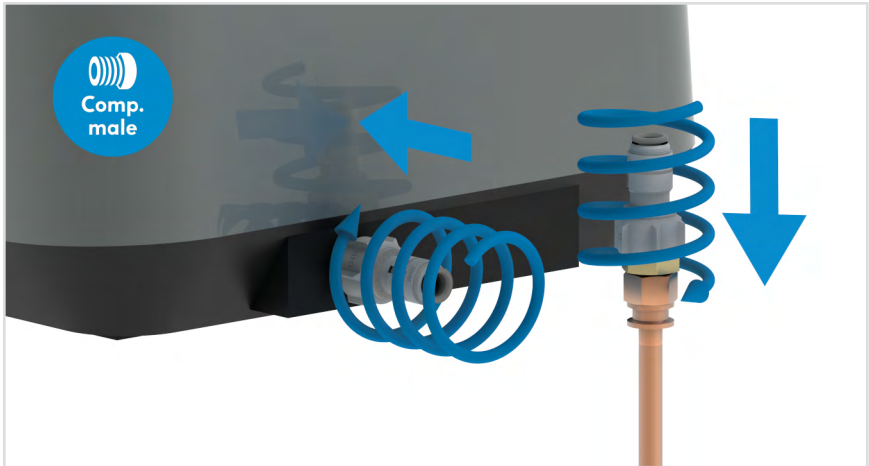

Diagram 2.6.3-A - Screw Compression To Quick Connect Adapter Onto Port or Hose

1x acc. For **1 Accessory Appliance Configurations**, you will need to run a section of **A 1/4 in. White PP Tubing** from your Accessory Appliance, directly to where you plan to locate your DRINKPOD 2000 (unless the appliance already has an integrated **QC Tubing** Quick Connect Tubing hose you plan to use instead). Finish by connecting the other **C 1/4 in. Quick Connect Shutoff Valve** to the end of the tubing or hose that will connect to your DRINKPOD. It should look like this:

1x acc. **HOSE/PORT > ADAPTER** (if necessary) **> TUBING** (if necessary) **> SHUTOFF VALVE** (where DRINKPOD 2000 will be located)

Once you've completed this, jump ahead to **"Connecting Your DRINKPOD" on page 2-23.**

Comp. female If your Accessory Appliance's port or hose is **Female Compression**, use **D 1/4 in. Brass Compression Union** to adapt the port/hose to the **1/4 in. White PP Tubing** line (referenced above). Instructions for this are including in the following step and **"Diagram 2.6.4-B" on page 1-1.**

Extending

4. If your appliance has a port (rather than a hose), or a hose that will not reach sufficiently far, follow the relevant directions below.

Installing Your Drinkpod

To extend **QC tubing**, use **D** 1/4 in. Brass Compression Union and 2x **B** 1/4 in. Compression To Quick Connect Adapters to connect the tubing running from your appliance to a section of **A** 1/4 in. White PP Tubing, as shown below.

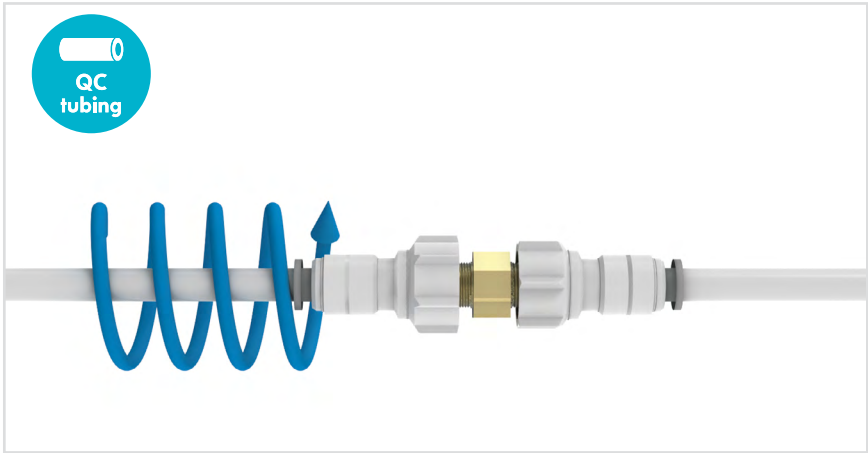

Diagram 2.6.4-A - Extending Quick Connect Tubing With Brass Compression Union

To extend from **QC port**, simply follow the usual method to connect one end of a section of **A** 1/4 in. White PP Tubing into the appliance's port using the normal method.

To extend from a **Female Compression Port** or **Hose**, simply screw it onto one end of a **D** 1/4 in. Brass Compression Union. Then, connect a **B** 1/4 in. Compression To Quick Connect Adapter to the other end, along with a section of **A** 1/4 in. White PP Tubing.

Installing Your Drinkpod

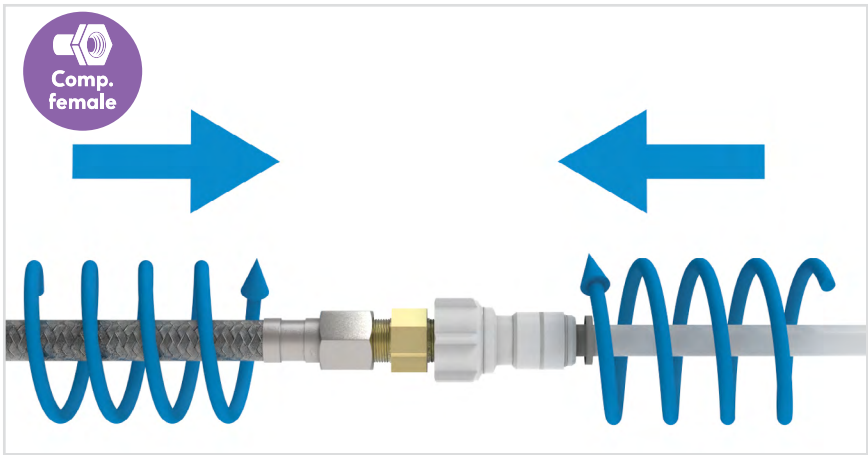

Diagram 2.6.4-B - Extending Female Compression Hose or Port With Brass Union

Merging

2x acc. **P acc.** This is where we will be connecting both appliances to **E** 1/4 in. **Brass Compression Tee**, then running a single merged line to the final destination. The instruction on how to connect both configurations are identical, only the ports each is connected to differ. Follow the relevant instructions for each connection below, using the specified ports of the diagrams that follow.

2x acc. **2 Accessory Appliance Configuration** will require another section of **A** 1/4 in. **White PP Tubing** connected through a **B** 1/4 in. **Compression To Quick Connect Adapter** to your **E** 1/4 in. **Brass Compression Tee**, with the other end running to your DRINKPOD 2000.

P acc. **Parallel Configuration** will use the existing line you ran from the Water Source at the beginning of the installation process. However, you will remove **C** 1/4 in. **Quick Connect Shutoff Valve** that you connected to our Water Source Line back at “**Running Water Source Line Step #4**” on page 2-23 - be sure to shutoff water flow at your source prior to disconnecting. You will also need an additional section of **A** 1/4 in. **White PP Tubing** to run from a **B** 1/4 in. **Compression To Quick Connect Adapter** connected to the **Brass Compression Tee** port specified in “**Diagram 2.6.5-B**” on page 2-21, and on to your DRINKPOD 2000. You will connect the **Shutoff Valve** to the other end of this line. Once all of this has been done, you can re-open your water source valve, and re-plug in and

Installing Your Drinkpod

power on your accessory appliance.



To connect **Quick Connect Tubing** to the **E 1/4 in. Brass Compression Tee**, unscrew the compression nut (from the port specified in the applicable diagram below), and thread the **Quick Connect Tubing** through it. Then, insert the **Quick Connect Tubing** into the threaded port of the **Brass Compression Tee**, and screw the compression nut back onto the port with your hand. Finally, tighten the connection with a 1/2 in. wrench or pliers.



To connect a **Female Compression Hose**, simply remove and set aside the compression nut (from the port specified in the applicable diagram below), and screw the **Female Compression Hose** directly onto the port, using a 1/2 in. wrench or pliers to tighten.

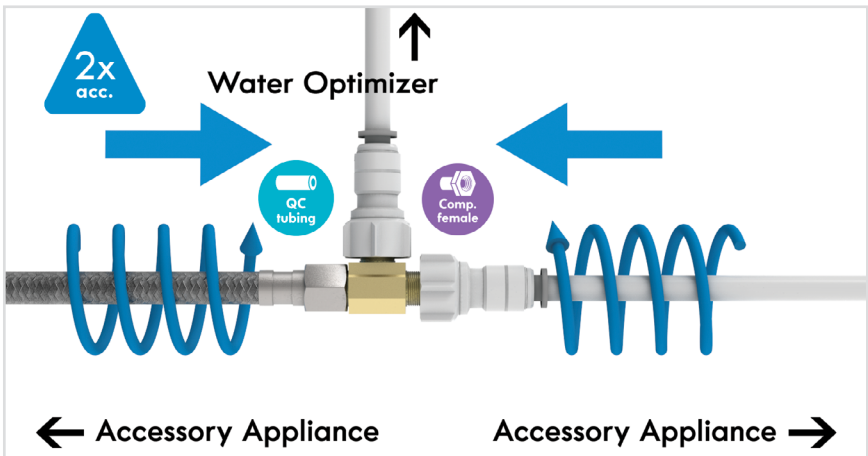

Diagram 2.6.5-A - Merging Connections to Brass Compression Tee For 2 Accessory Appliance Configuration

Installing Your Drinkpod

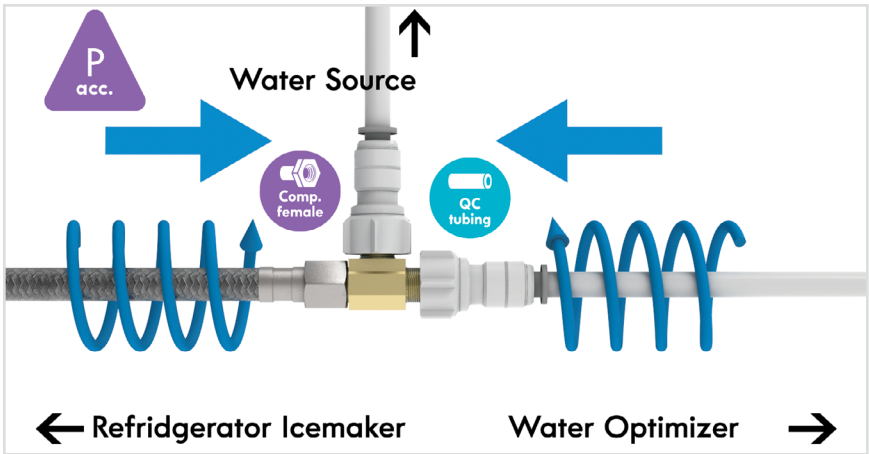

Diagram 2.6.5-B - Merging Connections to Brass Compression Tee For Parallel Configuration

Final Check

5. Your accessory appliances should be connected to **E** 1/4 in. Brass Compression Tee, and there should be a section of **A** 1/4 in. White PP Tubing running from there to where your DRINKPOD 2000 will be located, with **C** 1/4 in. Quick Connect Shutoff Valve attached to the other end.

P acc. Also, for **Parallel Configuration**, the section of **A** 1/4 in. White PP Tubing running from your Water Source should have the **Quick Connect Shutoff Valve** removed from it, and be connected to the top port of the **Brass Compression Tee**.

If all of the above is correct, you're ready to proceed to the next stage, "**Connecting Your DRINKPOD**" on page 2-23. If not, review the instructions and make any necessary corrections before proceeding. For 'visual' users, we've provided simplified reference diagrams to double check your work.

Installing Your Drinkpod

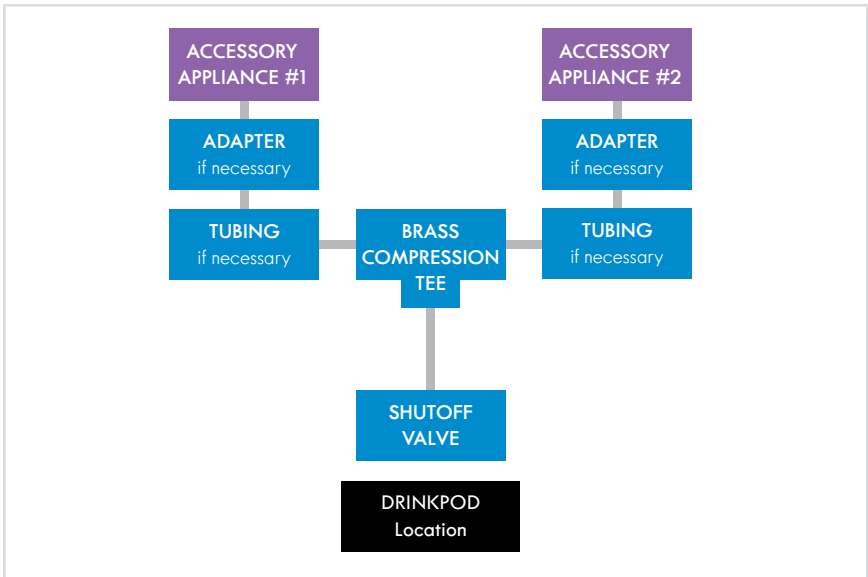

Diagram 2.6.6-A - Reference To Final Check For 2 Accessory Appliance Configuration

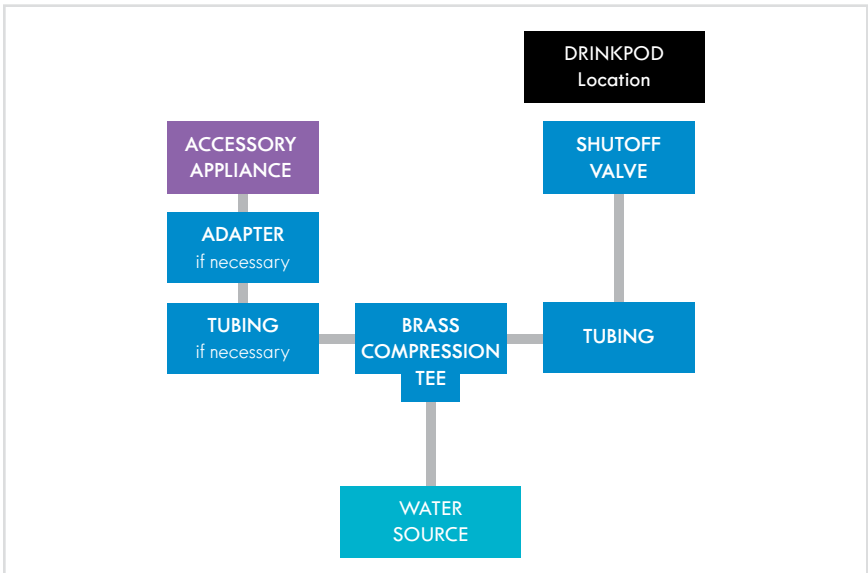

Diagram 2.6.6-B - Reference To Final Check For Parallel Configuration

Installing Your Drinkpod

Connecting Your DRINKPOD

Congratulations! You are now close enough to the end that you should be able to taste it.

You should now have a water line running from either **under your kitchen sink** or your **ice maker hookup** to wherever you plan on locating your new DRINKPOD 2000. From here on out, we will refer to this line as your **Source Line**.

If your **Ice/Coffee Connect** feature, you should also have another line from your Accessory Appliance, or **1/4 in. Brass Compression Tee** if you have 2 Accessory Appliances. We will refer to this as your **Accessory Line**.

1. Move your new DRINKPOD 2000 to its final location. Do not plug the power cord in yet.
2. Remove the plug from the **M** **Water Input Line**.
3. Insert the open end of **A** **1/4 in. White PP Tubing** (the small segment of tubing after the **C** **1/4 in. Quick Connect Shutoff Valve**) on your **Source Line** into the **M** **Water Input Line** attached at the end of located at the back of your DRINKPOD on the right side.

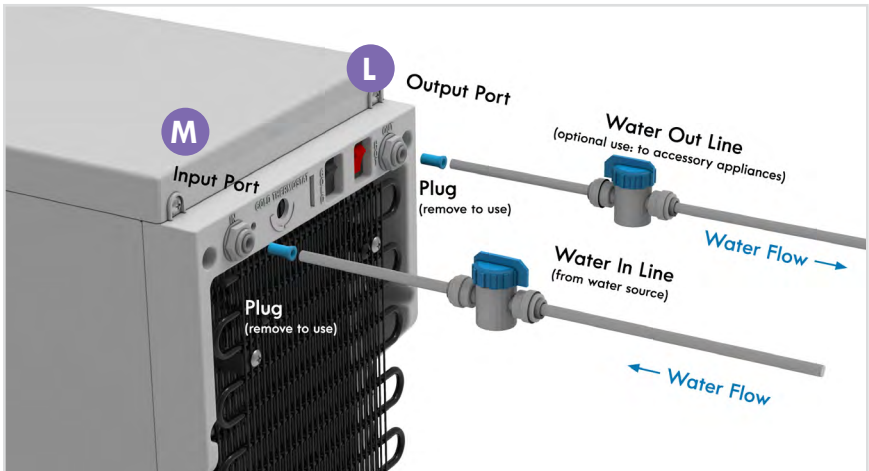

Diagram 2.7.1 - Connect Source Line To Source Input Port

4. Continue to firmly insert tubing into opening until it won't go any further. Then pull tubing backwards (away) from valve, using medium force, to engage/extend the compression sleeve on the valve, and ensure the connection is secured.

Installing Your Drinkpod

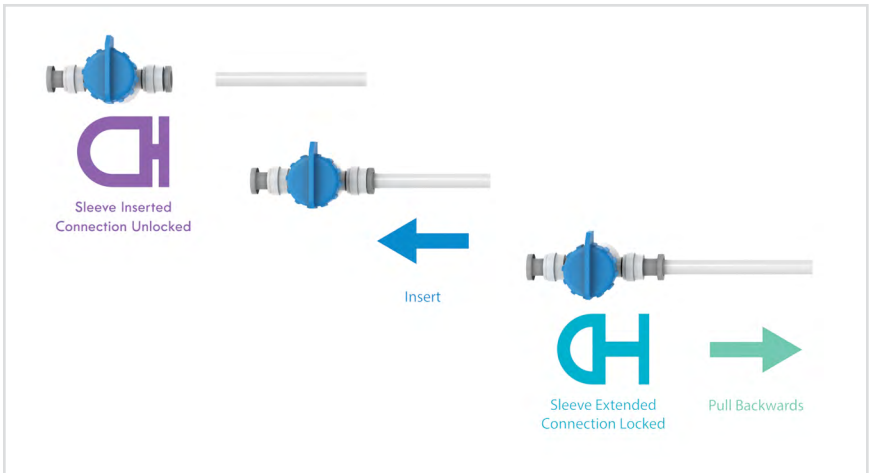

Diagram 2.7.3 Connect Tubing To Shutoff Valve

5. Make sure the valve handle is closed by turning it clockwise as far as it will go. When closed, the handle extends out perpendicular to the length of the shutoff valve.

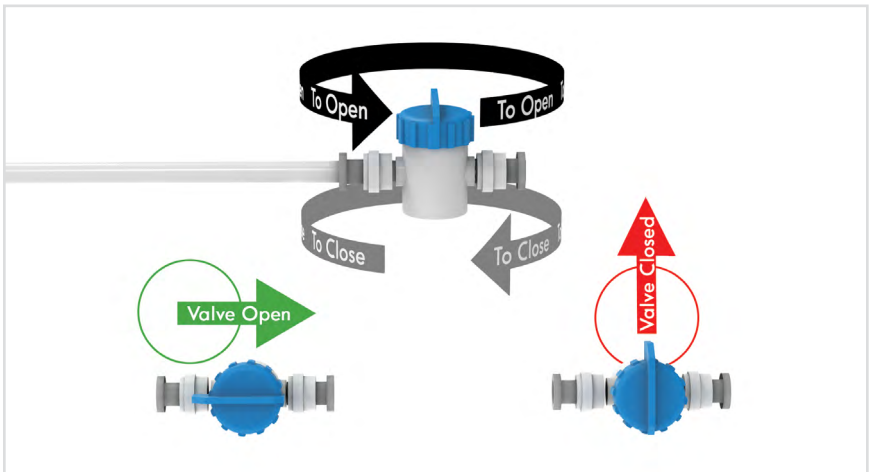

Diagram 2.7.4 Ensure Valve Is Closed

6. Turn on the water at your **Water Source** (see following diagrams). Confirm there are no leaks at any of your connections. If there are, turn off the water, reconnect correctly, and then turn water back on.

Installing Your Drinkpod

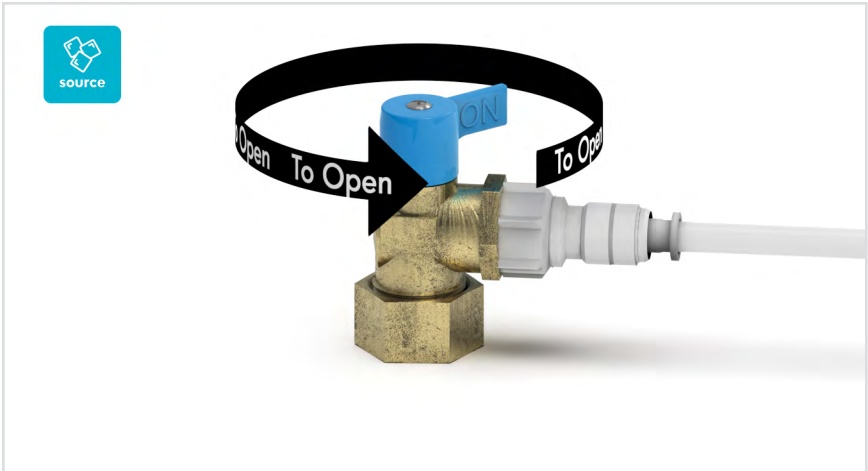

Diagram 2.75-A - Open Ice-maker Source

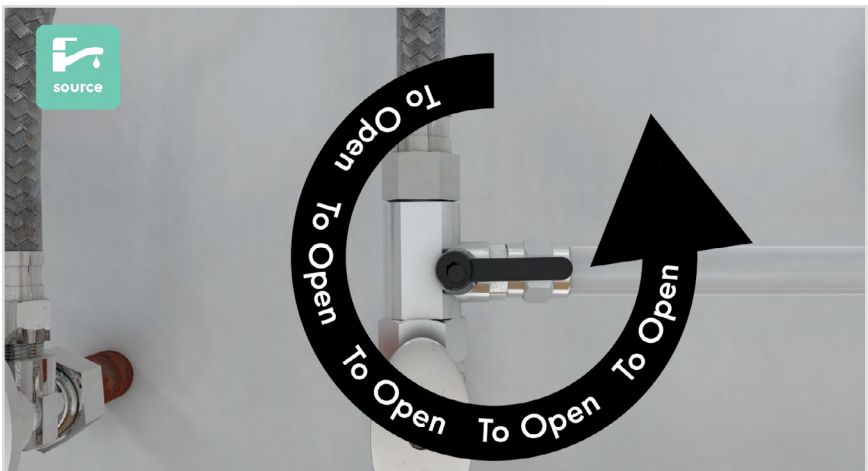

Diagram 2.75-B - Open Sink Source

- Now, if you're using the **Ice/Coffee Connect** feature, cut a small section of **A** 1/4 in. **White PP Tubing** (about 12 inches) and use it to connect the open end of the **C** 1/4 in. **Quick Connect Shutoff Valve** on your **Accessory Line** to your DRINKPOD's **L** **Output Port**.

Installing Your Drinkpod

Enabling Water Flow To Your Drinkpod

1. If it's not already open, start by opening your **Water Source Valve** (the valve on your existing water source we first shut off) see "[Turning On Your Water Source](#)" on page 2-24.
2. Ensure nothing is leaking between or at either of the valves.
3. Now open the valve on the **C** 1/4 in. Quick Connect Shutoff Valve on your **M** Water Input Line as shown below.

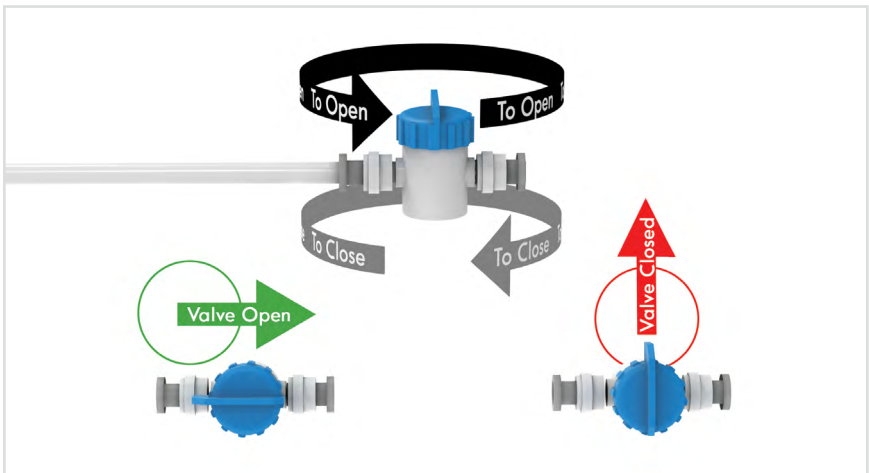

Diagram 2.9.3 - Open Shutoff Valve

4. You should hear water running and filling the DRINKPOD's tanks. Check for leaks, and wait until the sound of water running stops.
5. Once the DRINKPOD is filled, plug it in. **DO NOT FLIP ON THE POWER SWITCHES OR CONNECT ACCESSORY LINE YET!**
6. We need to flush each temperature mode. For the best experience, we recommend flushing the full tank capacity for both the **Hot Mode** and **Cold Mode**.

Installing Your Drinkpod

Flushing Your Filters

Certain types of filters require flushing prior to use. **This ensures any loose carbon particles in your filter media are discharged prior to drinking.** ALWAYS flush newly installed filters, prior to drinking. For your kit, the two specific filters that need flushed are

F1 Chemical Scrub and **F3** Polishing Scrub.

1. Place a container of water under one of the dispensers.
2. Proceed to dispense the full contents of each tank plus one gallon (to allow for the rest of the internal water system). See the total volume for each below.

Mode/Tank	Capacity To Flush
Cold (+ Reserve)	0.9 GAL (3.5 L) + 1.06 GAL (4 L) + 1 GAL (3.79 L) ≈ 3 GAL (11 L)
Hot	0.26 GAL (1 L) + 1 GAL (3.79 L) ≈ 2.5 GAL (9 L)

Enabling Water Flow From Your Drinkpod (Optional)

1. If you have connected accessory appliances, you can now open the **C** **1/4 in. Quick Connect Shutoff Valve** connected to your **Accessory Line**. Water should now start flowing into your accessory appliances. Check the lines, valve, and appliances for leaks.
2. Once you here the water stop flowing, you can plug your accessory appliances back in and power them on. **If possible, flush water through each for 1 minute.**

Powering On Your Drinkpod

Congratulations! You're finished! You may now proceed to power on your DRINKPOD. For details on how to use and maintain your Drinkpod, [see the Use & Care Guide for instructions.](#)

Appendixes

Appendix A - Water Sources

Accessory Water Line Source - Wall Mounted

Shutoff water by turning valve handle clockwise (usually 90 degrees).

Disconnect water line by unscrewing compression bolt counterclockwise.

Connect new water line with either...

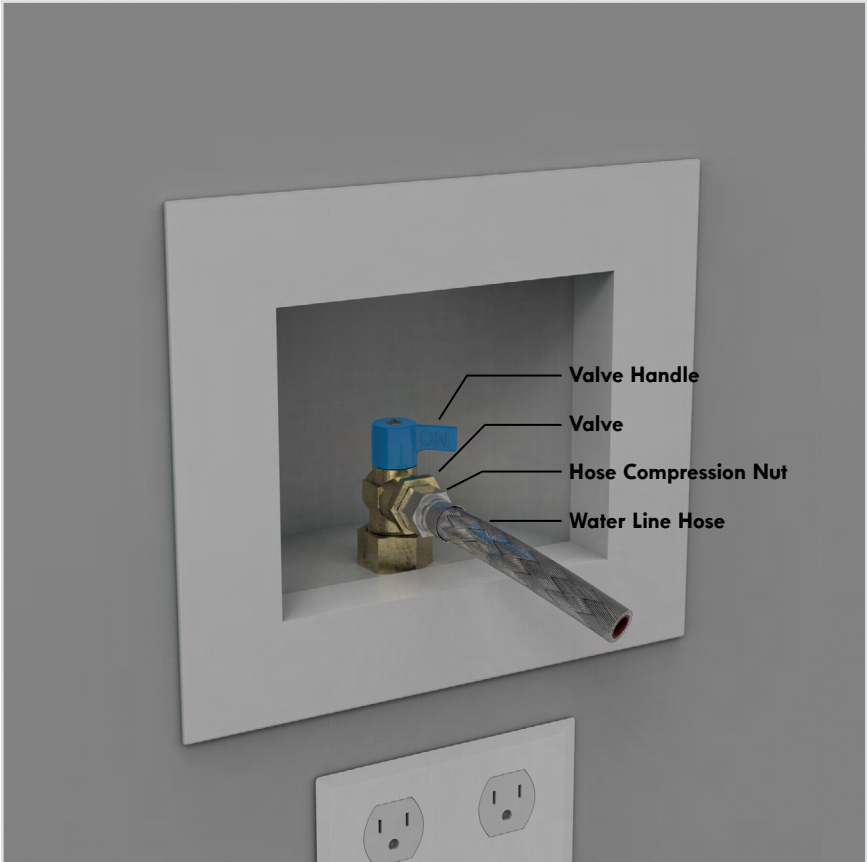

Appendixes

Accessory Water Line Source - Floor Mounted

1. Shutoff water by turning valve handle clockwise (usually 90 degrees).
2. Disconnect water line by unscrewing compression nut counterclockwise.
3. Connect new water line with either...

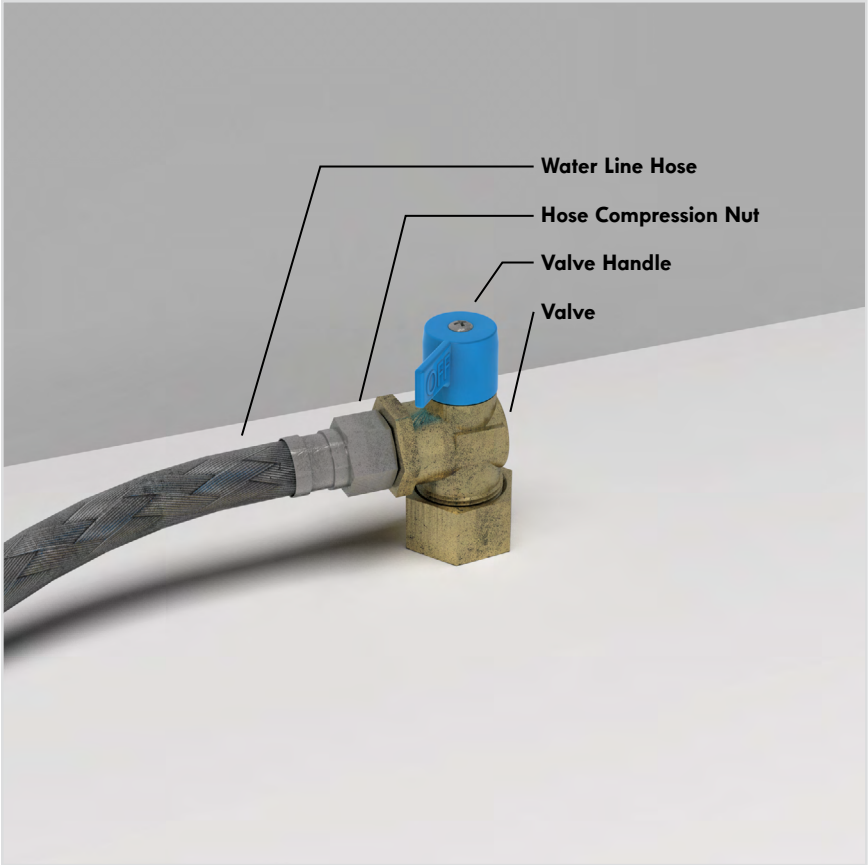

Appendixes

Accessory Water Line Source - Unmounted

1. Shutoff water by turning valve handle clockwise (usually 90 degrees).
2. Disconnect water line by unscrewing compression bolt counterclockwise.

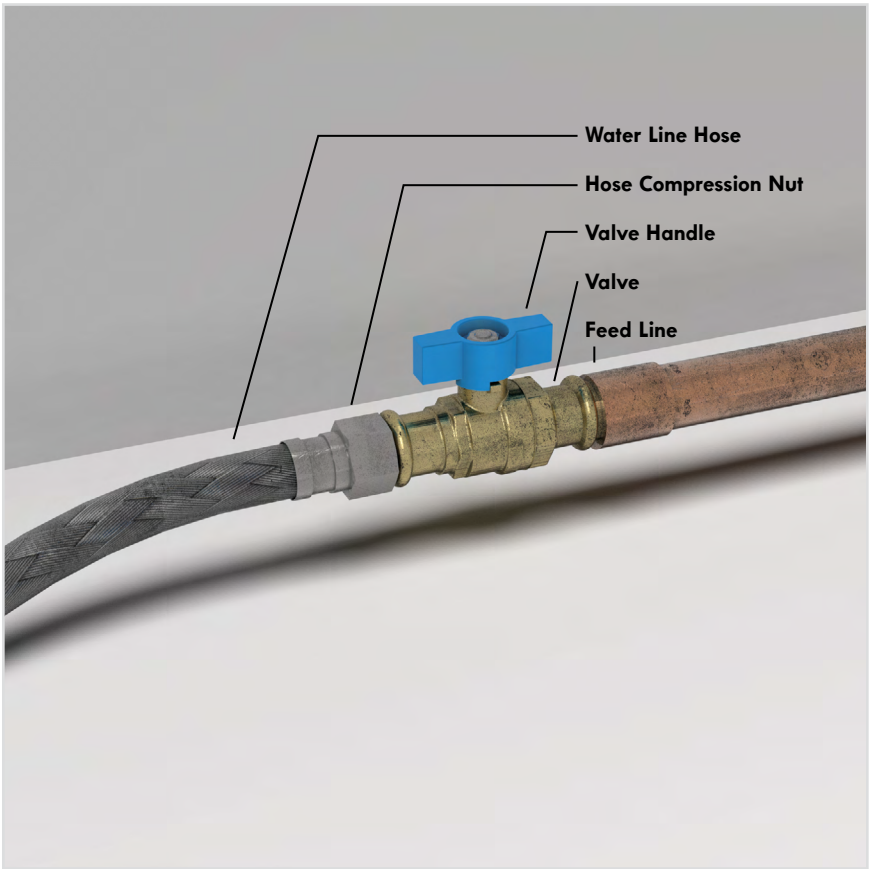

Appendixes

Faucet Cold Water Line Source

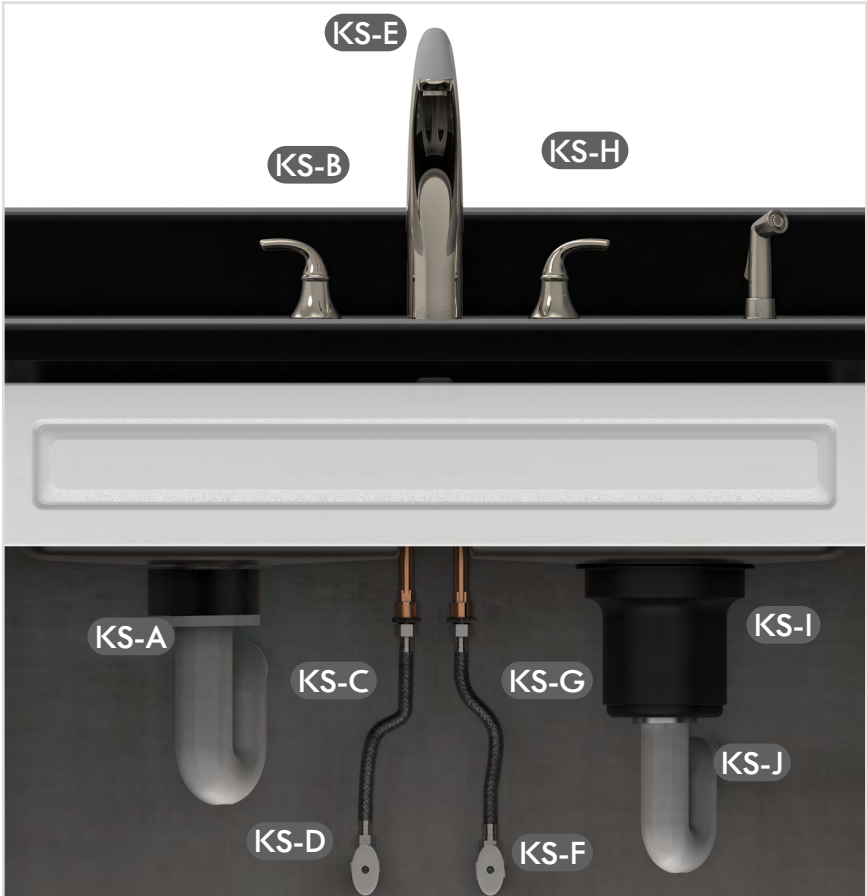

- KS-A:** Drains
- KS-B:** Hot Faucet Handle
- KS-C:** Hot Water Feed Line
- KS-D:** Hot Water Shutoff Valve
- KS-E:** Faucet
- KS-F:** [Cold Water Shutoff Valve](#)
- KS-G:** [Cold Water Feed Line](#)
- KS-H:** [Cold Faucet Handle](#)
- KS-I:** Garbage Disposal

Appendixes

Appendix B - Component Connections

1/4 in. Compression Tubing With Brass Fittings



1/4 in. Compression (Plastic Tubing)

Appendixes

1/4 in. Compression Hose (Basic)



1/4 in. Value Ice Maker Hose

Appendixes

1/4 in. Compression Braided Hose



1/4 in. Premium Ice Maker Hose / Appliance Integrated Hose

DRINKPOD

Customer Care Hotline

For technical support, warranty
repair service, or to order
replacement parts.

1-844-374-6576

www.drinkpod.com

