

1. Read enclosed detailed installation instructions before beginning install.
2. A flat subfloor is a must!
3. Proper moisture testing is a must!
4. Proper expansion around all permanent structures is a must!
5. Molding, trim, transition, and finish pieces must not prevent the floor from floating.
6. Failure to follow installation instructions will void warranty.
7. Acclimation is normally not necessary but may be required in extreme circumstances.

**Please Carefully Read All Instructions Before You Begin Your Installation.  
Improper Installation Will Void Warranty**

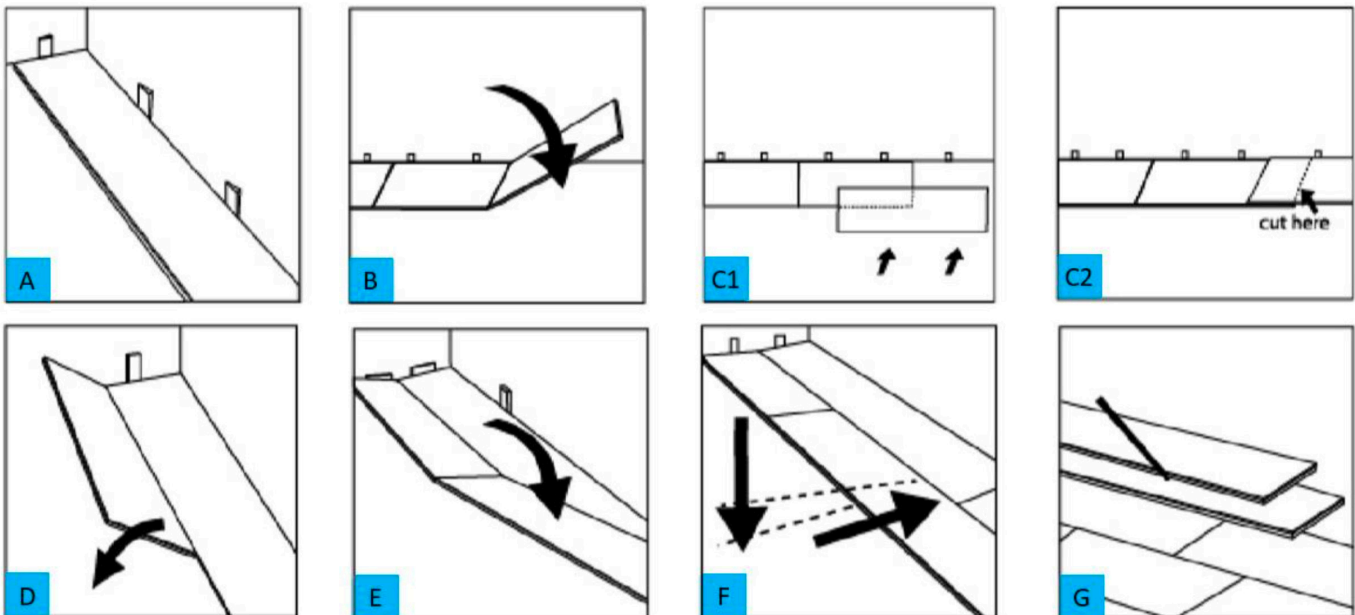

Always check flooring planks for defects such as chips and color variations under good light conditions. Check that groove are free of debris. **Use planks from multiple boxes** during installation to insure random pattern variation.

This flooring should be stored and installed in a climate controlled area with an average temperature of 60-78°F (18-25°C). If the humidity in the room of installation is below 35% or above 70%, the flooring must be acclimated for a minimum for 24 hours by spreading out the cartons during acclimation but not stacking the cartons.

The area in which the flooring is installed must remain climate controlled with the temperature between 65- 78°F (18-25°C) and humidity levels between 35%-70% for the life of the product.

This product is a floating floor and should NOT be secured to the floor. Do not install fixed objects, such as cabinets, on top of the flooring unless it is fully adhered and do not fasten trim/molding/transition pieces directly to the floor.

## Required Tools and Supplies:

- Saw
- Safety Glasses
- ½" spacers
- Utility Knife
- Straight Edge Ruler or T-Square
- Pencil
- Tape Measure
- Adhesive Tape
- Rubber Mallet
- Minimum 6 mil poly vapor barrier for crawl space and concrete floor installations

*If existing baseboard molding is difficult to remove, Quarter Round molding will be required to cover the expansion space need between flooring and baseboard.*

## SUITABLE TYPES OF FLOORS AND FLOOR PREPARATION

The sub floor must be **flat, dry, and clean**. Carpet staples or any/all adhesive residue must be removed and floor must be clean to ensure proper installation. All wooden subfloors must be structurally sound and must be installed following the American Plywood Association's (APA) and the manufacturer's recommendations.

To check for flatness, hammer a nail into the center of the floor. Tie a string to the nail and push the knot against the floor. Pull the string tight to the farthest of the room and examine the floor for any high/lows relative to the string. Subfloors must be flat to 3/16" per 10' (5mm per 3 meters). Any areas in excess of the flatness specification must be sanded down or filled with an appropriate leveler.

This product can be installed over most existing floors including wood, non-cushioned vinyl or linoleum, and ceramic/porcelain tile if the existing flooring is intact and properly secured to the subfloor. If installing over ceramic/porcelain tile, grout lines in excess of 1/16" (0.625) must be filled with a Portland based skim coat/floor leveler according to the manufacturer's guidelines. If installing over a concrete or wood substrate on or below grade, a vapor barrier is required if there is none existing in a well-ventilate crawl space. A minimum 6 mil (0.15mm) plastic poly sheeting should be used as a moisture barrier.

**Warning: This product should not be installed over carpet. Installation over carpet will void the warranty.**

When installed in rooms with direct sunlight, during the peak hours of sunlight, the use of blinds/shades or drapes to avoid prolonged direct sunlight period is recommended.

This product is waterproof but is not a moisture barrier. The product can withstand topical water and water penetration. However, water leaking over and around the outer edges of the flooring can damage and breed mold/mildew growth on subfloor and walls. This is not considered a defect in the flooring.

If considering **Radiant heat**, flooring can be installed over 1/2" (12mm) embedded radiant heat. Radiant heat systems must have a minimum of 1/2" (12mm) separation from the product. Maximum operating temperature should never exceed 85°F (30°C). Use of an in-floor temperature sensor is recommended to avoid overheating. Before installing over new radiant heat systems, operate the system at maximum capacity to force any residual moisture. The maximum moisture content should be 2.5% (CM method). Before starting the installation, turn the heat off for 24 hours before, during, and 24 hours after installation. During installation, make sure the temperature in the room of installation is between 60-80°F (15-25°C). After installation, the system can be turned on and the temperature can be raised gradually (5°F per hour) until returning to normal operating conditions.

**Warning:** Electric heating mats that are not embedded into the subfloor are not recommended for use underneath the flooring. **Using electric heating mats that are not embedded and applied directly underneath the flooring will void the warranty.**

## Installation

- Starting in the left hand corner, place the first plank 1/2" (10mm) from the wall. Use spacers along all walls to maintain an expansion gap of 1/2" (10mm) between the walls and the flooring (Figure A).
- Attach the ends of the 1st plank and the second plank by lifting the 2nd plank and inserting the tongue on the short side into the groove of the first plank and lowering it into place. Line up edges and corners carefully (Figure B).
- Continue along the wall until you reach the last full plank, connecting each plank in manner described above. To fit the last plank, turn plank over (face down). Place the plank in the corner so the tongue on the short end touches the 1/2" spacer from the adjacent wall. Measure overlap between the installed plank and the last plank (Figure C1 & C2).

Use saw to cut plank to size. If cutting with a jig saw, the laminate surface should be turned down. If cutting with a hand saw, the laminate surface should be face up.

**Note: The end pieces must be at least 12". This may require cutting a plank to start a row depending on the size of the room.**

- Begin the next row with the cut piece from the previous row, creating the necessary stagger. This piece should be a minimum of 12" (30cm) long and the joint offset from the previous row should be at least 12" (30cm) apart. To attach, tilt the plank you are installing slightly upwards (about 15-25°), insert its tongue into the previous row's groove, and lower it into place. The plank will click into place with light pressure (Figure D).
- Install the second plank in the second row by inserting the short end tongue into the previously installed plank's groove. Align the plank so that the long side tongue tip is positioned just over the groove lip of the plank in the first row (Figure E). Working from the end seam, at a low angle, insert the long tongue into the groove of the adjoining plank. Very little force is required to fit the tongue into the groove. You should be able to feel the tongue lock into the groove (Figure F). Continue locking each piece into place, short side first and then long side.

- To fit the last row, lay a plank on top of the previous row. With the plank against the wall, mark a line down the length of the plank and cut the planks accordingly to obtain the required width (Figure G). Insert this cut board against the wall. The last row should be at least 2" (50mm) wide. The spacers can then be removed.
- Door Frames and heating vents also require expansion room. Cut the planks to the correct length. Place the cut plank next to its actual position, use a ruler to measure the areas to be cut out and mark them. Cut out the marked points allowing the correct expansion distance on each side. T-molding is suggested in all doorways.
- To trim door frames, turn a panel upside down to use as a height guide. Using a handsaw, cut door frames to the necessary height so that the planks slide easily under them.
- To make holes for pipes, measure the diameter of the pipe and drill a hole that is 7/8" (20mm) larger into the plank. Saw the plank into two pieces perpendicular to the length and bisecting the previously drilled hole. Then lay the pieces in place around the pipe.
- To finish the perimeter of the room, install quarter round molding using finishing nails. Nail quarter round directly into the baseboard not the flooring.

## Maintenance, Tips, and Warnings

### MAINTENANCE:

Sweep or vacuum using soft bristle attachments for daily maintenance. When necessary, clean with a MOIST cloth or mop and water only – heavy use of detergent cleaners will leave a residue and, over time, lead to a cloudy film.

**NEVER USE** floor polish or floor cleaning wax, oils, soaps, etc. These products can damage and/or leave a film on the flooring. This is not a flooring defect.

### TIPS:

- Always use felt tip protectors on all furniture legs/feet, and regularly clean any gathered dirt/grit from the pads
- Entryway/walk off mats are recommended. **Warning:** Never use vinyl/latex/rubber backed protective mats
- Area rugs are recommended
- Keep pet nails trimmed
- Sharp shoe-heels (e.g. high-heels) may dent the floors
- Never slide furniture across a floor without pads
- Keep floors clean
- For wet areas such as bathrooms, caulk/completely seal the perimeter of the floor with a flexible silicon caulk