

Fehom

Home Dehumidifier

Please read the manual carefully
before using the product

PD08F

USER MANUAL

FOR CUSTOMERS

Thank you for purchasing our dehumidifier.

Fehom has been committed to developing powerful and easy-to-use products to bring more convenience to your life. We highly recommend you to keep this user manual for future reference in case of unexpected problems.

Please read this user manual carefully to ensure proper use of the dehumidifier. This dehumidifier is perfect for reducing humidity in family bedrooms, bathrooms, basements, offices, storage rooms and more.

Fehom dehumidifiers reduce the room humidity efficiently, creating a more healthy and comfortable environment for you and your family.

REQUESTING CUSTOMER SERVICE

If there are any problems of the product, please contact Fehom Customer Service at support@fehom.com with your Purchase Order ID. We'll help you solve the problems as soon as possible.

BEFORE FIRST USE:

To protect the product from any internal damages, please keep the product in the upright position throughout its journey.

Please take out the product and leave it standing in the upright position for **24 HOURS** before plugging it in.



TABLE OF CONTENTS

Precautions for Use	01
Parts Description	02
Operation Instructions	03
Cleaning and Maintenance	12
Specifications	13
Troubleshooting	14
Special Notes	17
Warranty and Contact Us	18

Statement

The graphics and functions provided in this manual maybe not the same as the actual product. The model shown in this manual is only for reference. Please install and operate the machine according to the actual situations. The company reserves the right to interpret relevant terms.

PRECAUTIONS FOR USE

Safety notes:

For your safety, please read this manual carefully and keep it for future reference. This product is for home use only. Please install and use the product according to the operations in this manual.

- Before cleaning the dehumidifier, please turn off the machine and unplug it from the power source.
- Please do not place the machine near heat or flammable goods.
- Do not put any sticks or your fingers into the air inlet or outlet.
- Please always place the machine on a flat ground, rather than uneven or slopping ones.
- Do not spray water, insecticides or flammable liquids on the machine.
- Please do not place the machine in a confined or narrow space.
- If the power cord is damaged, please contact a technician approved by the company to replace it.
- In Dry Mode, please keep the clothes at least 15.7 inches away from the air outlet to prevent the water entering the machine to cause damages.
- Please make sure the machine power wiring is installed in accordance with national wiring rules. The power cord should be connected to a reliable external naught wire.
- The fixed wiring connected to the machine must be equipped with an all-pole disconnect device (air switch) with a contact distance of at least 0.118 inch.
- The specification of the fuse: 3.15A.
- Please use this dehumidifier in an environment with the temperature range between 41°F/5°C and 95°F/35°C.
- When using the dehumidifier, please keep other surrounding objects at least 7.9 inches/20cm away from the machine. As shown in the picture:

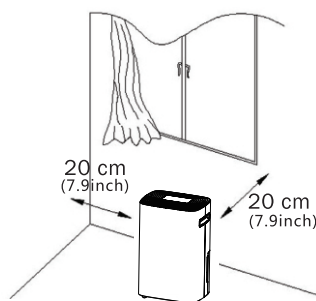

PARTS DESCRIPTION

FRONT

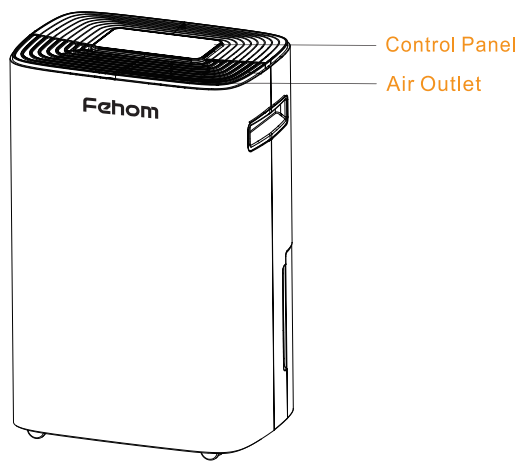

BACK

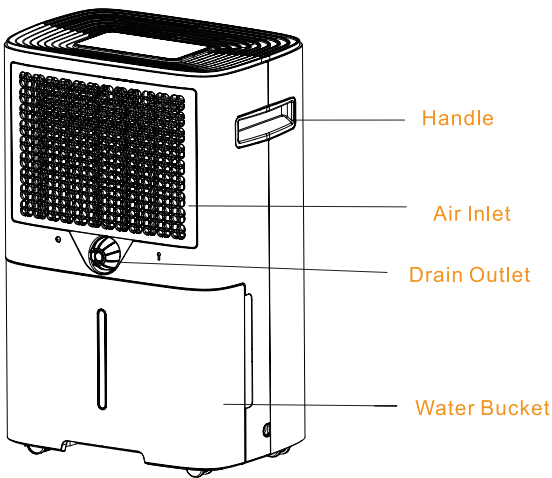

OPERATION INSTRUCTIONS

1. Control Panel

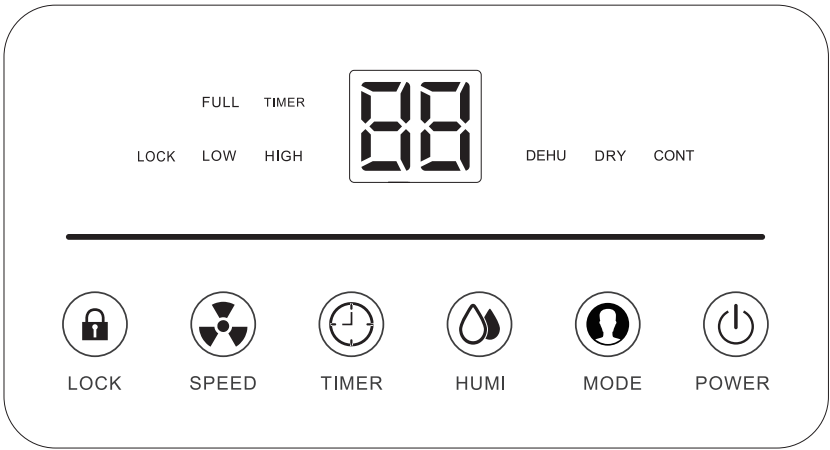

POWER Button

To turn the dehumidifier ON/OFF.



MODE Button

To select working mode between DEHU, DRY, CONT.



TIMER Button

To set Auto ON/OFF timer in 1-24 hrs.



SPEED Button

To select fan speed between high and low.



HUMI Button

To set the humidity within a range of 30%RH to 80%RH in 5% increments



LOCK Button

To enable or disable the child-lock function.



Full Bucket Icon

To indicate the water bucket is full.

OPERATION INSTRUCTIONS

2. Setting

Humidity Setting

The humidity level can be set within the range of 30% RH to 80% RH in 5% increments.

- When the machine starts to work, it will automatically detect and show the room humidity first. In dehumidification mode, press the "MODE" button to set the humidity in 5% increments. Then it will flash "88" and show the set humidity. Now you can set the humidity within the range of 30% RH to 80% RH in 5% increments. If you do not operate the machine for 5 seconds, "88" will show the actual room humidity.
- When the room humidity is higher or lower than the humidity you set, the machine will automatically begin to work or stop.
- When the humidity level is set at 30%RH, the machine will work in continuous dehumidification mode.

Lock Setting

Press and hold the "LOCK" button for 3-5 seconds to lock or unlock the control panel. When the "LOCK" function has been activated, the indicator will light up, and other buttons will be disabled. To regain use of the buttons, please unlock the control button.

Timer Setting

This setting is used for you to set a time when the machine will turn on and turn off automatically.

1. Press the "TIMER" button to select the timer by 1-hour increments. You can set the timer up to 24 hours. The machine will start to countdown when you start the timer.
2. Press and hold the "TIMER" button for several seconds to select faster.
3. If the timer is set to 00, it will be a invalid time. If you set the timer successfully, the light "TIMER" will light up. The led screen will display the time for several seconds and show the current humidity.

OPERATION INSTRUCTIONS

Speed Button

Press this button to control the fan speed. By pressing it, you can choose either High or Low speed. Higher speed results in quicker moisture removal. So when you want to reduce the humidity quickly, please choose the High speed; If you have reduced the humidity or prefer quieter operation, please choose the Low speed.

DRY (Laundry Dry) Mode

Press the “  ” button until you see the “DRY” indicator light up on the display to select DRY-CLOTHES mode. In the DRY mode, the dehumidifier will run continuously at high fan speed.

Note: In the DRY mode, the HUMI button and SPEED button are disabled.

CONT (Continuous) Mode

Press the “  ” button until you see the CONT indicator light up on the display to select continuous mode. In the CONT mode, the dehumidifier will run continuously until the water bucket is full.

Note: In the CONT mode, the HUMI button is disabled. SPEED button is available for setting.

Overflow Protection

When the bucket is full of water, the machine will turn off automatically. The indicator light is "FULL" will flash. After you empty the water from the bucket, the indicator light "FULL" will turn off. The machine will restart to work.

Convenient Drain





When the water tank is full, the Full Tank indicator will light up. No need to check the tank from time to time.

Auto Drain: The dehumidifier has a Drain outlet where you can just simply attached the 6.56ft hose used for continuous drainage.

Manual Drain: When the water tank is full, the "Full Tank" indicator will light up, the dehumidifier will automatically turn off and will start to turn on automatically when the tank is emptied and placed back into the unit.

OPERATION INSTRUCTIONS

3. Display Status Description

- When the device is currently powered on, when turning it off only the "POWER" will light up indicating device is in "Standby" status.
- Setting light "  " : If the timer is setup properly, the indicator will light up. Otherwise, the indicator will be off.
- High-speed indicator light "  " : If you set the high speed, this indicator will light up.
- Low-speed indicator light "  " : If you set the low speed, this indicator will light up.
- Dehumidify mode indicator light "  " : When the machine starts to dehumidify, this indicator light will light up. When the room humidity reaches the set humidity, the light will flash. Otherwise, it will be off.
- Water full light indicator " FULL " When the water tank or bucket is full, this indicator will flash.
- If the machine malfunctions, it will alarm and "88" will flash and show the error code.
- When the dehumidifier works normally, "88" will show the current humidity.

4. Instructions for Drying Clothes

The dehumidifier can be used for drying clothes in rainy weather.

Step 1.

Hang the washed clothes in a small space such as cloakroom, bathroom, or storage room.

Please keep the machine away from the water drips from the wet clothes.

Step 2.

Turn on the dehumidifier and set the humidity level at 30% RH. It is perfect if you can let the machine air outlet blow the air to the wet clothes directly.

1. The drying effect will vary according to the clothes thickness, quantity and the size of the drying space. Theoretically, the effect will be better if you hang few thin clothes in a small space.

2. It will take 3-8 hours to dry the wet clothes in general. We suggest that you should use continuous drainage when drying clothes.

5. Faults and Solutions

Problems	Analysis of Causes	Solutions
Humidity always shows "25% RH" but there is a big difference from the actual humidity.	Does the humidity sensor fail?	Set the humidity to 30% RH and check if the dehumidifier can work normally. If it does, the machine is in a good condition.
		Repair or replace the humidity sensor.
Humidity always shows "99% RH" but there is a big difference from the actual humidity.	Is there some water on the surface of the humidity sensor?	The dehumidifier can work normally. The moisture removal effect is not affected.
		Please keep the machine working for a while to remove the water on the humidity sensor surface. The machine will work normally when the water is removed.
		Repair or replace the humidity sensor.

If the malfunctions still exist, please don't hesitate to contact Fehom Customer Service at support@fehom.com for help.

Notice:
Before turning on the machine, please be sure to have opened the air outlet. Otherwise, the machine will overheat. Do not unplug the power cord directly to turn off the machine.

OPERATION INSTRUCTIONS

6. Empty the Tank or Bucket

There are two ways to remove collected water.

Using the Bucket

When the water tank is full, the full tank alert indicator will light up and the dehumidifier will automatically shutdown until the tank is emptied and placed back to the machine.

Ways to Empty the Water Tank

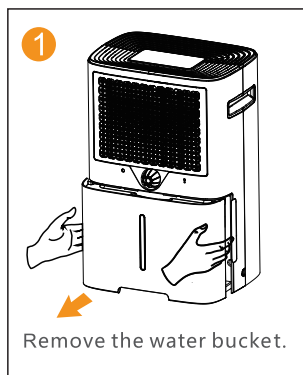

OPERATION INSTRUCTIONS

Note:

Do not remove the float in the water tank. Otherwise, the sensor may be unable to identify the water level in the tank properly, thus causing water leakage.

If the water tank is dirty, please use cold or warm water to clean it. Do not use any detergents, steel wools, chemically-treated dust clothes, gasoline, benzene, thinners or other solvents. Otherwise, it may damage the water tank and cause it to leak.

When placing the water bucket back, please use your hands to gently put it back to its original place. If the water tank is not placed properly, the sensors preventing water overflow may not operate as expected.

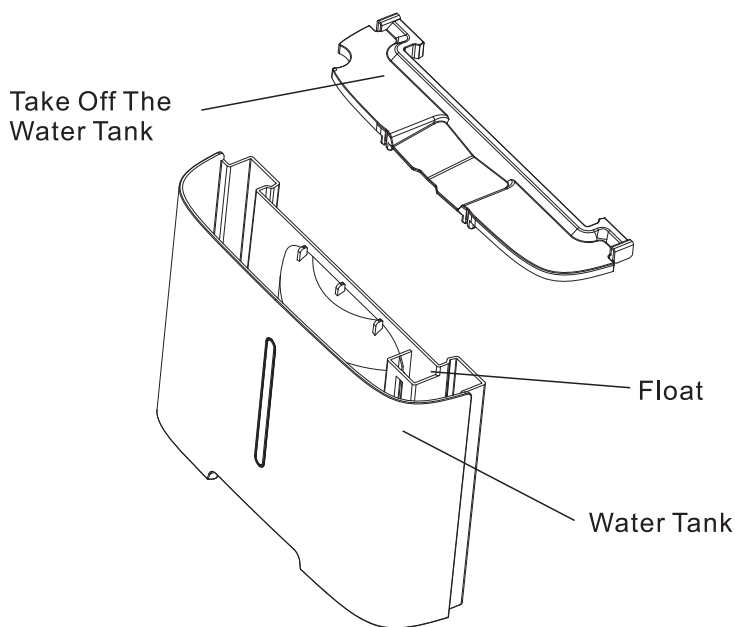

OPERATION INSTRUCTIONS

7. Continuous Drainage

To continuously drain, please unplug the machine from the power source first. Then take out the water tank and open the drain cover. Now insert the drain hose into the continuous drain port and place the water tank back to its original place. Plug the machine into the power source to start continuous drainage. Please make sure that the drain hose should be lower than the continuous drain port by at least 3.9 inches. Do not bend the drain hose. (Note: The diameter of the continuous drain port is 16mm/0.63inch.)

1

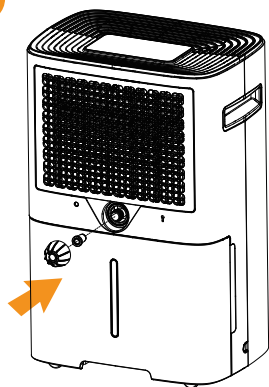

Unscrew the drain outlet cap.

2

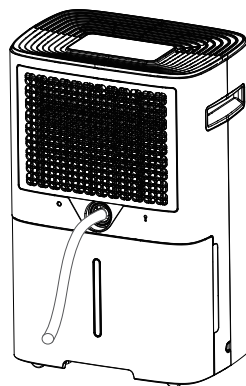

Attach the drain hose to the drain outlet.

8. Smart Functions

Auto Shut Off

When the bucket is full and/or the room humidity reaches the set point, the dehumidifier will stop working automatically.

Wait 3 Minutes Before Resuming Operation

To avoid any damage to the dehumidifier, the compressor will not start operation following a complete cycle until after 3 minutes. The operation will automatically start after 3 minutes.

Auto Defrost

When the frost builds up on the evaporator coils, the compressor will cycle off and the fan will continue to run until the frost disappears. During defrost process, the POWER indicator will flash.

Auto Restart

If the dehumidifier shuts off unexpectedly due to power outage while it is running or in standby mode, the dehumidifier will restart with the previous function setting (working mode, set humidity, fan speed and etc.) automatically when the power resumes.

CLEANING AND MAINTENANCE

⚠ WARNING:

Please turn off the dehumidifier and unplug it from the power source before cleaning.

A-Cleaning the Dehumidifier Body

Please use a soft and slightly damp cloth to clean the humidifier body.

B- Cleaning the Filter

1. Pull out the filter.
2. Clean the filter: Use a vacuum cleaner to gently remove the dust from the surface of the filter. If the filter is very dirty, wipe it with warm water and a mild detergent and dry it completely.
3. Carefully insert the filter back to its original place.

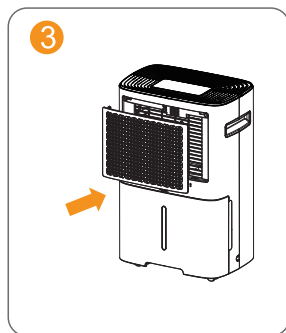
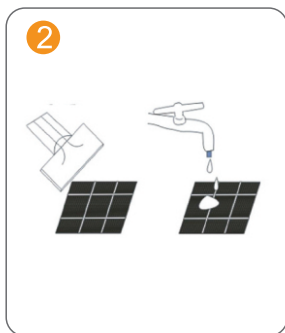
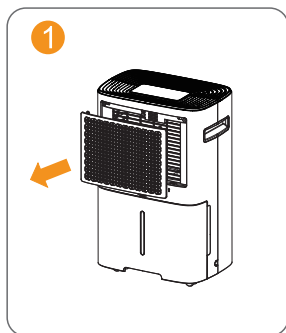

C-Dehumidifier Storage

If you don't use the machine for a long time, please store it according to the following steps:

1. Empty the water in the water tank.
2. Roll up the power cord and tie it up.
3. Clean the filter.
4. Place the machine in a cool and dry environment.

SPECIFICATIONS

Model	PD08F
Power Source	120V ~ 60Hz
Rated Power (95°F,90%RH)	400W
Rated Current (95°F,90%RH)	3.6A
Moisture Removal (65°F,60%RH)	15 Pints/Day
Moisture Removal (80°F,60%RH)	23 Pints/Day
Moisture Removal (86°F,80%RH)	40 Pints/Day
Moisture Removal (95°F,90%RH)	50 Pints/Day
Input Power (65°F,60%RH)	216W
Input Current (65°F,60%RH)	2.0A
IEF (64.94°F,60%RH)	1.30 liters/kWh
Motor Fla	0.23A
Motor Compressor	RLA:2.4A LRA:9.9A
Refrigerant	R134a/150g (5.29ozs)
Maximum Allowable Pressure	3.5MPa
Maxlmum Operating Ressure High	1.6MPa
Maxlmum Operating Ressure Low	0.7MPa



WARNING:

This product can expose you to chemicals including Styrene and its compounds, which is known to the State of California to cause cancer and birth defects or other reproductive harm. For more information go to: www.P65Warnings.ca.gov

TROUBLESHOOTING

Check the information below for troubleshooting the common problems you may encounter in the future. These abnormal conditions that are not faults caused by manufacturing process or material defects.

If the malfunctions still exist, please feel free to contact Fehom customer service for help.

Problems	Possible Causes	Troubleshooting
Dehumidifier does not work	The power cord is unplugged.	Make sure that the unit's plug is inserted properly into the power outlet.
	Is the full tank indicator flashing? (The tank is full or it is in a wrong position.)	Empty the water in the water tank and then reposition the tank.
	Is the room temperature above 95°F (35°C) or below 41°F (5°C).	The machine cannot work in an overheat or cold environment. It will automatically shutdown to protect itself.
	Is the room temperature between 41°F (5°C) and 68°F (20°C) ?	When running under lower ambient temperature, the machine will automatically defrost, it is a normal phenomenon. Wait until the defrost process finish, it will restart dehumidifying again.
	The dehumidifier is in the defrosting process.	It is normal the compressor ceases while defrosting process. Wait until the defrost process finish, it will restart dehumidifying again.
	Does the room humidity is lower than or reach the preset humidity level? (The room humidity has reached the preset humidity level, the dehumidifier enters into Standby Mode and the the LCD and indicators will flash.)	Please set the humidity 5% lower than the room humidity or set the humidity to 30% RH.
	There is prevent frequent start function in the machine. Dose the machine stop working just now?	Please wait for more than 3 minutes.
	Room humidity is low.	The machine is designed to work in the humidity range of 30% RH to 80% RH. It will not work if the humidity is not within this range.

TROUBLESHOOTING

Dehumidifier does not dry the air as it should	The air filter is dirty.	Clean the air filter.
	Is the air inlet or air outlet obstructed?	Remove the obstruction from the air inlet or outlet.
	The dehumidifier size is too small for application.	Increase the quantity of dehumidifier. Or change a higher capacity dehumidifier.
	Poor air circulation.	Please leave about 7.9inch(20cm) around the product.
	Did not allow enough time to remove the moisture.	Allow enough time to remove the moisture. When first installed, allow at least 3-4 days to maintain the desired RH.
	The room has not been sealed properly.	Check that all doors, windows and other openings are securely closed.
	The room temperature is too low or the ambient temperature is below 41°F (5°C) (The machine will not work or it dehumidifies very slowly in low temperature).	Please wait the temperature rises above 5°C or higher.
The dehumidifier makes loud noise when operating	The dehumidifier is not positioned level.	Move the machine to a horizontal position.
	Is there blocking around the air inlet? The air filter is clogged.	Clean up the dirt on the air inlet and outlet.
	Is the filter installed correctly?	Please check to see if the filter package is removed and it is installed properly.
Dehumidifier operates continuously	Check if the dehumidifier is in CONTINUOUS MODE.	Don't set the humidity too low. Typically, 40-50% are good settings to use.
	Room humidity is too high.	Change humidity settings or replace the machine with a higher-capacity dehumidifier.
	Doors and windows are open.	Ensure that all doors, windows and other openings are closed.

TROUBLESHOOTING

Overflow of water on floor	The connection between the hose and port may be loose.	Connect the hose with the drain outlet tightly.
	The water tank is not installed properly.	Re-install the water bucket properly.
	The float of the water tank has sunk.	Move the float and make sure it can swing freely.
	The magnet on the float has come off.	Put the magnet in right position.

Notice:

If the dehumidifier still does not work properly as expected, please unplug the machine from the power source and contact Fehom customer service at support@fehom.com.

SPECIAL NOTES



- 1 When using the machine, please do not put it on a soft or uneven ground to prevent vibration and movement.



- 2 Do not insert any thin rods or hard items into the machine to prevent malfunctions and dangers.

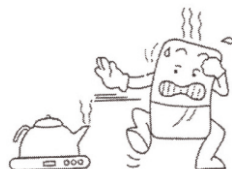

- 3 When using the machine, please keep it away from any heating furnaces, electric kettles and other heating sources.



- 4 When using the machine, please close doors and windows for the optimal moisture removal effect.



- 5 Please do not put any objects around the machine. The dehumidification effect will be affected if the ventilation is bad.



- 6 Please unplug the machine from the power source if you do not use it for a long time.



- 7 When cleaning the machine, please use wet cloth to wipe gently. Do not spray water on it directly.



- 8 Please do not put any objects on the dehumidifier.



- 9 Please clean the filter every two weeks. Do not use hot water above 104°F, alcohol, gasoline or toluene.



- 10 When using the hose to drain continuously, please place the hose horizontally and make sure it is even and not winded.



- 11 After cleaning the filter, please do not dry it under direct sunlight to prevent it from deforming.



- 12 Before moving or carrying the machine around, please empty the water tank first.

Warranty

Fehom offers a 12-month warranty to all of our products together with the original proof of purchase when a defect occurred, including those newly purchased and unused, from Fehom or through an authorized reseller, wholly or substantially, or as a result of faulty manufacturing parts, or workmanship during the Warranty Period.

The warranty does not apply if damage is caused by other factors, including but without limitation of:

- (a) Normal wear and tear;
- (b) Abuse, mishandling, accident or failure to follow operating instructions;
- (c) Exposure to liquid or infiltration of foreign particles;
- (d) Servicing or modification of the product other than by Fehom.

There are our general terms for the warranty service, but we always encourage our customers to contact us if any issues, regardless of warranty terms. If you are experiencing an issue with fehom product, you can reach out to us at support@fehom.com, we will dedicate our efforts to resolve it for you.

Extend Your Warranty by 1 Year

Register your product at www.fehom.com to extend your 1-year warranty by an additional year.

*Please fill out all required fields and include your Order ID, Date of Purchased if applicable.

Customer Support

If you have any questions or concerns about our product, please feel free to contact our expert support team. Fehom customer service is ready to help.

Fehom Office

13211, Spring Street Baldwin Park, CA, US

Email: support@fehom.com

Live Chat: www.fehom.com

Support Hours

24 Hours available

*Please have your order number before contacting customer support.

Fehom

For FAQs and more information please visit:

www.fehom.com



@Fehom



@Fehom



@Fehom



@Fehom



(Scan the QR Code for Live Chat)

We are expecting to see our products fulfill your life and hear your voice.

Your satisfaction means a lot to us.

Please tag us if you share a snap on your social media.

www.fehom.com