

# PRE-DRILLED UNITS

## HANGING INSTRUCTIONS

### STEP 1

---

Insert the supplied #6 2.5" phillips head screw into the pre-drilled hole. Do until about 1/8" of the screw exits back side of board. At desired height hold the shelf level and press the screw tip into the wall surface as a marker.

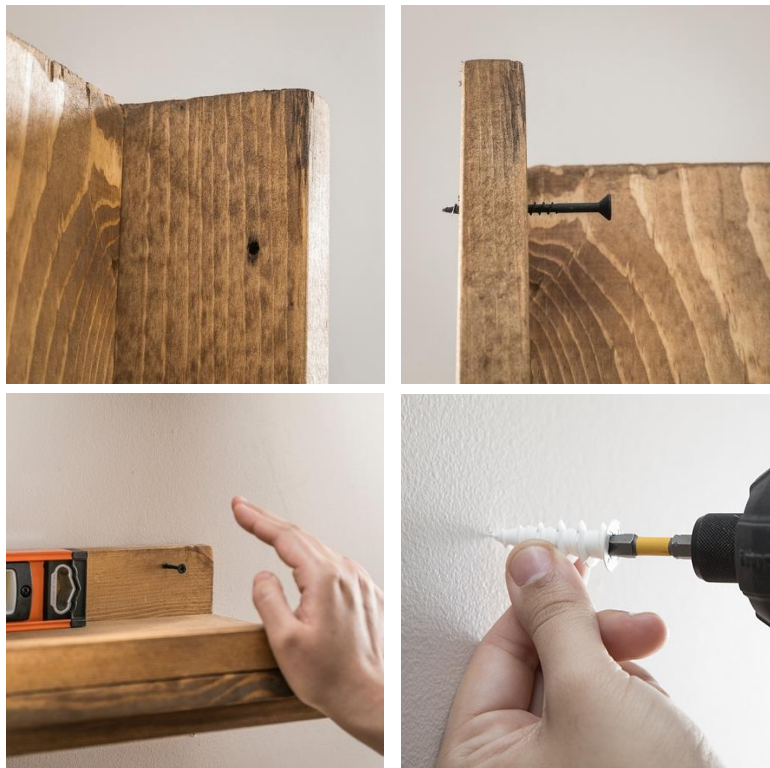

## STEP 2

---

Either on a stud or using the supplied drywall anchor tighten screw until secure (do not over tighten).



**HAVE FUN DECORATING!**

